

6FU03400a

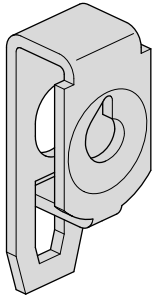

Vega D

- | | | | |
|----|--------------------------|----|-----------------------|
| ⓁⒹ | Montageanleitung | ⓁⒽ | Upute za montažu |
| ⓁⒻ | Notice d'instructions | ⓁⒺ | Szerelési útmutató |
| ⓁⒼ | Mounting instructions | ⓁⒿ | Montavimo instrukcija |
| ⓁⓃ | Montage instructie | ⓁⓈ | Montāžas instrukcija |
| ⓁⓀ | Monteringsvejledning | ⓁⓉ | Instrukcja montażowa |
| ⓁⓂ | Asennusohje | ⓁⓇ | Intruciuni de montare |
| ⓁⓃ | Montasjeanvisning | ⓁⓀ | Návod na montáž |
| ⓁⓊ | Monteringsinstruktioner | ⓁⓇ | Инструкция по монтажу |
| ⓁⓉ | Istruzioni di montaggio | ⓁⒹ | Инструкции за монтаж |
| ⓁⓈ | Instrucciones de montaje | ⓁⒺ | Οδηγίες χώνευσης |
| ⓁⓇ | Instruções de montagem | ⓁⓈ | Navodilo za montažo |
| ⓁⒿ | Montážní návod | ⓁⓉ | Paigaldusjuhised |
| ⓁⓈ | Uputstvo za montažu | ⓁⓀ | Leiðbeiningar |
| | | ⓁⓇ | دليل التركيب |

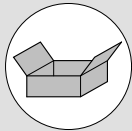
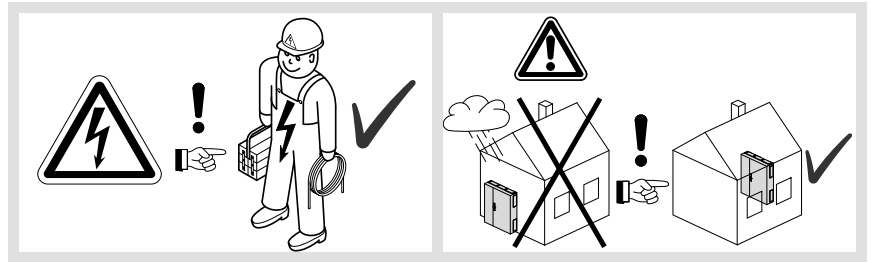

ZZ41SF

4x

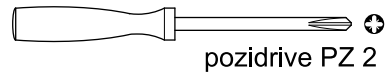
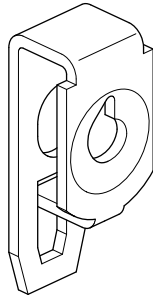

pozidrive PZ 2

