

vision
VKS01PVG, 40A / 230V

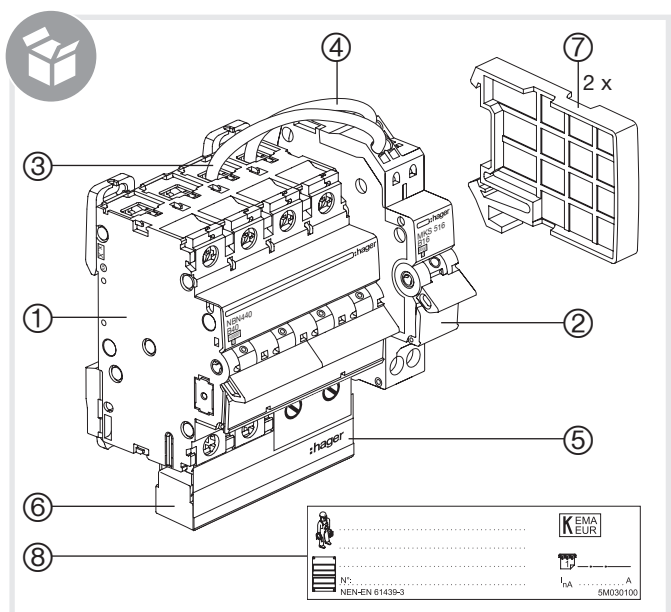

Schroefverbindingen voor inbedrijfstelling controleren a.u.b.



(NL) Gebruiksaanwijzing



Opmerking:

De set wordt compleet geleverd. Om te voldoen aan de geldende normering en keuringen moet de set conform deze gebruiksaanwijzing worden gemonteerd. Er mogen geen andere materialen worden toegepast dan zijn meegeleverd.



Let op!

De PV-kit mag alleen in specifieke vision verdelers worden geïnstalleerd. Voor een gedetailleerde lijst van geschikte verdelers kijk op: hager.nl/vision

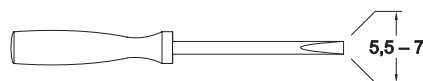
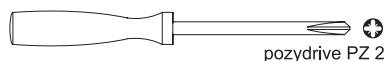

Uitbreidingsset vision:

- ① Installatieautomaat 4-polig 40 A
B-karakteristiek 10 (15) kA **NBN440**
- ② Installatieautomaat 1p+N 16 A
B-karakteristiek 6 kA, quickconnect **MKS516**
- ③ Draad 2,5qmm massief - bruin
- ④ Draad 2,5qmm massief - blauw
- ⑤ Kamrail
- ⑥ 2 x Eindkapje
- ⑦ 2 x Afstandsstuk in verband met warmte, 0,5 module **LZ060**
- ⑧ Type sticker

1

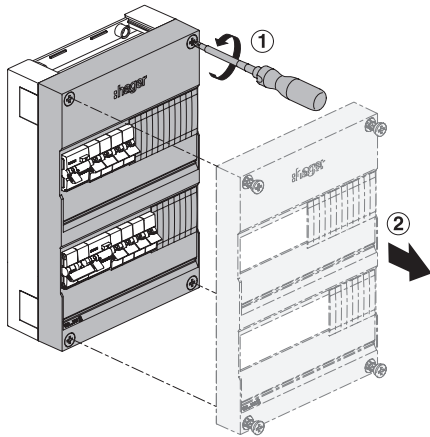

2

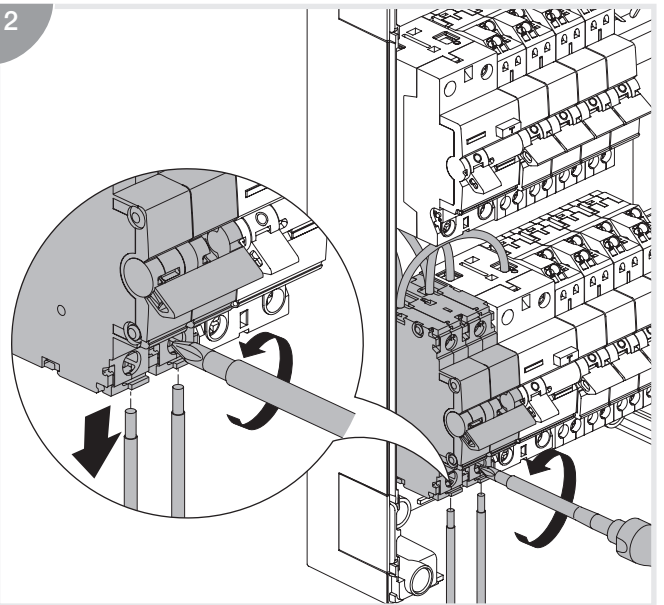

3

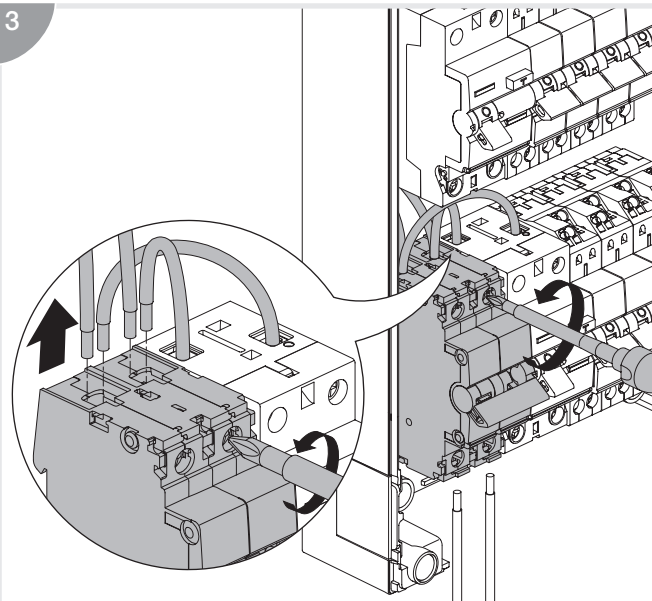

4

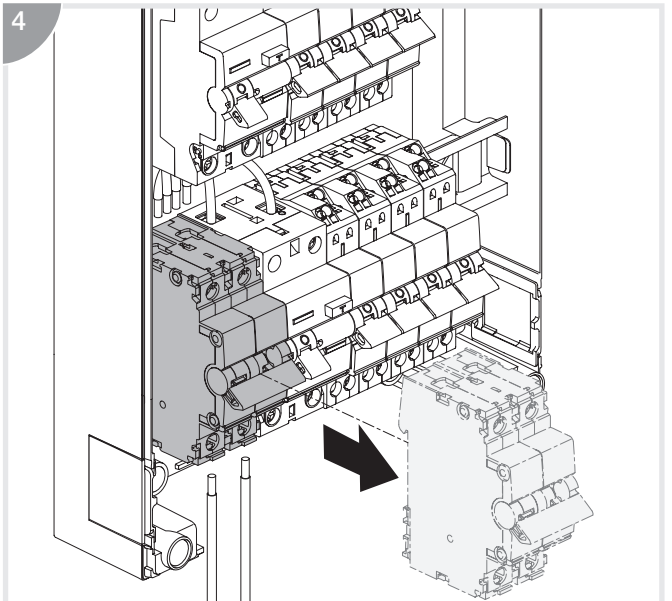

5

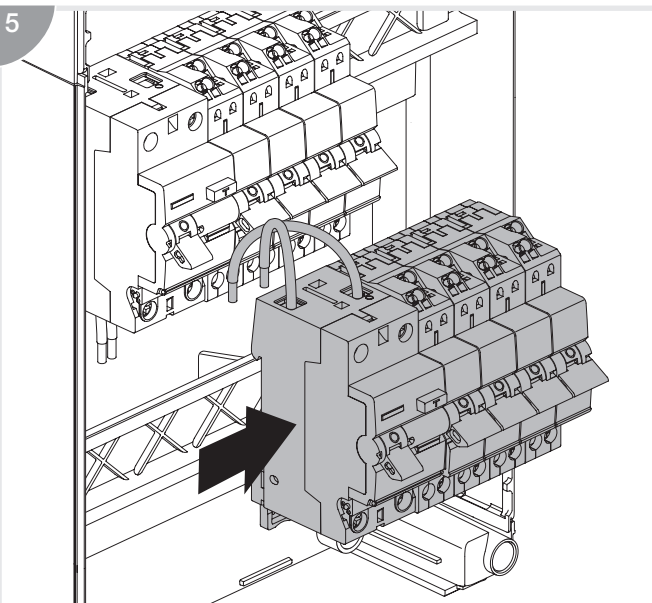

6

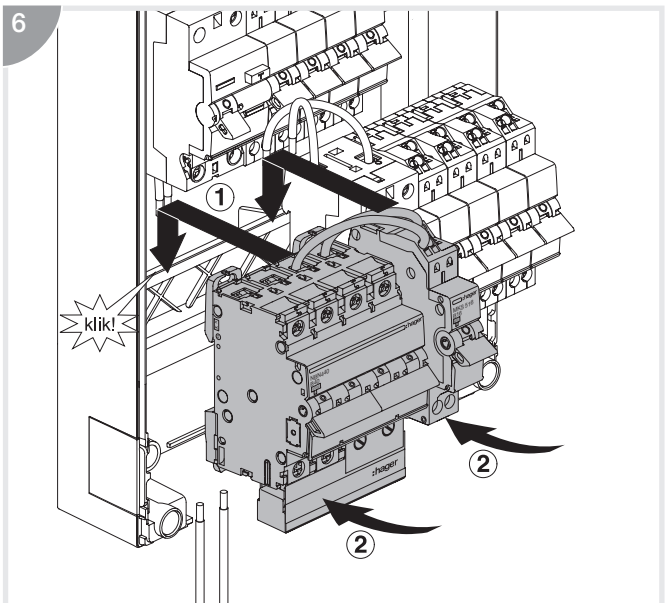

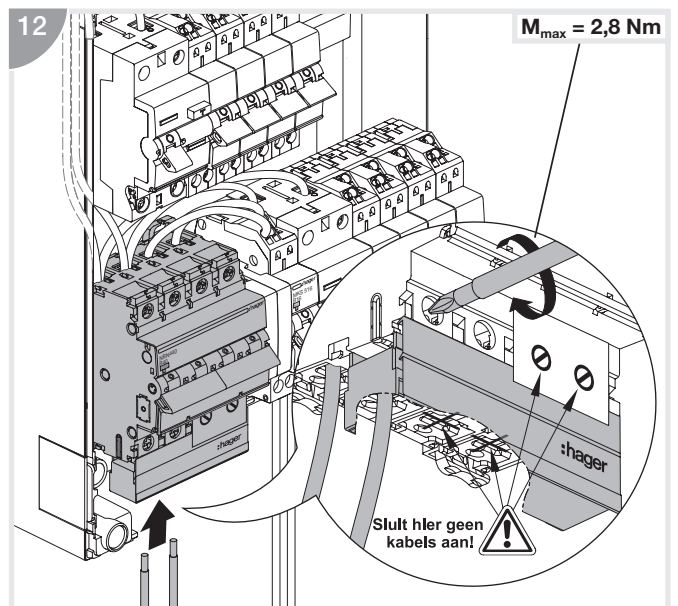
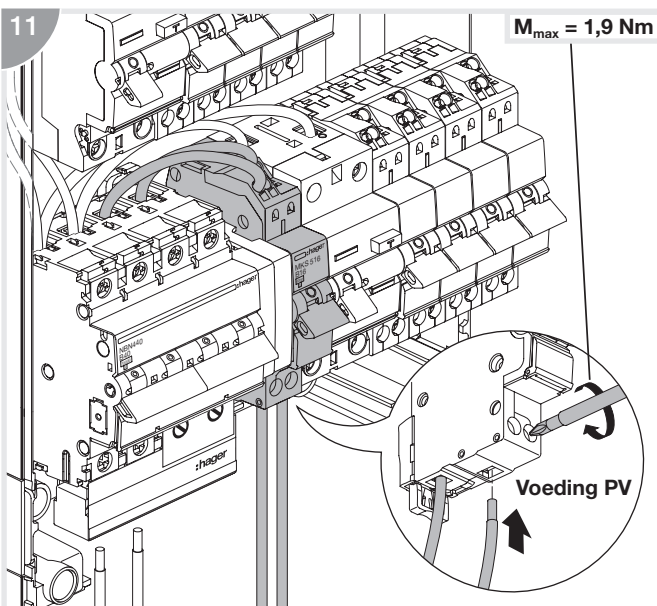
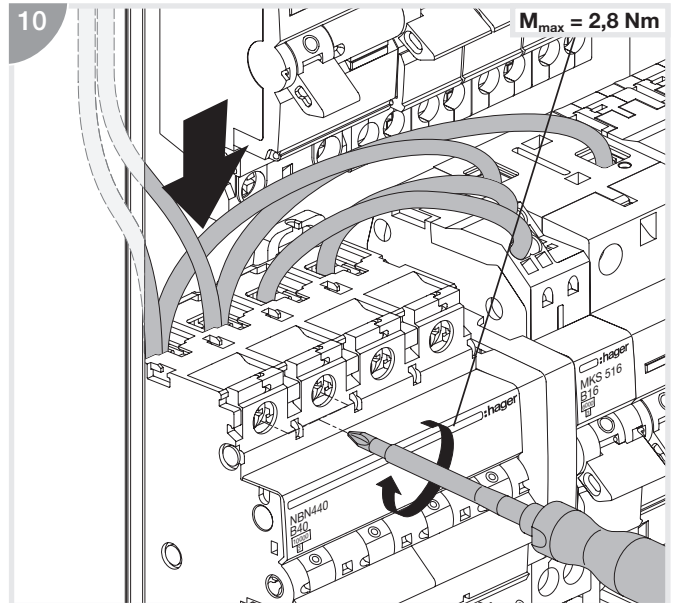
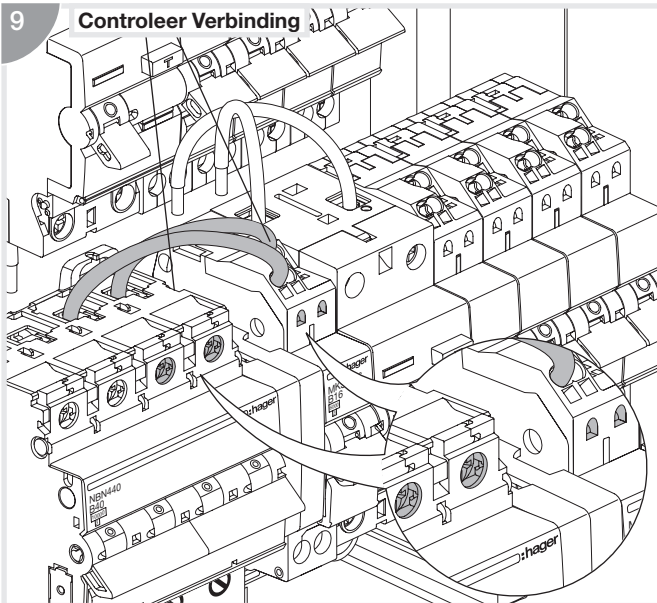
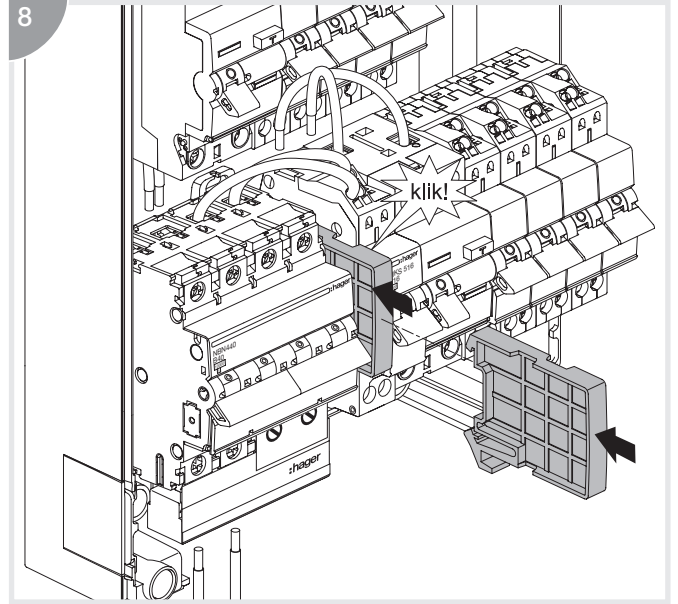
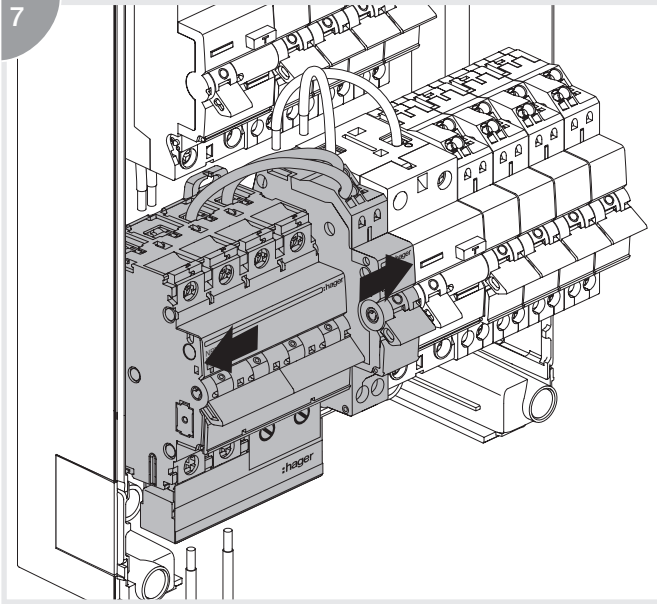

13

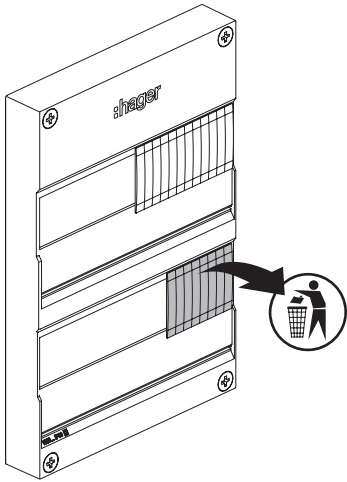

14

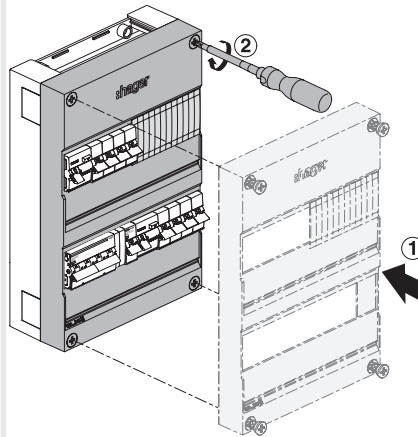

15

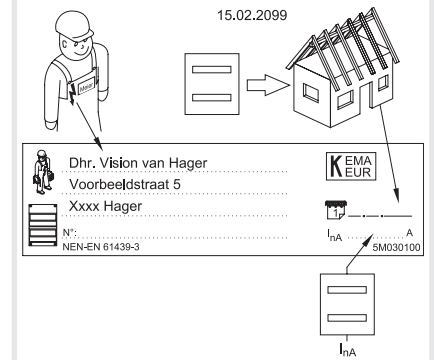

16

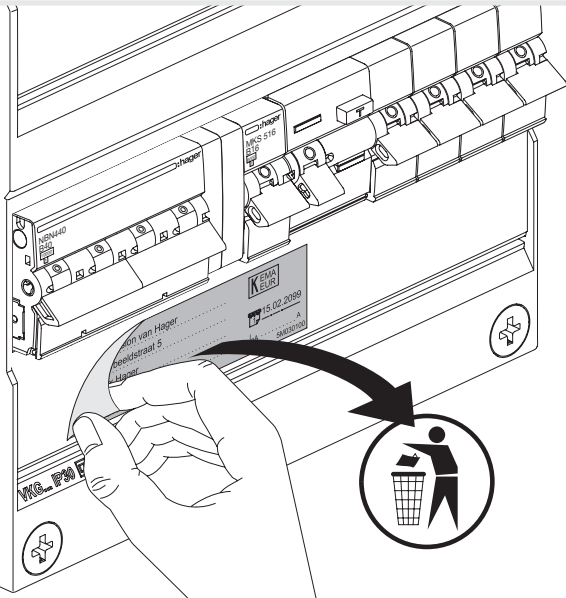

17

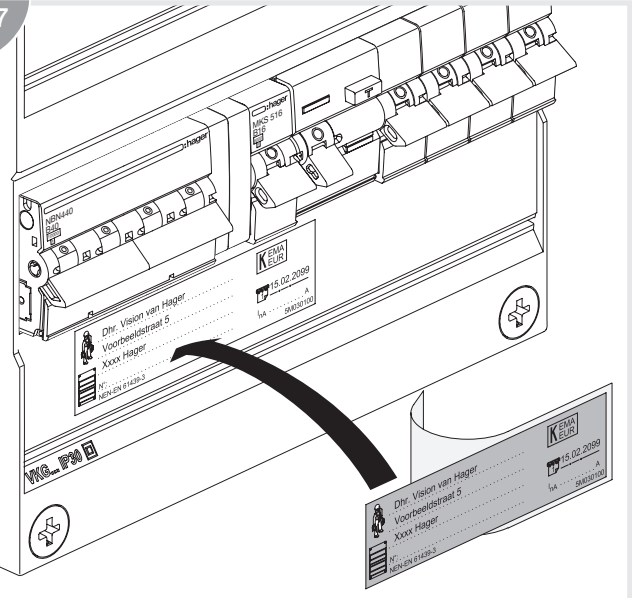

18

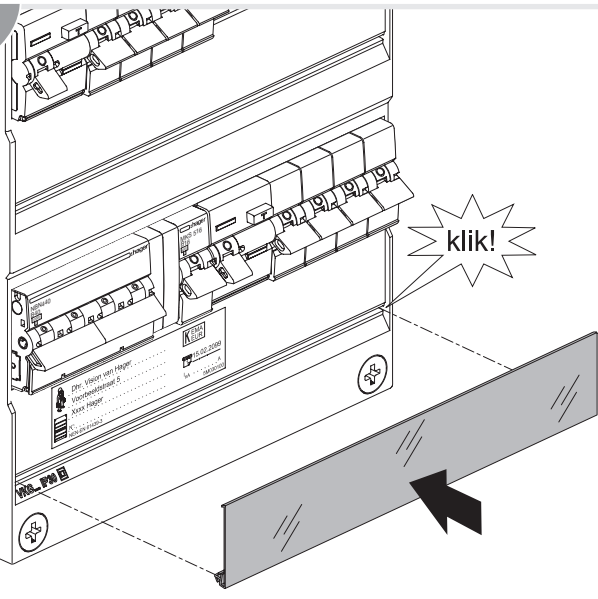

19

