

Strömbegränsningsdiagram gG/gL 500V~ D01, D02, DII, DIII Smältsäkringar

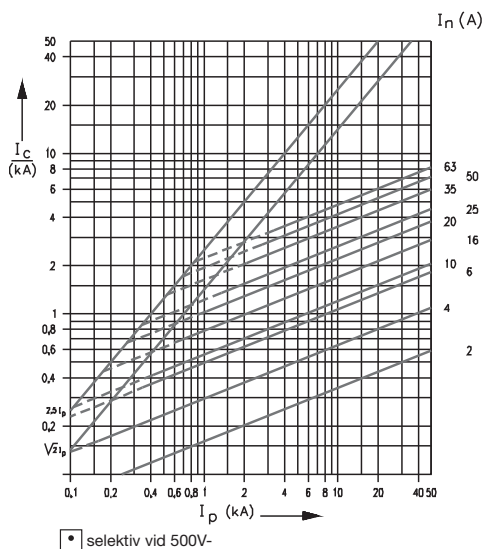

Selektivitet gL/gG Säkringar D01, D02, DII, DIII

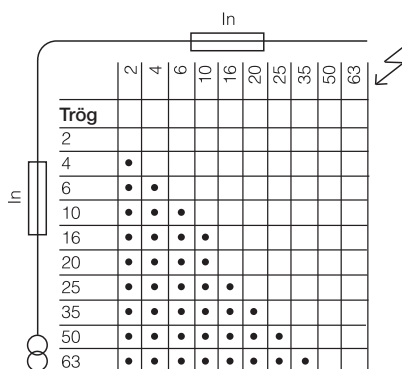

Egenförbrukningstabell D01, D02 gG/gL säkringar

	In	Watt
D01	2A	0,8
	4A	1,1
	6A	1,2
	10A	1,1
	16A	1,7
	20A	1,7
D02	25A	2,3
	35A	2,8
	50A	3,8
	63A	5,0

DII, DIII gG/gL säkring

	In	Watt
DII	2A	1,5
	4A	1,6
	6A	1,8
	10A	1,4
DIII	16A	2,1
	20A	2,2
	25A	3
	35A	4,1
	50A	5
	63A	6,9

Tid-/strömkurvor D01, D02, DII, DIII gG/gL

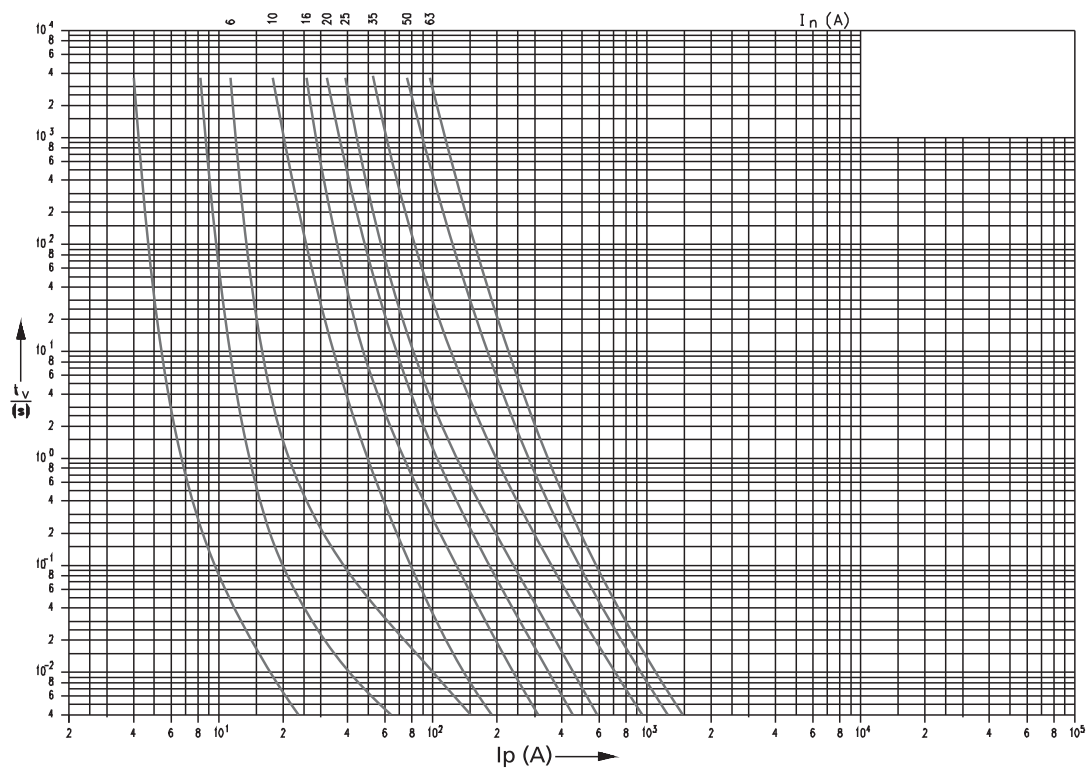

Tekniska data NH-Säkringar

Selektivitet för säkringar

Strömbegränsningsdiagram gG 500 V~

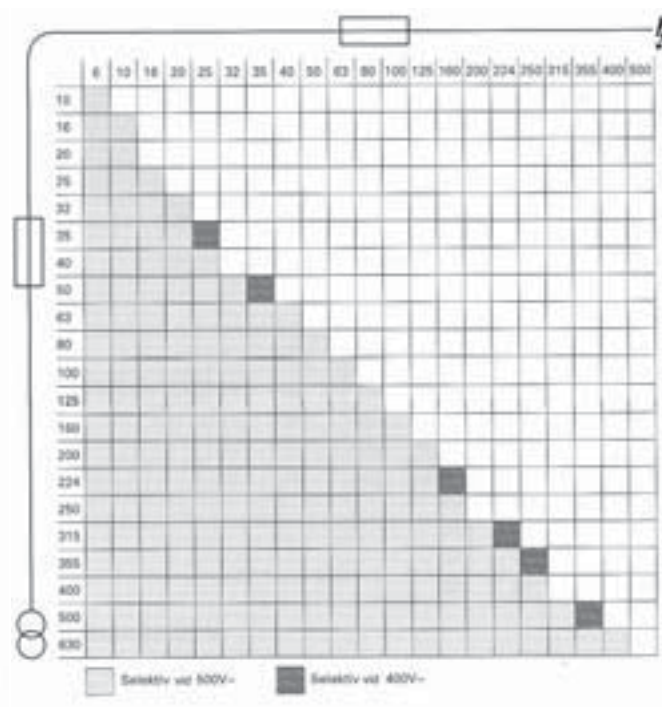
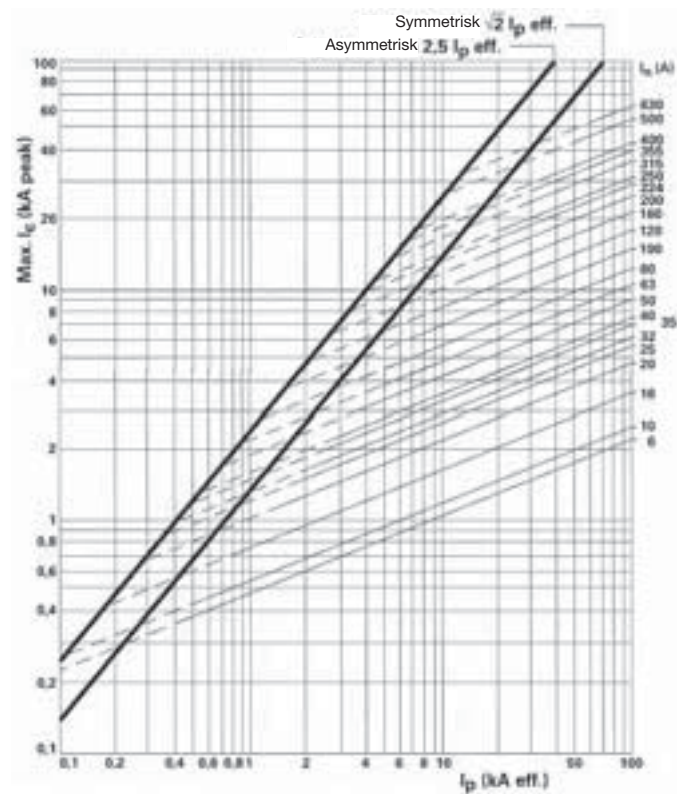

Genomsnittlig tid-/strömkurvor gG 500 V~

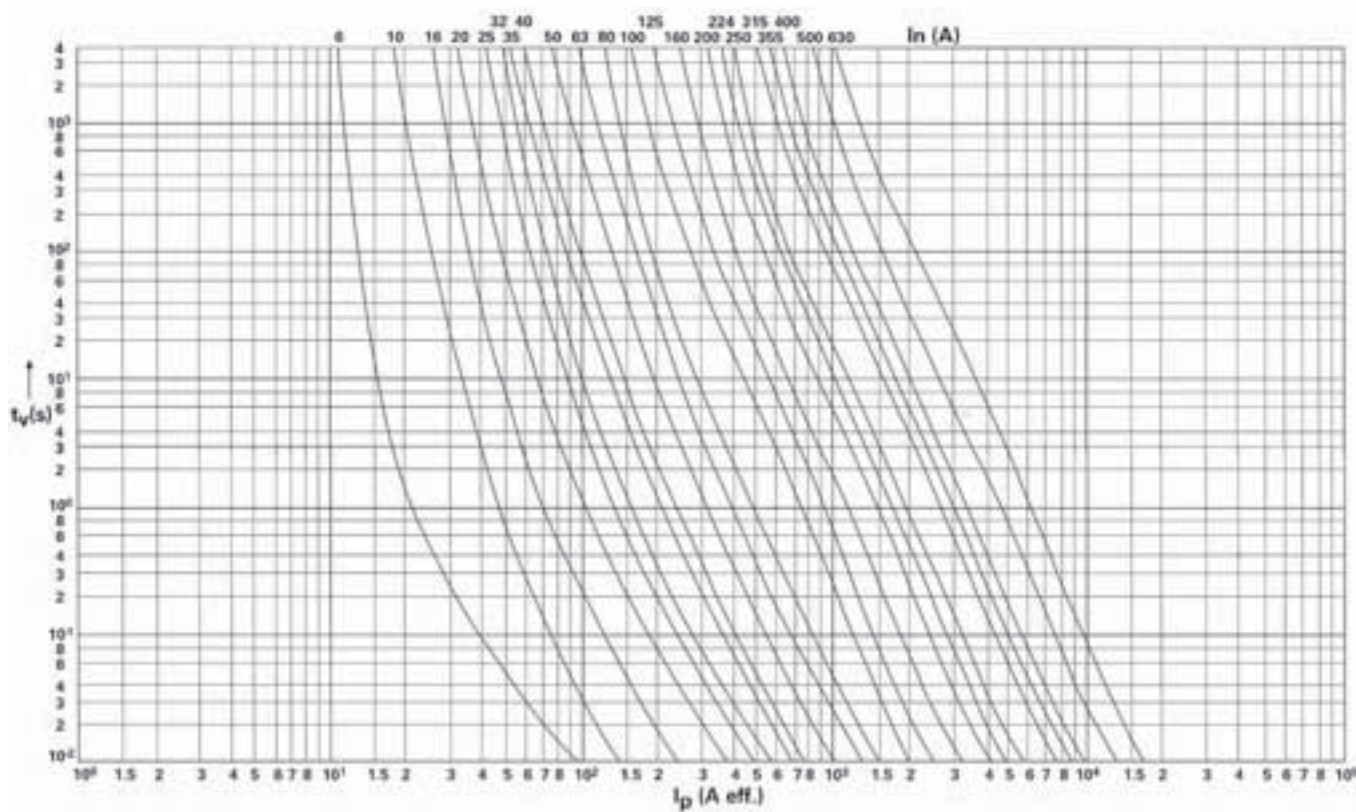

Tekniska data NH-säkringar

NH-Säkring DIN 500 V~

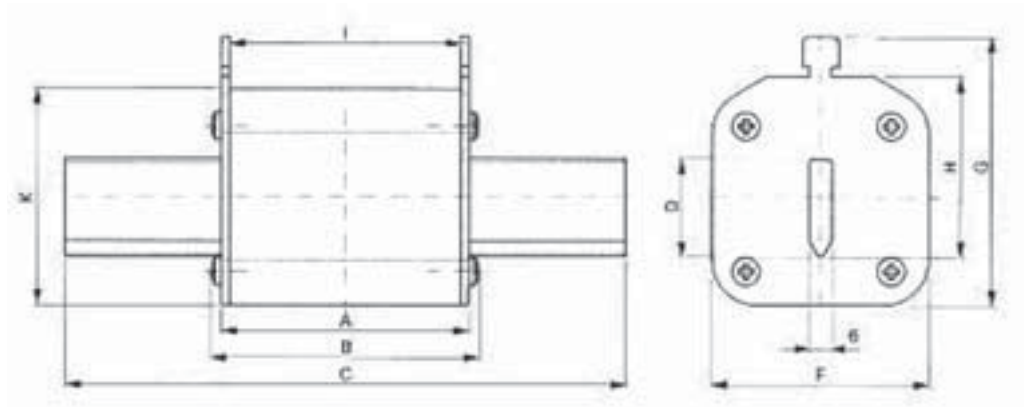

Storlek	Märkström	A	B	C	D	F	G	H	I	K
000	≤ 100A	49	53	79	15	21	51	35	45	37
00	> 100A	49	53	79	15	30	59	35	45	45
1C	≤ 160A	68	71	135	15	30	64	40	62	45
1	> 160A	68	71	135	20	50	64	40	62	50
2C	≤ 250A	68	71	150	20	50	50	48	62	50
2	> 250A	68	71	150	26	58	72	48	62	58
3C	≤ 400A	68	71	150	26	58	84	60	62	58
3	> 400A	68	71	150	32	68	84	60	62	68

Egenförbrukning DIN 500 V~

