

Lastmanagement

Sicherheitshinweis!



Einbau und Montage elektrischer Geräte dürfen nur durch eine Elektrofachkraft gemäß den einschlägigen Installationsnormen, Richtlinien, Bestimmungen, Sicherheits- und Unfallverhütungsvorschriften des Landes erfolgen.
Bei Nichtbeachten der Installationshinweise können Schäden am Gerät, Brand oder andere Gefahren entstehen.



GEFAHR!

Elektrischer Schlag bei Berühren spannungsführender Teile!

Elektrischer Schlag kann zum Tod führen!

- Vor Arbeiten am Gerät Anschlussleitungen freischalten und spannungsführende Teile in der Umgebung abdecken!
- Sofern Arbeiten unter Spannung im Sinne von DGUV 3 §8 Nr.2 nicht zu vermeiden sind, dürfen diese nur durch eine Elektrofachkraft ausgeführt werden, welche im Sinne dieser Vorschrift die fachliche Eignung für derartige Arbeiten nachgewiesen hat.

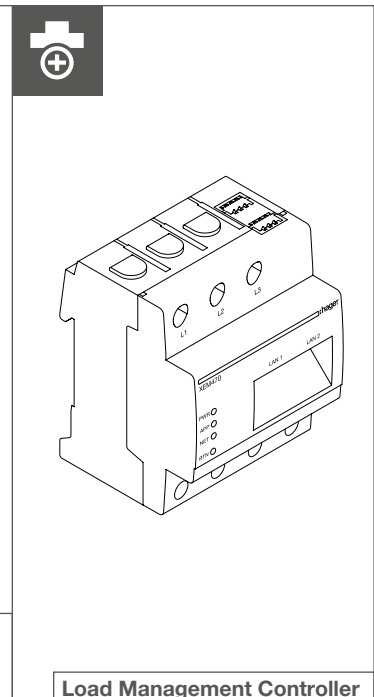
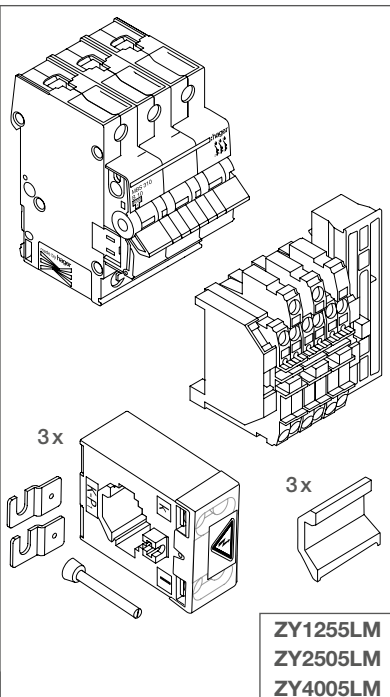
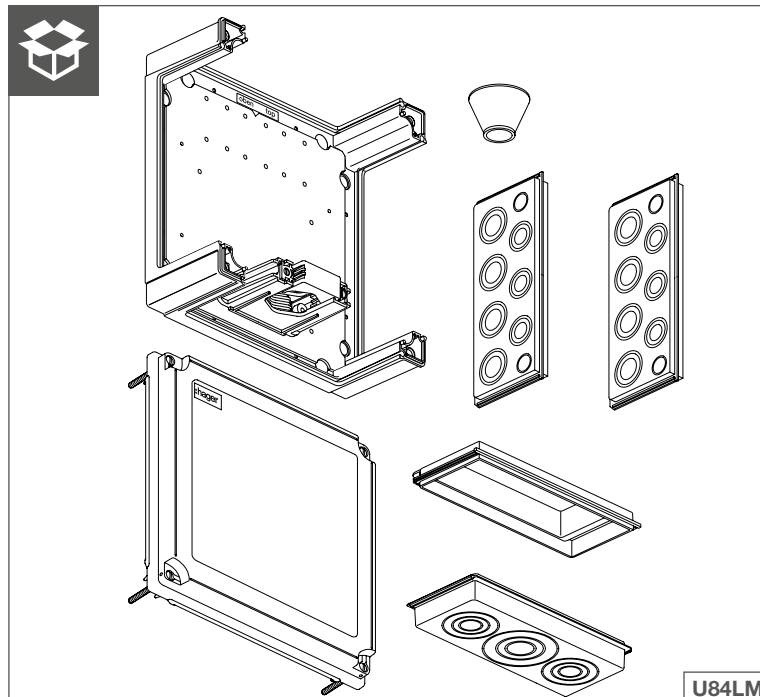
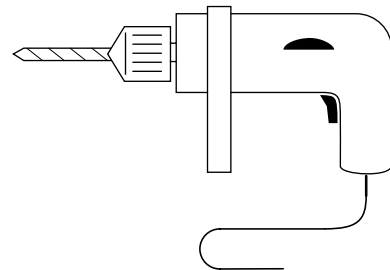
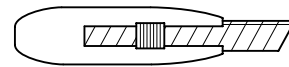
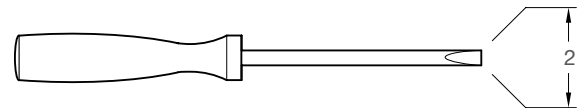
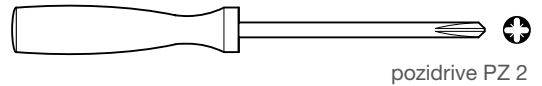
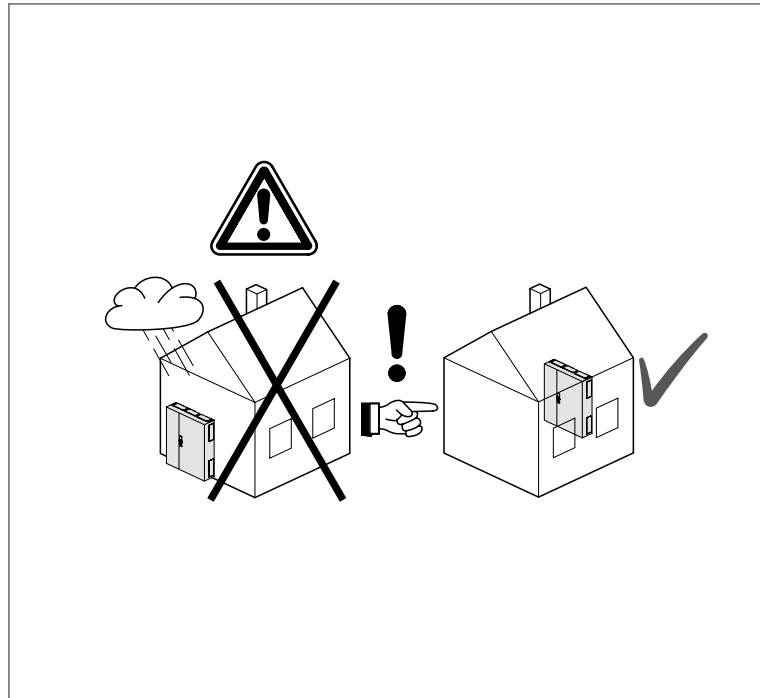

Montage von Kabelanschlusskasten und Wandler

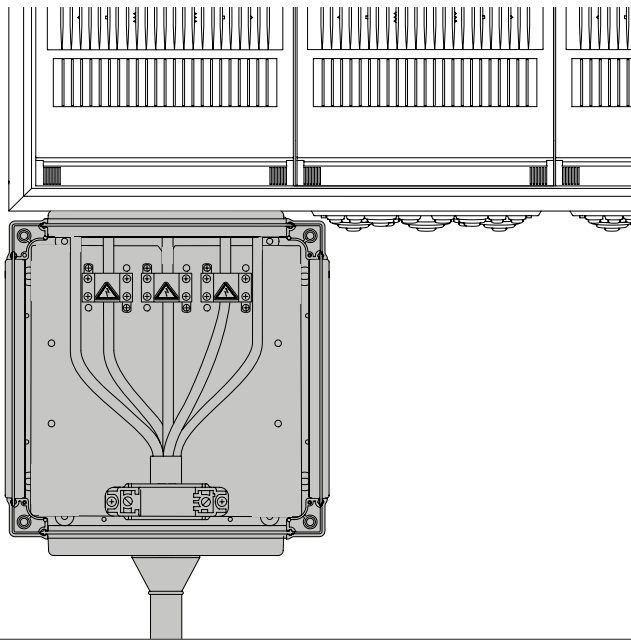

01

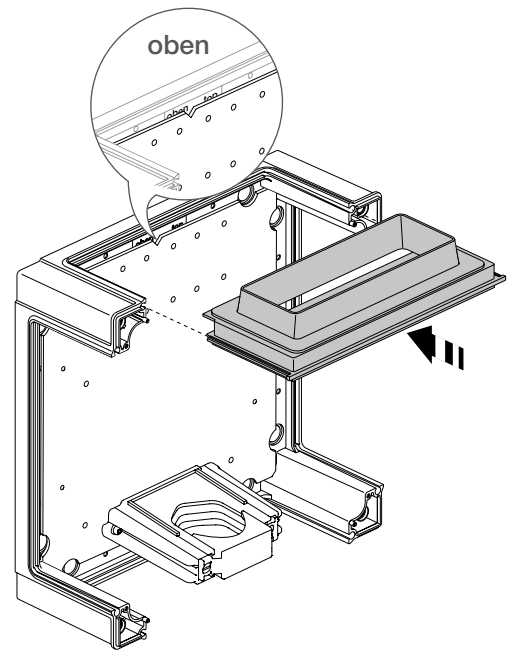

02

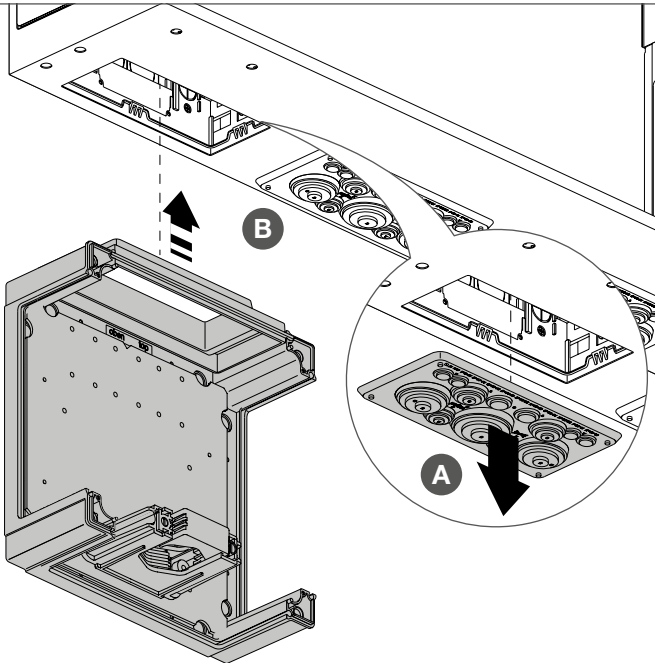

03

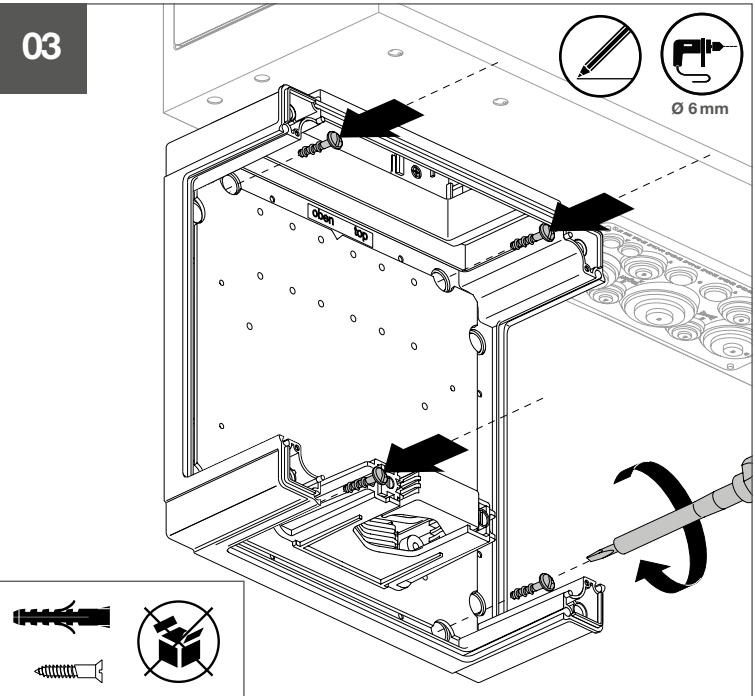

04

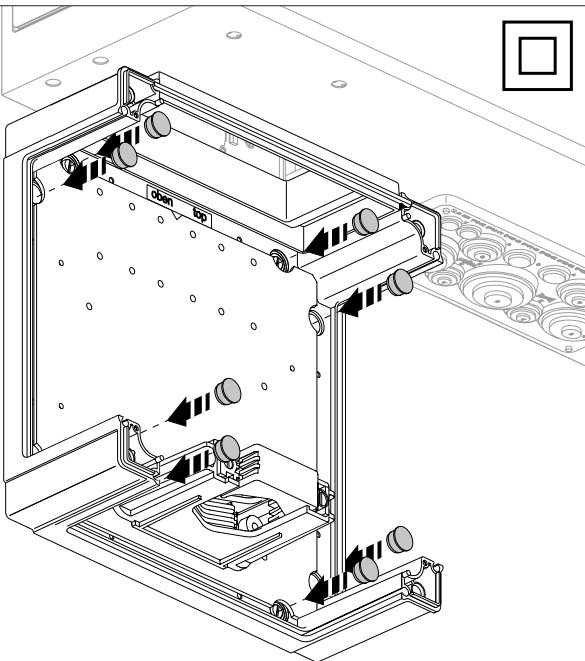

05

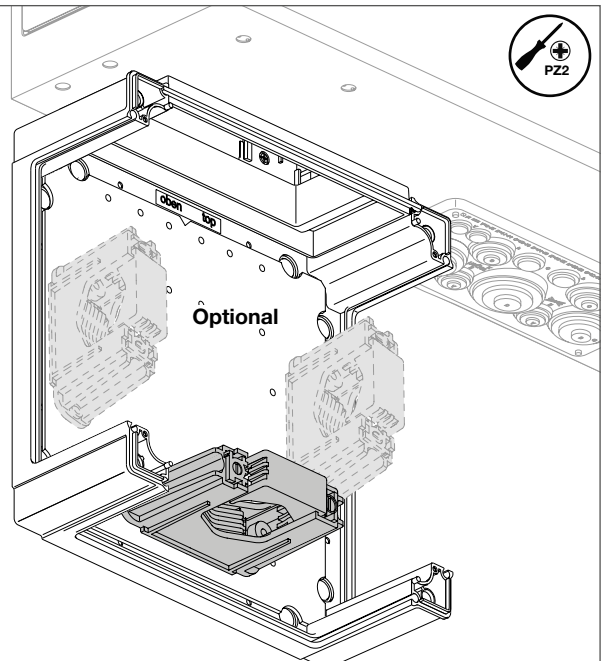

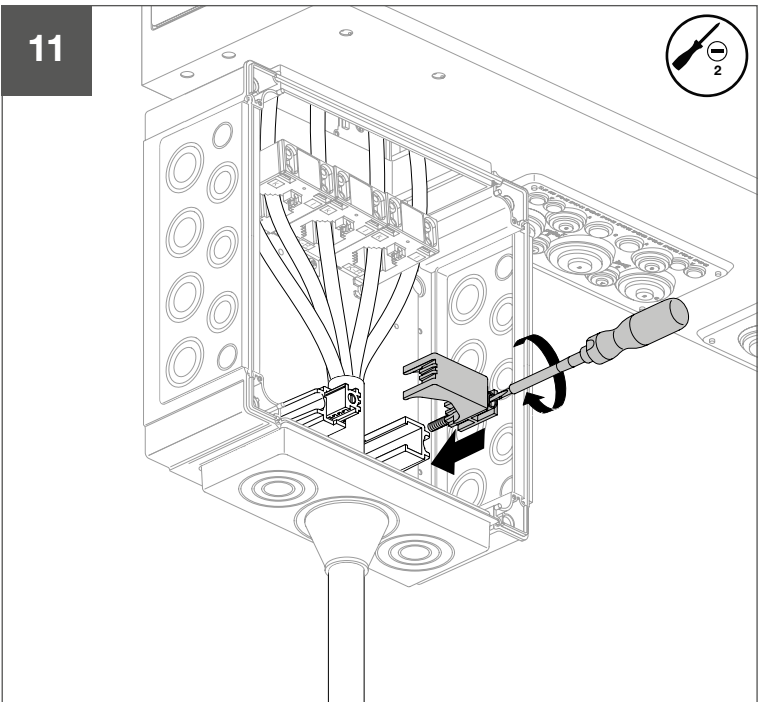
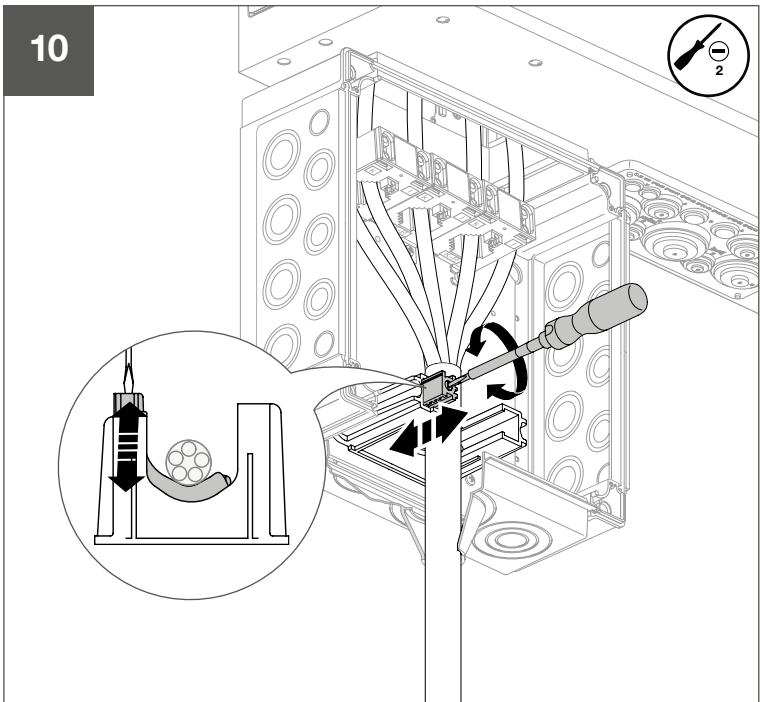
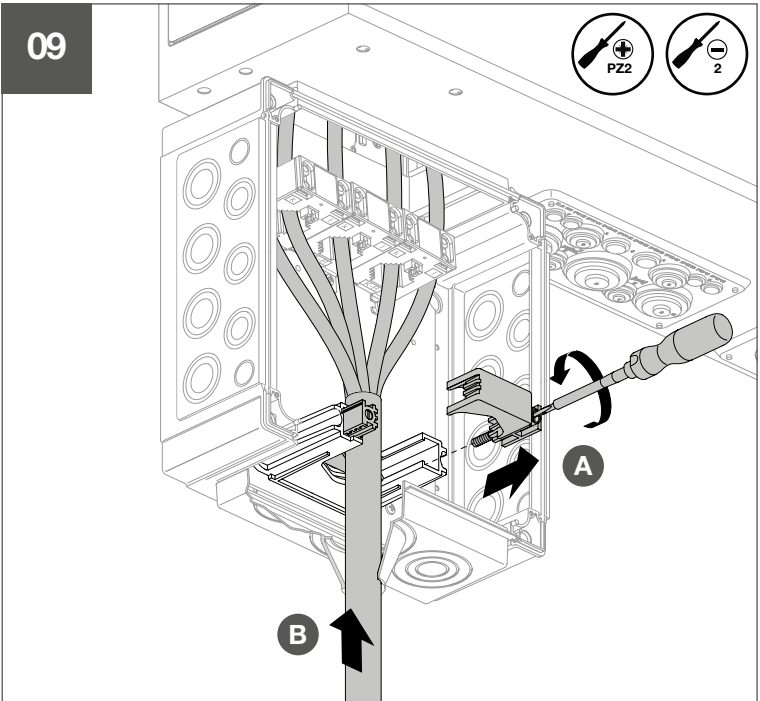
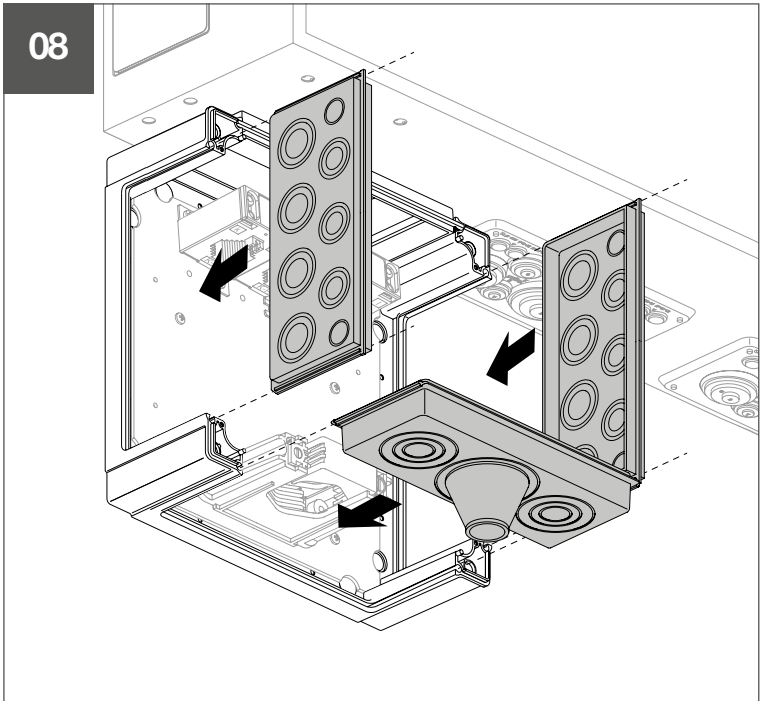
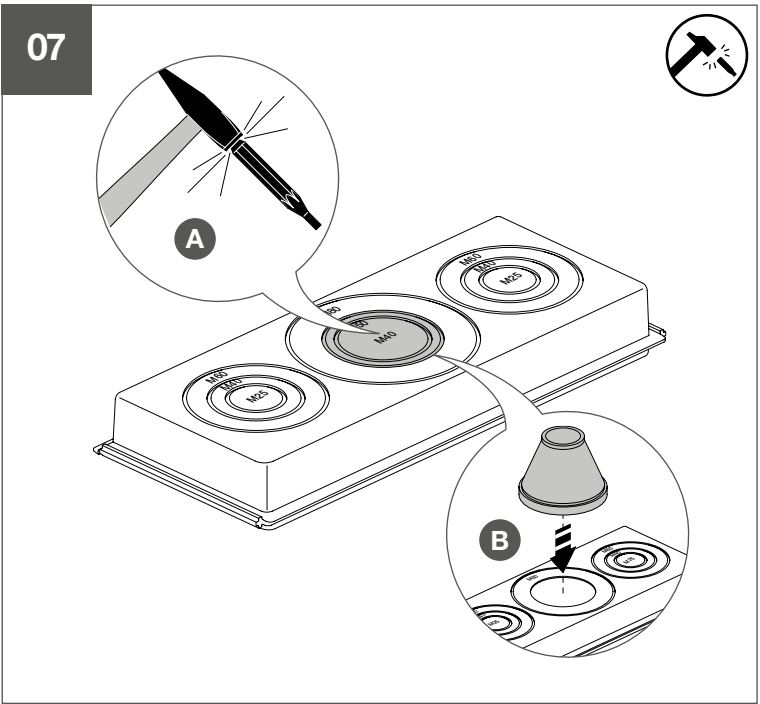
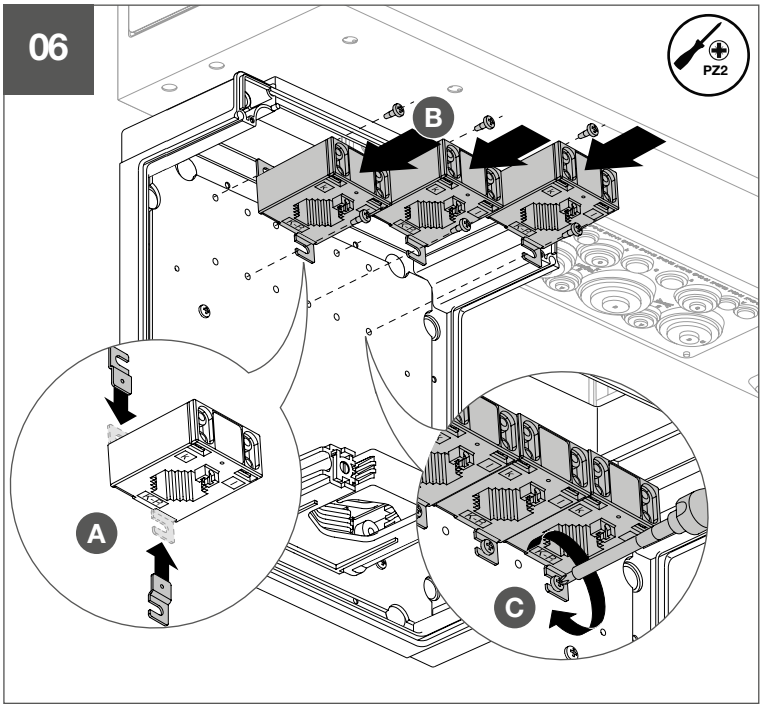

Sekundärleitung verlegen: Wandler und Reihenklemme anschließen

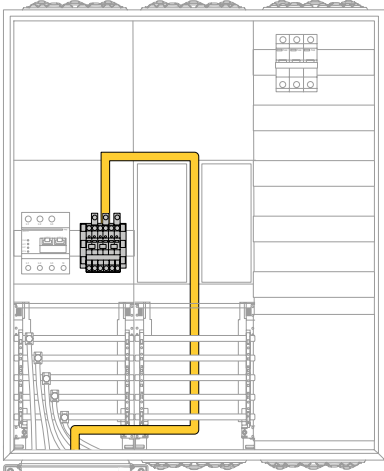

Leitungsquerschnitt	max. Kabellänge
6 x 2,5 mm ² Cu	2,5 m
6 x 4,0 mm ² Cu	4 m

01

0

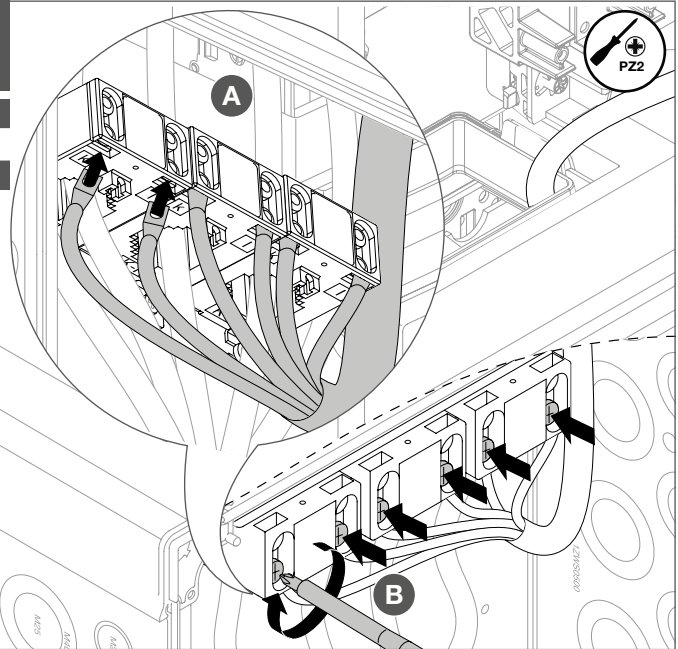

• Wandler sekundärseitig anschließen

02

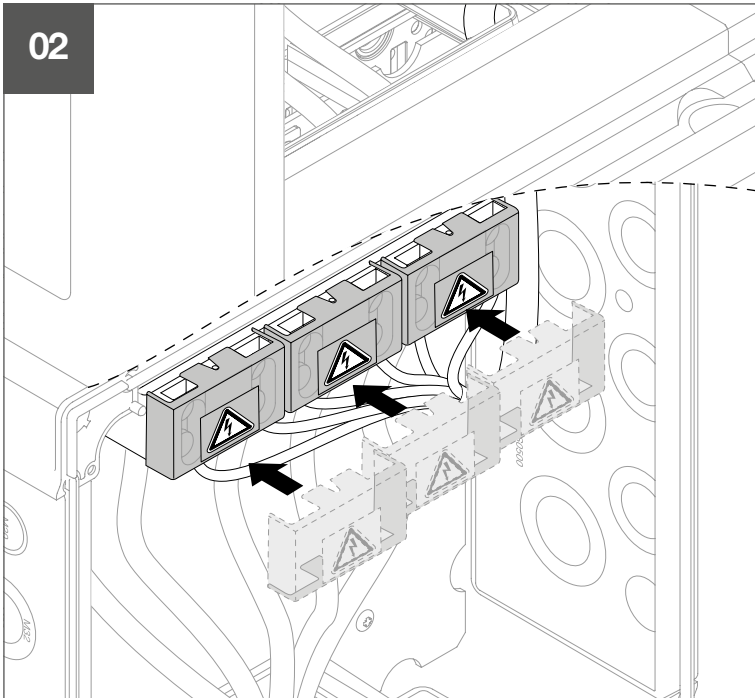

03

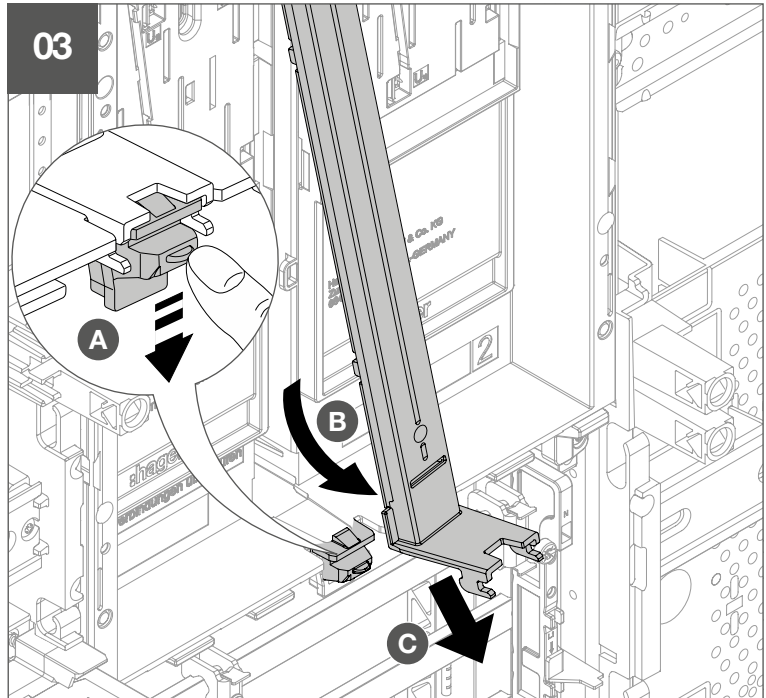

04

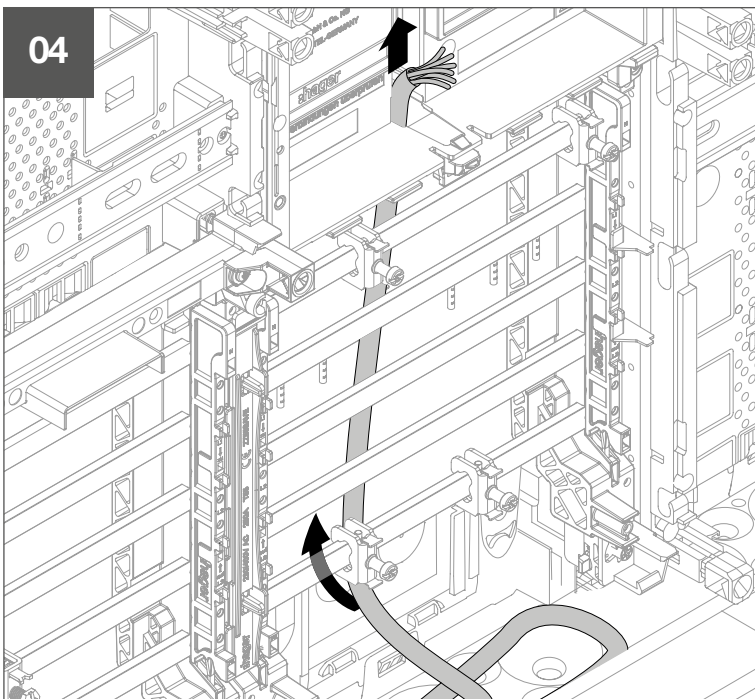

05

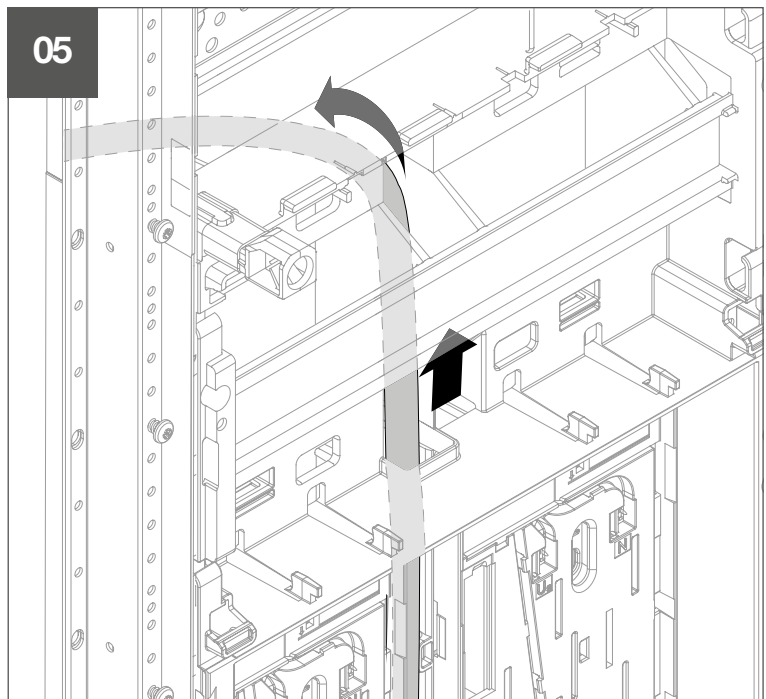

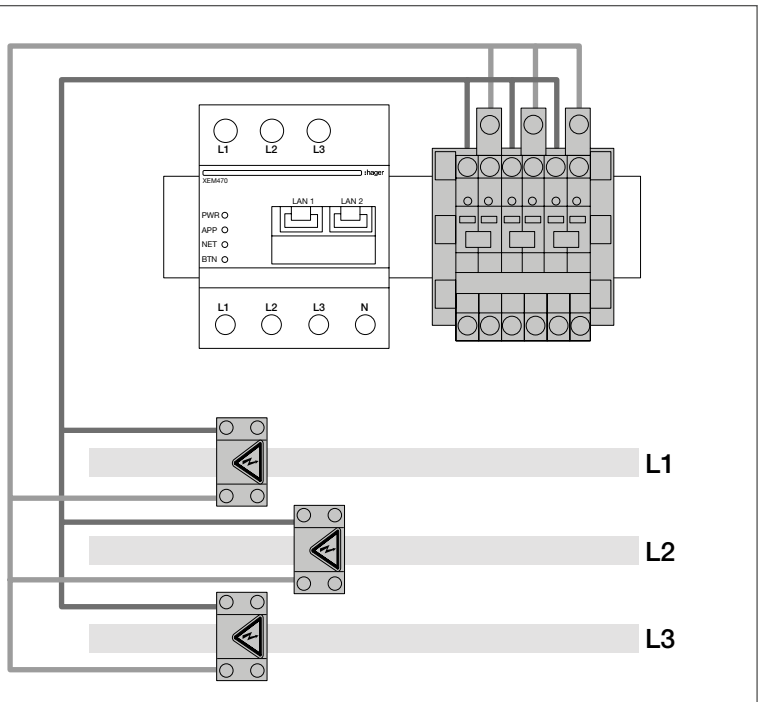
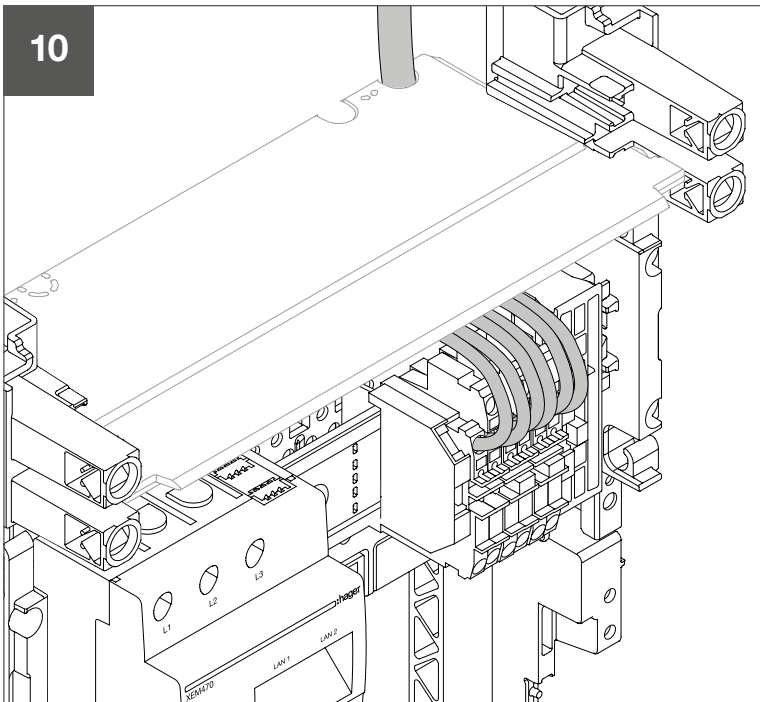
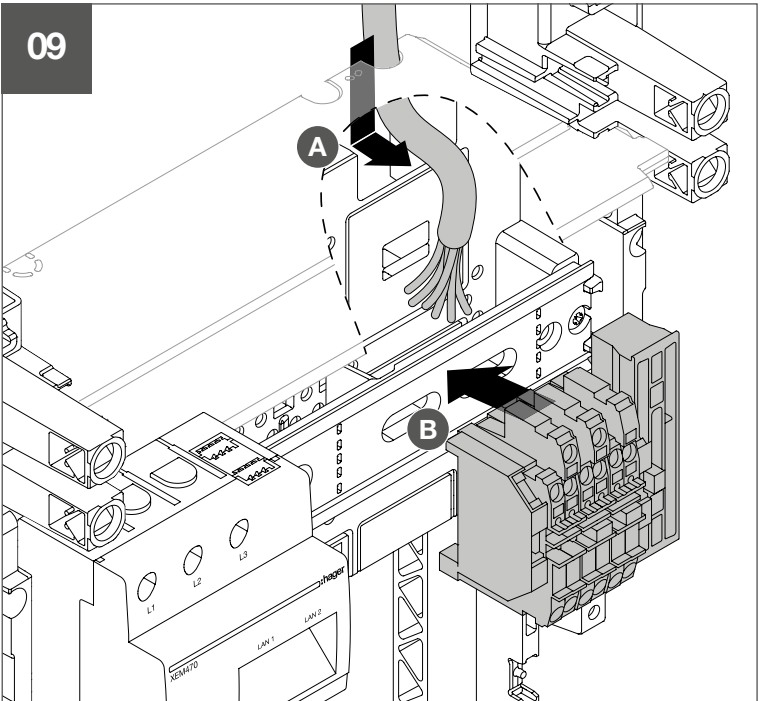
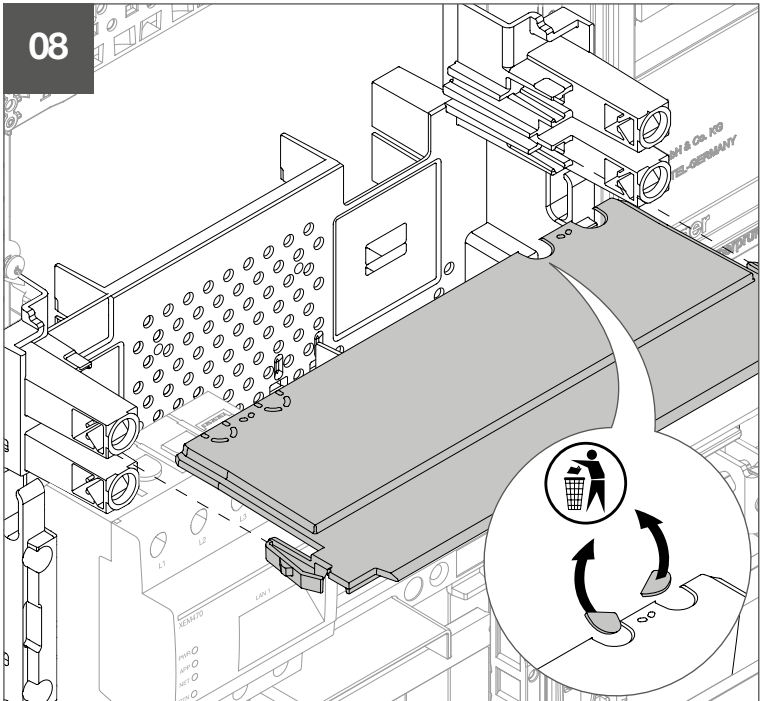
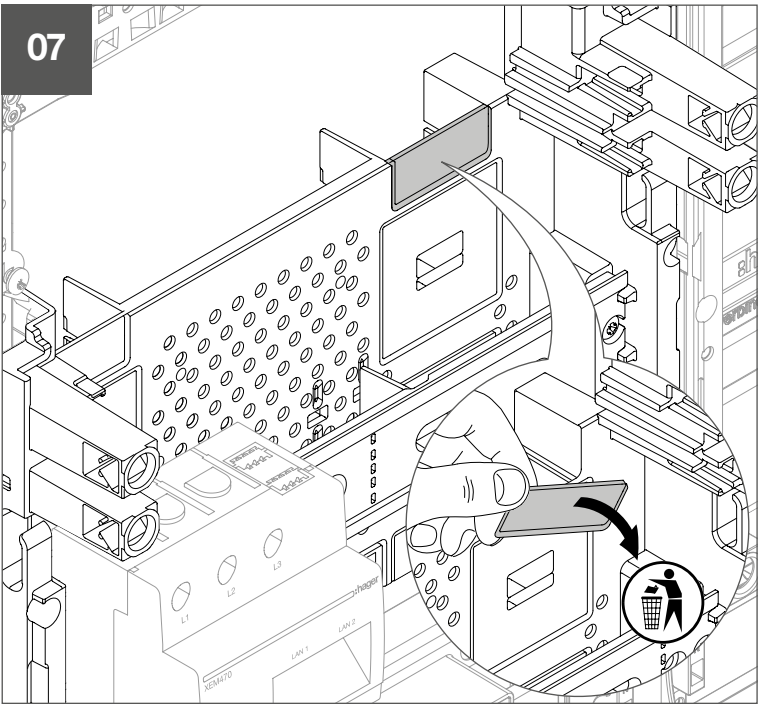
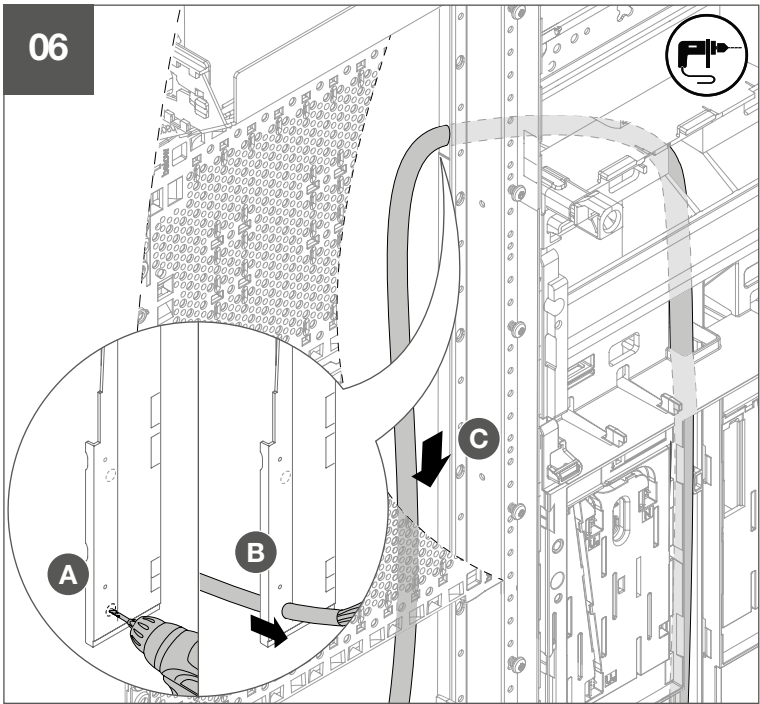

Leitung Spannungspfad verlegen und anschließen

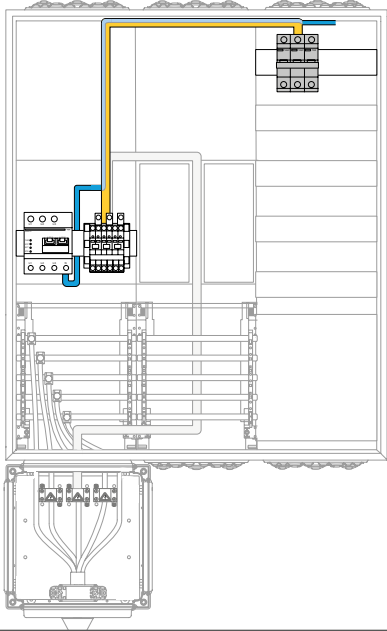

01

0

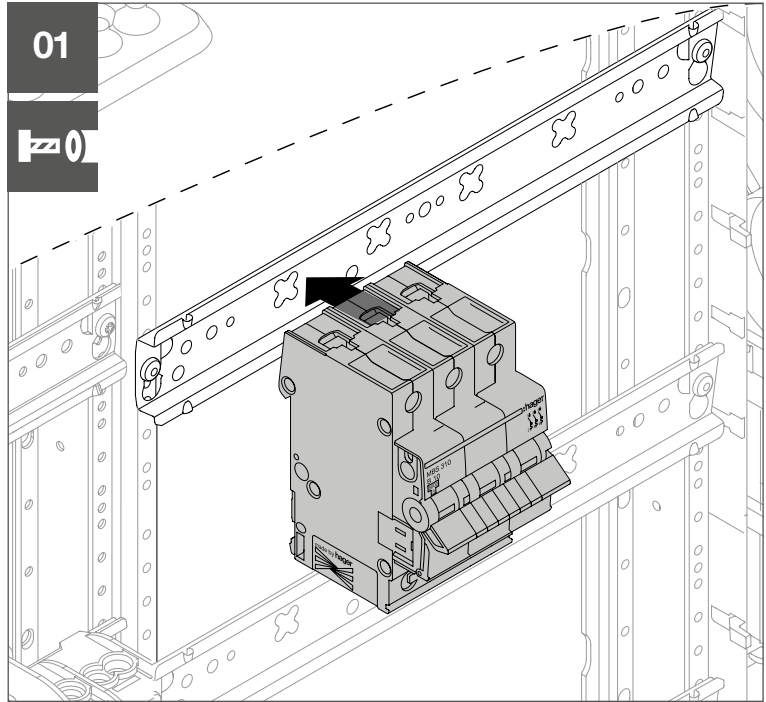

02

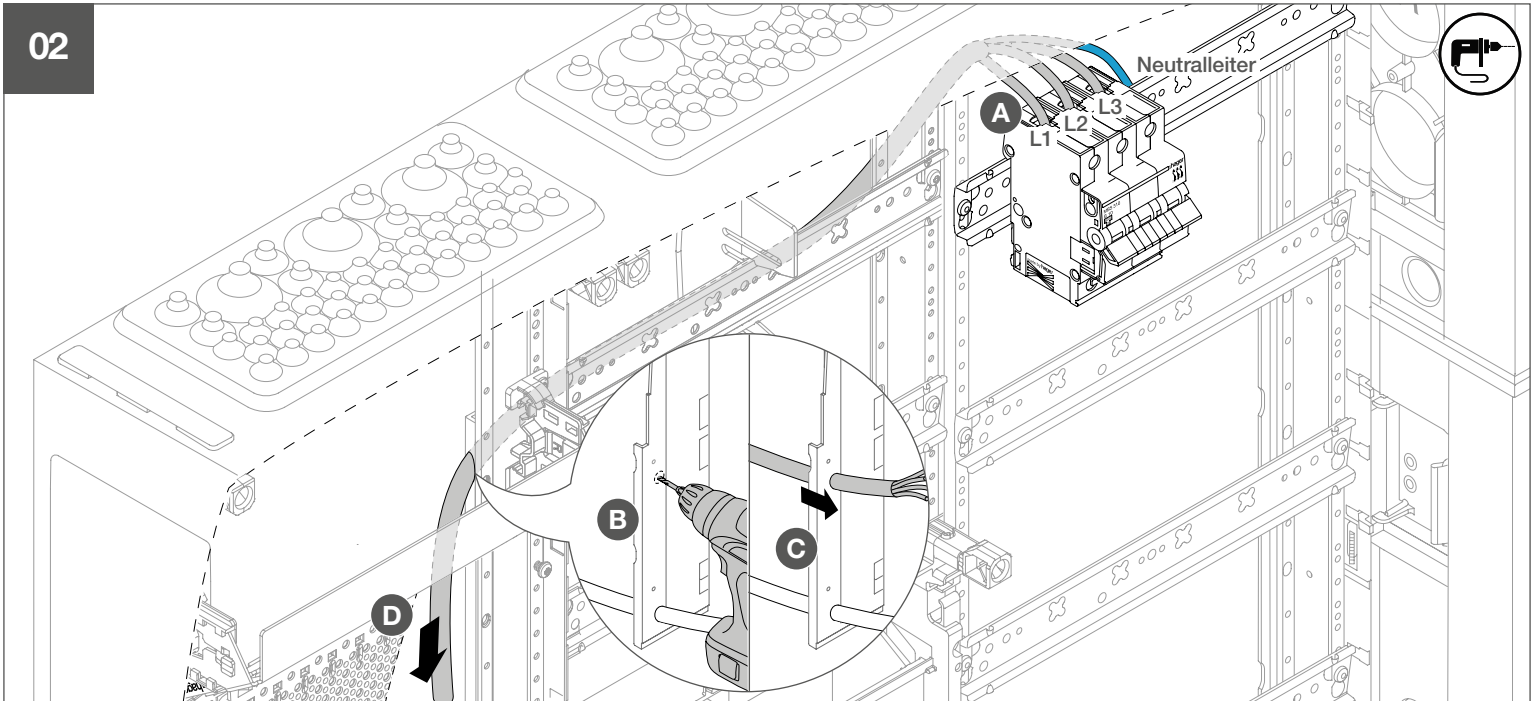

03

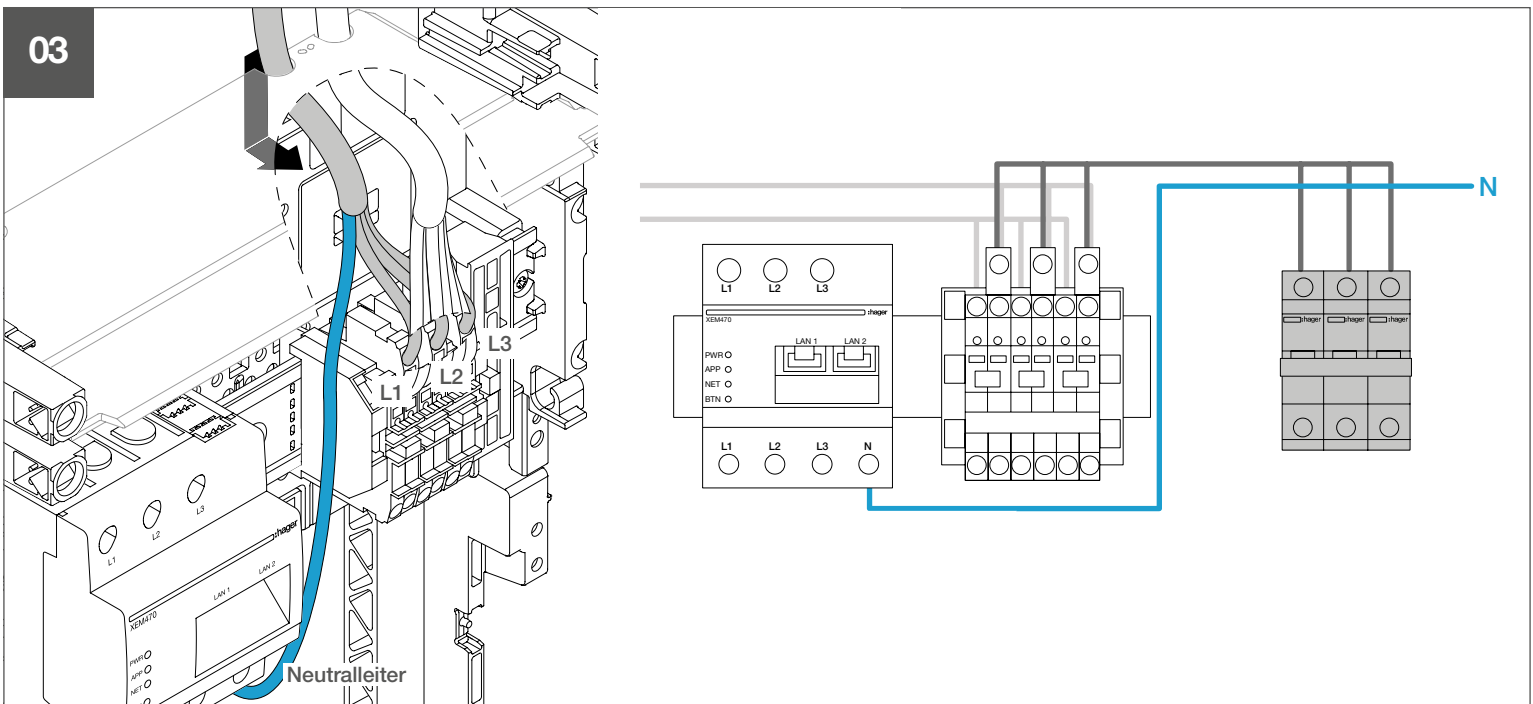

Verdrahtung Reihenklemme zu Loadmanager

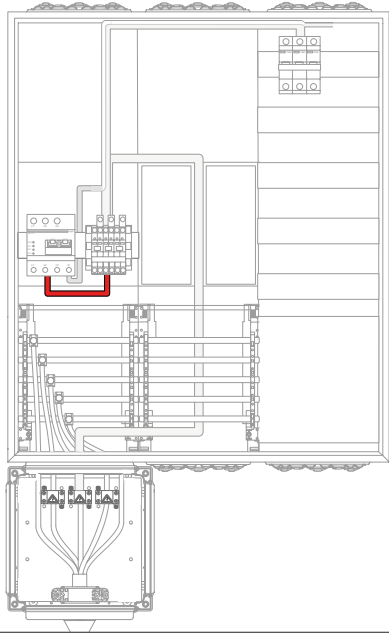

01

0

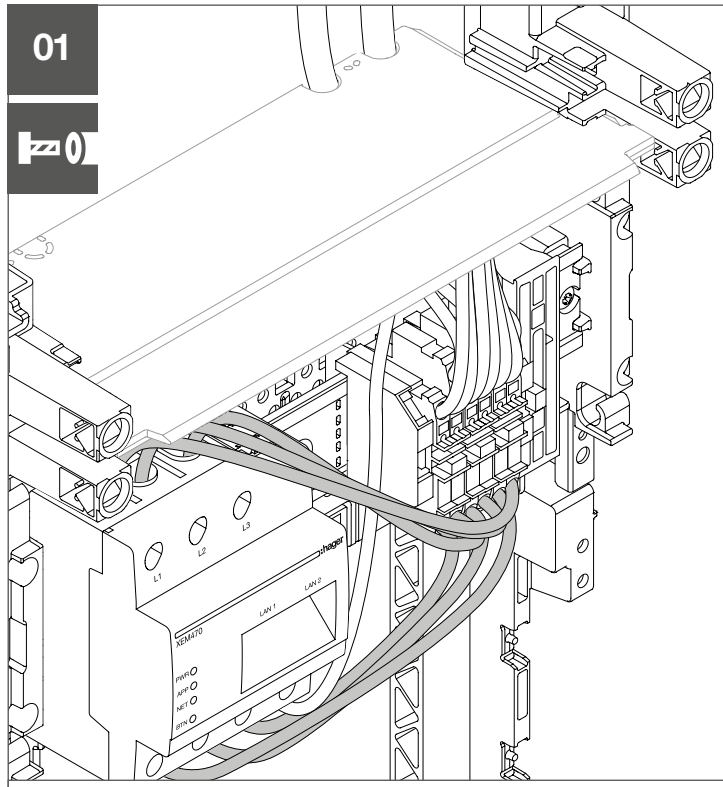

● Loadmanagement-Controller mit den Reihenklemmen verbinden

02

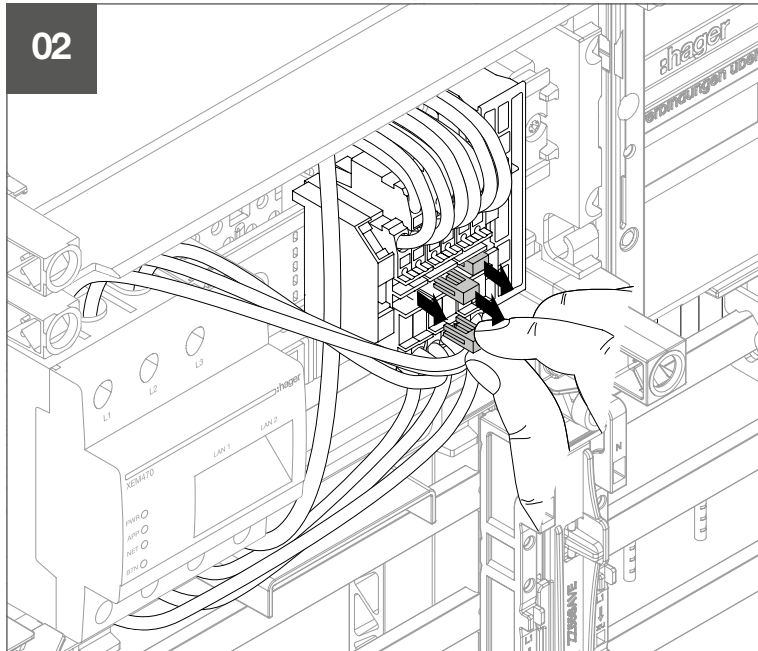

● Vor Inbetriebnahme Brücken entfernen

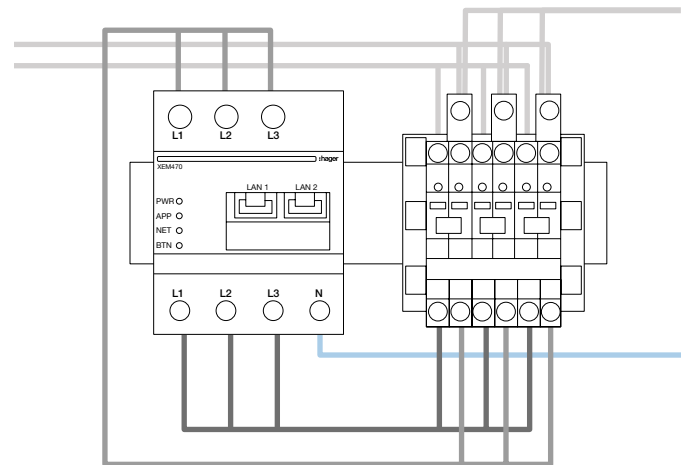

03

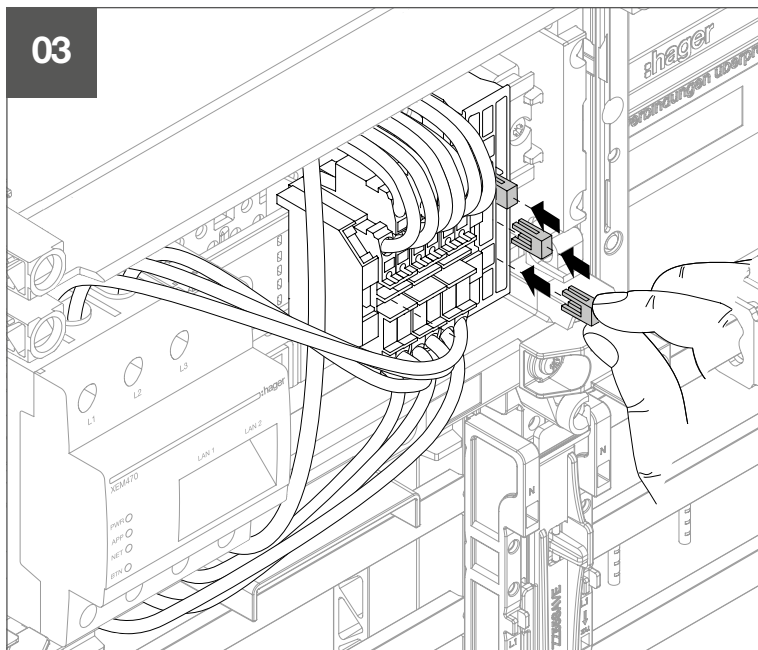

● Brücken zur Wiederverwendung in Parkposition stecken

Wandler im NAR auf Sammelschienen montieren

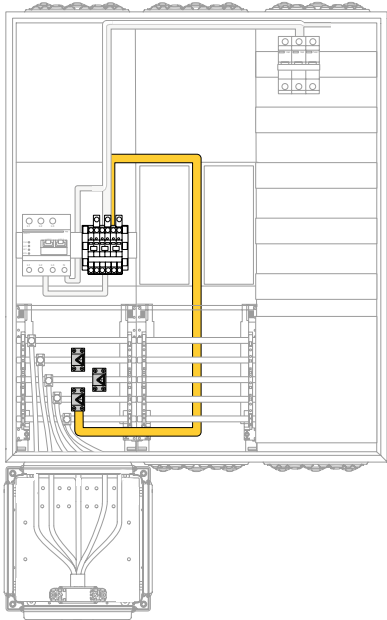

01

0

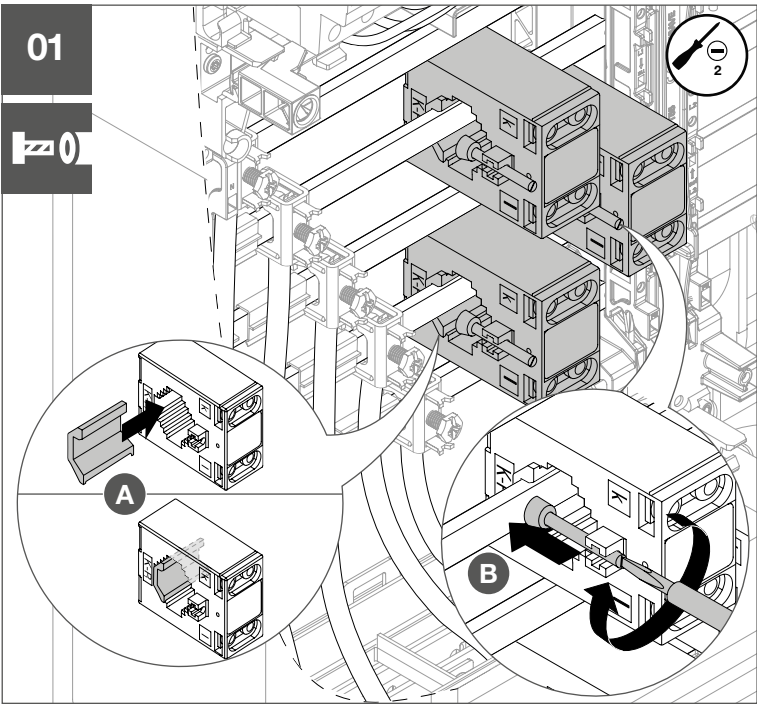

02

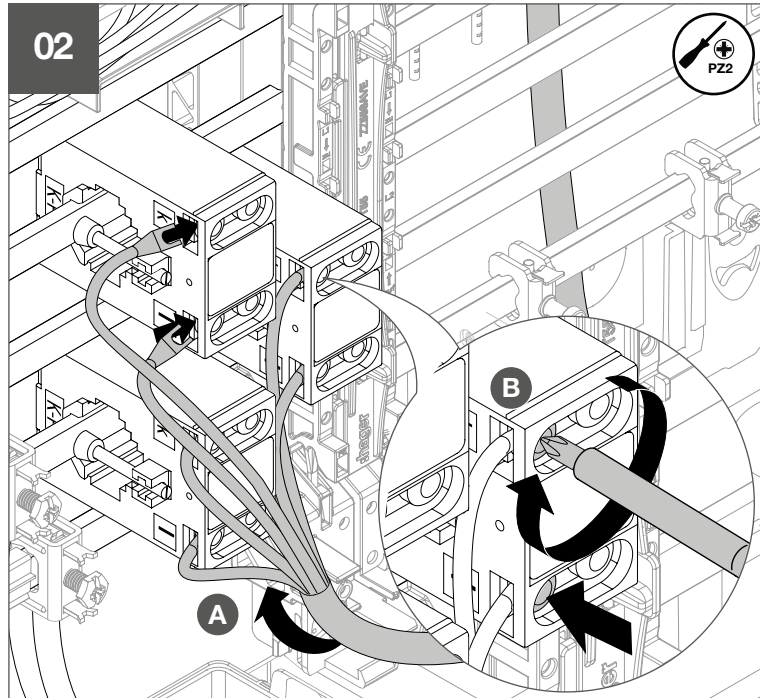

03

