

TerCia BDS-C45

Boîtes de sol à équiper, à clipsage 45

TerCia BDS-C45

Dimensions

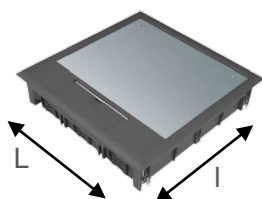

Code	Lxl (mm)
B45410	219x219
B45414	272x219
B45418	263x263
B45440	219x219
B45444	272x219
B45448	263x263

TerCia BDS-C45

Dimensions d'encastrement

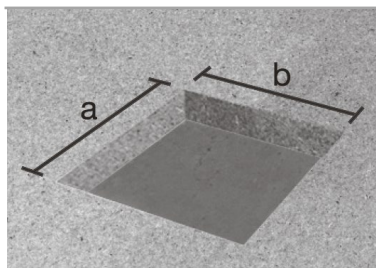

Code	a	b
B45410	200	200
B45414	200	253
B45418	244	244
B45440	200	200
B45444	200	253
B45448	244	244

TerCia BDS-C45

Réglage en profondeur des supports



Profondeur	A	B	C	D
mm	39,85	45,85	51,85	57,85

TerCia BDS-C45

Profondeur d'encastrement min.



Code	A	Code	A
B45410		B45440	
B45414	80	B45444	87
B45418		B45448	

Support appareillages TerCia BDS-C45

Composition

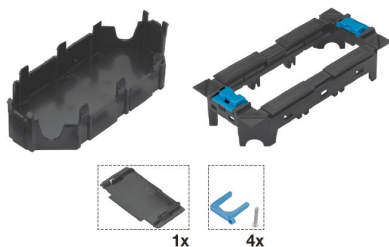

Support appareillages TerCia BDS-C45

Dimensions

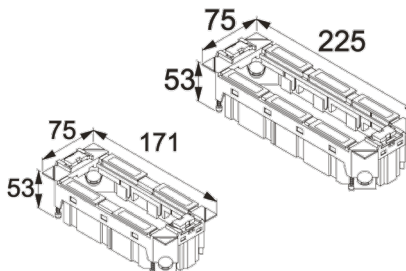

TerCia BDS-C45

Dimensions de la fiche

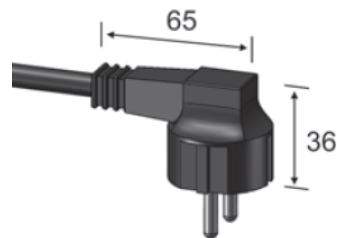

TerCia BDS-C45

Boîtes de sol à équiper, à clipsage 45

Kit réservation béton

Support de réservation
B45460

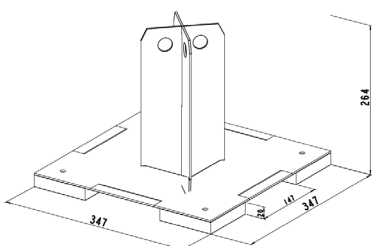

Boîte de réservation
B45461

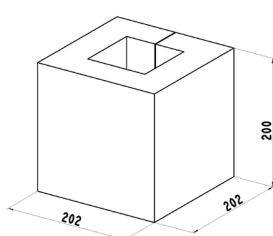

Boîte de réservation
B45462

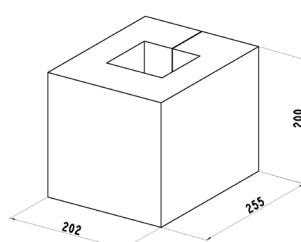

Boîte de réservation
B45463

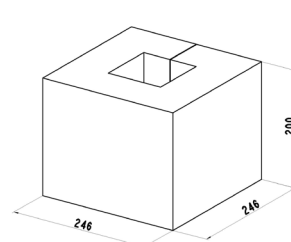

Notice d'utilisation Kit de réservation béton – 1/2

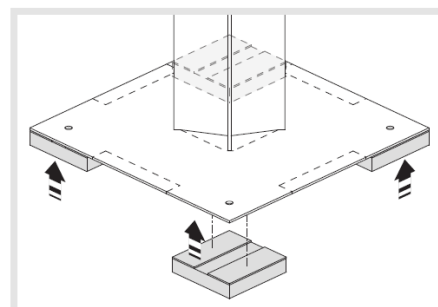
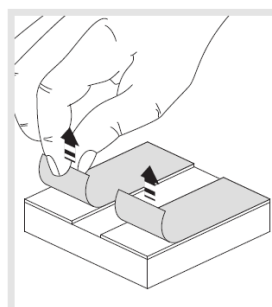
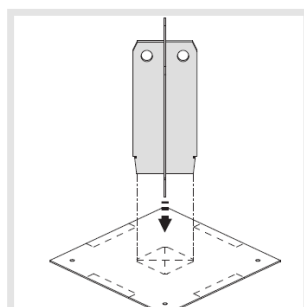
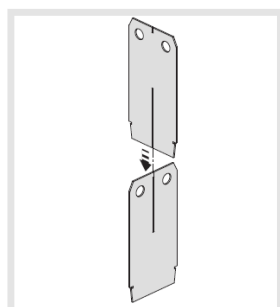
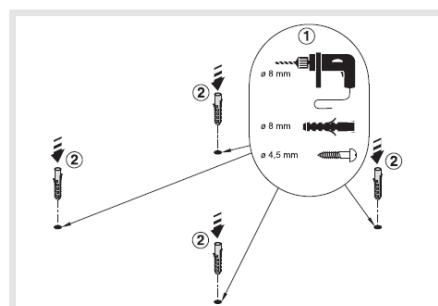
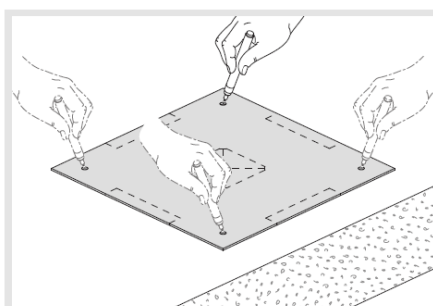
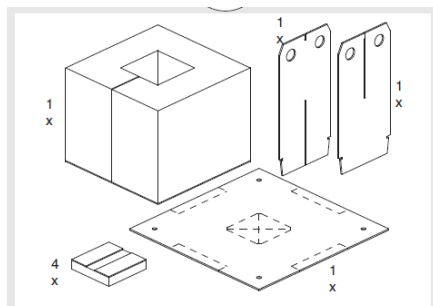

TerCia BDS-C45

Boîtes de sol à équiper, à clipsage 45

Notice d'utilisation Kit de réservation béton – 2/2

