

2980 xx, 2984 xx, 3080 xx, 3084 xx
Radio Touch

Radio Touch

Safety instructions

Electrical equipment must only be installed and assembled by a qualified electrician in accordance with the relevant installation standards, regulations, directives and safety and accident prevention directives of the country.

Failure to comply with these instructions may result in damage to the device, fire or other hazards.

Disconnect load before working on the device. Take into account all circuit breakers that supply dangerous voltages to the device.

These operating instructions are an integral component of the product, and must be retained by the end user.

Design and layout of the device

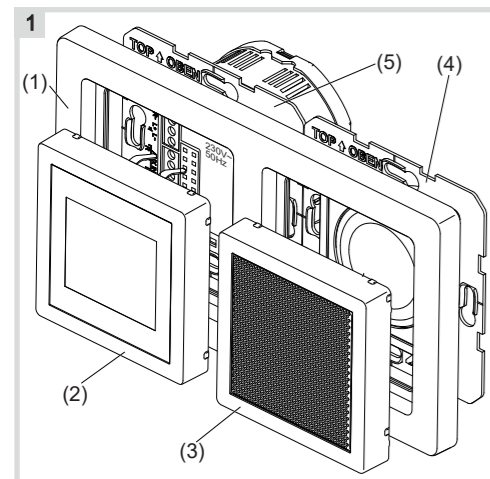

- (1) Frame 2gang
- (2) Radio Touch application module
- (3) Centre plate for loudspeaker
- (4) Loudspeaker insert
- (5) Radio Touch insert

Depending on variant, the scope of delivery for the radio set includes loudspeaker, design parts and fastening screws.

Function

The radio receives FM and DAB radio stations, can be streamed with Bluetooth audio devices and emits the audio signals via the connected loudspeakers.

Additional functions:

- Capacitive touch display
- Manual and automatic station search
- 8 FM and 8 DAB storage slots
- Display of reception frequency and RDS information
- Display of time and date in Standby mode
- Automatic date and time setting on RDS reception
- Alarm with radio or acoustic signal
- Timer (countdown) with acoustic signal when expired (also during radio reception)
- Sleep mode with automatic switch-off
- Hotel mode with limited functions can be activated
- Display brightness can be adjusted in 10 stages and with 8 times, black and white display can be inverted
- Extension unit connection, e.g. for switch, controller
- AUX-IN for external audio sources, e.g. smartphone or MP3 player to multimedia socket outlet

Correct use

- Only suitable for use in indoor areas
- Flush-mounting in wall box according to DIN 49073
- Radio and loudspeaker each mounted in a wall box

Operation

Operation of the radio solely using touch control panel. The touch surface (Figure 2) has a display and six symbol buttons.

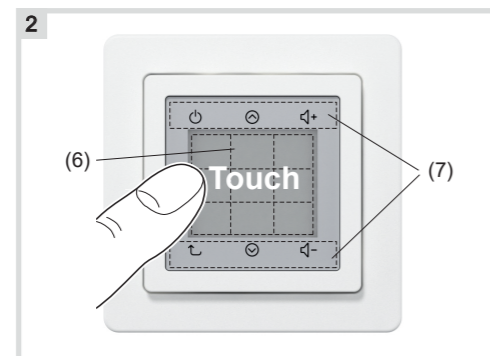

- (6) Touch display
- (7) Touch symbol buttons

Depending on the display, the touch display is divided into up to 9 control panels or shows a multi-line menu.

The six symbol buttons have fixed functions:

Symbol button	Function
	Switch on/switch off
	jump back to the higher-level operating level
	scroll up/increase value
	scroll down/reduce value
	increase volume
	decrease volume

Switching on the radio

The radio is in Standby mode, the time and date are displayed.

- Touch display or button .

The radio repeats the most recently selected station or switches the last function used on again.

In FM and DAB radio operation, details such as station type, name and frequency, song title, storage slot and type of playback are displayed, or alternatively the function.

Selecting menu item

The radio is switched on.

- Touch the button until main menu appears (Figure 3).



- Touch the button or the display.

The active display in the central operating panel - shown in bold - changes.

- Touch the active display with the desired menu item.

A new menu opens.

Longer lines of text are shown in a loop after a second's delay.

Configure settings

The menu item is selected - e.g. **Countdown**. The first setting is active - e.g. Hours **Hr**.

- Use the / button to set the desired number.
- Using the control panel, apply the number of another setting, e.g. **Min** or **Sec**, or save the settings with (figure 4) .

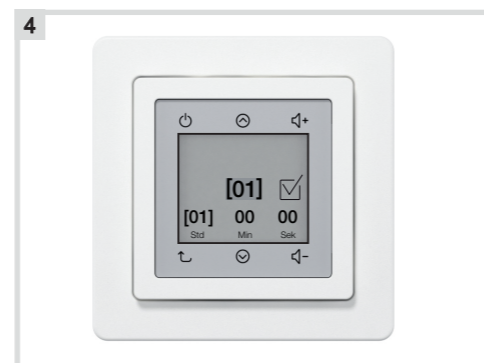

- Adjust other settings accordingly.

The active setting is displayed in square brackets.

Adjusting volume

The radio is switched on.

- Press / button.

The sound is played back louder/more quietly.

Alternatively, simply swipe up or down on the displayed volume bar during setting.

With control panel , switched to mute during volume setting.

Setting the date and time manually

The radio is switched on.

- Touch the button until main menu appears (Figure 3).
- Select the **Alarm and time** control panel with the / buttons and press it.
- Select **Date/time** with / and press it.
- Select **Manual** with / and press it.
- Using / , select the date format **EU / US** and, using another control panel, apply, e.g. **Year**.
- Using / , select the year and apply with **Month**.
- Using / , select the month and apply with **Day**.
- Using / , select the day and apply with **Hr**.
- Using / , select the hour and apply with **Min**.
- Using / , select the minutes and apply all settings with .

Setting the DAB stations

The radio is switched on.

- Touch the button until main menu appears (Figure 3).
 - Select the control panel **DAB+ Radio** using / and press it.
- The most recently set station is played back and shown in the display.
- Select the saved station using / and press it.

or:

- Go up one level using and select using / "New station" and press it.

The first station in the station list is played back and shown in the display.

- Select another station in the station list using / einen anderen Sender der Stationsliste wählen.

or:

- Save the station (see Saving stations).

Setting an FM station with automatic search

The radio is switched on.

- Touch the button until main menu appears (Figure 3).
- Select the control panel **FM Radio** using / and press it.
- Select the control panel **Automatic Search** using / and press it.

The first station to be found will be played back and shown in the display.

- Pressing continues the automatic search without saving.

or:

- Save the station (see Saving stations).

Setting an FM station with manual search

The radio is switched on.

- Touch the button until main menu appears (Figure 3).
- Select the control panel **FM Radio** using / and press it.
- Select the control panel **Manual Search** using / and press it.
- Increase/reduce the reception frequency in 0.1 MHz steps using / until a station is received without interference.
- Press to continue the manual search without saving.

or:

- Save the station (see Saving stations).

Saving stations

The searched for station is played back.

- Press the station display in the control panel.
- Press **Save**.
- Select the **New station** using / and press it to save.

or:

- Select the saved radio station with / and press it to overwrite.

Opening a saved station

The radio is switched on.

- Touch the button until main menu appears (Figure 3).
- Select the control panel **FM Radio** using / and press it.
- Select the saved station using / and press it.

Deleting stations

The station to be deleted is played back.

- Press the control panel with the station display.
- Delete this storage slot using **Delete**.

Connecting audio devices with Bluetooth

This function is only available in the radio with Bluetooth.

A maximum of 8 Bluetooth devices can be stored. Only one of them can be connected at a time.

The radio is switched on.

- Touch the button until main menu appears (Figure 3).
 - Select the control panel **Bluetooth** using / and press it.
 - Select the control panel **Connect** using / and press it.
- The display shows **Connect**.
- Connect to Bluetooth on the audio device.

The radio plays the audio signals sent by the audio device.

Setting the alarm

The radio is switched on.

- Touch the button until main menu appears (Figure 3).
- Select the **Alarm and time** control panel with the / buttons and press it.
- Select **Alarm** using / and press it.
- Select **On** using / and press it.
- If necessary, switch to **24h/AM/PM** display.
- Press the time to be set (hours or minutes). Set the time using / (Figure 2).
- Press and, using / , select and press a radio station or the electronic alarm signal.
- Press to apply the settings.

When the alarm is active and the radio switched off, the alarm symbol is displayed.

Alarm operations can be terminated using or moved by intervals of 5 minutes (snooze) by pressing another control panel.

Setting timer (countdown)

The radio is switched on.

- Touch the button until main menu appears (Figure 3).
- Select the **Alarm and time** control panel with the / buttons and press it.
- Select **Countdown** using / and press it.
- Press the time to be set (hours, minutes or seconds). Using / , set the time shown in brackets (Figure 4).
- If necessary, set additional times.
- Apply the time setting using and activate the countdown.

After the time has elapsed, an acoustic signal will sound - even if radio is being received.

The **Sleep Mode** function can be set accordingly.

Setting the language

- Touch the button until main menu appears (Figure 3).
- Select the control panel **Settings** using the / buttons and press them.
- Select the **Language** using / and press it.
- Select the appropriate language using / and press it.

The **Lighting**, **Default Settings** and **Audio** functions can be set in the same way.

Setting to external audio device (AUX IN)

- Touch the button until main menu appears (Figure 3).
- Select the control panel **External Input** using the / buttons and press them.

Activating/deactivating hotel mode

The radio is switched on.

- Press the and buttons for more than 10 seconds
- The display shows **Hotel mode on** and the menu items **FM Radio**, **DAB+ Radio**, **Bluetooth** and **Alarm** can be selected.

Information for electricians

Installation and electrical connection



DANGER!

Electrical shock when live parts are touched!

An electric shock can lead to death!

Before working on the device or load, disconnect all associated circuit breakers. Cover all live parts in the area!



CAUTION!

This product contains electrostatically endangered components.

The device may get damaged!

Do not touch the connecting socket of the flush-mounted insert when the device is installed.

Connecting radio to lead (Figure 5)

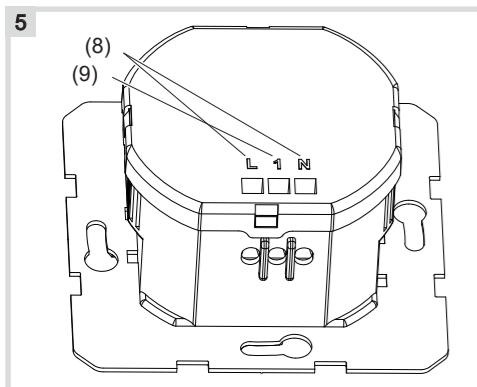

- (8) 230 V~ lead
- (9) Extension unit

The lead is protected by means of a circuit breaker (max 16 A).

- Connect the 230 V~ lead to the L and N terminals (Figure 5, 8).

Connect extension unit (optional)

- If necessary, connect the extension unit (Figure 5, 9).

Switches, controllers and timers are suitable as extension units. The same phase should be used as for the radio (Figure 6).

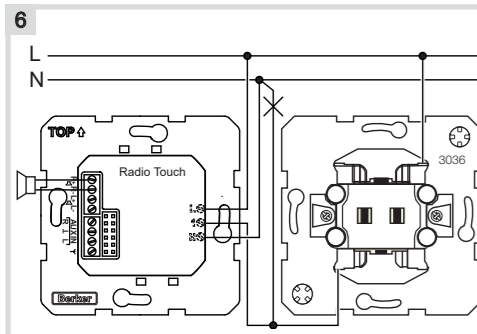

Do not connect the load cable directly to the extension unit terminal but connect it directly to the switch or in connection boxes.

Interference pulses can occur when switching electronic transformers, ballast, energy saving and LED lights to the extension unit input. We recommend wiring the extension unit input with a separate contact e.g. with a 2-pole switch or additional relay.

Connecting loudspeakers



DANGER!

If the loudspeakers are connected to the operating voltage in a shared cable, the operating voltage can reach the loudspeaker cables.

Electric shock possible through touching the loudspeaker cable.

An electric shock can lead to death.

Route a separate loudspeaker wire.

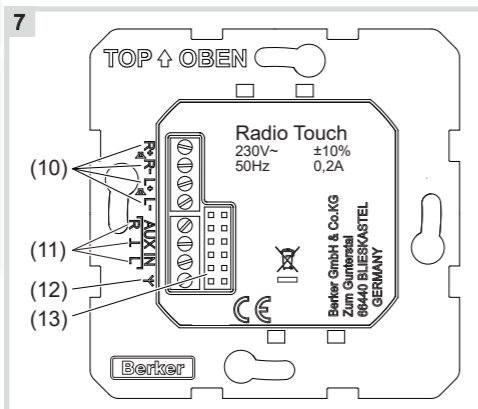

Connections on the radio insert (Figure 7) for:

- (10) Loudspeaker (L, R)
- (11) external audio devices **AUX IN**
- (12) Aerial
- (13) Radio application module (12-pole jack)

At least one loudspeaker must be connected for radio operation.

- Connect the loudspeaker to the terminals \square + (red) and \square - (white) (Figure 7, 10).

Wires must be mounted in such a way, e.g. with cable ties, that a detached wire will not touch another potential in the event of a fault.

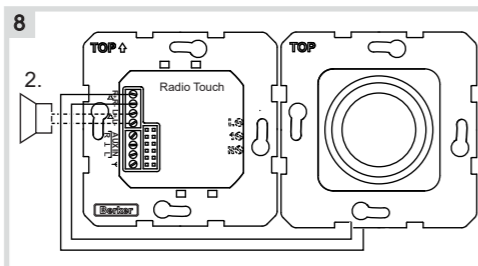

In stereo mode with 2 loudspeakers (Figure 8), the control panel with the station display can be used to switch manually to mono operation.

Connect external aerial

For standard-compliant FM and DAB+ reception, the radio must be operated with an external aerial wire connected to the terminal Υ .

Recommended wire length for reception of both FM and DAB+: 75 cm (corresponds to a lambda/2 dipole for DAB+).

Recommended wire length for optimized reception of DAB+: 40 cm (corresponds to a lambda/4 dipole).

Recommended conductor cross-section: 0.75 mm².



The wire and the tip of the aerial must be fully insulated from the terminal point!

- Prepare insulated aerial wire and connect to the terminal Υ (Figure 7, 12).
- Recommendation: Lay in a separate wiring conduit, stretched out, not parallel to other lines.

The aerial wire must be mounted in such a way within the wall box, e.g. with cable ties, that a detached wire will not touch another potential in the event of a fault.

Connecting an external audio device (optional)

- Connect an external audio device **AUX IN**, if necessary (Figure 7, 11).

Use shielded wires for interference-free signal transmission. Connect the shield to the terminal \perp according to the terminal labelling.

Assembly of the devices (Figure 1)

The inserts are connected.

- Insert the inserts (Figs. 1, 4 and 5) correctly into the wall boxes and fasten them with the screws provided.
- Place the 2gang frame (Figure 1, 1) over the inserts and attach the Radio Touch application module (Figure 1, 2) and the loudspeaker centre plate (Figure 1, 3).

Carefully guide the contact pins on the radio application module into the socket (Figure 7, 13) on the insert without bending them.

Assemble the Radio Touch and loudspeaker separately with two 1gang frames or in combinations.

In combinations or in the immediate vicinity of electronic devices (e.g. ballasts), radio reception can be disturbed. Before installation at the assembly location, put the radio into operation and test it for interferences. In case of interference, increase the distance to the source of interference.

Radio commissioning

The radio is assembled.

- Switch the operating voltage on.
- Select the required language from the list and press it.

A list of all DAB+ stations received is automatically created and the date and time are updated.

If no station is received, **Manual** must be selected (see Setting time and date manually).

When using 2 loudspeakers, both loudspeakers should be activated under **Settings, Audio**.

Appendix

Technical data

Radio Touch

Operating voltage	230 V~, 50/60 Hz
Nominal current	0.2 A
Power consumption at rated output power	7 W
Stand-by operation	< 1 W

Rated output power (sine) per channel	2,1 W at 4 Ω @ 0.5% THD 1 kHz 1.5 W
---------------------------------------	---

Loudspeaker impedance	4 ... 8 Ω /channel
Input impedance AUX IN	10 k Ω
Frequency range DAB+	174 ... 240 MHz
Frequency range FM	87,5 ... 108 MHz
Operating temperature	5 ... 40 °C
Degree of protection	IP20

Connecting terminals mains connection	screw terminals max. 2.5 mm ²
Connecting terminals loudspeaker/AUX	max. 1 mm ²

Cable lengths:

Loudspeaker	max. 20 m
AUX IN	max. 3 m
Extension units	max. 50 m
Installation depth	33 mm

Only for radios with Bluetooth function:

Transmission frequency Bluetooth	2.4 ... 2.483 GHz
Bluetooth version	4.2
Internal reach	max. 10m
Bluetooth transmission output	max. 10 mW

Loudspeaker (2882 xx)

Loudspeaker impedance	4 Ω
Sine output/music output	3/4 W
Frequency range	170 Hz ... 18 kHz
Pre-assembled cable	approx. 25 cm
Installation depth	35 mm

Accessories

Loudspeaker	2882 xx
USB/3.5 mm audio socket outlet	33 1539 xx
3 x Cinch/S-Video socket outlet	33 1532 xx

Warranty

We reserve the right to realise technical and formal changes to the product in the interest of technical progress.

Our products are under guarantee within the scope of the statutory provisions.

If you have a warranty claim, please contact the point of sale.

This device complies with EU Directive 2014/53/ EU. The declaration of conformity and further system information can be accessed at hager.com.

The device may be operated in all EU and EFTA states (excluding Switzerland and Liechtenstein).

"The Bluetooth®-word mark and logos are registered trademarks of Bluetooth SIG Inc. Any use of these marks by Hager are subject to licensing. Other trademarks and brand names are the property of the respective owners."

Correct disposal of this product (electrical waste).

(Applicable in the European Union and other European countries with separate collection systems).

This marking shown on the product or its documentation indicates that it should not be disposed of with other household waste at the end of its working life. To prevent possible harm to the environment or human health from uncontrolled waste disposal, please separate this device from other types of waste. Recycle the device responsibly to promote the sustainable reuse of material resources.

Household users should contact either the retailer where they purchased this product, or their local government office, for details of where and how they can take this device for environmentally safe recycling.

Business users should contact their supplier and check the terms and conditions of the purchase contract. This product should not be mixed with other commercial waste for disposal.

Usable in all of Europe, except Switzerland and Liechtenstein