

476-015-004b

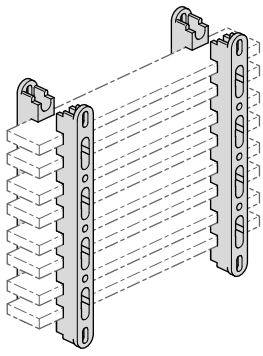

- (DE) Montageanleitung
- (FR) Notice d'instructions
- (GB) Mounting instructions
- (NL) Montage instructie
- (DK) Monteringsvejledning
- (FI) Asennusohje
- (NO) Montasjeanvisning
- (SE) Monterings instruktioner
- (IT) Istruzioni di montaggio
- (ES) Instrucciones de montaje
- (PT) Instruções de montagem
- (CZ) Montážní návod
- (BA) Uputstvo za montažu
- (HR) Upute za montažu
- (HU) Szerelési útmutató
- (LT) Montavimo instrukcija
- (LV) Montāžas instrukcija
- (PL) Instrukcja montażowa
- (RO) Instrucțiuni de montare
- (SK) Návod na montáž
- (RU) Инструкция по монтажу
- (BG) Инструкции за монтаж
- (GR) Οδηγίες χώνευσης
- (SI) Navodilo za montažo
- (EE) Paigaldusjuhised
- (IS) Leiðbeiningar
- (AR) دليل التركيب

Sammelschienenenträger UST4 Support de barres UST4 Bus bar support UST4

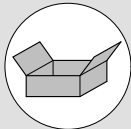
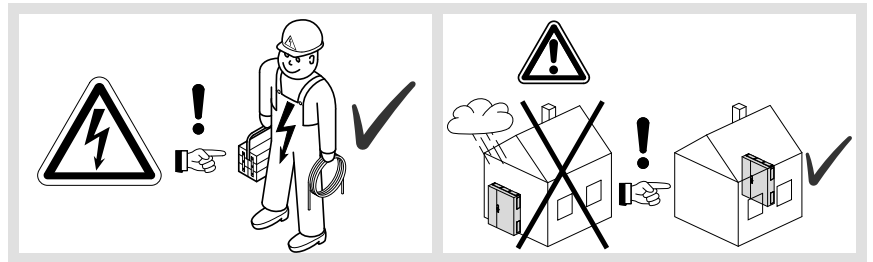

1 UST42x20x10; 776-020-024

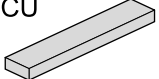
| CU | Phasen- mitten- abstand | | |
|---|-------------------------------|-------------|--------------|
|  | 50 | 776-020-024 | UST4-2x20x10 |
| 1 x 20 x 10 mm | 50 | 776-020-024 | UST4-2x20x10 |
| 2 x 20 x 10 mm | 50 | 776-020-034 | UST4-2x30x10 |
| 2 x 30 x 10 mm | 50 | 776-020-044 | UST4-2x40x10 |
| 2 x 40 x 10 mm | 50 | 776-020-054 | UST4-1x50x10 |
| 1 x 50 x 10 mm | | | |

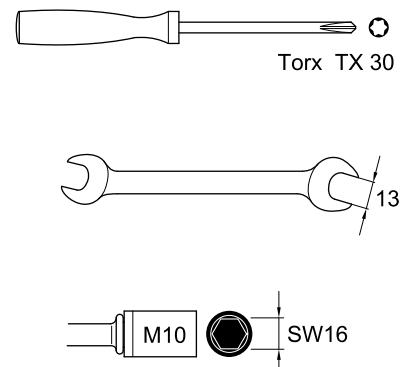

2

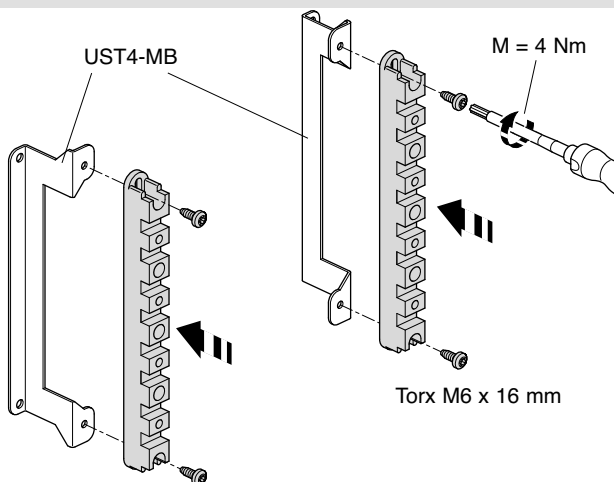

3a

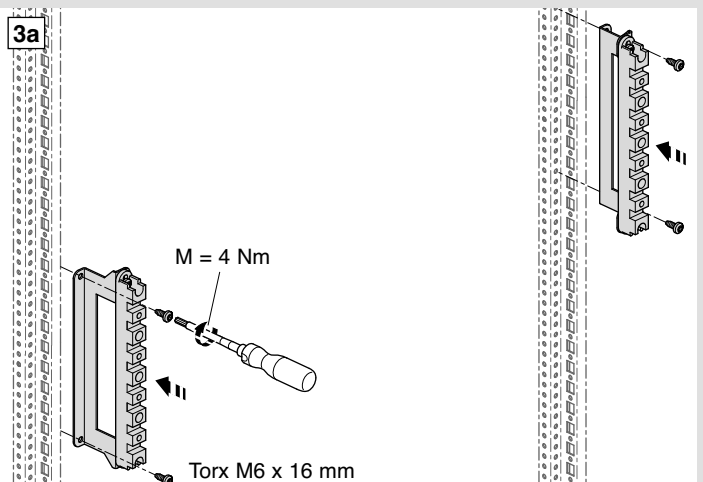

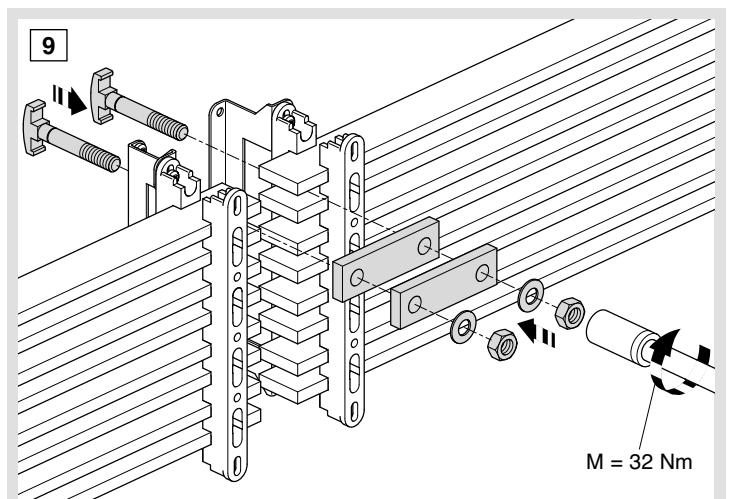
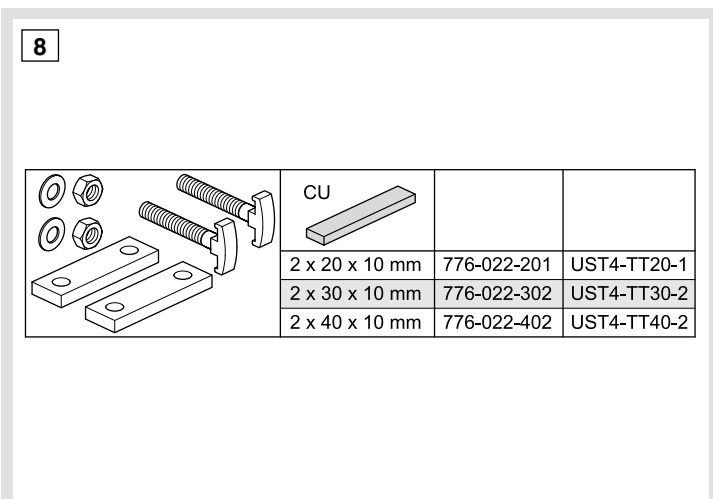
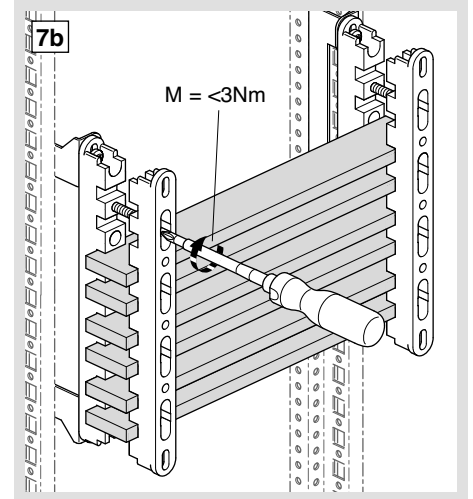
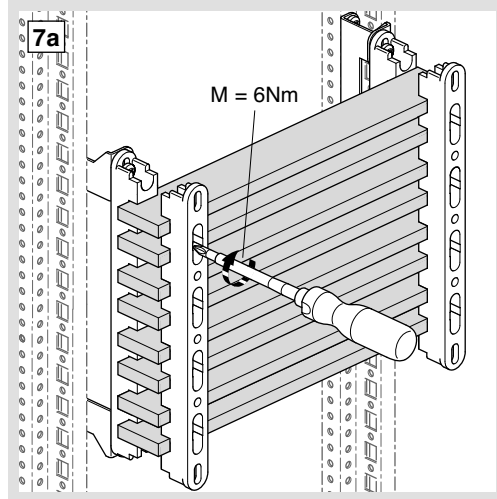
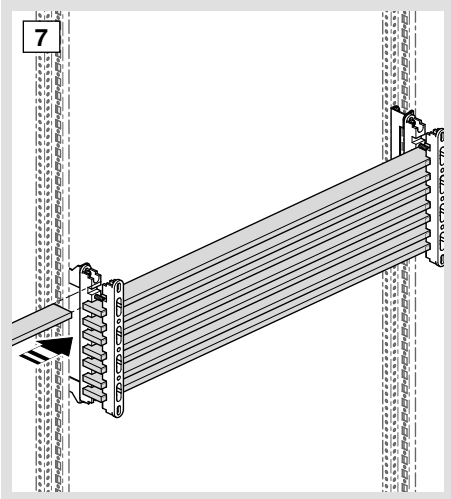
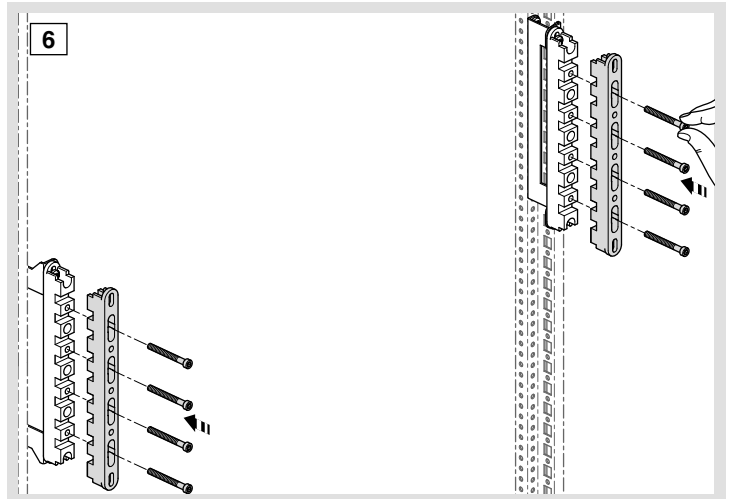
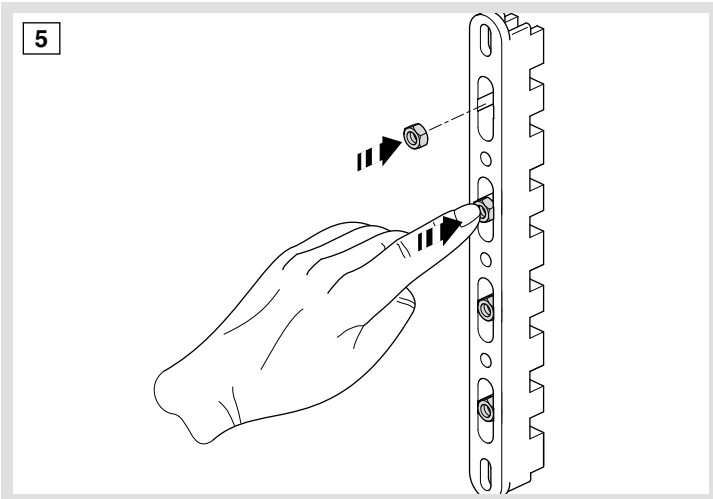
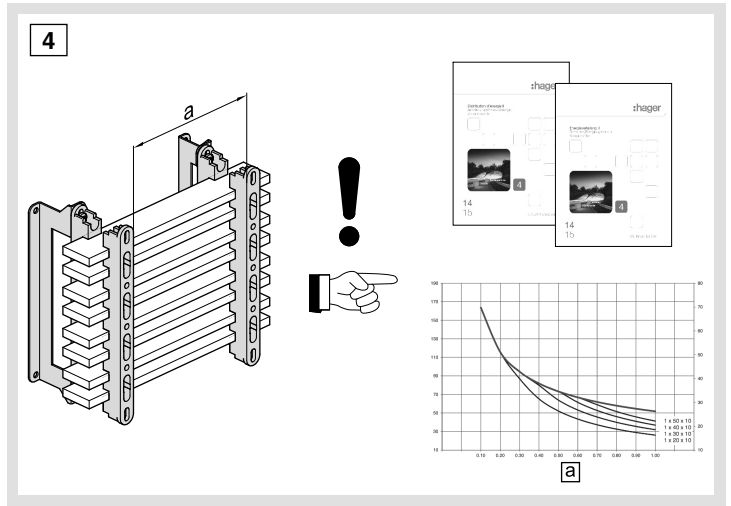
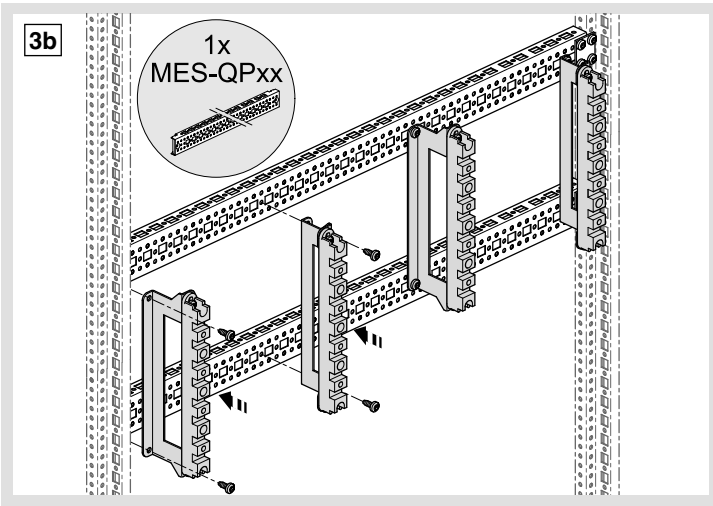

10a

| | | | | | |
|--|------------------|---------------|-----------|-------------|---------------|
| | CU | Nennstrom (A) | Dimension | Artikel-Nr. | Typ |
| | 2 Schienen / Pol | 400 | M8-26 | 776-023-208 | UST-ABM826-2 |
| | 2 Schienen / Pol | 1000 | M12-26 | 776-023-212 | UST-ABM1226-2 |
| | 2 Schienen / Pol | 1250 | M32-32 | 776-023-312 | UST-ABM1232-2 |

10b

| | | | | | |
|--|-----------------|---------------|-----------|-------------|---------------|
| | CU | Nennstrom (A) | Dimension | Artikel-Nr. | Typ |
| | 1 Schiene / Pol | 630 | M12-25 | 776-023-112 | UST-ABM1225-1 |

| | | | | |
|----|-------------|-------------|-------------|-------------|
| CU | 20 x 10 mml | 30 x 10 mml | 40 x 10 mml | 50 x 10 mml |
| | 60 mm | 70 mm | 80 mm | 90 mm |

11a

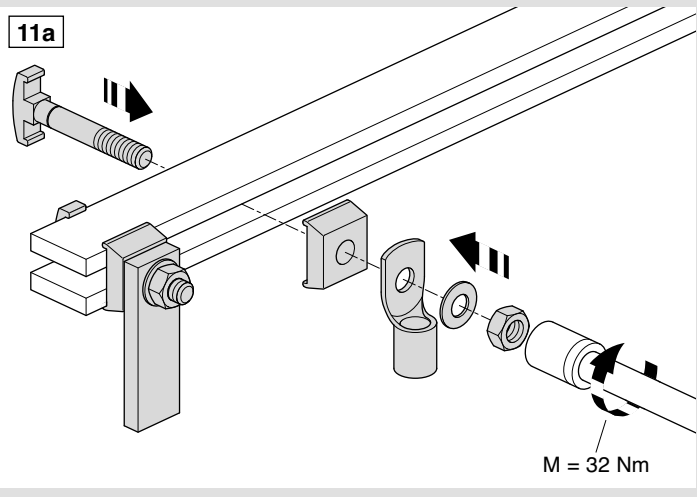

11b

