

6VF00900.a

golf

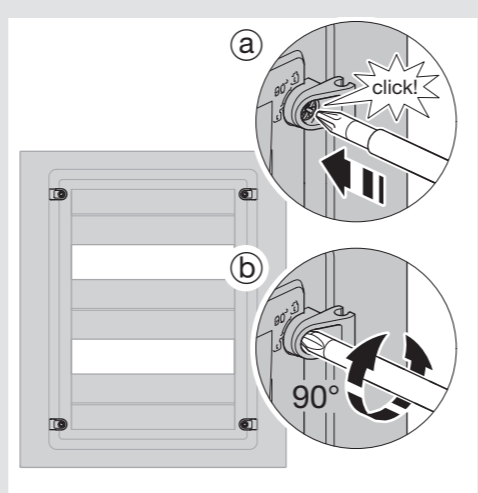
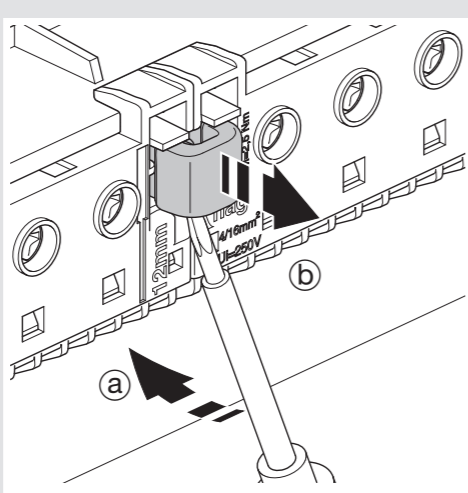
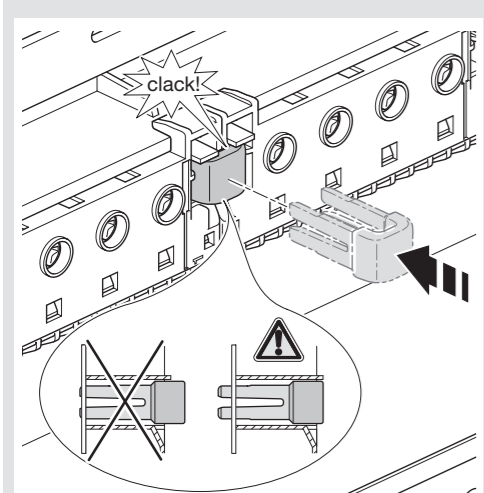
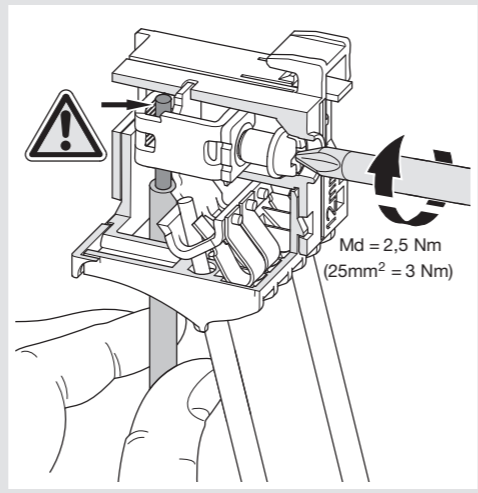
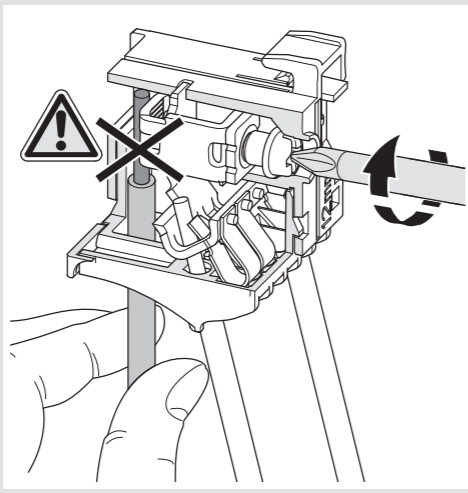
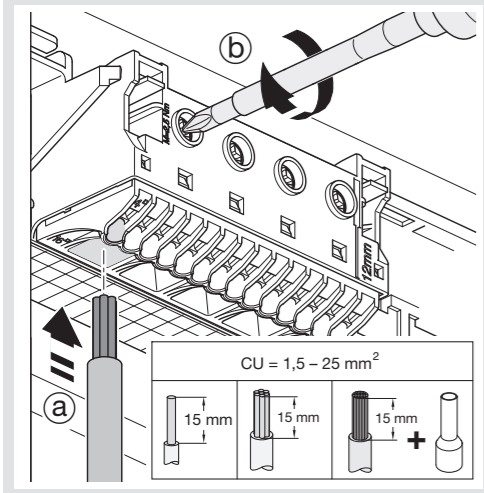
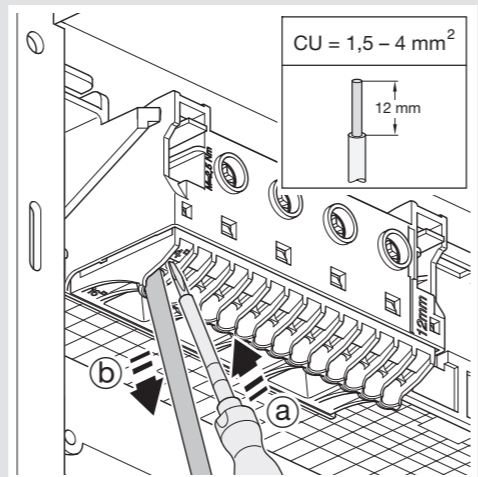
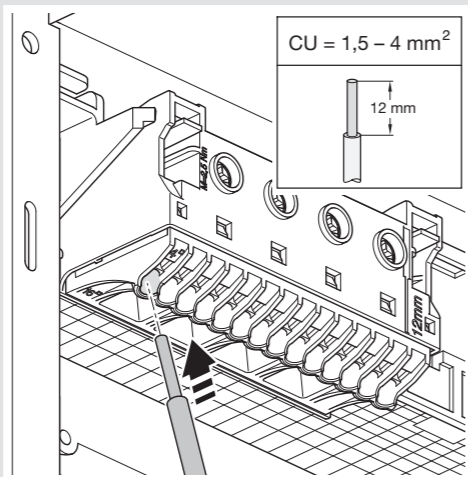
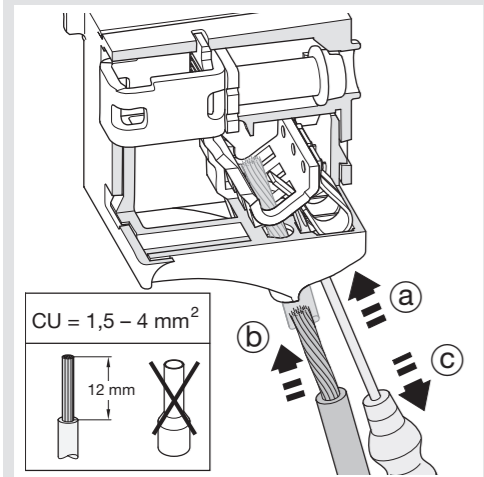
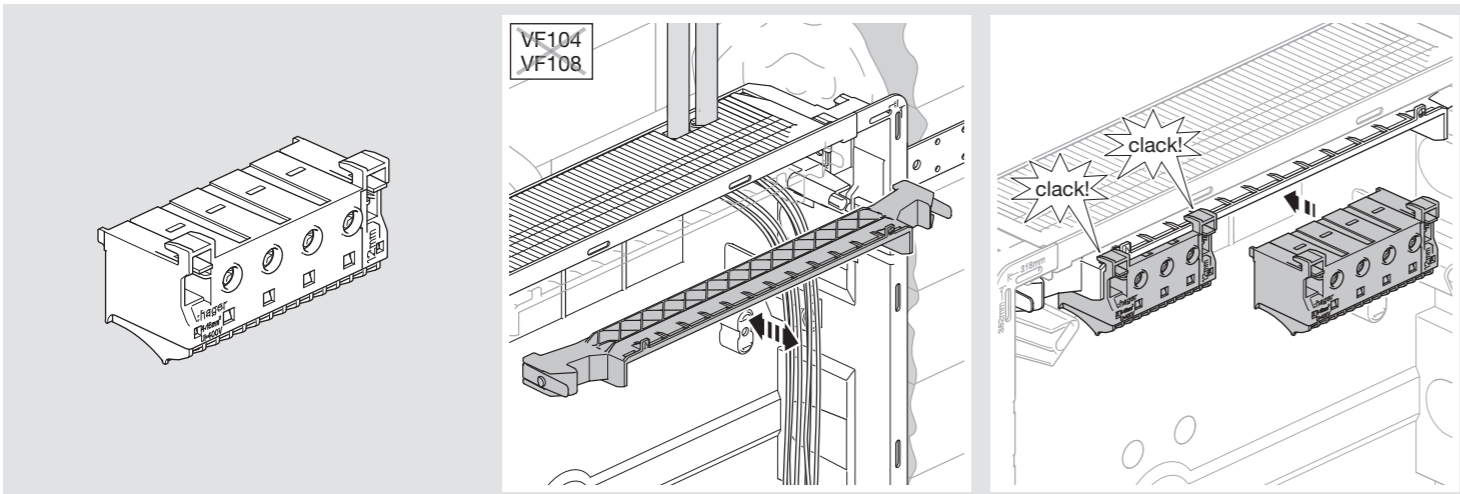
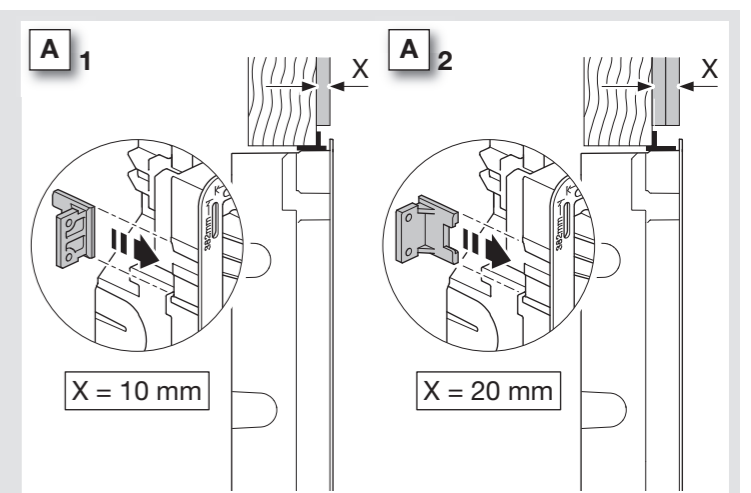
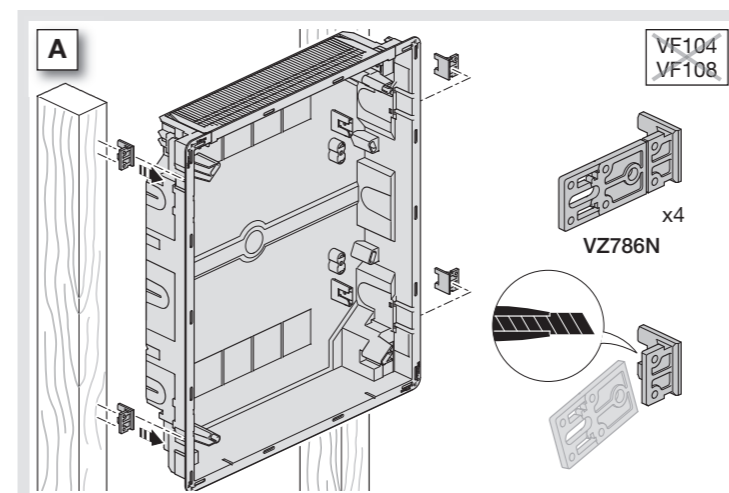
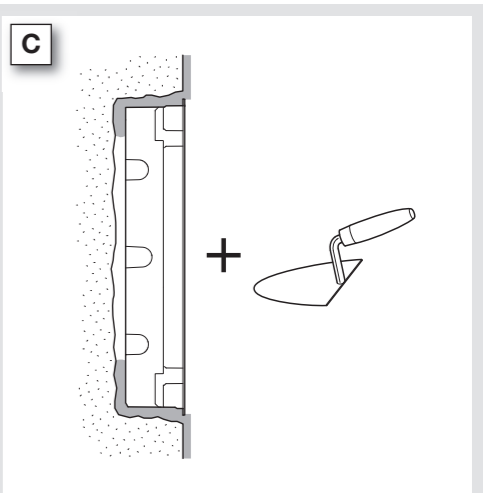
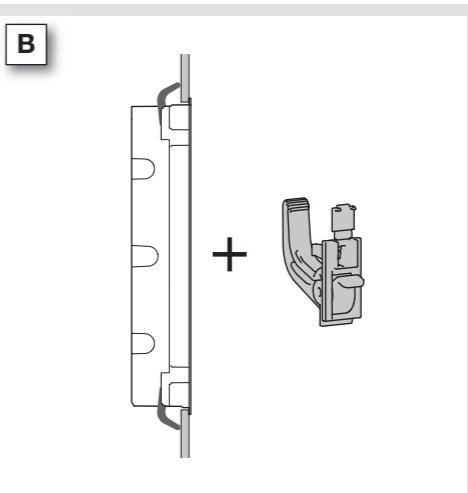
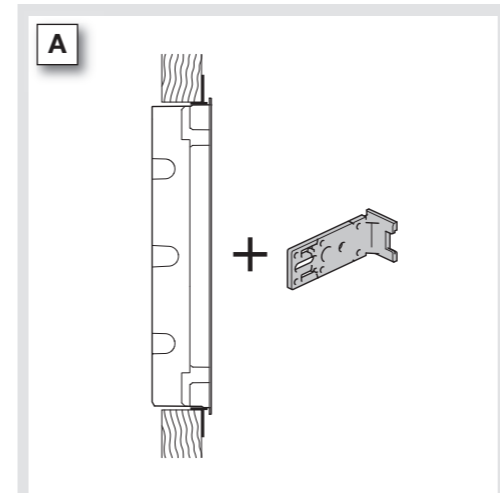
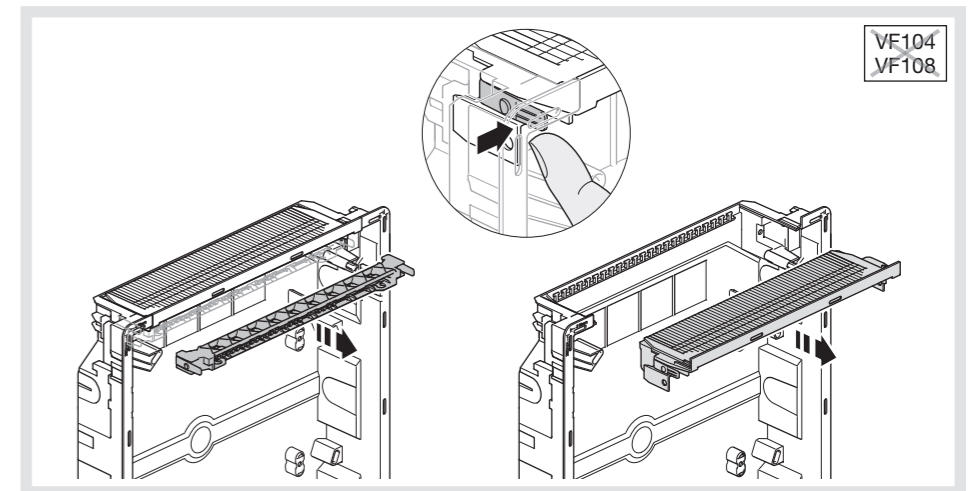
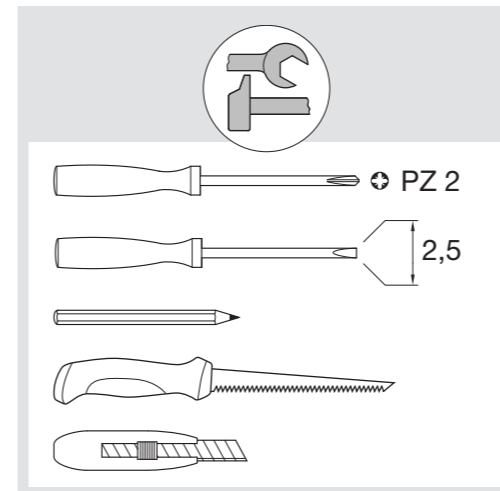

Hager 08.2012

B

	H (mm)	B (mm)
VF104	189	170
VF108	189	242
VF112	257	318
VF212	382	318
VF312	507	318
VF412	652	318
VF118	257	426
VF218	382	426
VF318	507	426
VF418	652	426
VF122	257	498

max. 30 mm

C

VF104
VF108

VZ786N

x 4

x 4

VZ696N

Click!

VF104
VF108
= 4 mm max

VF...
= 8 mm max

VZ683N
VZ684N
VZ685N
VZ686N
VZ687N
VZ688N
VZ689N
VZ690N
VZ691N

90°

3

4

818mm

382mm

5

180°

6

318mm

7

PZ2
90°

1/4 turn screw

MAINTAIN PRESSURE

8

VF104
VF108

VZ699N