

6ZS02000a

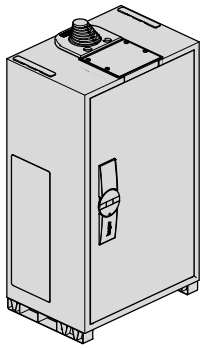

univers

- Ⓛ DE Montageanleitung
- Ⓛ FR Notice d'instructions
- Ⓛ GB Mounting instructions
- Ⓛ NL Montage instructie
- Ⓛ DK Monteringsvejledning
- Ⓛ FI Asennusohje
- Ⓛ NO Montasjeanvisning
- Ⓛ SE Monterings instruktioner
- Ⓛ IT Istruzioni di montaggio
- Ⓛ ES Instrucciones de montaje
- Ⓛ PT Instruções de montagem
- Ⓛ CZ Montážní návod
- Ⓛ BA Uputstvo za montažu

- Ⓛ HR Upute za montažu
- Ⓛ HU Szerelési útmutató
- Ⓛ LT Montavimo instrukcija
- Ⓛ LV Montažas instrukcija
- Ⓛ PL Instrukcja montażowa
- Ⓛ RO Instrucțiuni de montare
- Ⓛ SK Návod na montáž
- Ⓛ RU Инструкция по монтажу
- Ⓛ BG Инструкции за монтаж
- Ⓛ GR Οδηγίες χώνευσης
- Ⓛ SI Navodilo za montažo
- Ⓛ EE Paigaldusjuhised
- Ⓛ IS Leiðbeiningar
- Ⓛ AR دليل التركيب

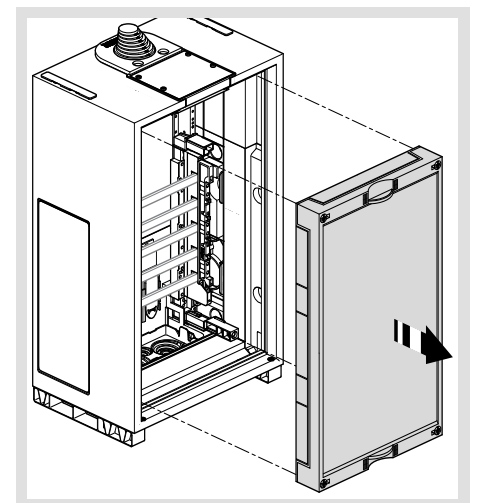
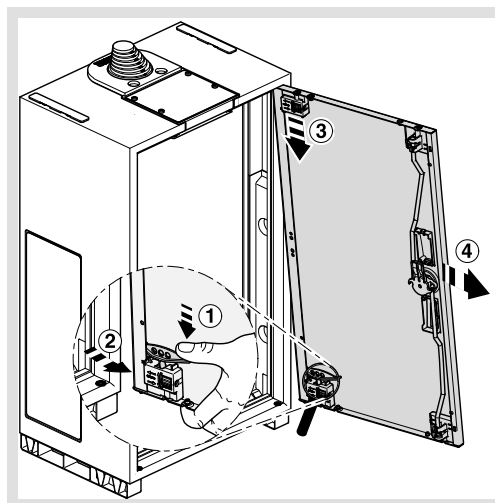
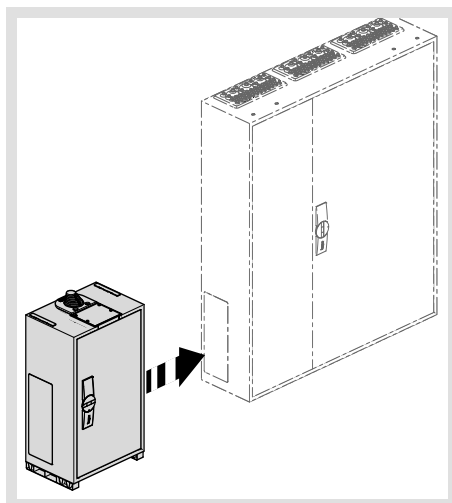
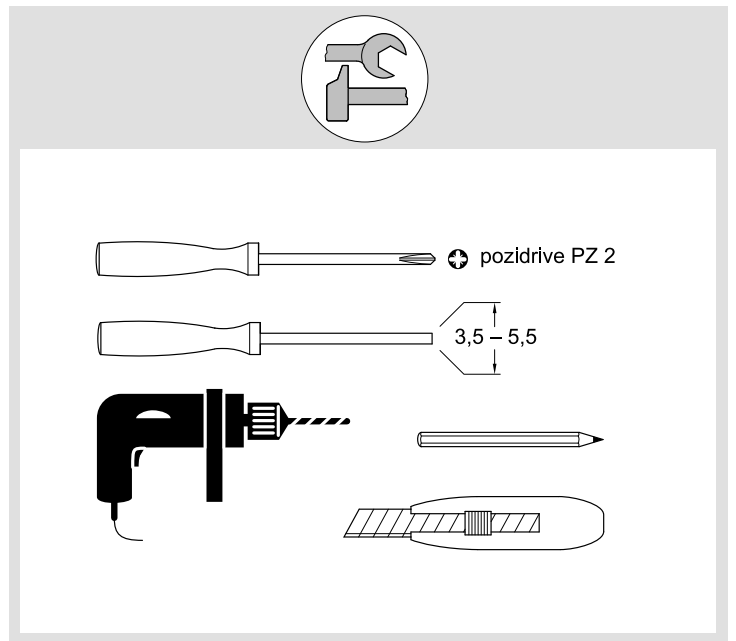
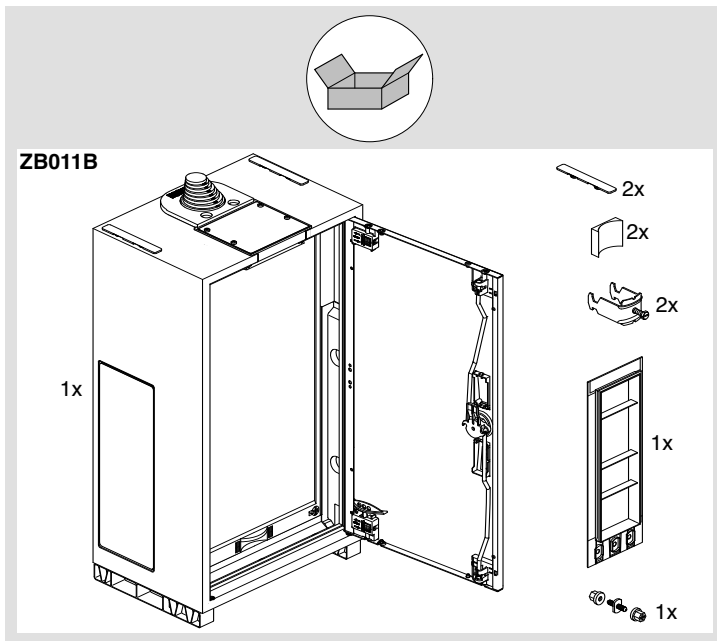
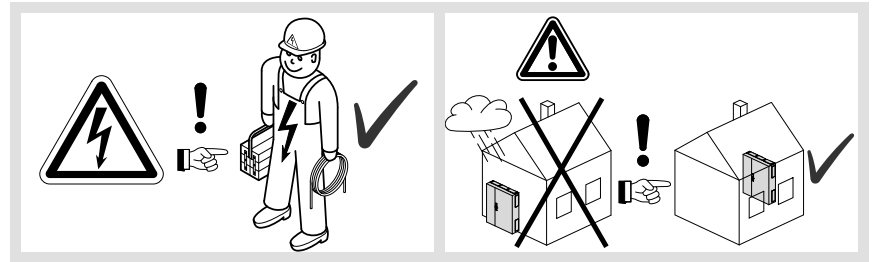

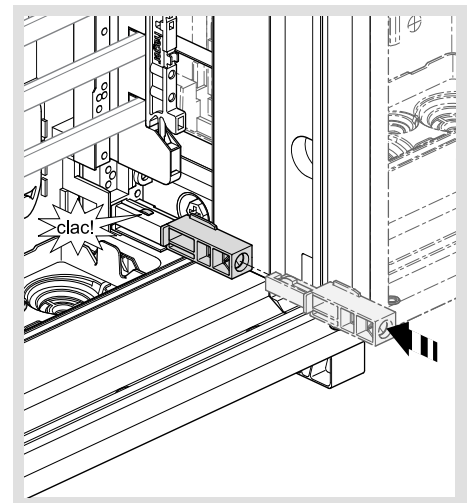
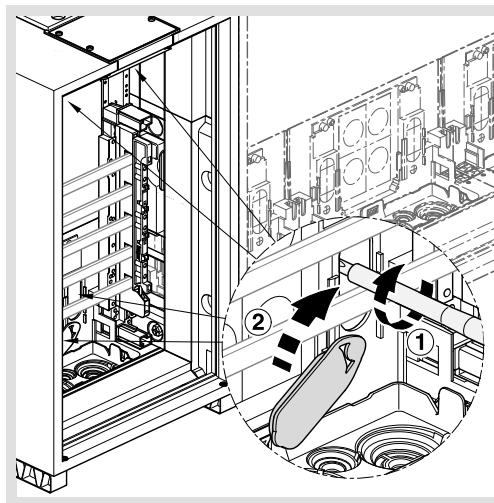
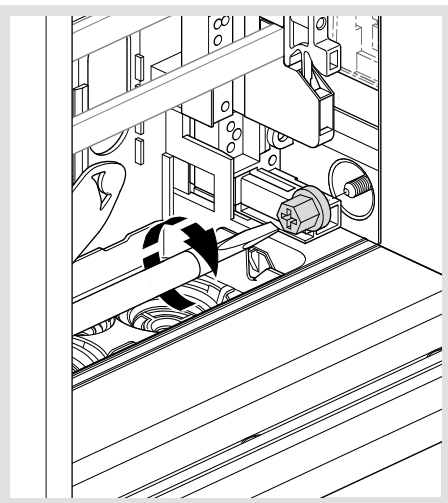
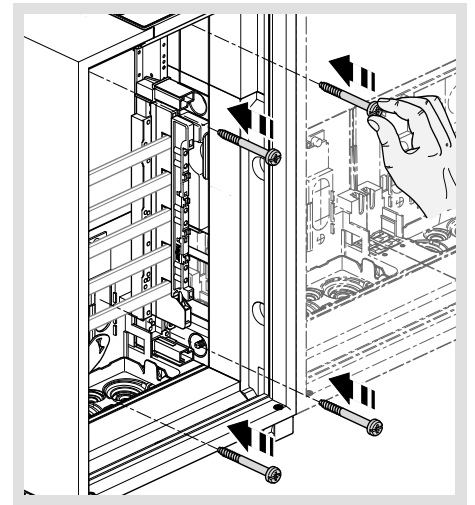
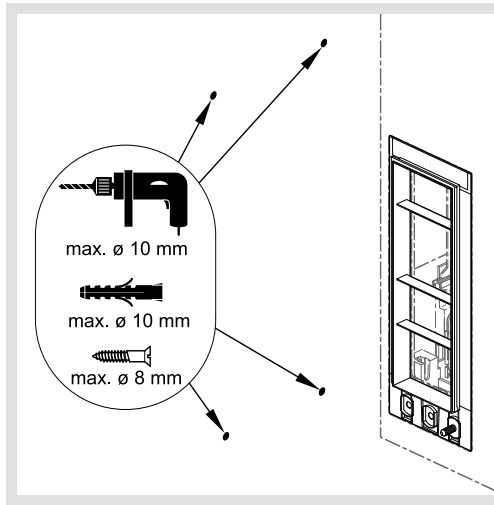
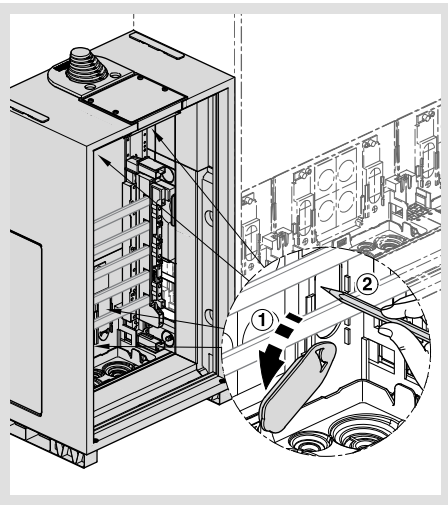
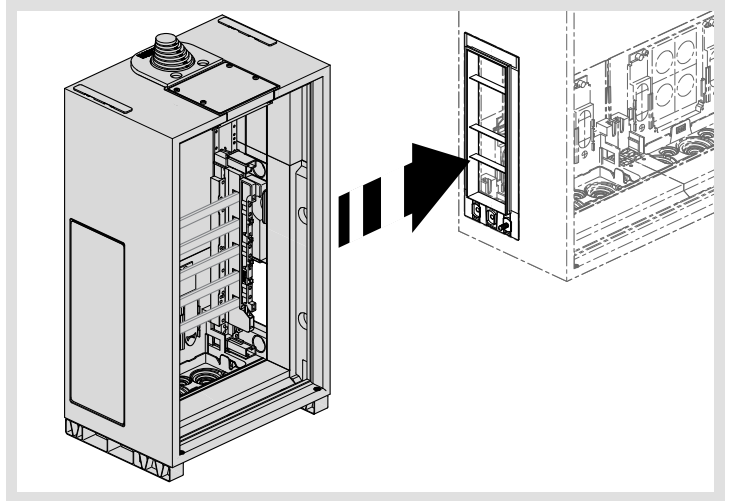
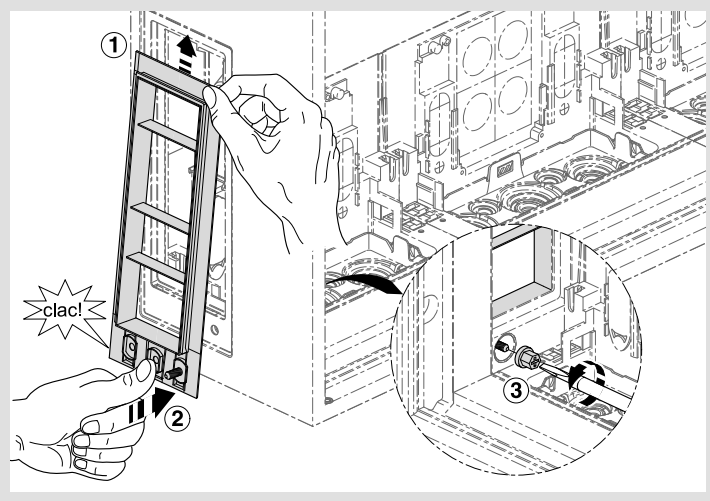
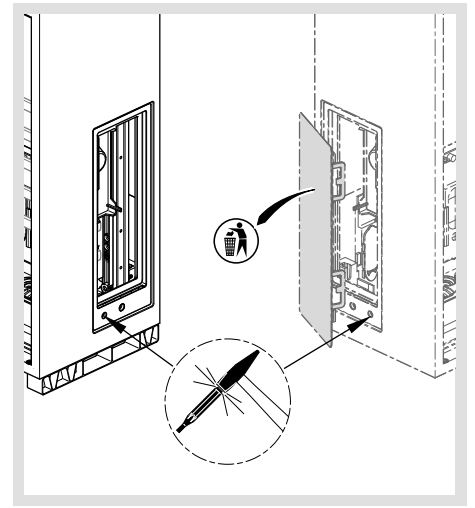
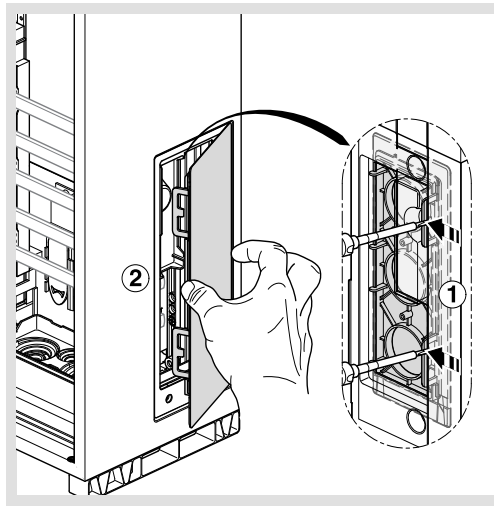
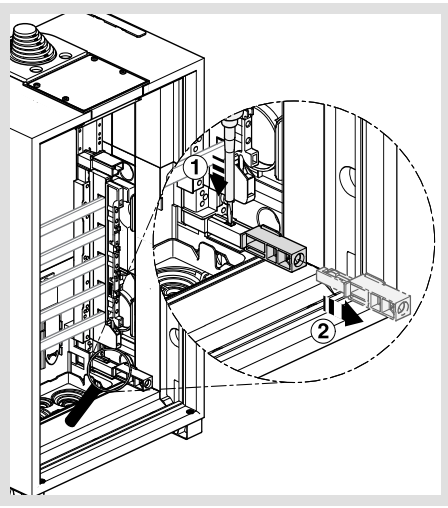

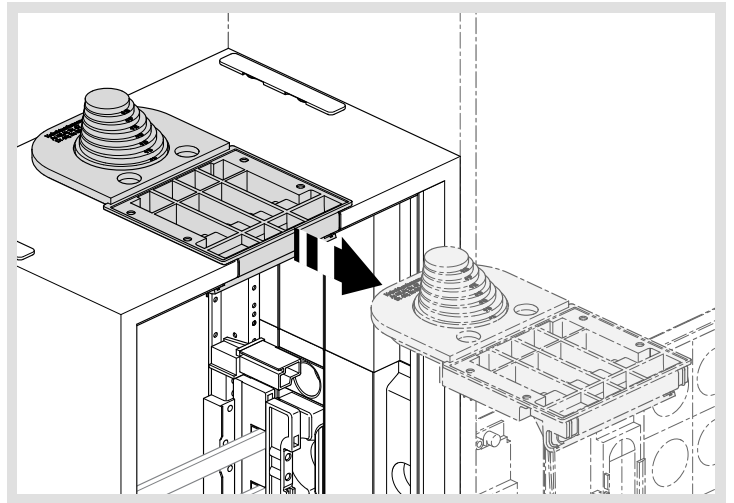
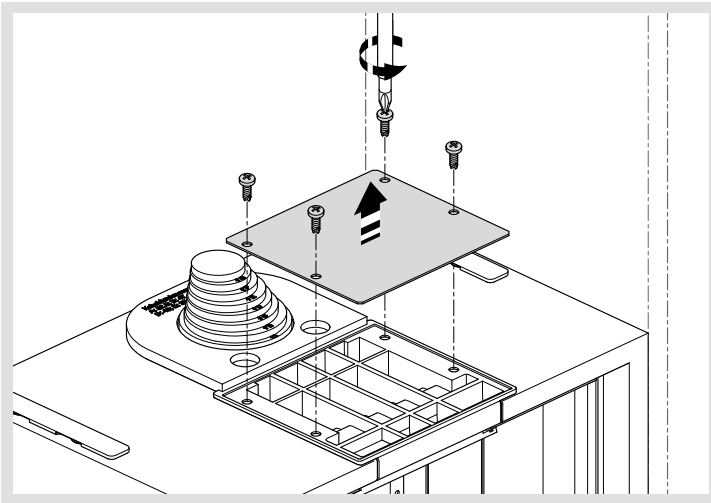
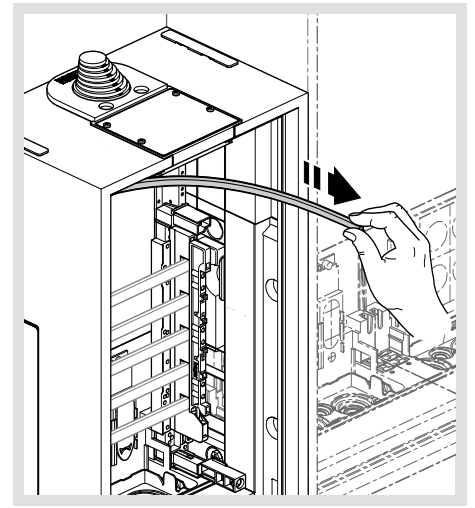
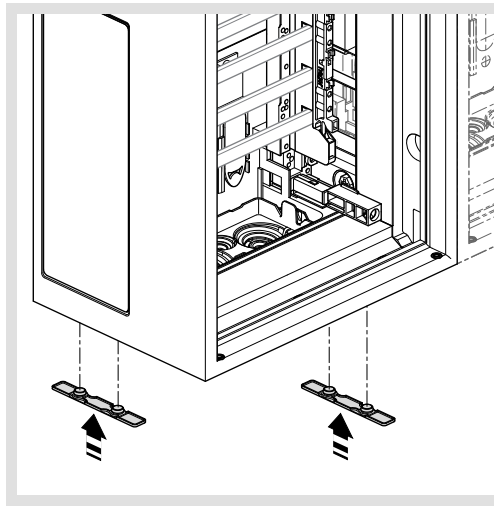
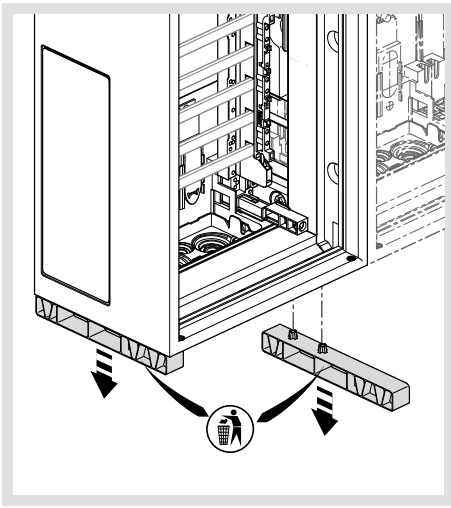

Kabeldurchmesser (mm):  
 A: 52,5; B: 47,5; C: 43,5;  
 D: 40; E: 35; F: 31; G: 27,5

<b>G</b>	27,5 mm = 4 x 25 mm <sup>2</sup> / 4 x 35 mm <sup>2</sup>
<b>F</b>	31 mm = 4 x 50 mm <sup>2</sup>
<b>E</b>	35 mm = 4 x 70 mm <sup>2</sup>
<b>D</b>	40 mm = 4 x 95 mm <sup>2</sup>
<b>C</b>	43,5 mm = 4 x 120 mm <sup>2</sup>
<b>B</b>	47,5 mm = 4 x 150 mm <sup>2</sup>
<b>A</b>	52,5 mm = 4 x 185 mm <sup>2</sup>

