BLC motion detector 180 IP44

Order no.: 1783 x1 xx/1786 x1 xx

BLC motion detector 180 comfort IP44

Order no.: 1784 x1 xx/1787 x1 xx

Assembly instructions

1 Safety instructions

The protection category IP44 is only guaranteed if assembly is performed in accordance with these instructions.

Electrical equipment must only be installed and assembled by qualified electrical engineers.

Disconnect before working on the device. Take into account all circuit breakers that supply dangerous voltages to the device or load.

Failure to comply with these instructions may result in damage to the device, fire or other hazards.

2 Function

The BLC motion detector 180 IP44 with included sealing set are suitable for water-protected installation in accordance with protection category IP44.

 Also observe the installation instructions in the operating instructions.

In BLC motion detectors 180 comfort IP44 there is no slide switch for off/automatic/on. BLC motion detectors IP44 function exclusively in automatic operation.

3 Information for electricians

3.1 Installation



DANGER!

Touching live parts can result in an electric shock.

An electric shock can lead to death.

Before working on the device or load, disconnect all associated circuit breakers. Cover all live parts in the area.

Install device with sealing set

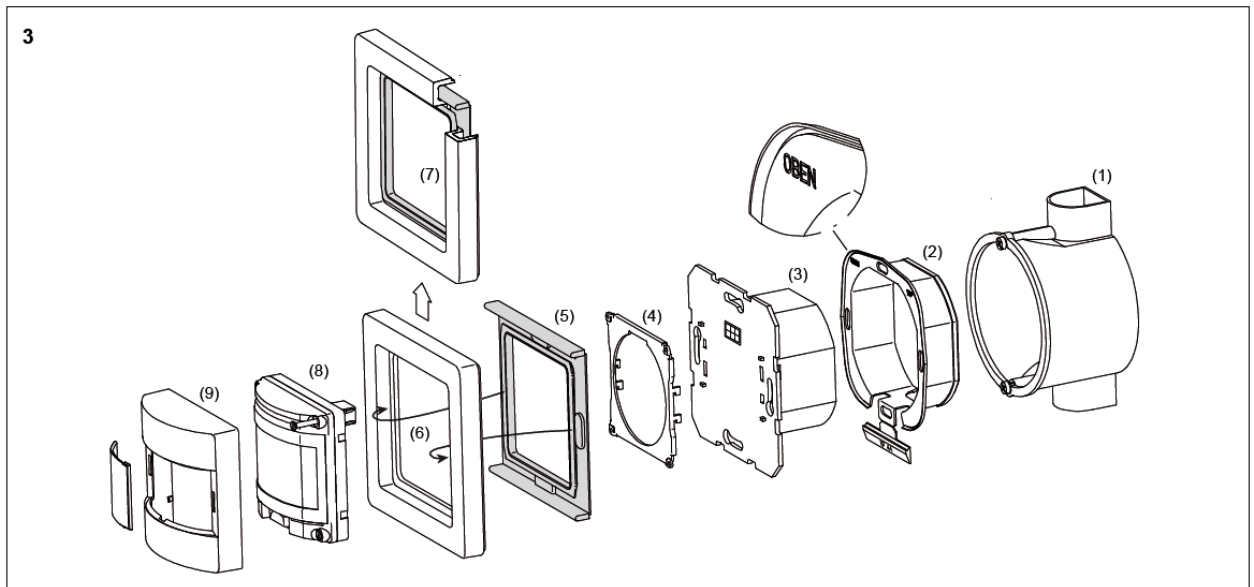

Figure 3

The protection category IP 44 can be achieved during installation with the supplied sealing set

- in flush-mounted boxes according to DIN 49073, Part 1
- on smooth, even, vertical walls
- in flush-mounted boxes.

The protection category IP 44 is not ensured in the case of floor mounting, ceiling mounting and mounting in hollow-wall boxes.

- Insert sealing flange (2) into the flush-mounted box (1). Note the proper direction (marking OBEN).

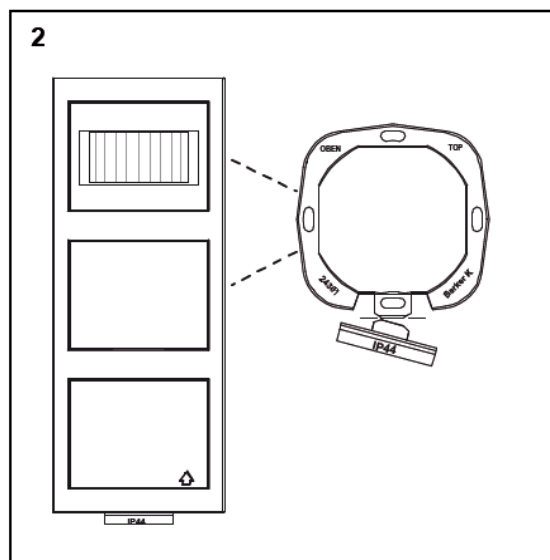

Figure 2

- If necessary, separate IP44 lug from sealing flange (Figure 2).

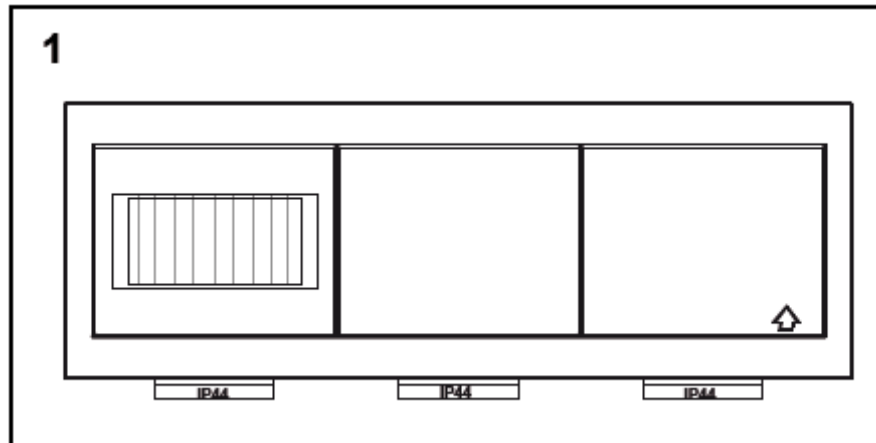

Figure 1

- ① For installation in horizontal combinations:
Each sealing flange requires the integrally moulded IP44 lug (Figure 1).
For installation in vertical combinations:
Only the lower sealing flange requires the integrally moulded IP44 lug (Figure 2).
- Connect BLC insert (3) in accordance with operating instructions and install in the flushmounted box.
 - Snap mounting plate (4) onto the BLC insert.
 - Guide seal (5) through the frame cut-out (6) from the rear as illustrated. When doing so, pull the sealing collar over the inner edge of the frame around its entire circumference (7).
 - Fit frame with seal (7).
 - Fit motion detector (8) on the insert and fasten with screws.
 - Fit design cover (9).

4 Address of manufacturer

Berker GmbH & Co. KG

Klagebach 38

58579 Schalksmühle/Germany

Phone: + 49 (0) 23 55/905-0

Telefax: + 49 (0) 23 55/90 5-111

www.berker.com