

(FR)

(EN)

(ES)

(PT)

(EL)

WK258 WK259 kallysta, Type F

Caractéristiques techniques

Technical data



Technische Daten

Características técnicas

Τεχνικά αρακτηριστικά

- Impédance / Impedance / Impedanz /
Impedancia / Impedância / Αντίσταση :
75 Ω

- Normes / Standards / Normen /
Normas / Προτυπα :
NF EN 50083 - UTE 90123 - UTE 90125

	Ref.	Type	dB	mA	MHz
	WK259	Prise directe / Direct socket / Enddose / Toma directa / Tomada directa / Απλή	< 1 dB	500 mA	4 - 2400
	WK258	Prise directe double type F / Double direct socket type F / Doppelt Enddose Typ F / Tomada directa doble tipo F/ Toma directa dobro tipo F / Απλή διπλό τύπος F	< 4 dB	500 mA	4 - 2400

Montage / Assembly / Montaje / Montagem / Τοποθέτηση

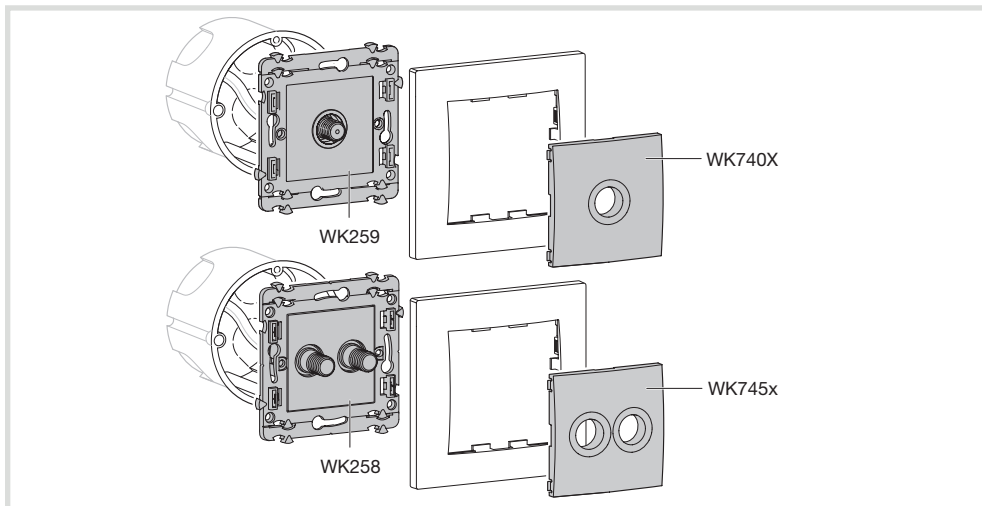

Coaxial / Koaxial / Ομοαξονικό

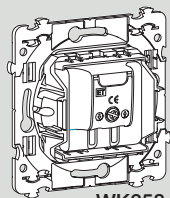
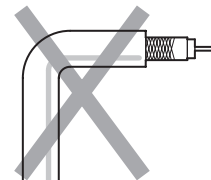
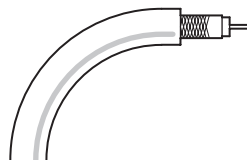
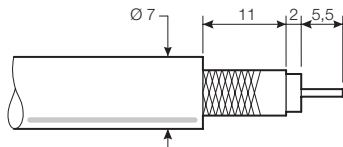

WK258

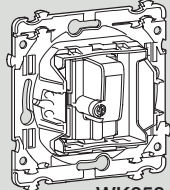

WK259

