

Effektbrytare

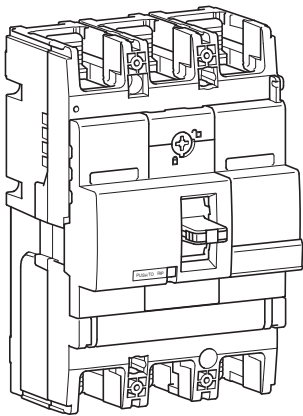

		220/240V AC IEC 60 947-2	380/415V AC IEC 60 947-2
HNB	l _{cu}	85 kA	40 kA
	l _{cs}	40 kA	20 kA

Magnetisk och termisk inställning

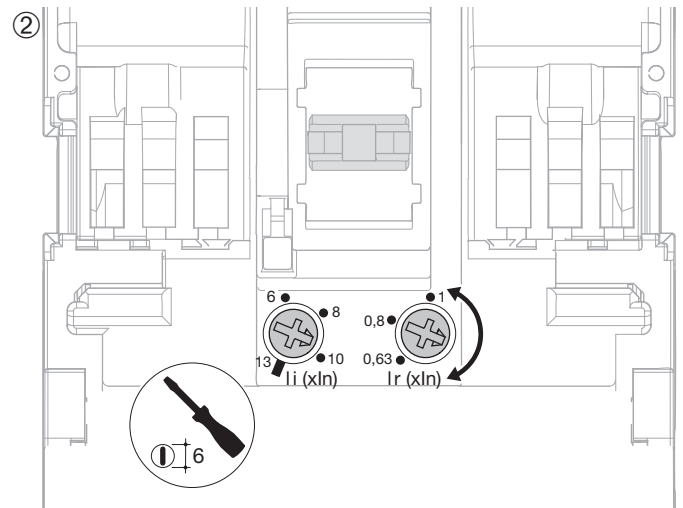
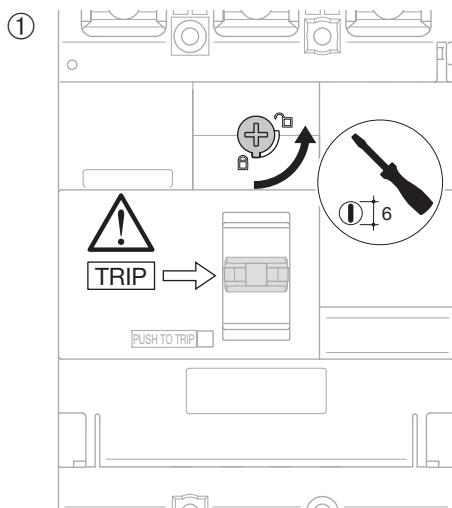

Termisk inställning från 0,63 till 1 x I_n

Magnetiskt inställning från 6 till 13 x I_n (100 - 200A)
från 5 till 11 x I_n (250A)

	100 - 200A	250A
I _r (x I _n) ①	0,63 - 0,8 - 1 x I _n	
l _i (x I _n) ②	6 - 8 - 10 - 13 x I _n	5 - 7 - 9 - 11 x I _n
x I _n /l _i ③	0 - 100%	
	0 - 60%	

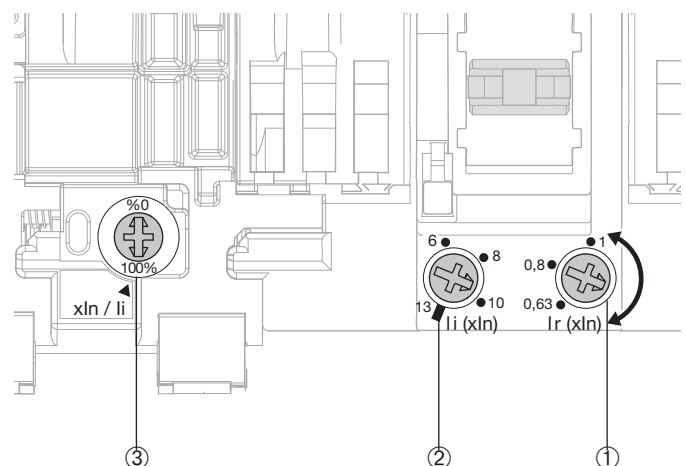

Tid - strömkurva

Effektbrytare x250

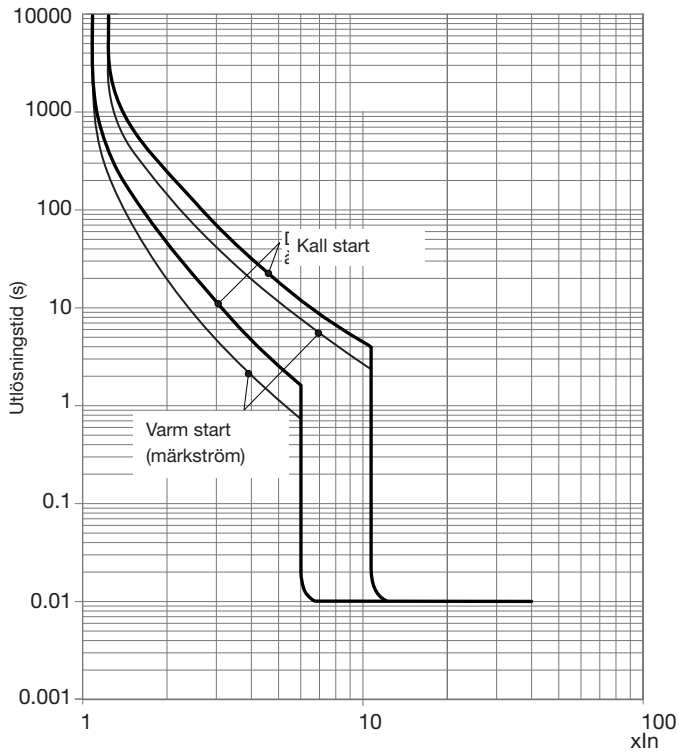

Genomsläppt energi

Effektbrytare x250

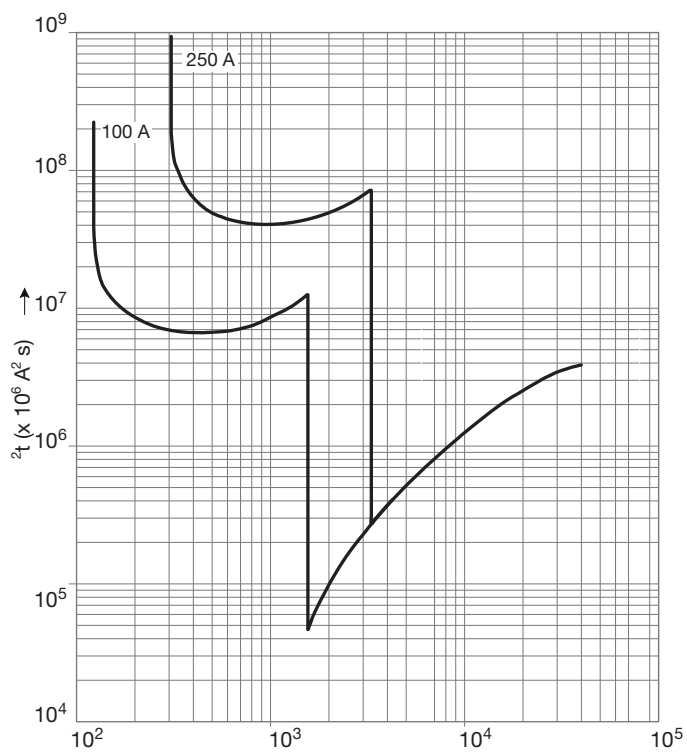

Strömbegränsning - kortslutning

Effektbrytare x250

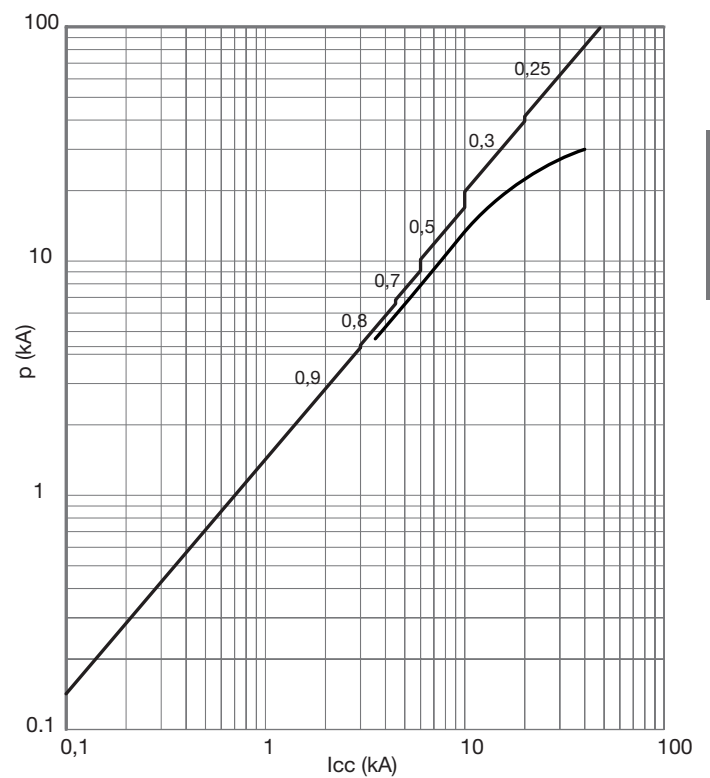

Mått

Effektbrytare x250

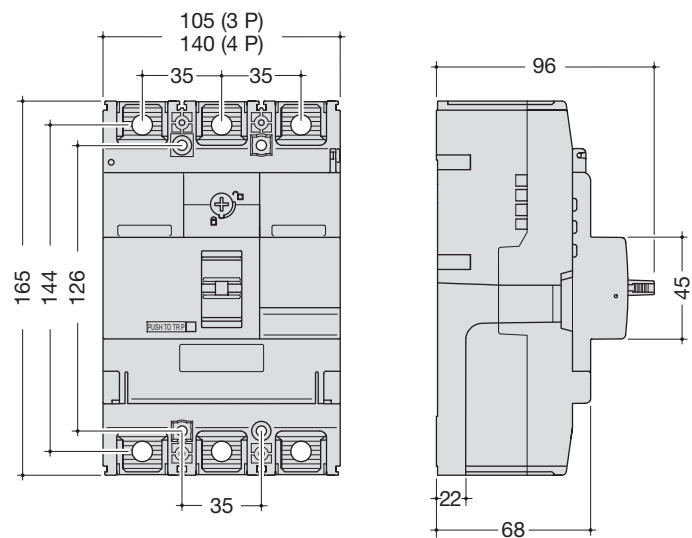

	A (mm)	B (mm)	C (mm)
3P	104,5	35	126
4P	139,5	35	126

Beröringsskydd över raka anslutningsförlängningar

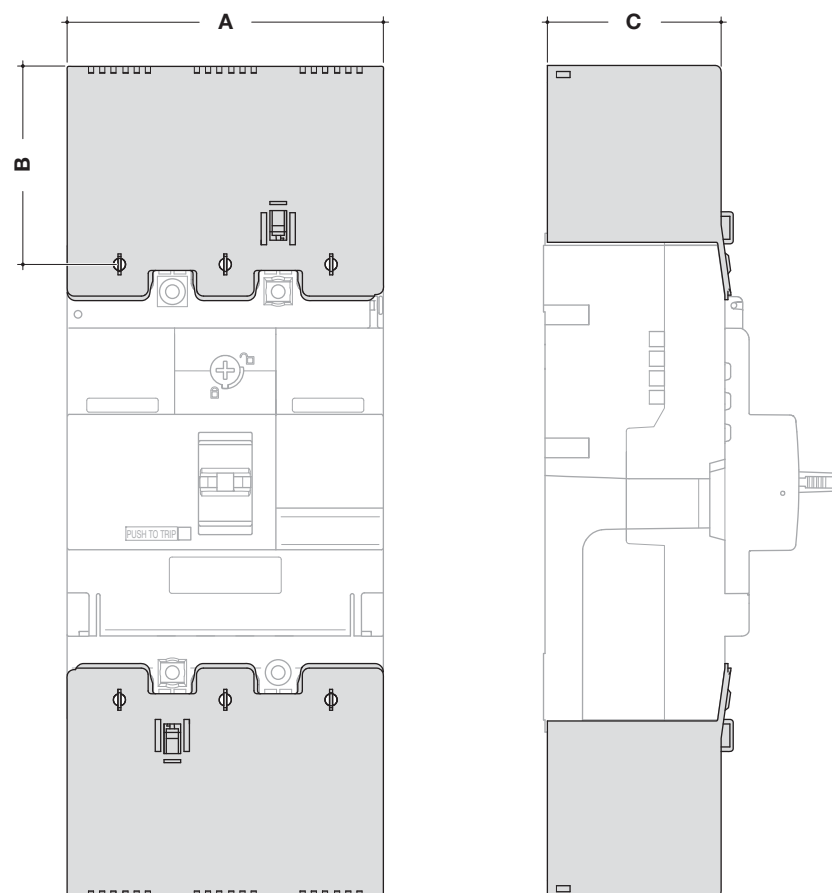

	A (mm)	B (mm)	C (mm)
3P	105	54,5	64
4P	140	54,5	64

Tillbehör

Beröringsskydd över särade anslutningsförlängningar

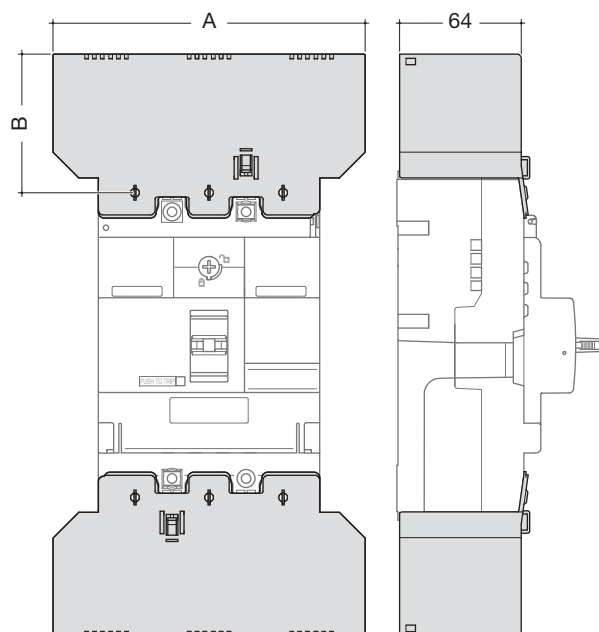

	A (mm)	B (mm)	C (mm)
3P	147,5	54,5	64
4P	196	54,5	64

Beröringsskydd över anslutningar

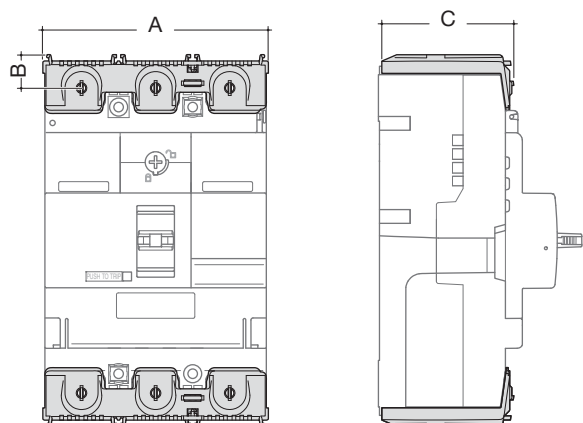

	A (mm)	B (mm)	C (mm)
3P	105	5	64
4P	140	5	64

Beröringsskydd över anslutningarklämmor aluminium

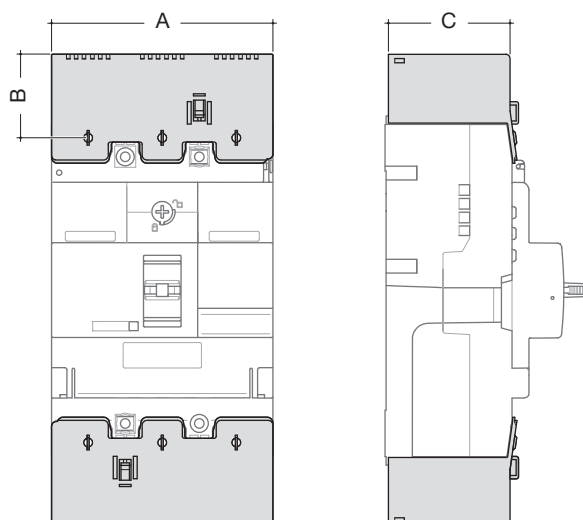

	A (mm)	B (mm)	C (mm)
3P	105	28,5	64
4P	140	28,5	64

Anslutningar

Anslutningsförlängare, rak och särad

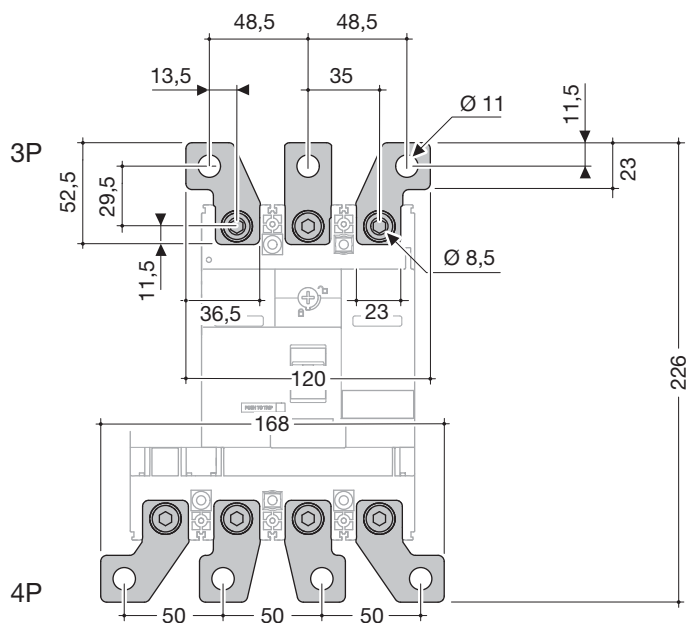
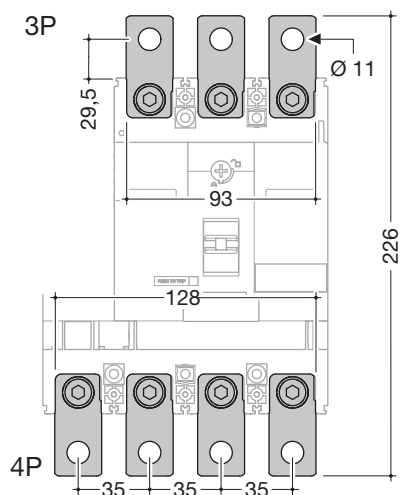
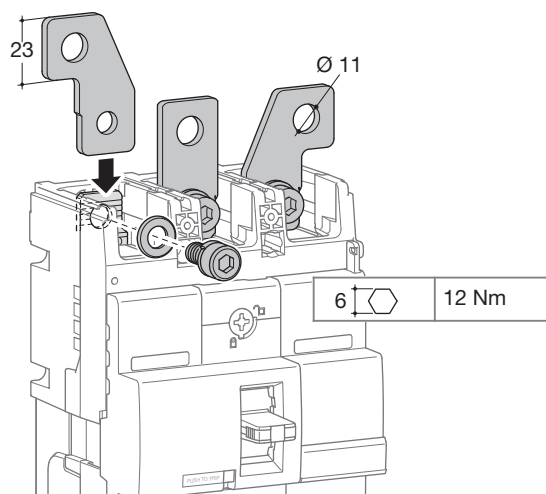
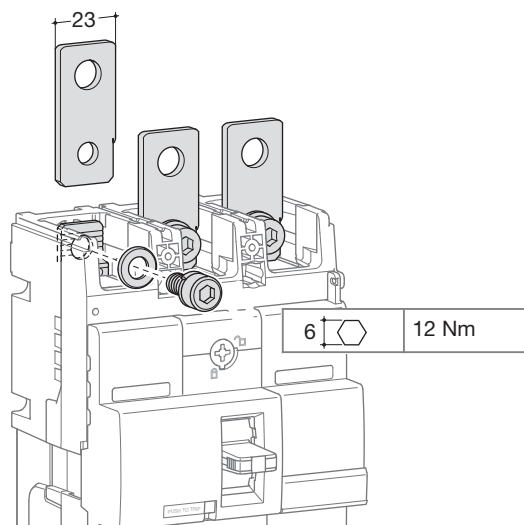

Anslutningsförlängare, anslutning bakom

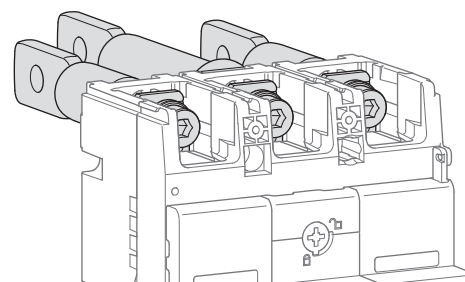
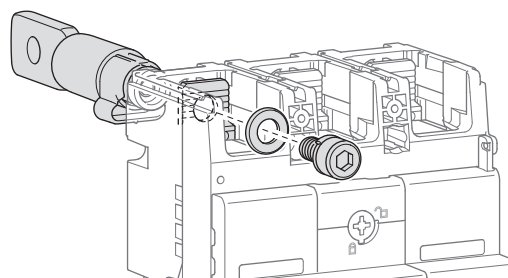
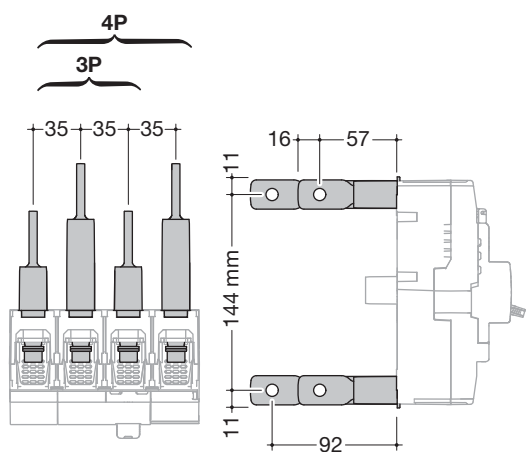

Anslutningsklämmor

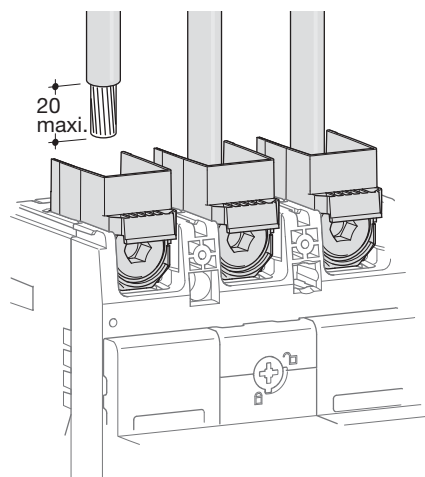
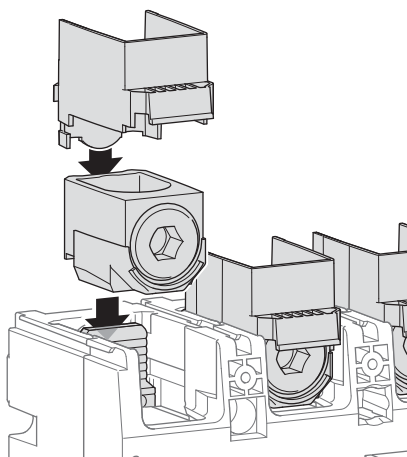

	min. 35 mm ²	max. 150 mm ²
	min. 35 mm ²	max. 185 mm ²
8	35 mm ² till 50 mm ² = 25 Nm 60 mm ² till 185 mm ² = 25 Nm	

Anslutning med kabelskor

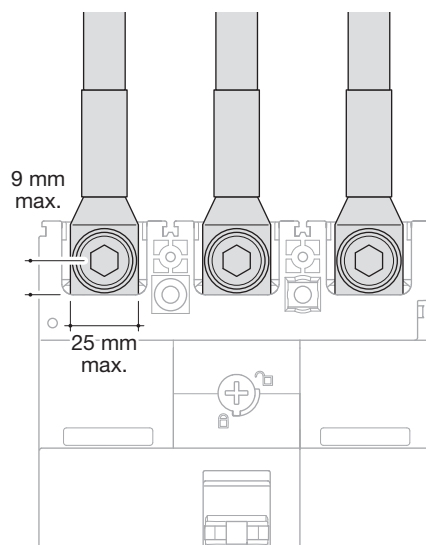
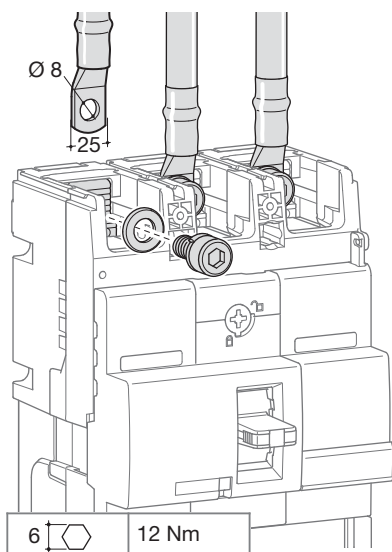

Isolationsplattor

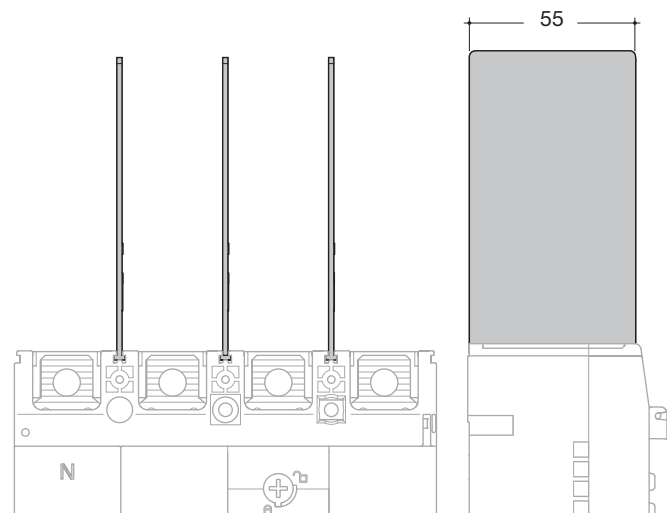
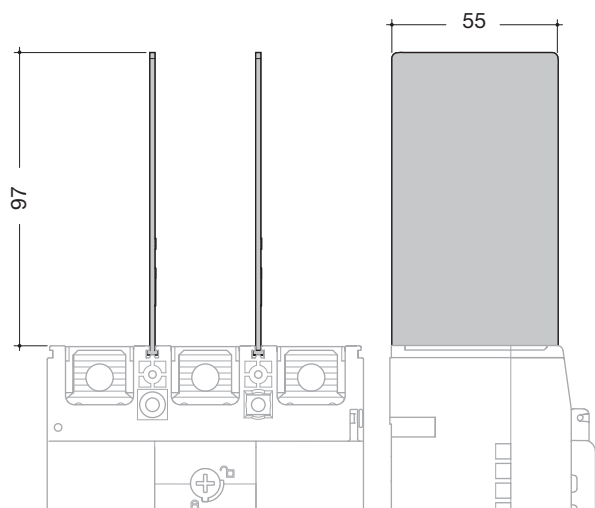

Tillbehör

Vridhandtag direkt på effektbrytaren

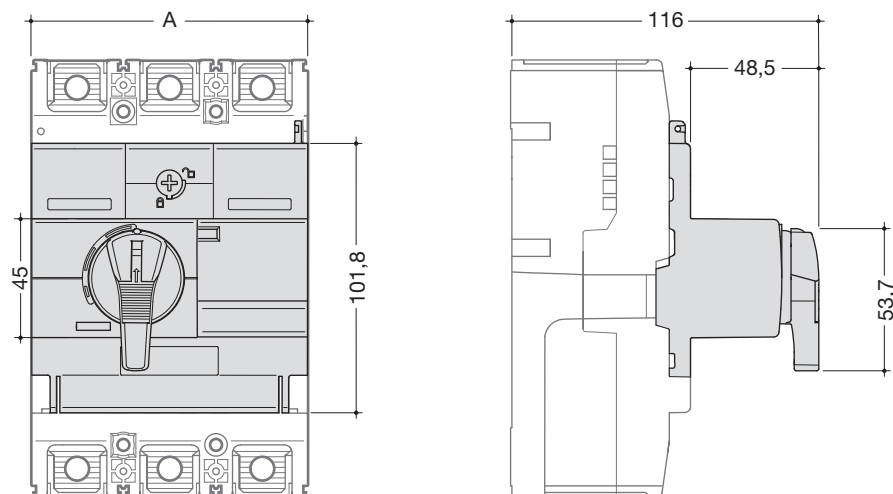

Vridhandtag genom dörr

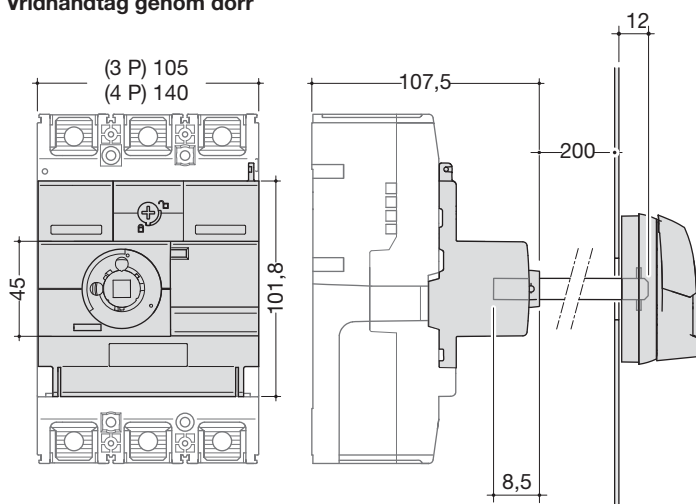

Motorbetjäning

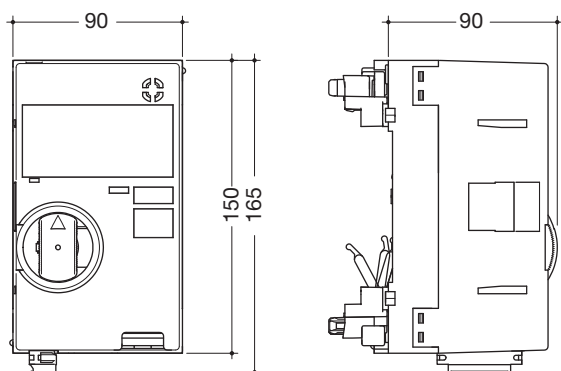

Märkdriftspänning	24V DC	ok
	230-240V AC	ok
Driftström (A)	24V DC	18
	230-240V AC	4
Start ström (A)	24V DC	26
	230-240V AC	8
Funktion		direkt
Manövreringstid (s)	ON	0,1
	OFF	0,1
	RESET	0,1
Manöverspänning	100V, 0.1A, öppnings spänning 44V, ström 4mA	
Tillslagseffekt	300 VA ström	
Dielektriska egenskaper	24V DC	1000 V AC
	230-240V AC	1500 V AC

Tillbehör

Tillbehör för effektbrytare

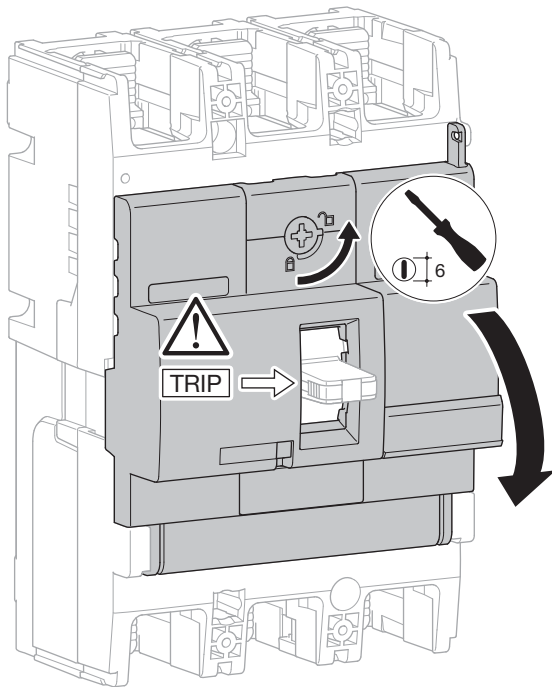

Monteringskombinationer för tillbehör

AX
Hjälpkontakt

AL
Signalkontakt

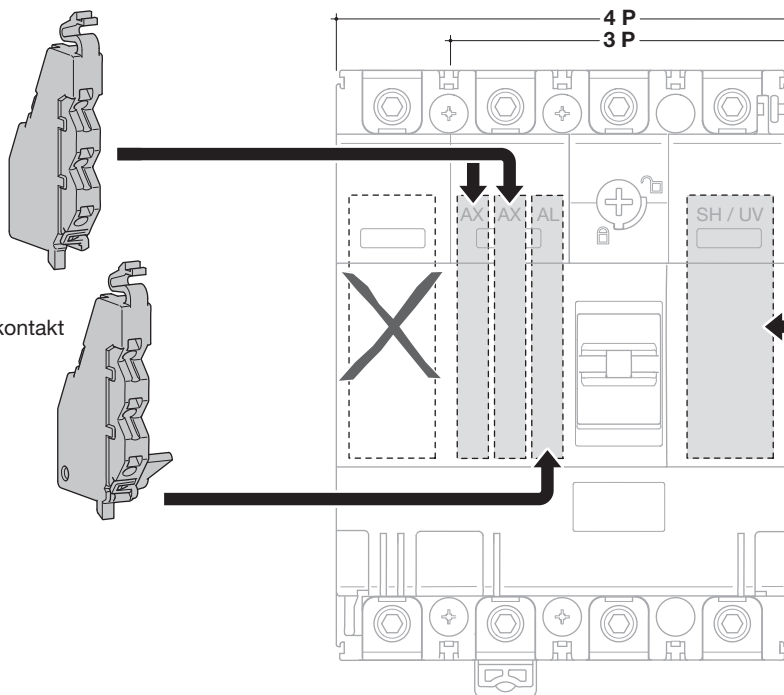

SH
Shuntutlösare

UV
Underspanningsutlösare

DUVR
Fördröjd
underspannings-
utlösare

Tekniska
sidor