

## Safety instructions

Electrical equipment must only be installed and assembled by a qualified electrician in accordance with the relevant installation standards, regulations, directives and safety and accident prevention directives of the country.

Failure to comply with these installation instructions may result in damage to the device, fire or other hazards.

## Function

The shaver socket is installed in a bathroom of a hotel in order to provide safety power to an electric razor.

## Correct use

- According to IEC 60670 installation of the safety shaver socket outlet is only permitted in plastic wall box or metal wall box (metal wall box must be connected with earth directly).  
Observe depth of wall box (depth  $\geq$  51 mm).
- Only suitable for use in indoor areas with no drip and no spray water.

## Technical data

Rated voltage:	250 V~
Frequency:	50/60 Hz
Output voltage:	115 V~/230 V~
Power:	max. 20 VA
Conductor cross-section of screw terminals:	min. 1 x 1.5 mm <sup>2</sup> ... max. 2 x 4 mm <sup>2</sup>
Distance of fixing holes:	120.6 mm
Compliance:	BS EN 61558

# Information for electricians

## Installation and electrical connection



### DANGER!

Touching live parts can result in an electric shock.

An electric shock can lead to death.

Disconnect the connecting cables before working on the device and cover all live parts in the area!

## Preparing the device for installation

1

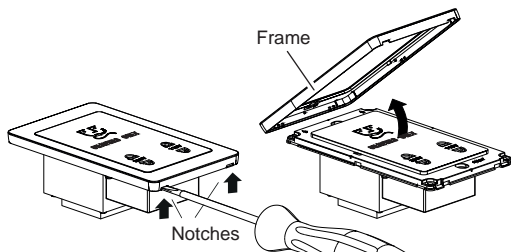

- Carefully loosen the frame on the notches with a flat-blade screwdriver. Lift up and remove the frame (1).

## Connecting the device

### 2A with plastic wall box

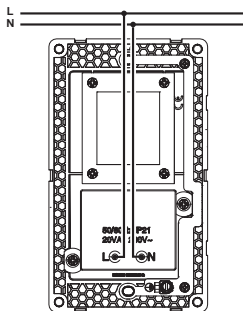

### 2B with metal wall box

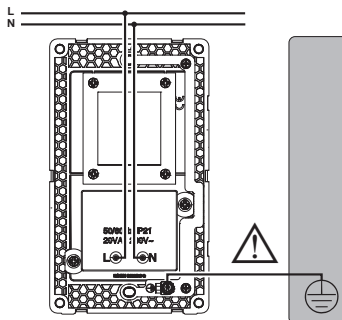

- Strip connection cables approx. 10 ... 15 mm.
- Wire the shaver socket according to the connection diagram (2A or 2B).  
When installing in metal wall box (2B), the box must be connected with earth directly.

## Installing the device into the wall box

3

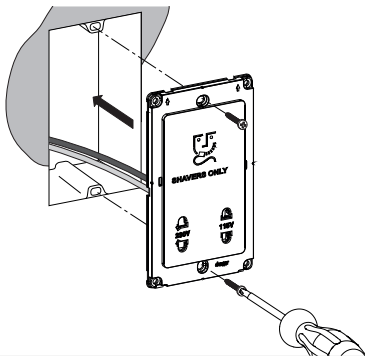

- After wiring, fix the device with the two screws attached into the wall box (3).

## Assembling the frame

4

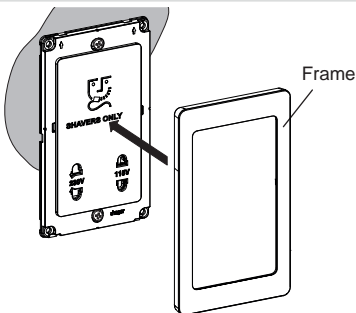

- Snap the frame onto the device (4).

