



Safety instructions

Electrical equipment must only be installed and assembled by a qualified electrician in accordance with the relevant installation standards, regulations, directives and safety and accident prevention directives of the country.

Failure to comply with these installation instructions may result in damage to the device, fire or other hazards.

Function

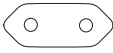
International socket with twin 2pole outlets for electrical installations in buildings. It is compatible with the following plug types:

	
Plug "type C"	Plug "type A"
2pin	2pole flat pin
CEE 7/16 Europlug	GB 1002

Correct use

- For the flush-mounted installation in standard wall boxes (recommended wall box depth ≥ 35 mm).
- Only suitable for use in indoor areas with no drip and no spray water.

Technical data

Rated voltage:	250 V~
Frequency:	50/60 Hz
Socket rated current:	10 A
Conductor cross-section of screw terminals:	min. 1 x 1.5 mm ² ... max. 2 x 4 mm ²
Distance of fixing holes:	60.3 mm
Socket compliance:	IEC 60884-1

Information for electricians

Installation and electrical connection



DANGER!

Touching live parts can result in an electric shock.

An electric shock can lead to death.

Disconnect the connecting cables before working on the device and cover all live parts in the area!

Preparing the device for installation

1

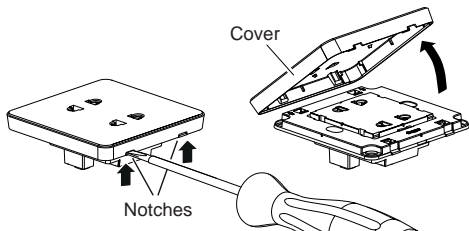

- Carefully loosen the cover on the notches with a flat-blade screwdriver (1).
- Lift up and remove the cover.

Connecting the device

2

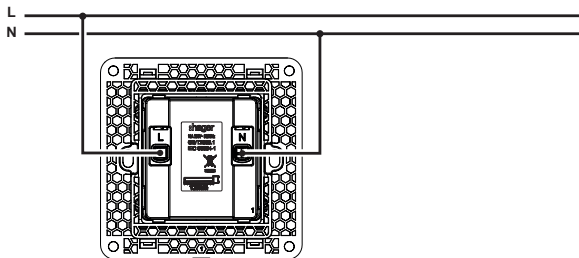

- Strip connection cables approx. 10 ... 12 mm.
- Wire the device according to the connection diagram (2).

Installing the device into the wall box

3

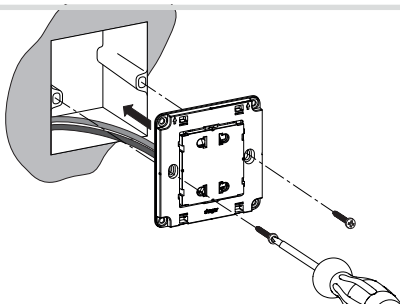

- After wiring, fix the device with the two screws attached into the wall box (3).

Assembling the cover

4

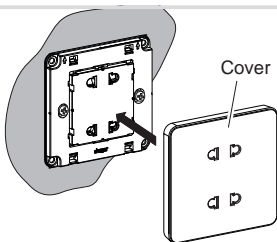

- Place the cover in the correct position and snap it onto the device (4).

i 2-5gang frames are available for multiple combinations.

