

## Safety instructions

Electrical equipment must only be installed and assembled by a qualified electrician in accordance with the relevant installation standards, regulations, directives and safety and accident prevention directives of the country.

Failure to comply with these installation instructions may result in damage to the device, fire or other hazards.

## Function

This device combines a TV outlet with a data outlet. It is equipped with a single TV jack for supplying TV signals and a RJ45 module for data transmission. RJ45 jack with dust protection slider.

## Correct use

- For the flush-mounted installation in standard wall boxes (wall box depth  $\geq 47$  mm).
- Only suitable for use in indoor areas with no drip and no spray water.

## Technical data

### TV outlet

Frequency range: 5 ... 1000 MHz

### RJ45 outlet Cat.5e

Transmission bandwidth: max. 100 MHz

Voltage proof (contact-to-contact): 1000 V DC or AC peak

Current rating: 0.75 A

Insulation resistance:  $\geq 500$  M $\Omega$  at 100 V DC

Signal contact resistance:  $\leq 20$  m $\Omega$

Type of connection: IDC terminals

Conductor  $\varnothing$  (solid): 0.51 ... 0.64 mm (AWG 24-22)

Cat.5e, unshielded (UTP): according to ISO/IEC 11801

Design: according to IEC 60603-7

Colour code A and B: according to TIA/EIA 568-B.2

# Information for electricians

## Installation and electrical connection

### Preparing the device for installation

1

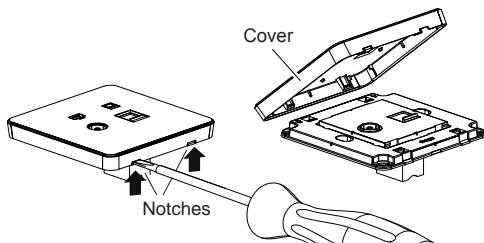

- Carefully loosen the cover on the notches with a flat-blade screwdriver (1).
- Lift up and remove the cover.

### Connecting the data module

- Remove the cover plate of the data module with a flat-blade screwdriver.

2

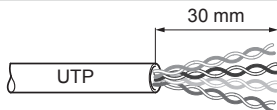

- Strip 30 mm of cable jacket (2).
- Position and terminate first pair according to colour code A or B:

RJ45 pin assignment		TIA/EIA 568B	TIA/EIA 568A
	1	white/orange	white/green
	2	orange	green
	3	white/green	white/orange
	4	blue	blue
	5	white/blue	white/blue
	6	green	orange
	7	white/brown	white/brown
	8	brown	brown

- As with the first pair position and terminate each subsequent pair one at a time until termination is complete.
- Fix the cover plate back to the module.



### Checking of the installation:

A functional test of the installation should be made for each data outlet.

## Connecting the TV jack

- Shorten and route coaxial transmission line in the wall box. When doing so, do not bend coaxial transmission line too far.

**3A**

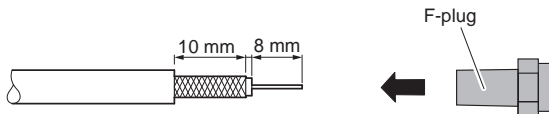

- Strip coaxial transmission line and attach supplied F-plug (3A).

**3B**

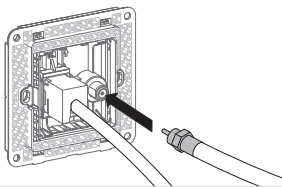

**3C**

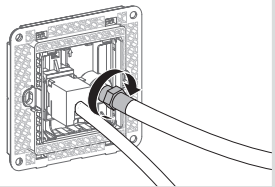

- Connect and screw the assembled line to the F-jack on the rear of the TV outlet (3B/3C).

## Installing the device into the wall box

4

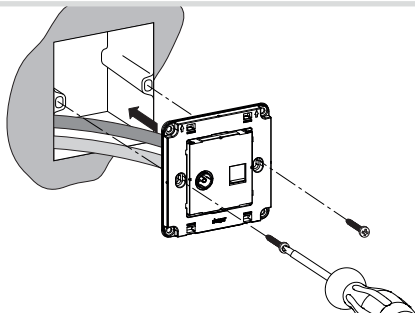

- After wiring, fix the device with the two screws attached into the wall box (4).

## Assembling the cover

5

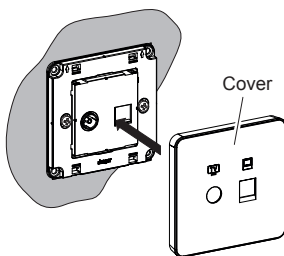

- Place the cover in the correct position and snap it onto the device (5).

**i** 2-5gang frames are available for multiple combinations.