

Safety instructions

Electrical equipment must only be installed and assembled by a qualified electrician in accordance with the relevant installation standards, regulations, directives and safety and accident prevention directives of the country.

Failure to comply with these installation instructions may result in damage to the device or the mobile device to be charged, fire or other hazards.

Function

Standalone USB charging socket outlet for electrical installations in buildings.

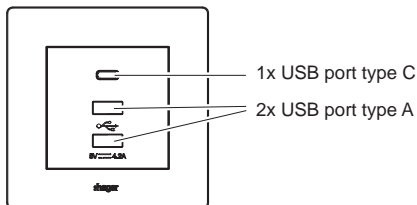

USB features:

- The 3 port USB port charging unit is suitable for charging most portable electronic devices connected via a USB type A or a USB type C plug.
- Allows charging of up to 3 devices at the same time.
- With dynamic load recognition
- Short-circuit proof and overload proof

Correct use

- For the flush-mounted installation in standard wall boxes (recommended wall box depth ≥ 35 mm).
- Only suitable for use in indoor areas with no drip and no spray water.

Charging portable electronic devices



CAUTION!

The use of non-standardised charging cables and connectors can cause damages or malfunctions of the device or the mobile device to be charged.

Use only approved charging cables and connectors.



CAUTION!

The USB ports of some mobile devices might carry external voltages higher than 5V d.c.

The USB charging unit may be destroyed.

Connect only certified mobile devices with a maximum voltage of 5V d.c.

- Insert **USB type A** connector of the charging cable into one of the two lower USB type A charging ports.

Or:

- Insert **USB type C** connector of the charging cable into the upper USB type C charging port.

i Up to three portable devices can be charged simultaneously with a maximum total charging current of 4.2 A. The charging current is then split depending on the phone or device characteristics and the number of ports used.

- If the charging process is complete or shall be interrupted, plug out charging cable.

Technical data

Rated voltage:	220 ... 240 V~
Frequency:	50/60 Hz
Conductor cross-section of screw terminals:	max. 2 x 1,5 mm ²
Distance of fixing holes:	60.3 mm
USB output:	5 V d.c.
USB output current:	
- 1 type A port used only:	max. 2.4 A
- 2 type A ports used:	max. 4.2 A
- type C port used only:	max. 3.0 A
- type C port and 1 type A port used:	max. 4.2 A
- type C port and 2 type A ports used:	max. 4.2 A
Standby power consumption:	< 150 mW
USB compliance:	IEC 62368-1
Operating temperature:	-5 ... +45°C
Relative humidity (no condensation):	0 % ... 95%

Information for electricians

Installation and electrical connection



DANGER!

Touching live parts can result in an electric shock.

An electric shock can lead to death.

Disconnect the connecting cables before working on the device and cover all live parts in the area!

Preparing the device for installation

The device is delivered with a transparent dust protection sticker. This sticker must remain on the device during the time of installation.

1

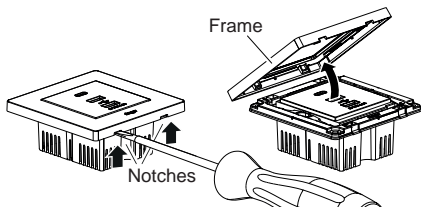

- Carefully loosen the frame on the notches with a flat-blade screwdriver. Lift up and remove the frame (1).

Connecting the device

2

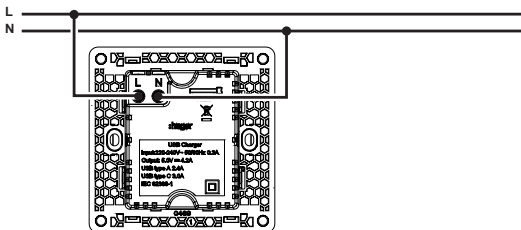

- Strip connection cables approx. 7 mm.
- Wire the device according to the connection diagram (2).

Installing the device into the wall box

3

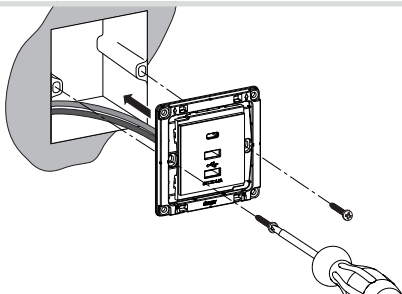

- After wiring, fix the device with the two screws attached into the wall box (3).

Assembling the frame

4

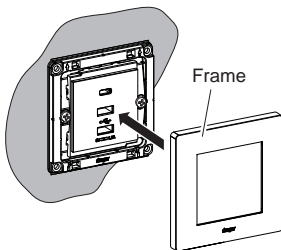

- Snap the frame onto the device (4).
- Remove the dust protection sticker.



WARNING!

To avoid possible damage to the product or spurious insulation readings, please **DISCONNECT** the product from the mains supply before carrying out insulation resistance testing!