

- (FR) Tore ouvrant pour relais différentiels
- (GB) Opening Torroid for HR relays
- (DE) Wandler zum öffnen für FI Relais
- (NO) Delbar spole for jordfeilreleer HR
- (IT) Toro apribile per rele HR
- (ES) Trafo diferencial abierto
- (PT) Toro aberto para rele HR

- Notice d'instructions
- User instructions
- Bedienungsanleitung
- Bruksanvisning
- Istruzioni d'impiego
- Instrucciones de uso
- Instruções

HR820, HR821, HR822, HR823, HR824

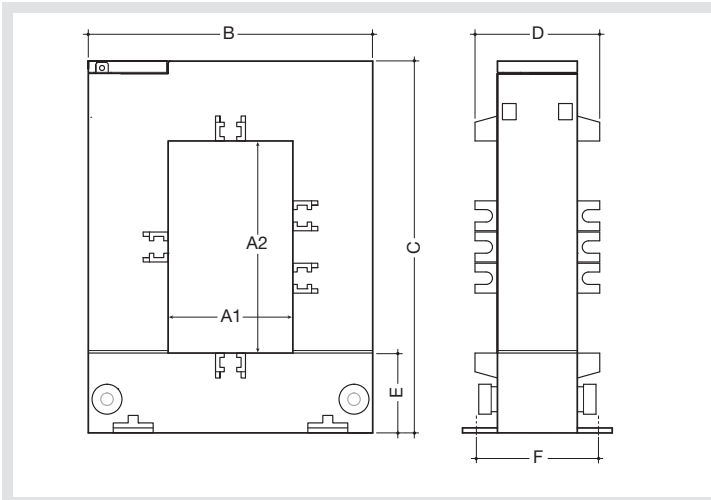
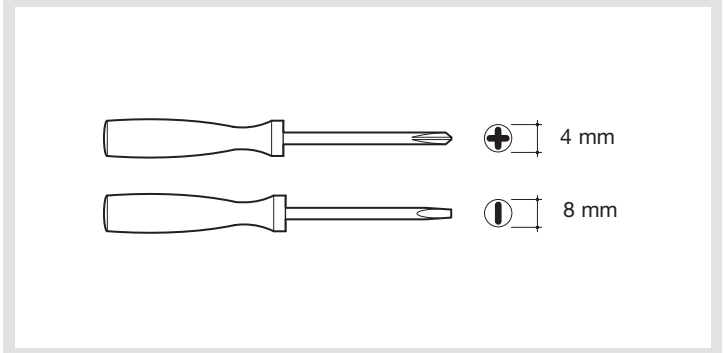
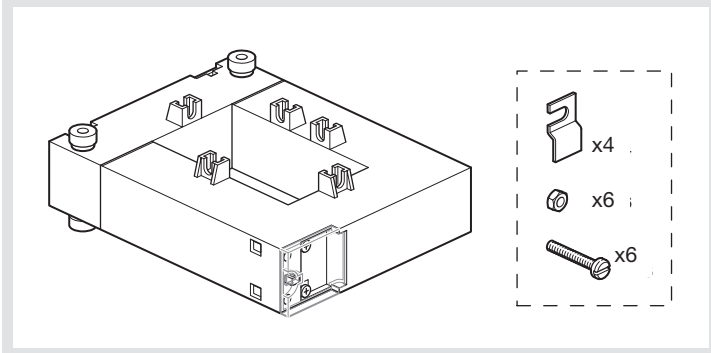
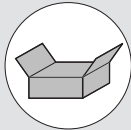

	A1	A2	B	C	D	E	F
HR820	20	30	89	110	41	32	46
HR821	50	80	114	145	50	32	46
HR822	80	80	145	145	50	32	46
HR823	80	121	145	185	50	32	46
HR824	80	161	184	244	70	37	46

