

- ⒹE Montageanleitung
- ⒻFR Notice d'instructions
- ⒼB Mounting instructions
- ⒾT Istruzioni di montaggio

uniway UW-Sxxx

- ⒹE Stecksocket 125A, 160A, 250A
- ⒻFR Socle enfichable 125A, 160A, 250A
- ⒼB Busbar socket 125A, 160A, 250A
- ⒾT Zoccolo a innesto 125A, 160A, 250A

UW-Sxxx

	U_e max.	I_n max.	I_{cw} max.
UW-S125-xx	690 V AC	125 A	10 kA / 300 ms
UW-S160-xx	690 V AC	160 A	10 kA / 300 ms
UW-S250-xx	690 V AC	250 A	12 kA / 300 ms

UW-K52	5x2mm	2m
UW-K103	10x3mm	2m
UW-K153	15x3mm	2m
UW-K253	25x3mm	2m

UW-Kx
Cu-ETP CW004A
(EN 13601)

M6	L
UW-S125-xx	50mm
UW-S160/250A-xx	65mm

⊙ SW6 (M = 4 Nm)

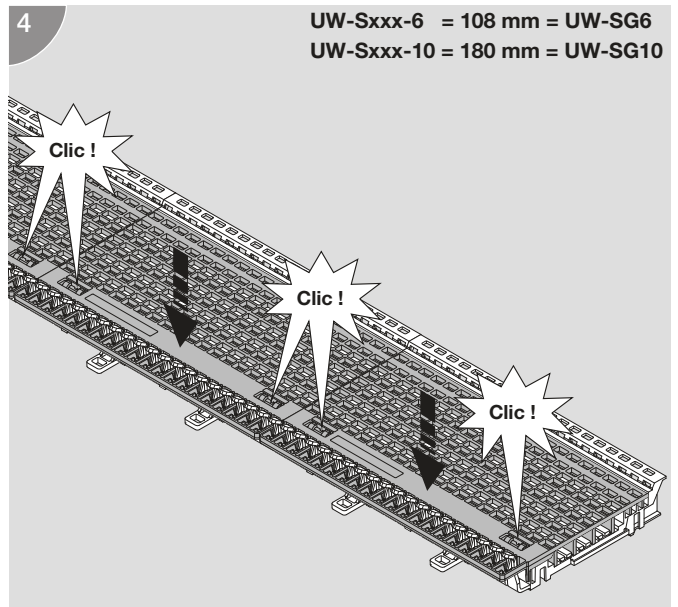
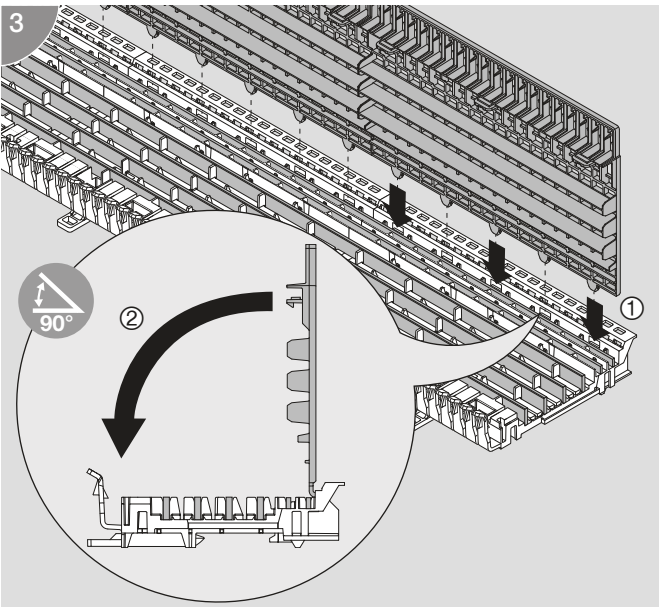
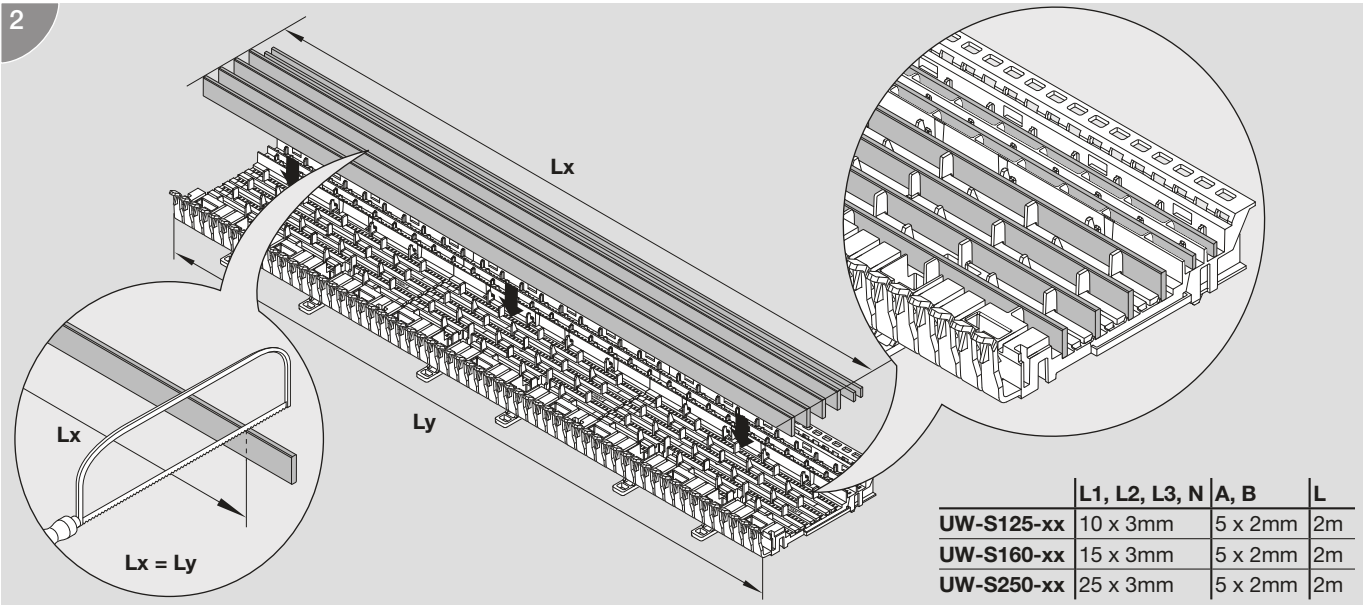
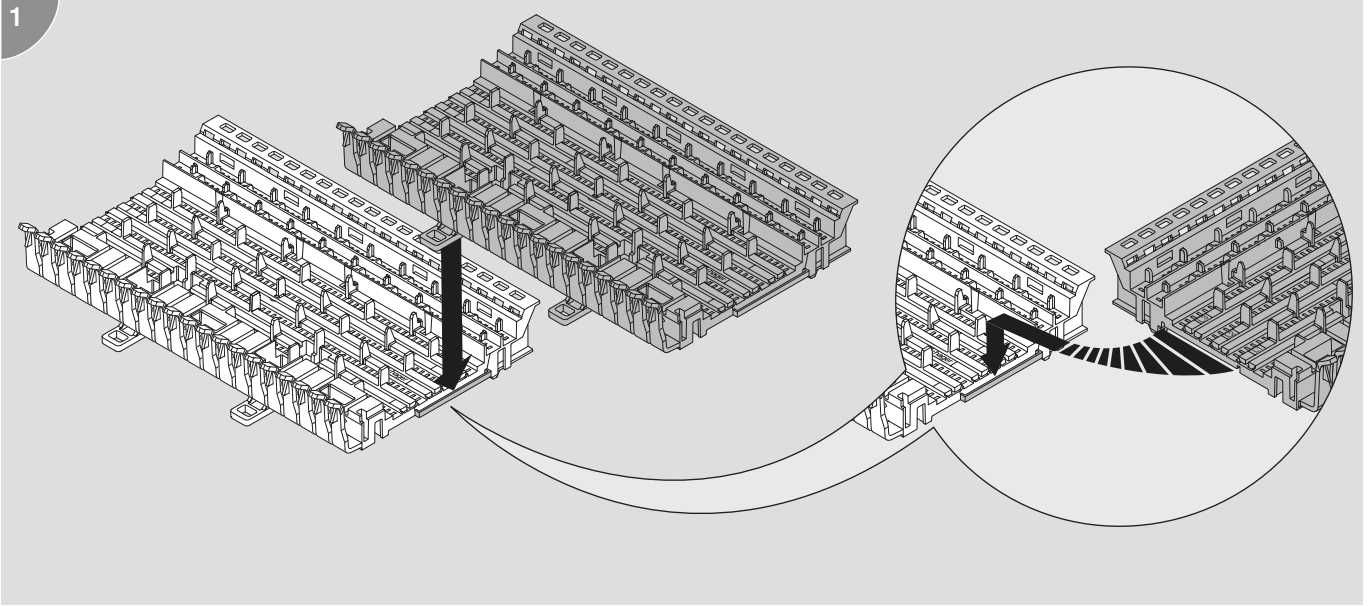

UW-SE

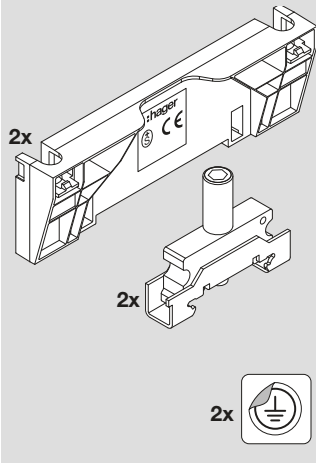

1

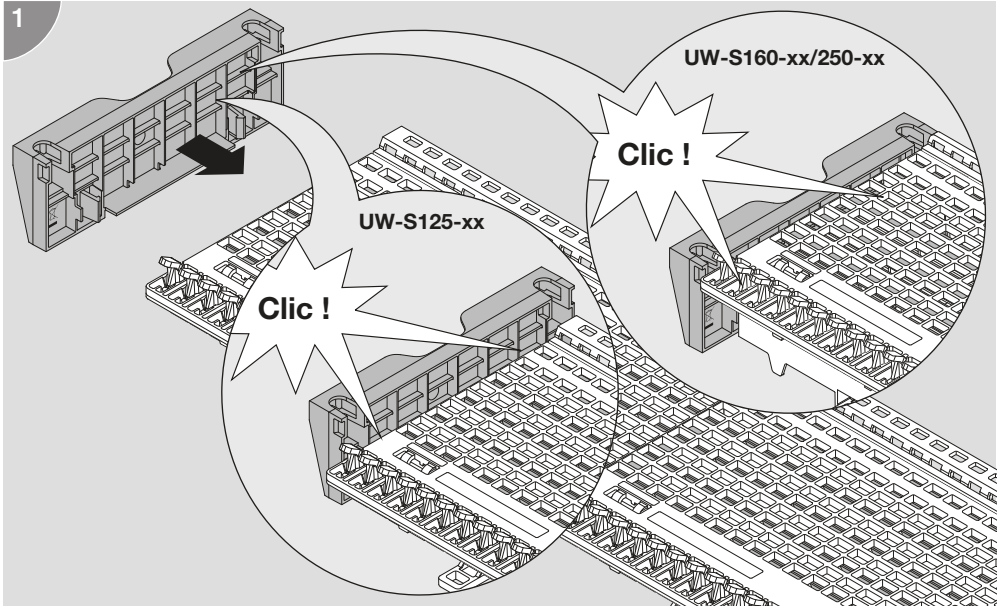

2 UW-S125-xx

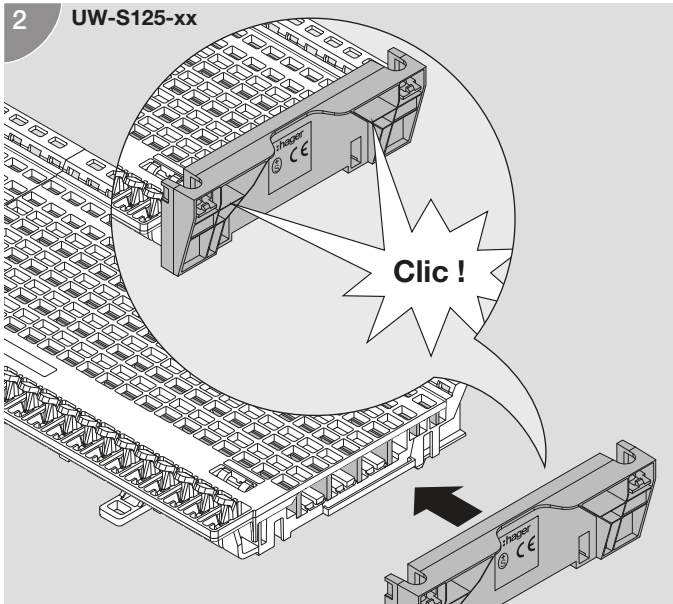

UW-S160-xx/250-xx

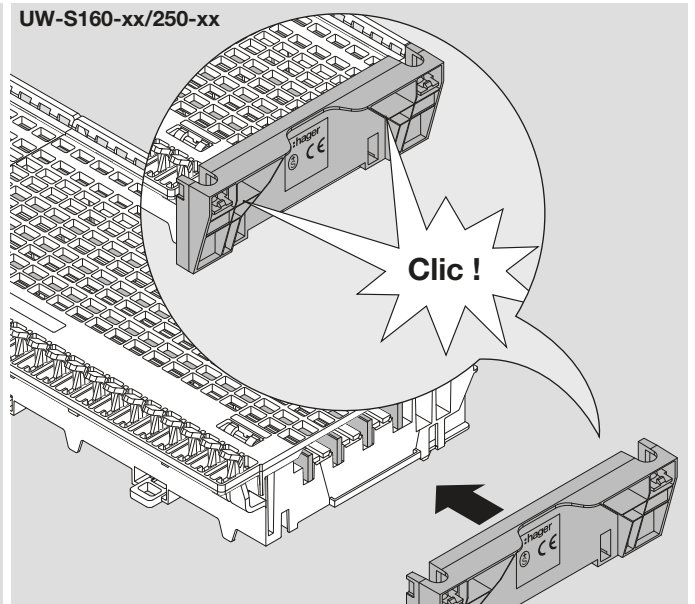

3

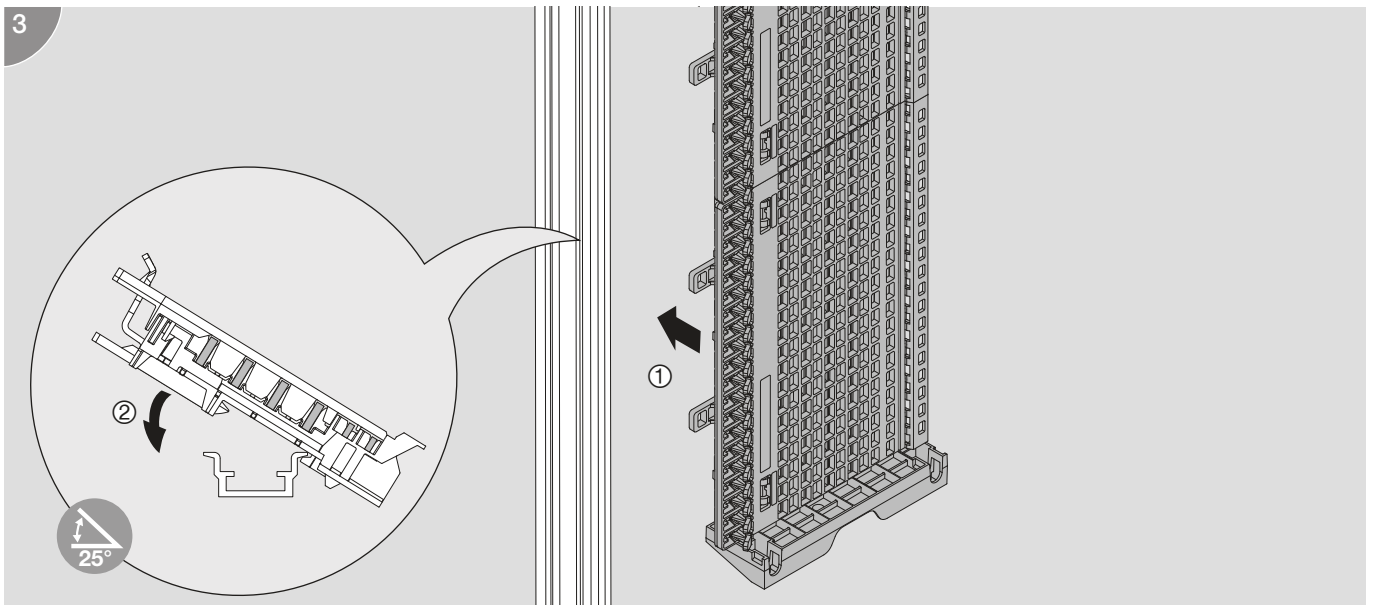

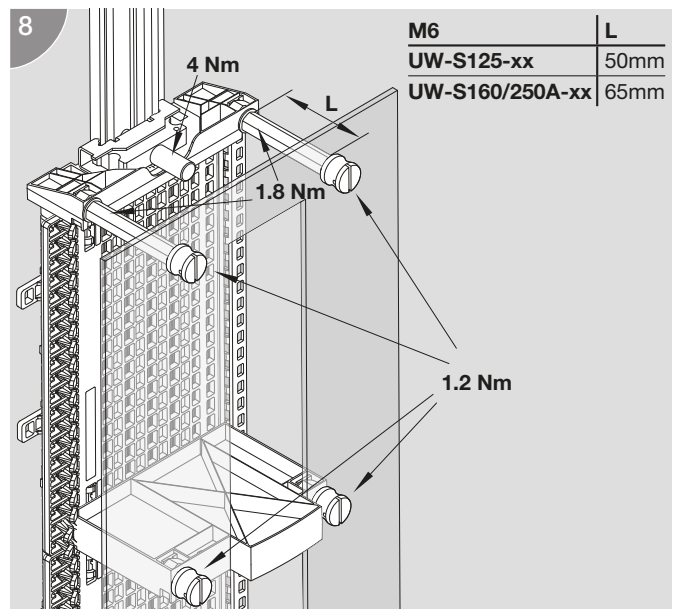
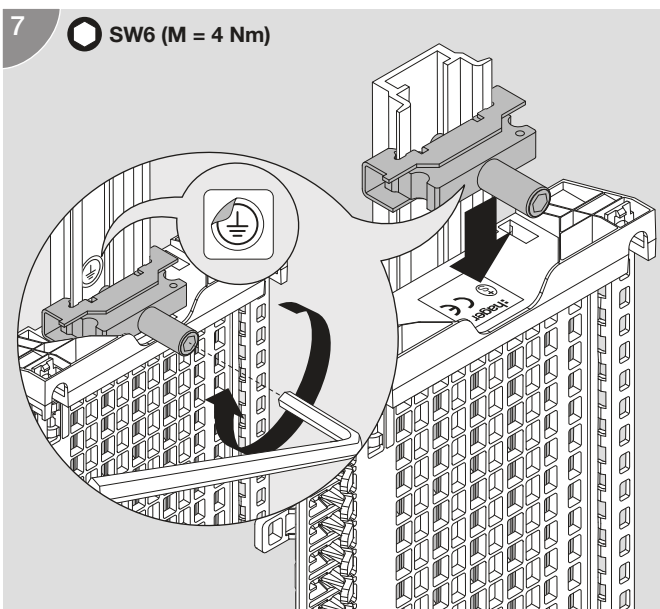
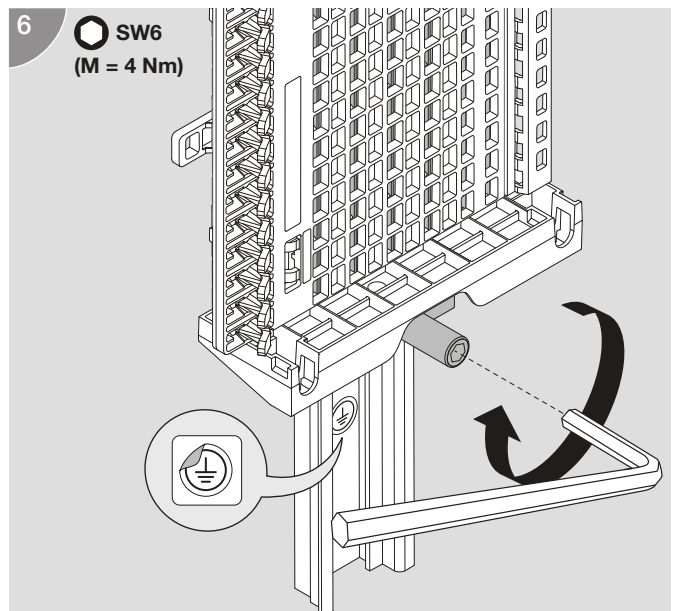
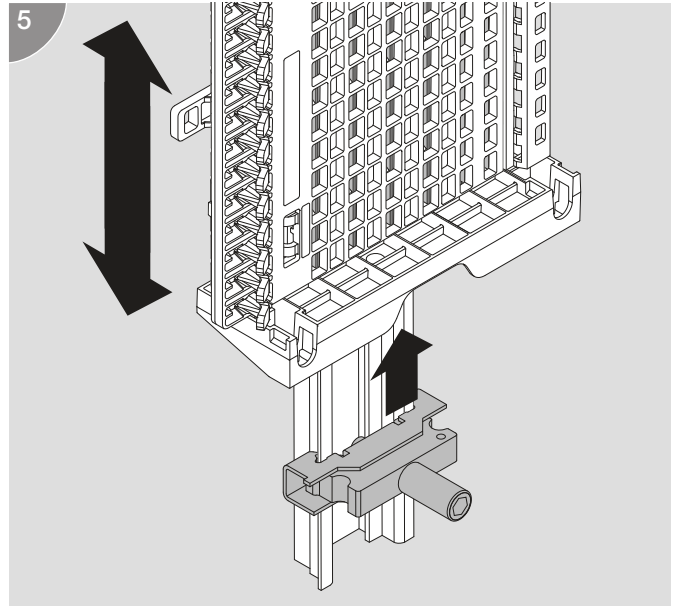
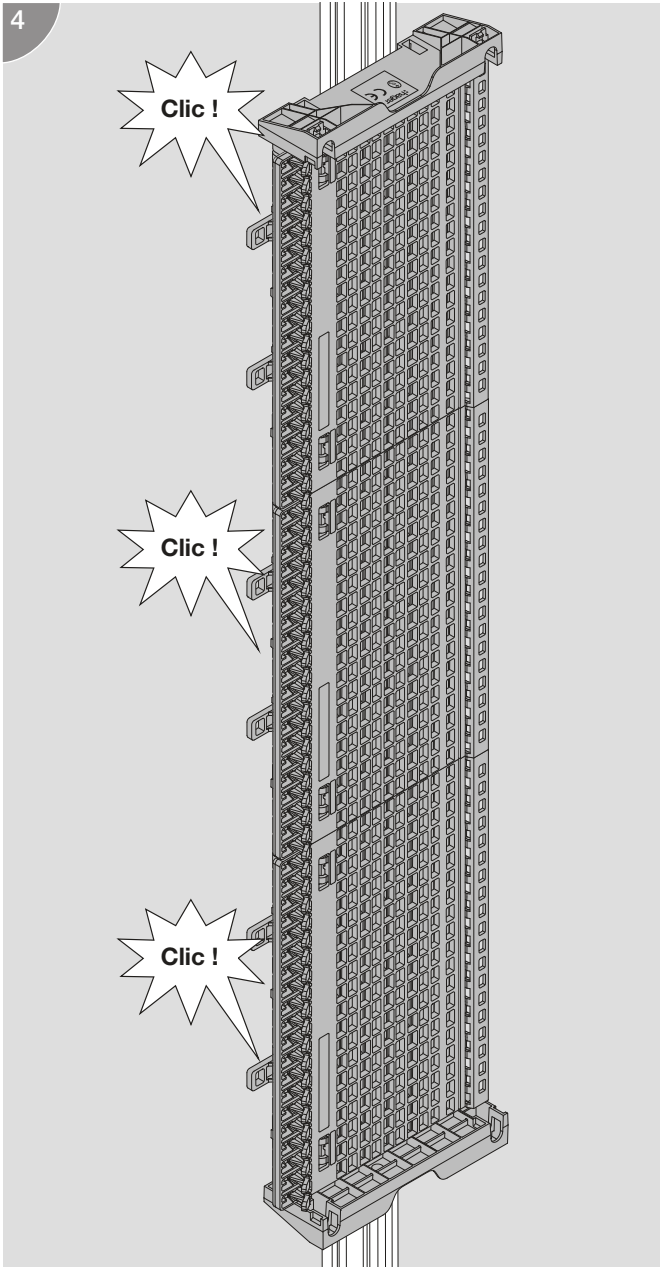

UW-PE

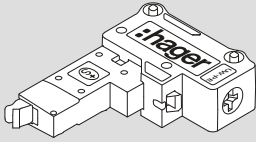

U_e max.	400 V AC
I_n max.	63 A

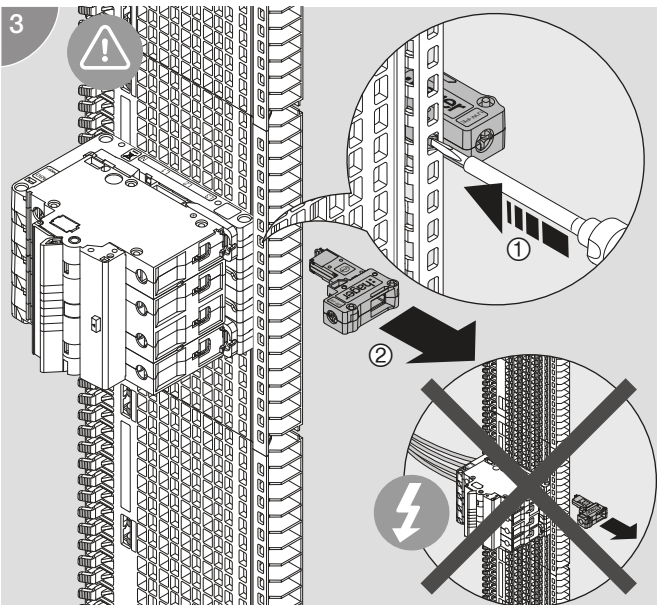
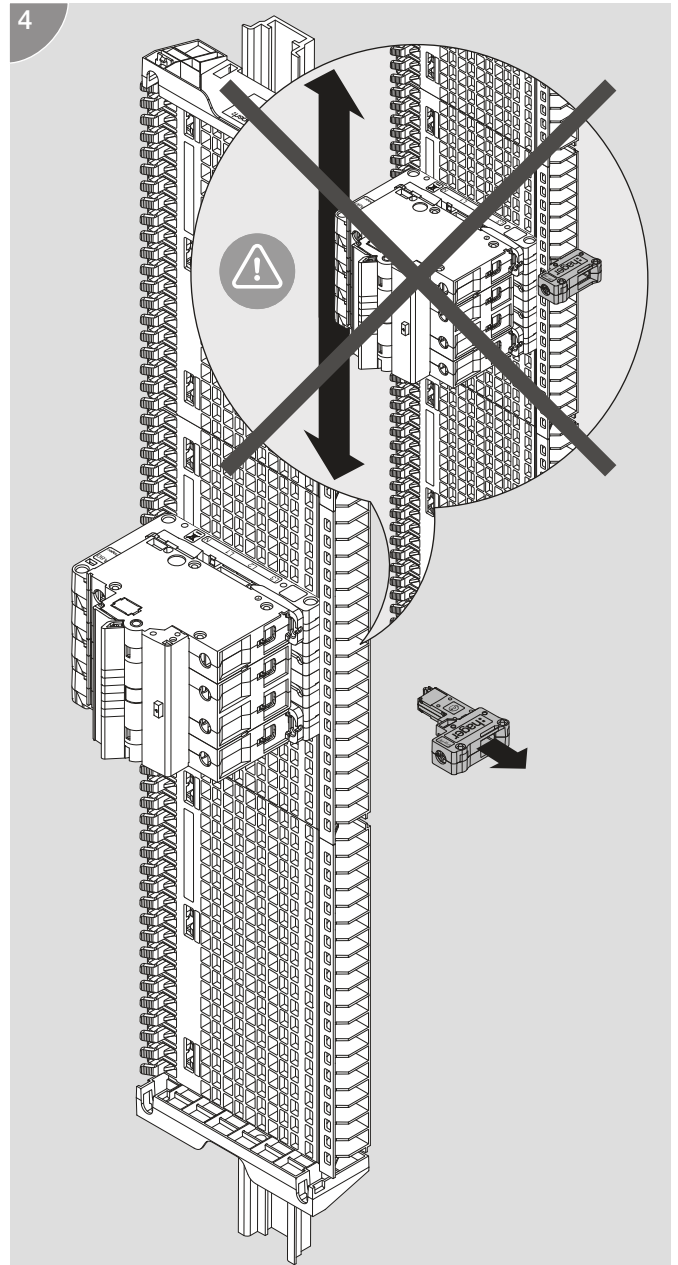
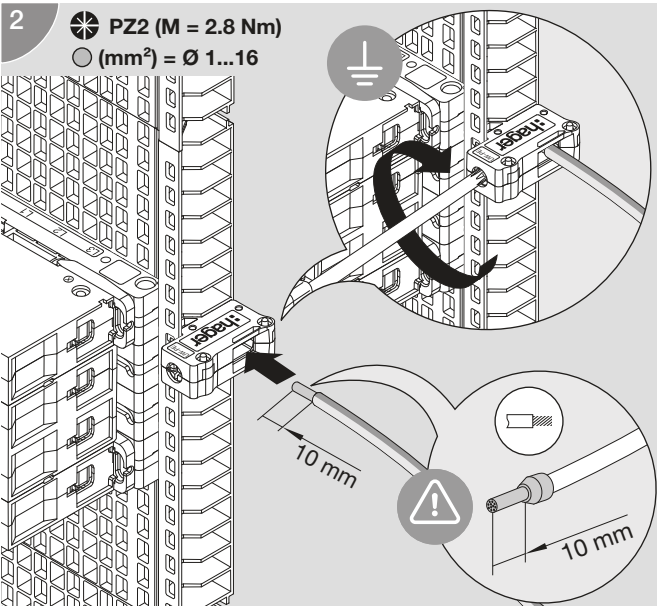
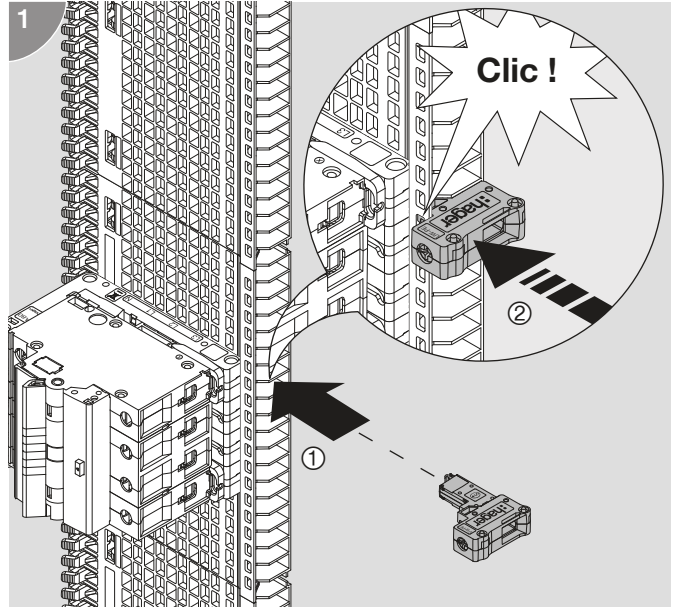



Hauptsitz

Hager AG
Sedelstrasse 2
CH-6020 Emmenbrücke
Tel. +41 41 269 90 00

Verkaufsniederlassungen

Hager AG
Glattalstrasse 521
CH-8153 Rümlang
Tel. +41 44 817 71 71

Hager AG
Ey 25
CH-3063 Ittigen-Bern
Tel. +41 31 925 30 00

Hager AG
Chemin du Petit-Flon 31
CH-1052 Le Mont-sur-Lausanne
Tel. +41 21 644 37 00

hager.ch
infoch@hager.com