

(AU)

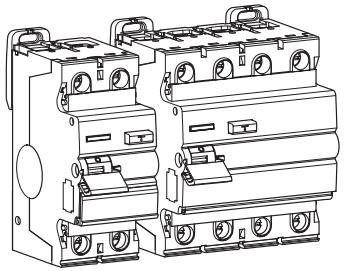

**i** (GB) For the tripping times verification tests, in an electrical installation, Hager certifies that the RCDs, of the Hager brand, conforming to standards EN 61008-2-1, EN 61009-2-1, trip under a current of  $5 \cdot I_{\Delta n}$  in accordance with the times imposed in table 41.1 of standard DIN VDE 0100-410 (VDE 0100-410) 2018-10.

## Safety switch (RCCB's) 25 - 100 A

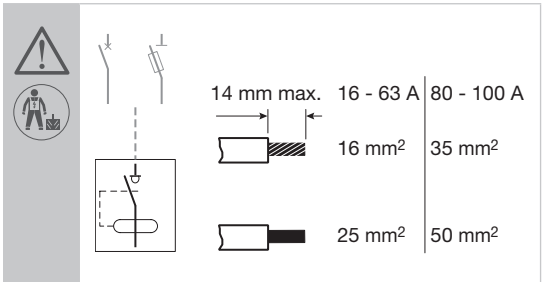

**Safety instructions**  
 The installation and mounting of electrical appliances must only be performed by qualified electricians, in compliance with installation standards and in accordance with the guidelines, provisions and safety and accident prevention regulations in force in the country concerned.

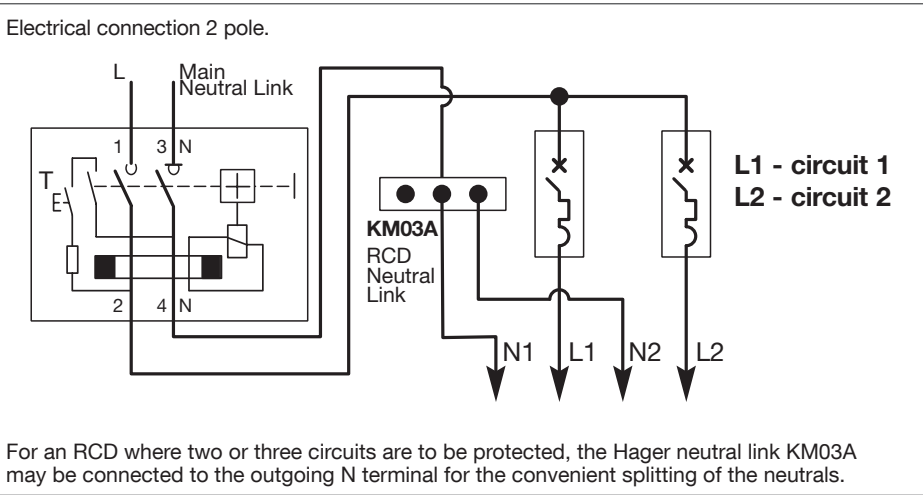

### Please note the following

- 1 - The current rating per pole of the RCCB must not be exceeded by the maximum demand of the protected circuits.
- 2 - If RCCB trips OFF after installation, locate and repair faulty appliances (cumulative leakage from a number of appliances may exceed the RCCB tripping current, causing RCCB to trip OFF).
- 3 - The "main neutral" and "main earth" should be checked to ensure good connection.
- 4 - If RCCB trips intermittently will not reset, or test button will not work, check for low insulation resistance between neutral & earth wiring.
- 5 - RCCB may be fed in any position: LOAD and LINE circuits may be connected top or bottom.

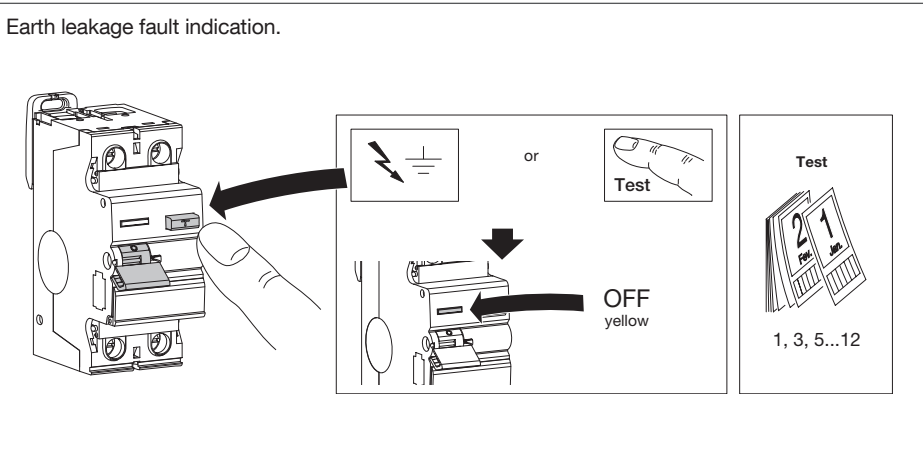
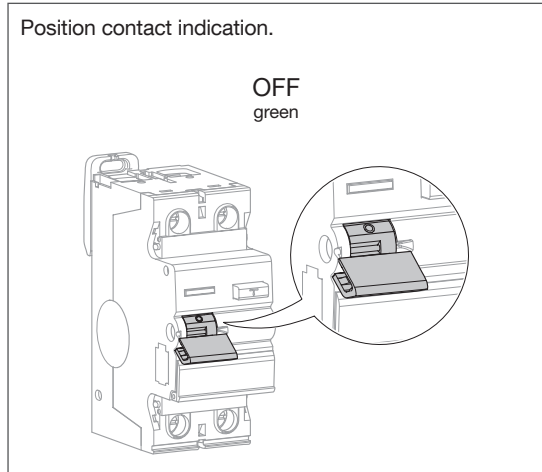
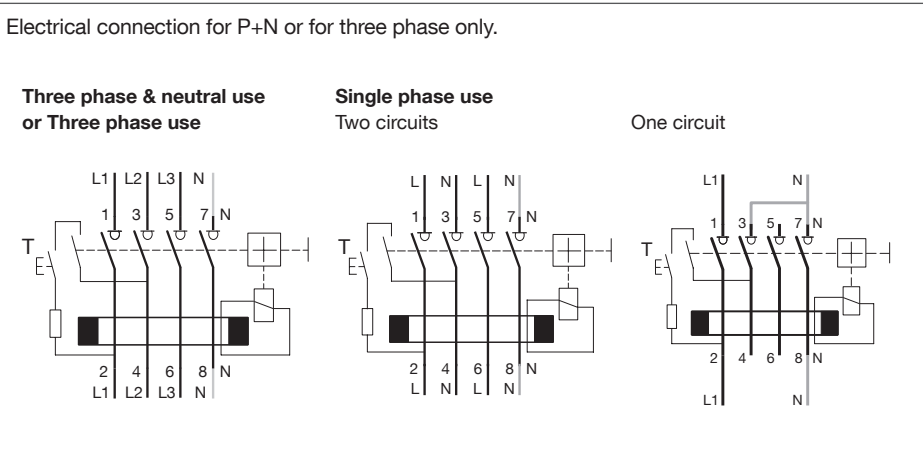

Single phase connection.

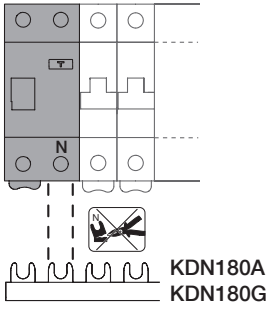

Three phase connection.

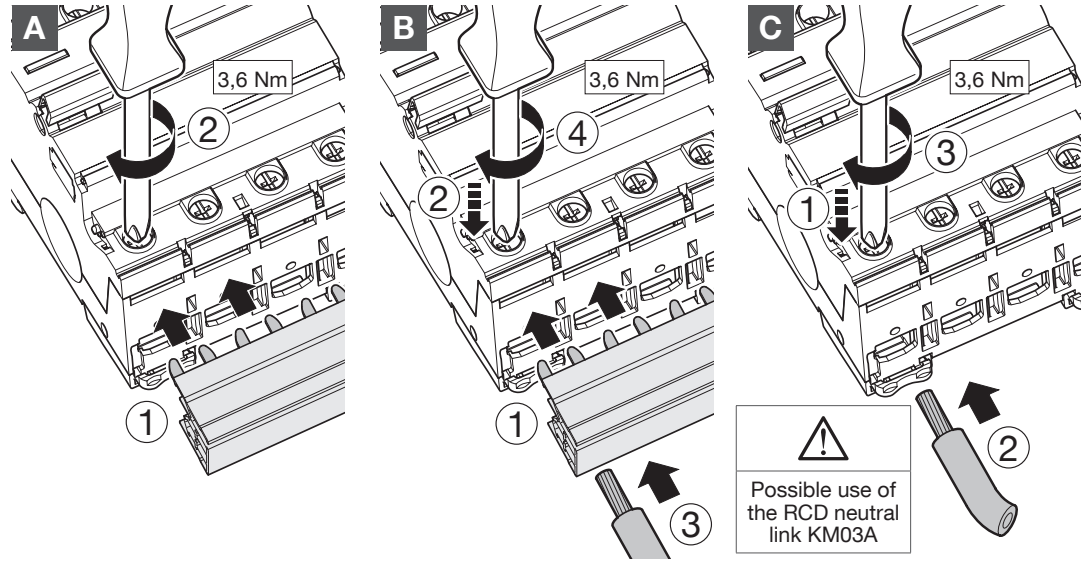
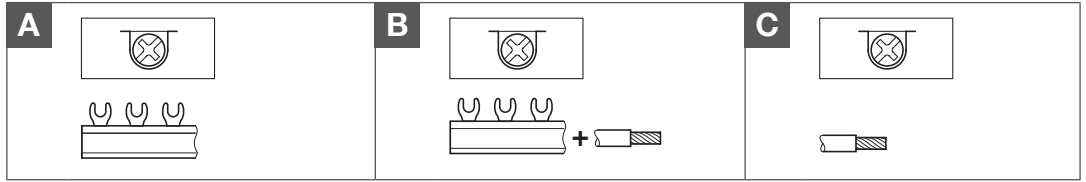
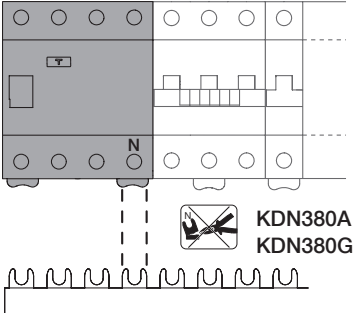

Auxiliary possibilities.

- MZ201
- MZ202
- MZ203
- MZ204
- MZ205
- MZ206

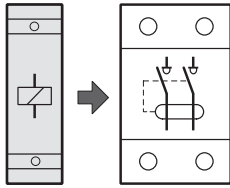

Locking device for handle MZN175.

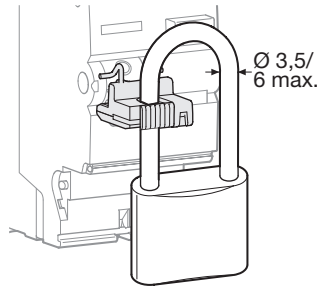

Protection against dust

In case of work activities nearby, make sure that the electrical installation is protected against dust if the enclosure is not IP5x.