

Residual current operated circuit-breaker RCBO with switched neutral 6 to 32A

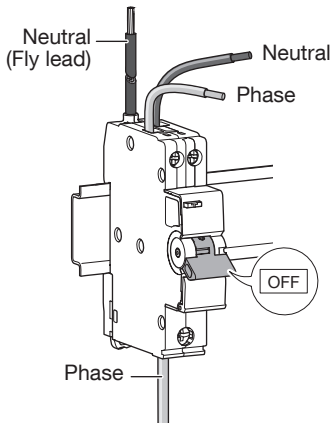

This device is to be installed only by a professional electrician fitter according to local applicable installation standards.
Do not plug in or unplug this product when it is live.
Conform to TBTS installation rules.

Electrical connection



This device can be wired either from the top or bottom without any alteration of its functions (bi-directional device).

230/240V~50Hz

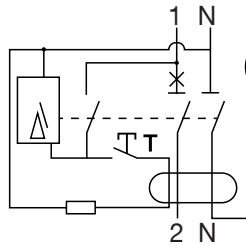

	BOTTOM	TOP
(mm ²)	1 to 16 2 x 10	1 to 16 2 x 6
	12 mm	10 mm
	⊕ PZ2	⊕ PZ2
	2,1 Nm	1,9 Nm

Easy dismantling with the plastic DIN rail clip

01

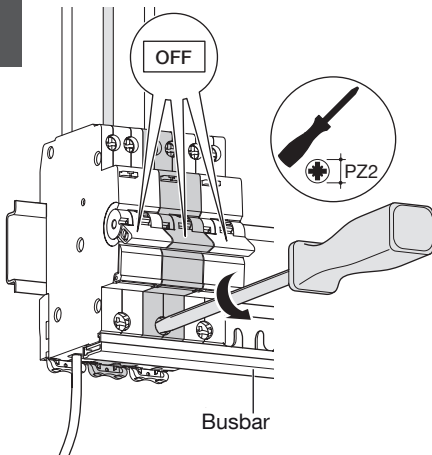

02

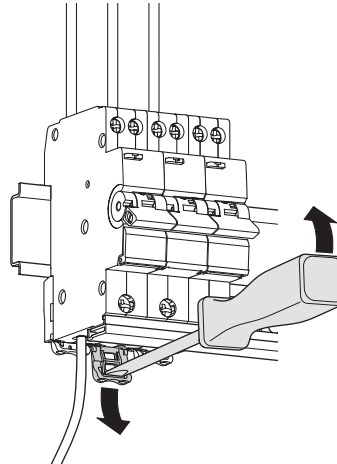

03

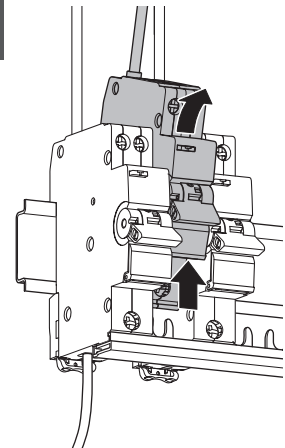

Locking device for handle MZN175



RCBO 1 module suitable for DIN rail mount & Invicta panel board

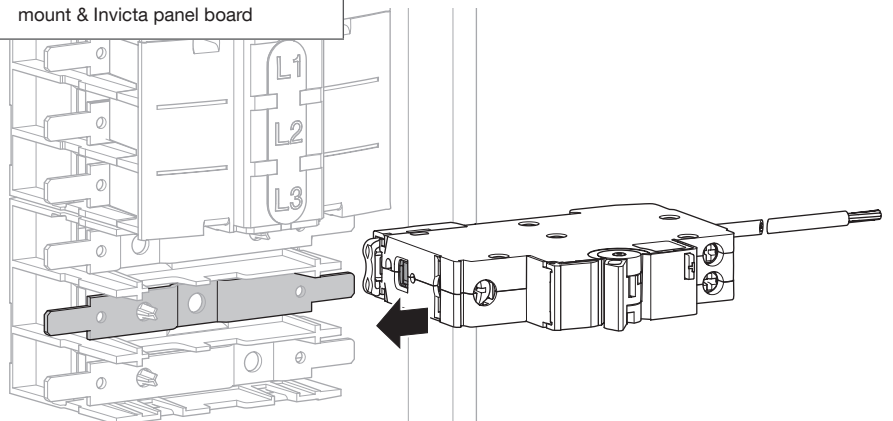
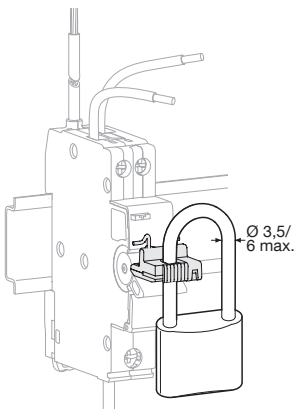

TEST

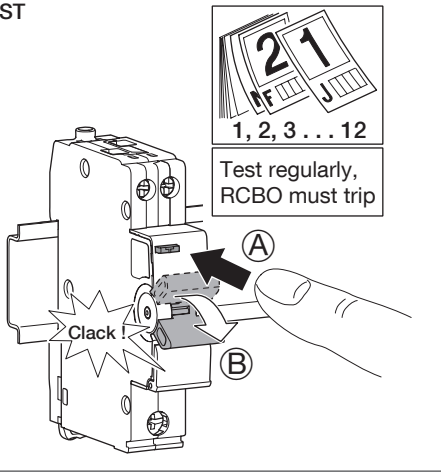

IR TEST

