

## Residual current operated circuit-breaker RCBO with switched neutral 6 to 32A

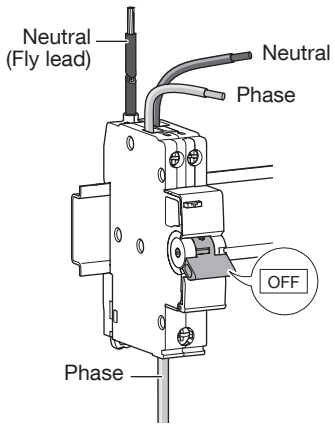

This device is to be installed only by a professional electrician fitter according to local applicable installation standards.  
Do not plug in or unplug this product when it is live.  
Conform to TBTS installation rules.

### Electrical connection



This device can be supplied either from the top or bottom without any alteration of its functions (bi-directional device).

230/240V~50Hz

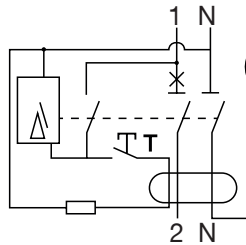

|                    | BOTTOM            | TOP              |
|--------------------|-------------------|------------------|
| (mm <sup>2</sup> ) | 1 to 16<br>2 x 10 | 1 to 16<br>2 x 6 |
|                    | 12 mm             | 10 mm            |
|                    | ⊕ PZ2             | ⊕ PZ2            |
|                    | 2,1 Nm            | 1,9 Nm           |

### Easy dismounting with the plastic DIN rail clip

01

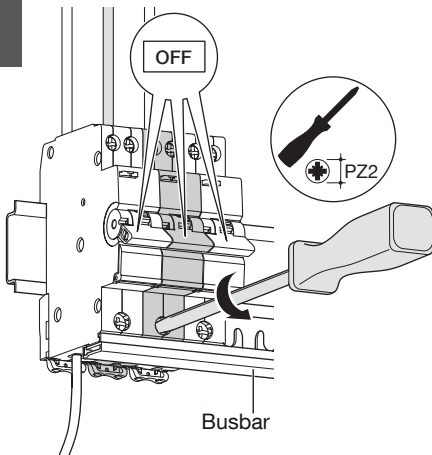

02

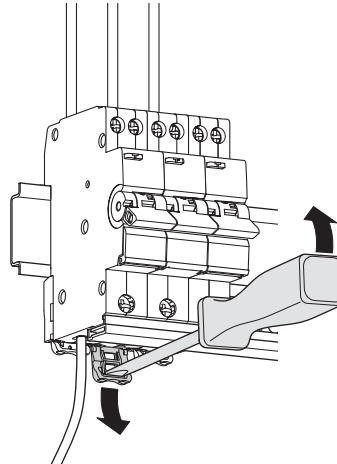

03

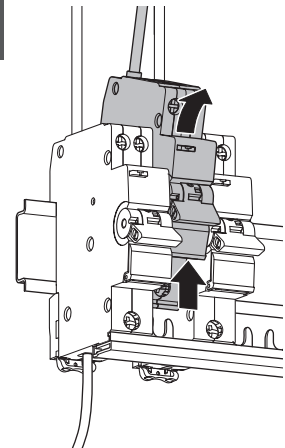

### Locking device for handle MZN175



RCBO 1 module suitable for DIN rail mount & Invicta panel board

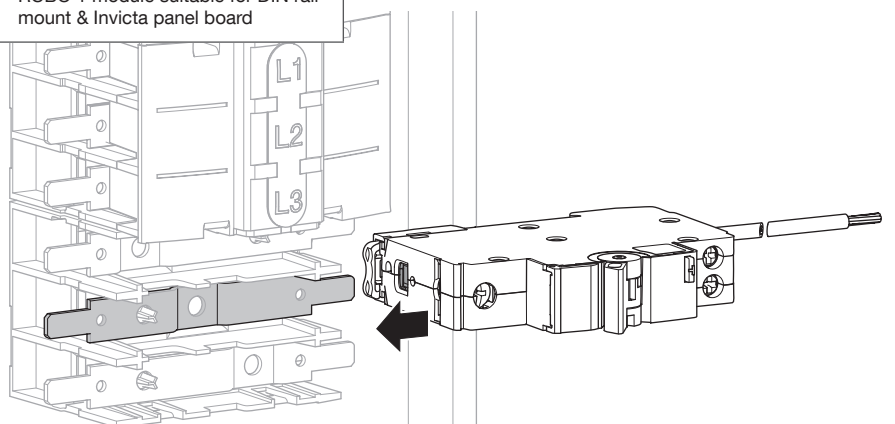
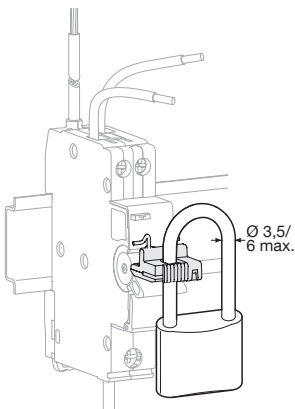

## TEST

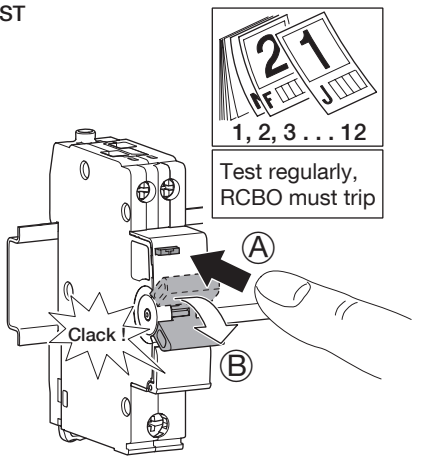

## IR TEST

