

## GA01N

Panneaux de contrôle (Type A) monophasé pour branchement à puissance limitée (tarif bleu) pour compteur Linky ou CBE et disjoncteur de branchement maximum 60 A



### Fixations :

170 x 100	- sur mur
230 x 100	- sur goulotte
	- sur rehausse

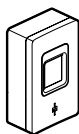

Compteur Linky +  
Disjoncteur de  
branchement

ou

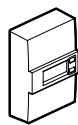

Compteur CBE +  
Disjoncteur de  
branchement

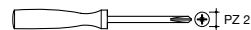
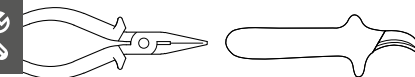
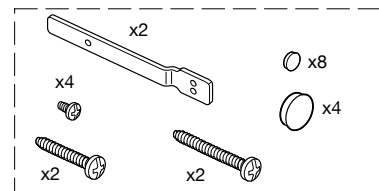
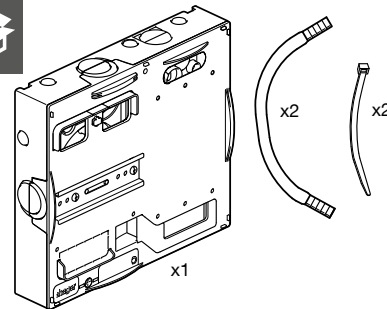
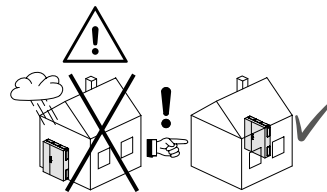
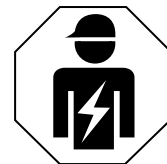
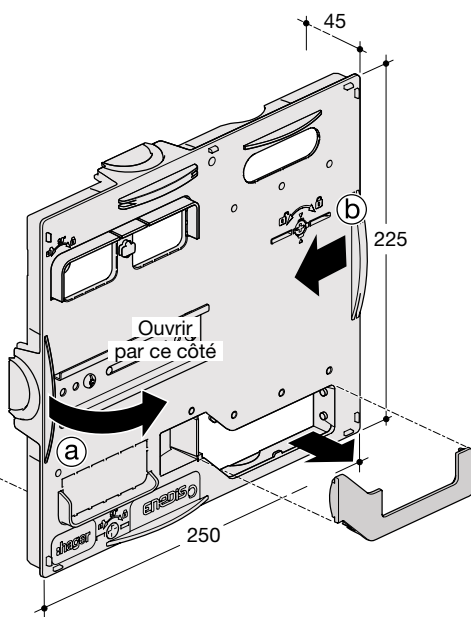
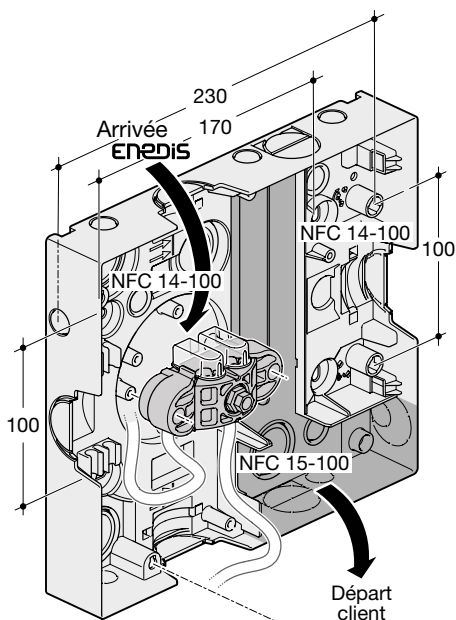

### Outils autorisés pour le serrage de la borne :

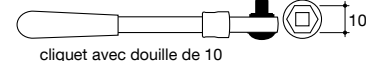
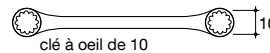
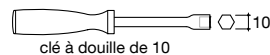

Veillez utiliser uniquement l'un des 3 outils représentés. L'utilisation d'un autre outil ou d'un outil électromécanique n'est pas adapté au serrage de la borne.

### 01a Fixation murale

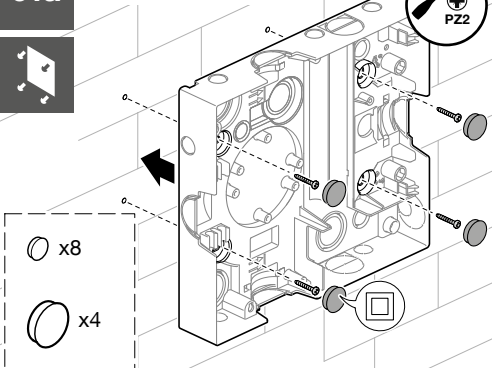

⚠ Jeu de 4 vis "fixation murale" non fourni.

### 01b Fixation sur goulotte Gamma

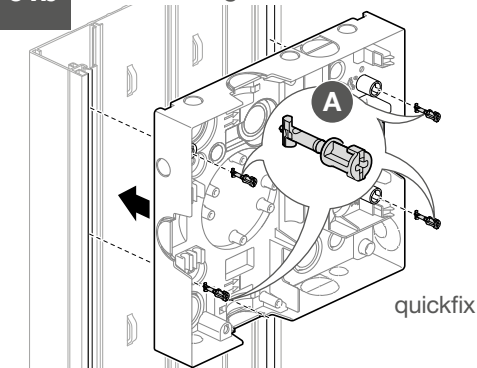

⚠ Jeu de vis "quickfix" pour la fixation sur la goulotte incluse dans la goulotte Gamma.

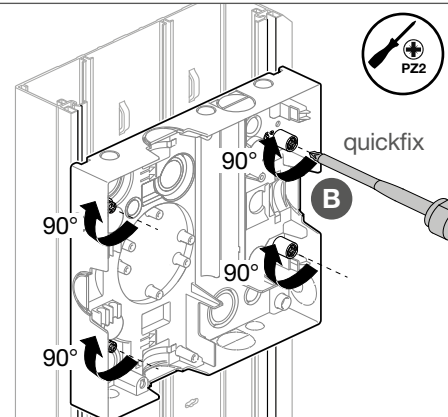

**01c** Montage au-dessus du coffret



1,8 Nm

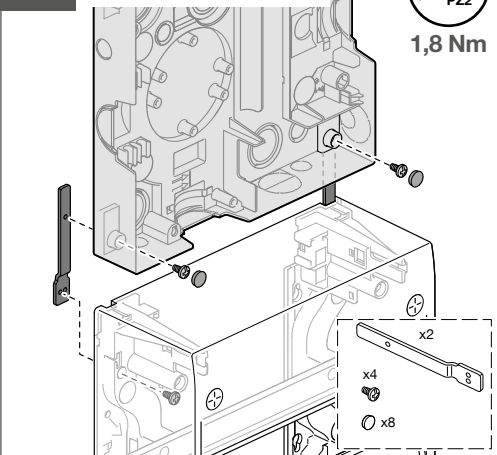

**01d** Montage au-dessous du coffret



1,8 Nm

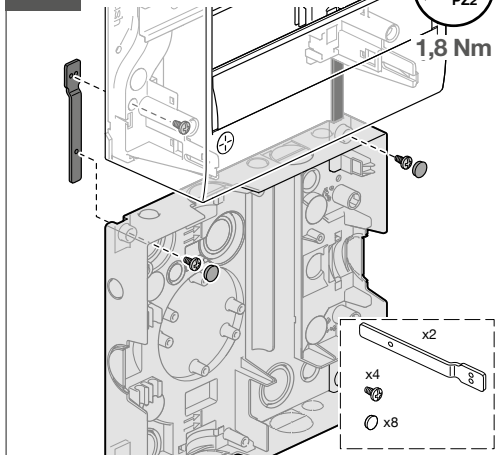

**0** Entrées de tubes

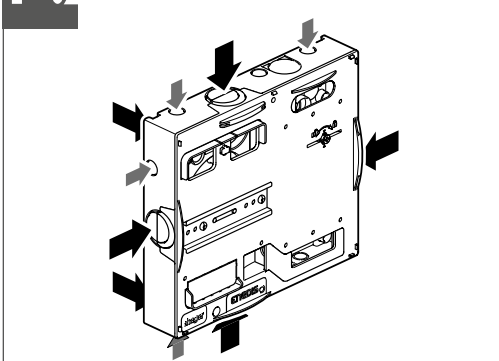

Arrivée ENEDIS + câble téléreport  
Les câbles doivent arriver sous conduit jusque dans le domaine de la NFC 14-100

**01**

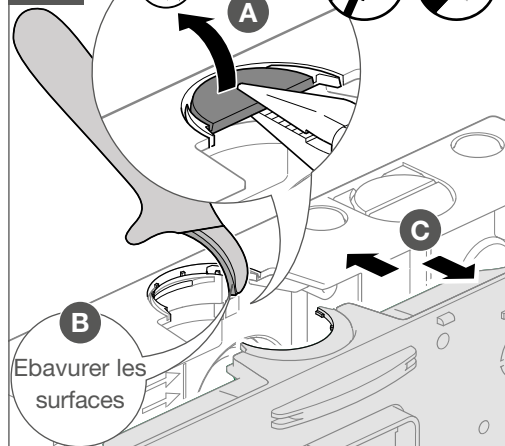

**02**

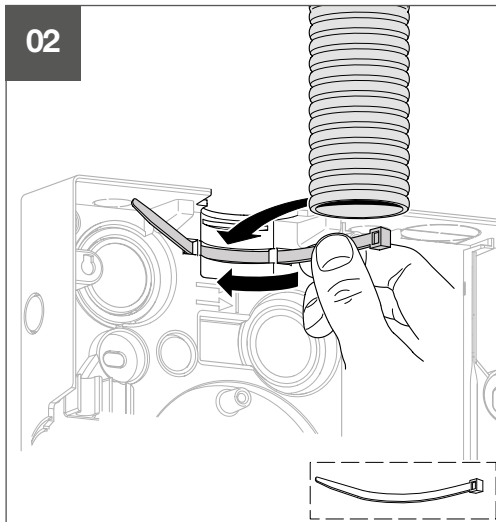

**i**

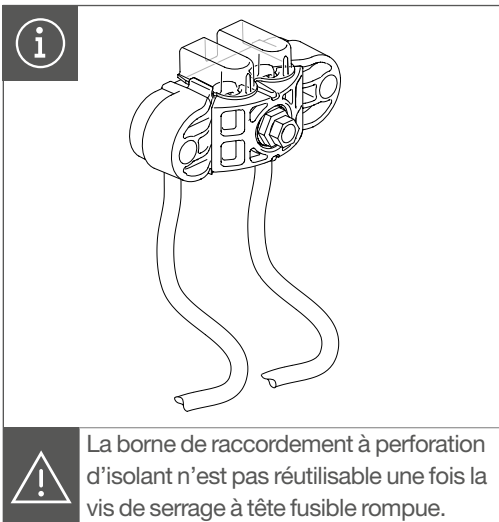

**01**



1,4 Nm

Montage du compteur Linky et CBE

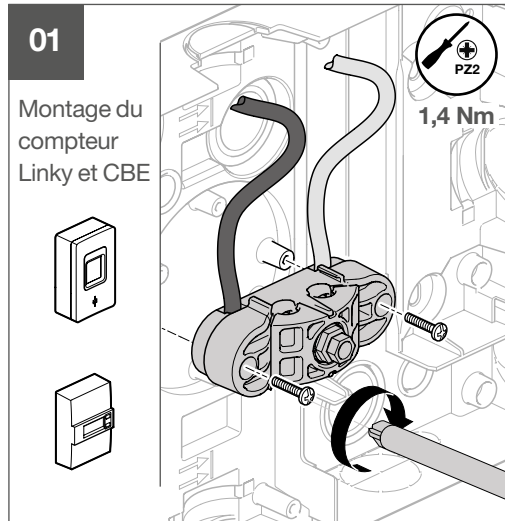

**02**

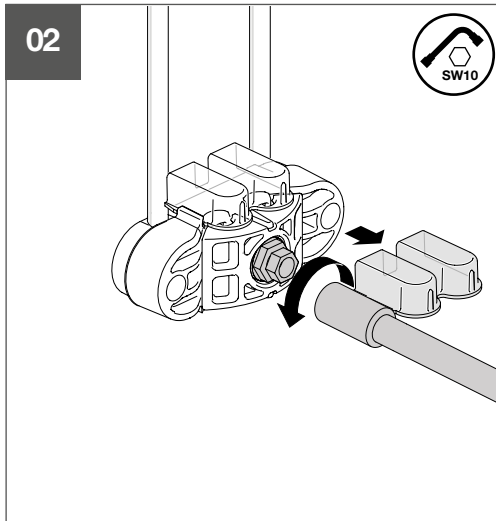

**03**

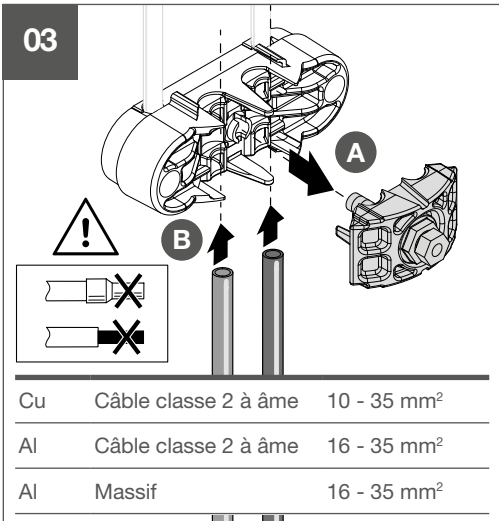

**i**

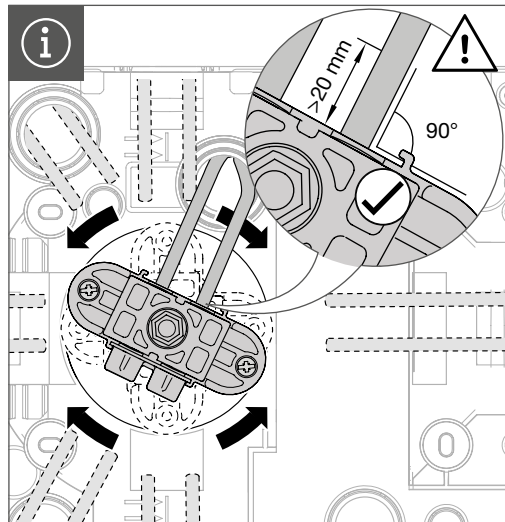

**04a**

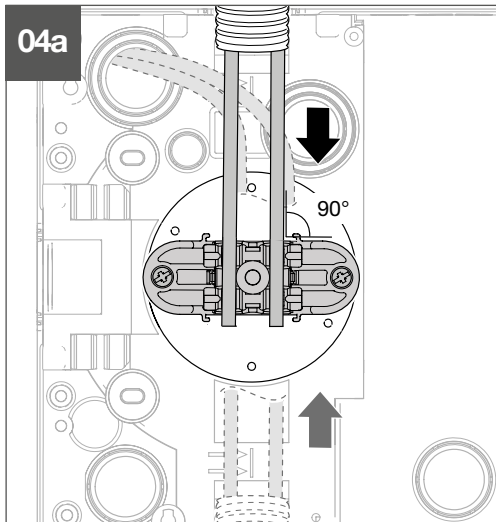

**04b**

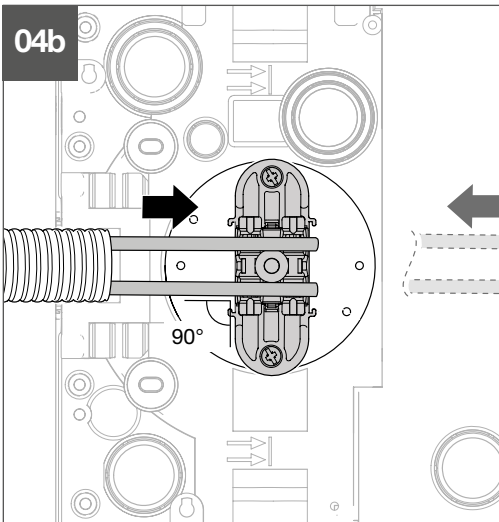

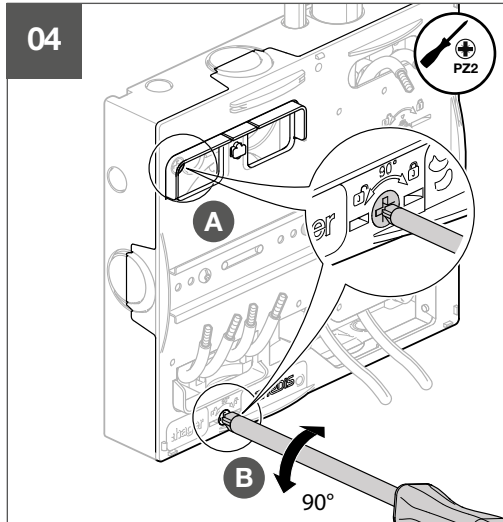
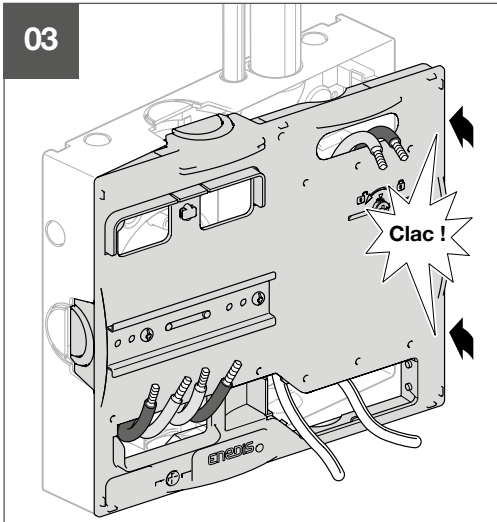
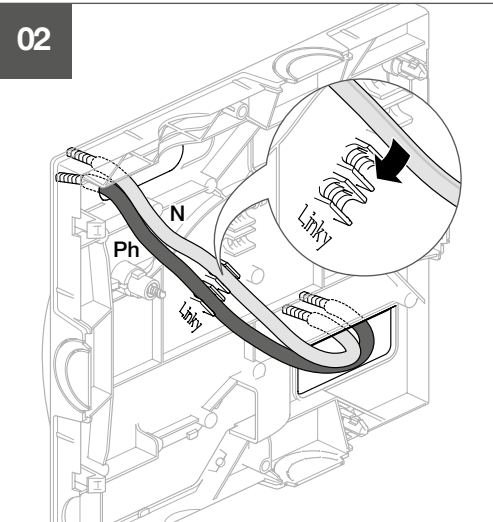
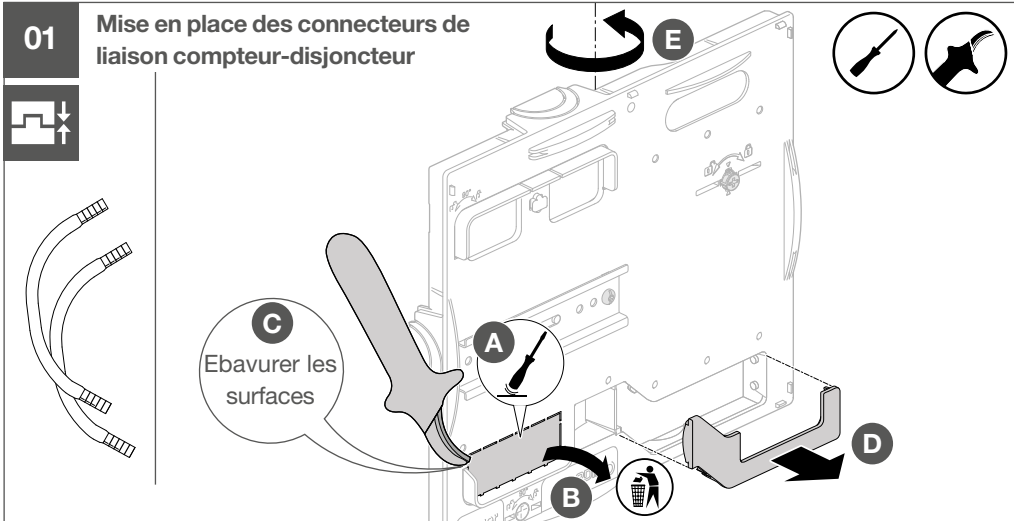
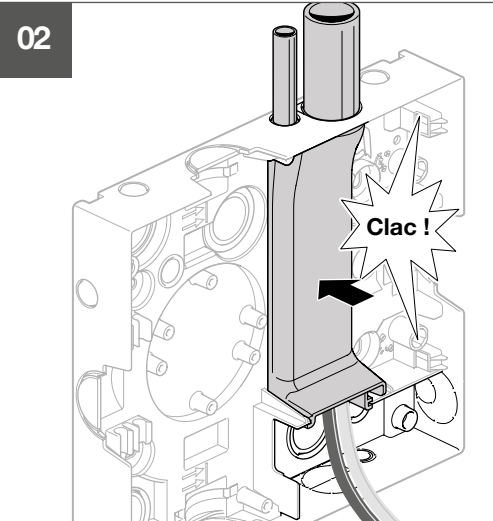
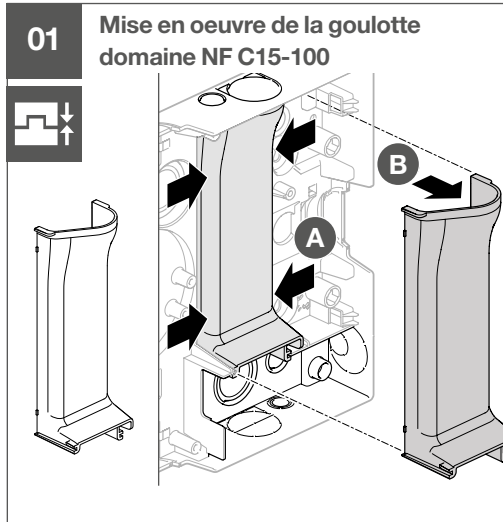
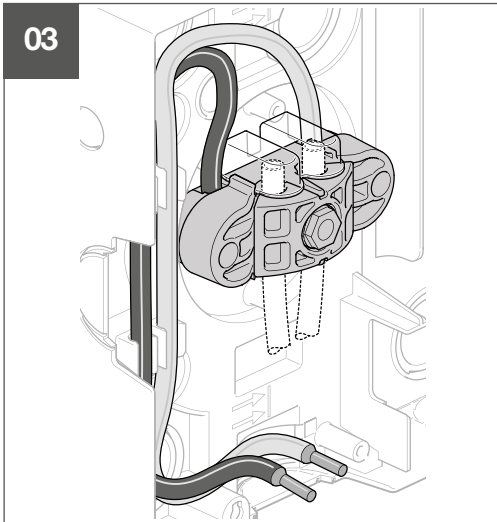
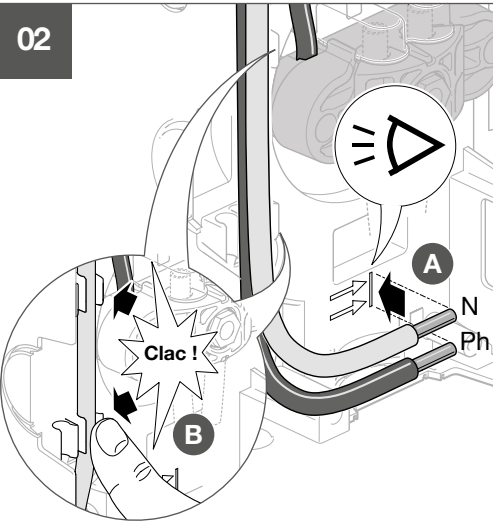
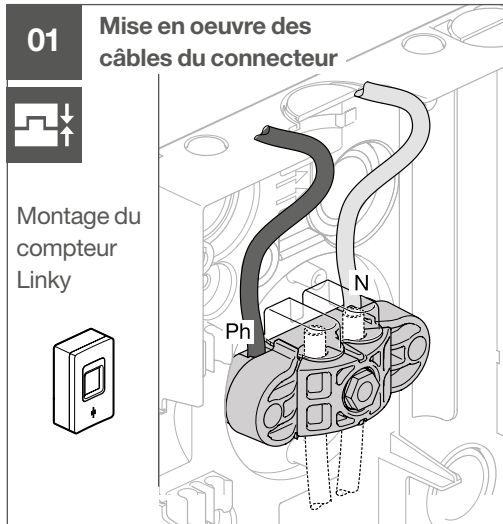
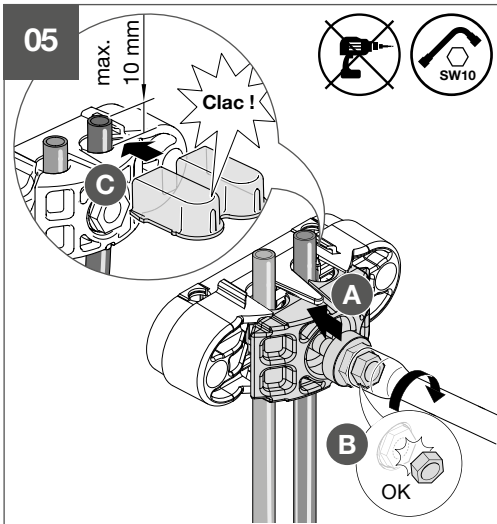
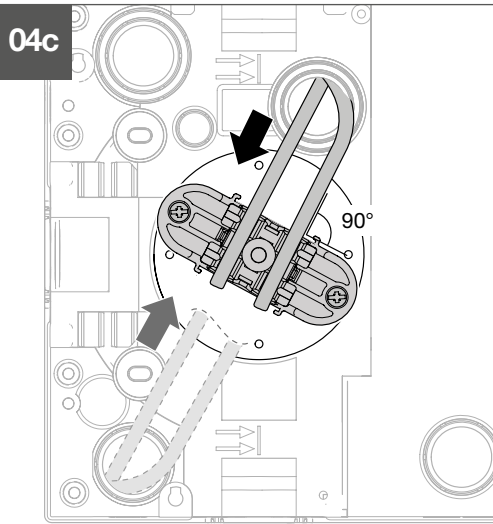

05

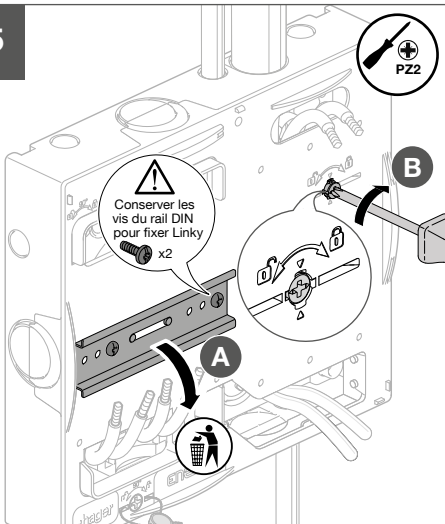

06

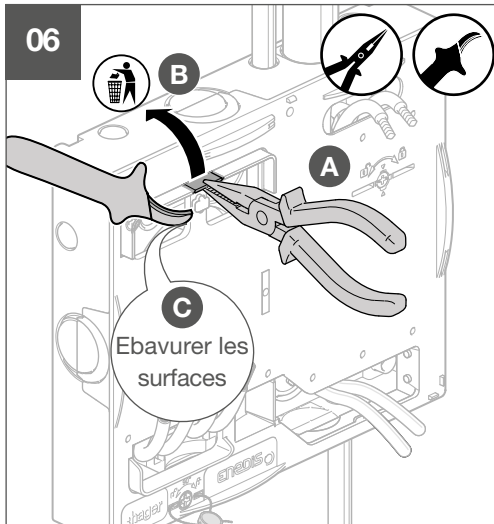

07

Utiliser le cache de filerie comme cale d'épaisseur

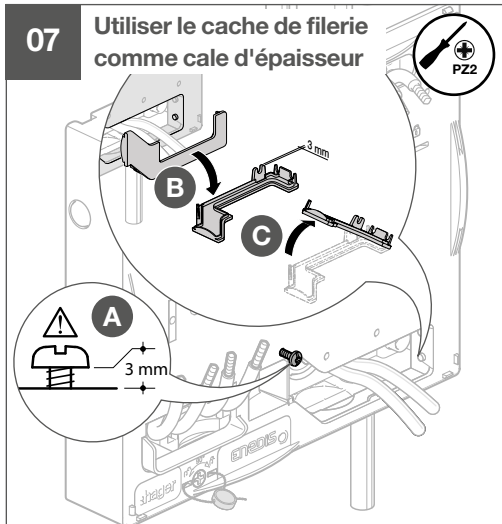

08

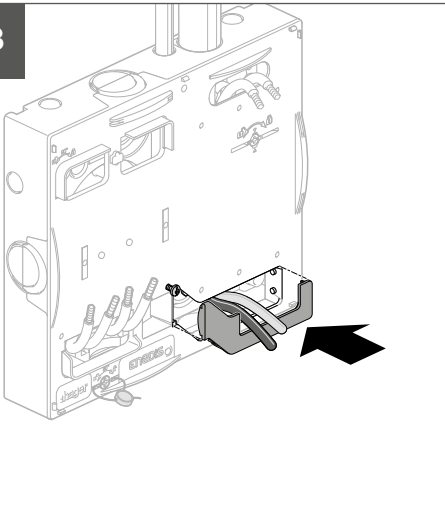

09

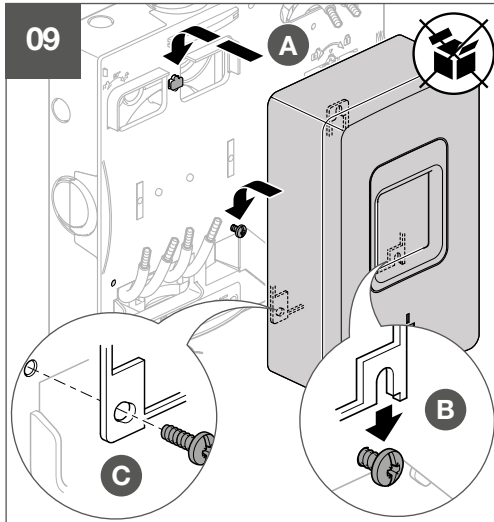

07

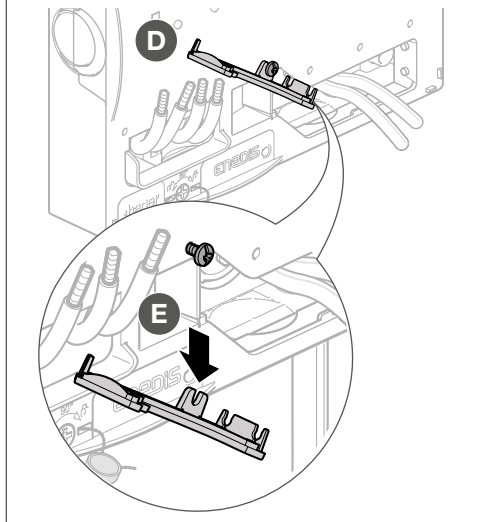

10

Mise en place du disjoncteur



2,7 Nm

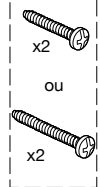

7 - 10 mm

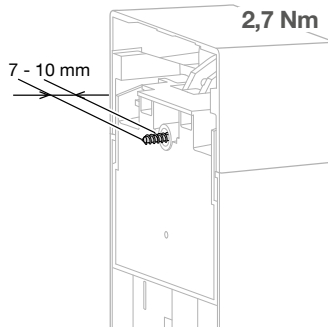

Choix de la vis de fixation pour le disjoncteur de branchement

11

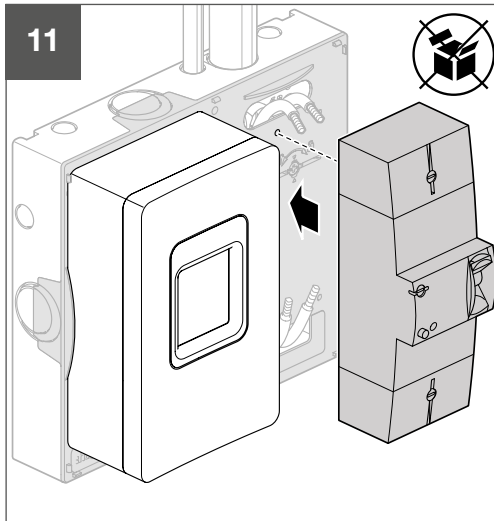

01

Mise en oeuvre des câbles du connecteur



Montage du compteur CBE

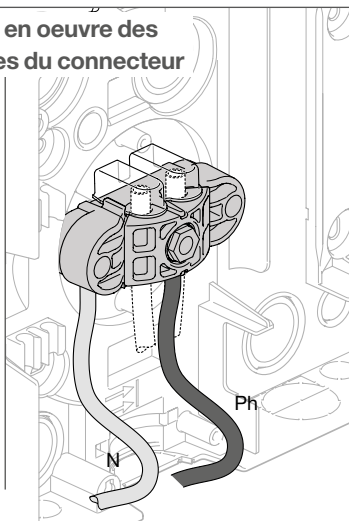
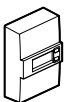

02

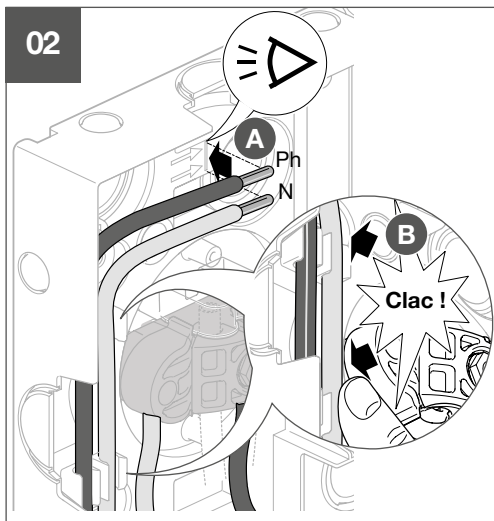

03

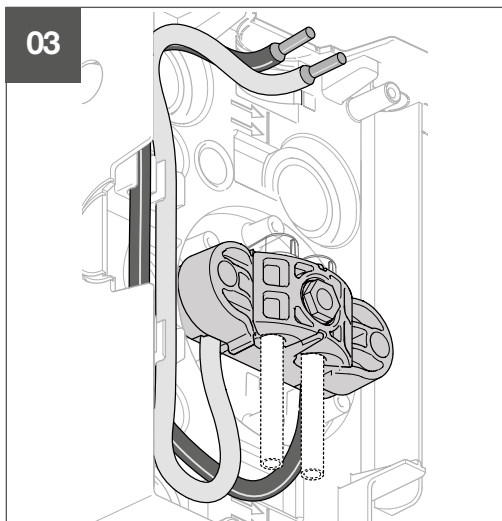

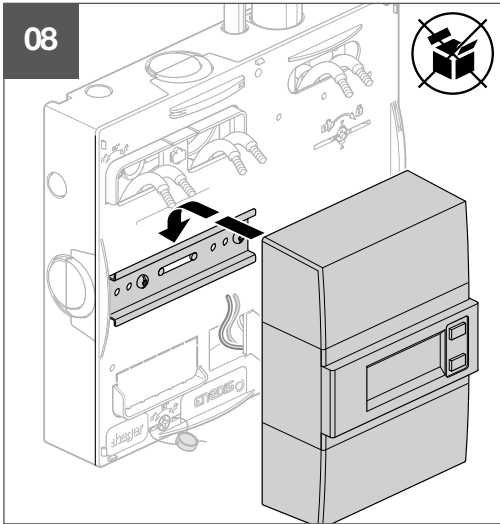
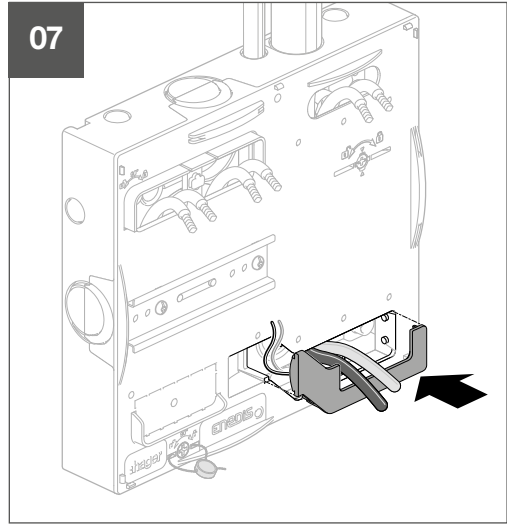
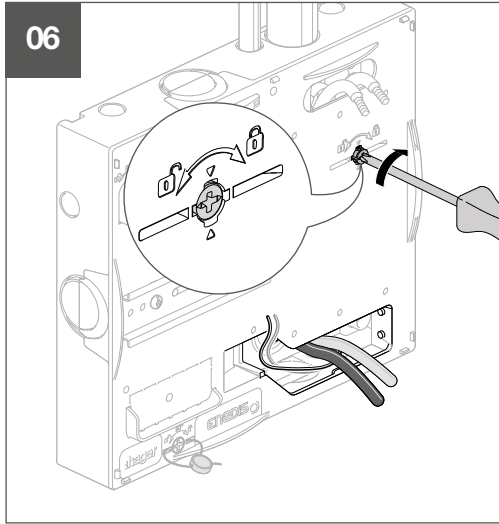
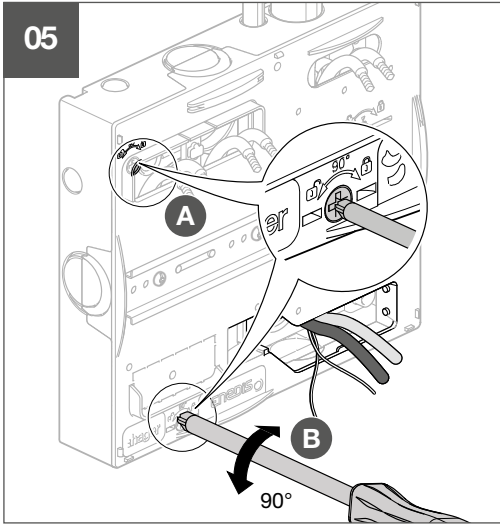
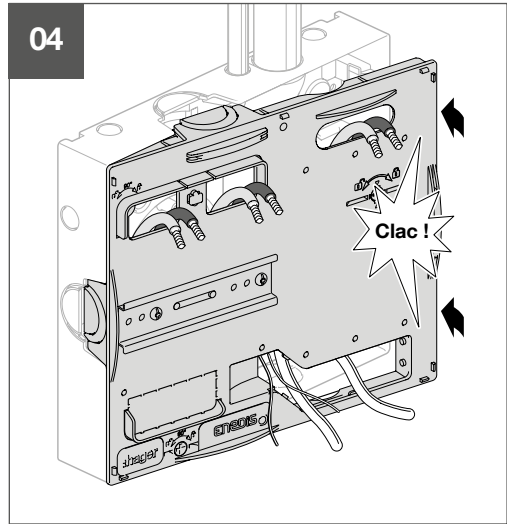
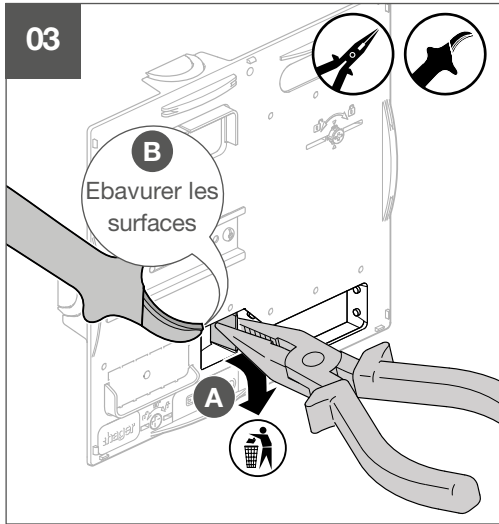
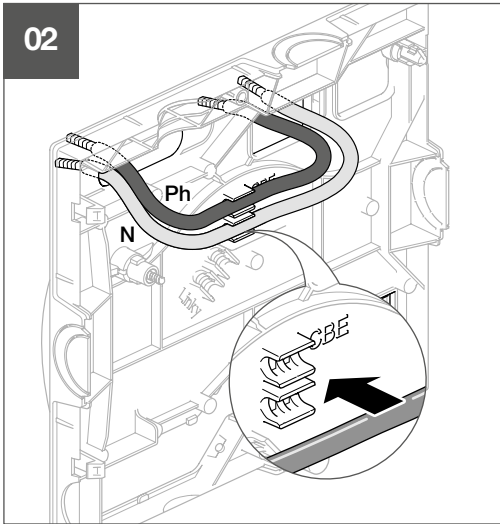
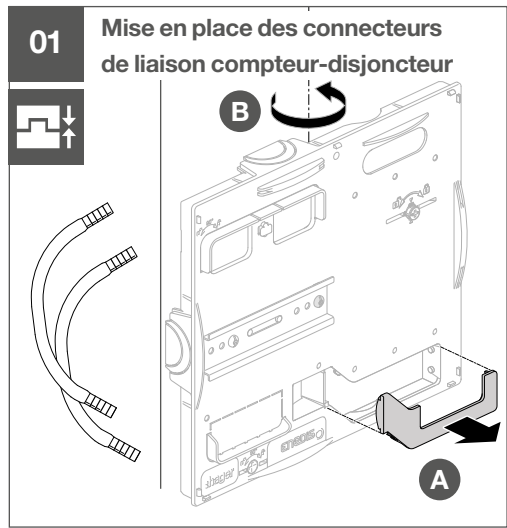
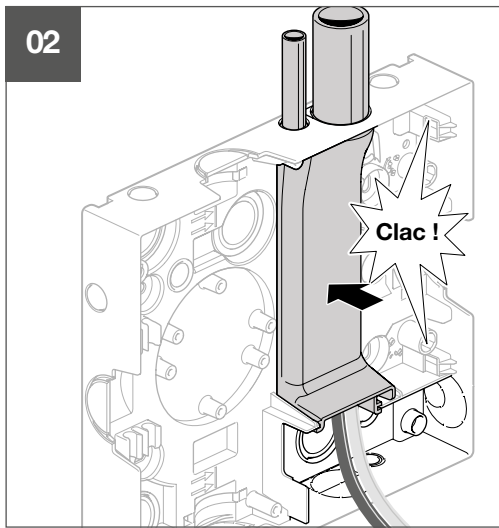
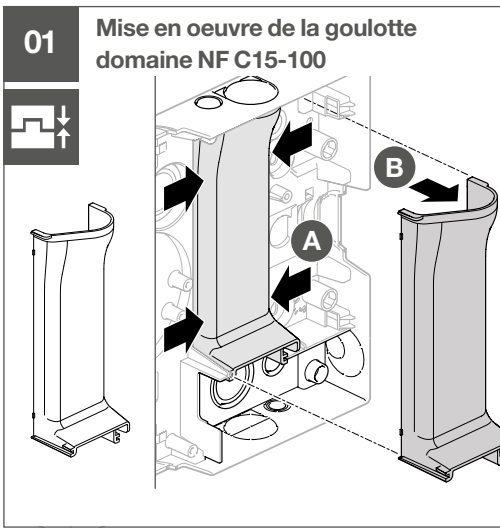

Choix de la vis de fixation pour le disjoncteur de branchement

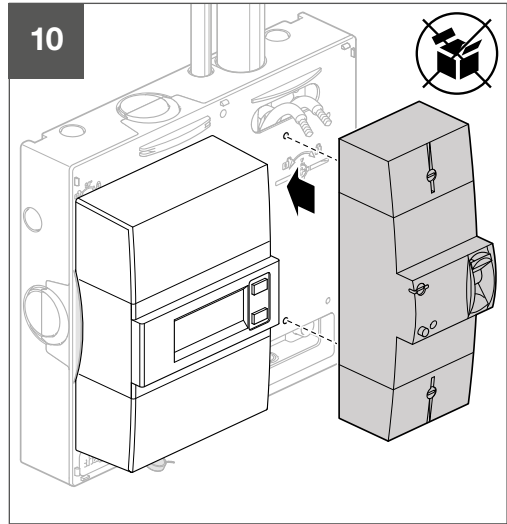

01

Condamnation du tableau



Compteur  
CBE et  
Compteur  
Linky

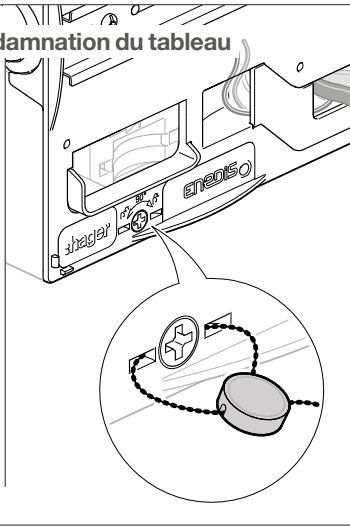

02

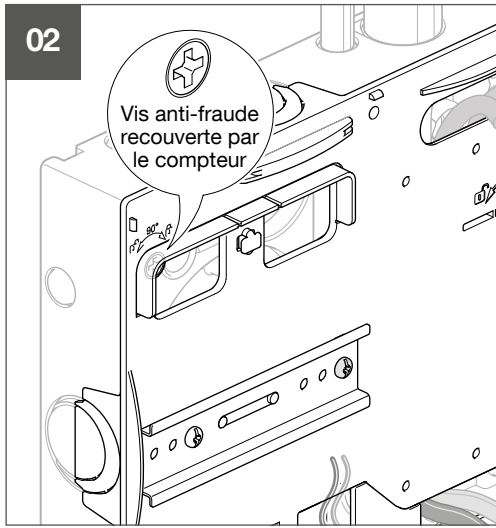

Vis anti-fraude  
recouverte par  
le compteur