



Electrical devices must only be installed and assembled by a qualified electrician in accordance with the relevant installation standards, guidelines, regulations, directives, safety and accident prevention directives of the country.

Failure to comply with these installation instructions may result in damage to the device, fire or other hazards.

Hazard due to electric shock. Do not operate the device without the application module.

These instructions are an integral component of the product and must be retained by the end user.

Design and layout of the device (Figure 01)



General design and layout of all socket outlets

- ① Socket outlet insert
- ② Frame (not included)
- ③ Centre plate

Function



Correct use

- Mains voltage power supply of electronic devices with mains plug via SCHUKO socket outlet
- Charging of mobile devices such as smartphones, smartwatches, tablets, etc. via the relevant USB port type A or C
- Only suitable for use in indoor areas with no drip and no spray water
- Installation into wall box according to DIN 49073-1 with at least 40 mm depth

Product characteristics

- USB ports short-circuit-proof and overload-proof (electronic fuse)
- Installation in multiple combinations
- Connection of SCHUKO socket outlet with USB port to shared plug-in terminals

Application



Caution

The use of non-standardised charging cables and plugs can cause device malfunctions.

The devices may be destroyed.

- Use only approved charging cables and plugs.



If devices are connected to the USB ports with their original charging cables, the charging control can recognise the devices and regulate the charging current.

Charging batteries of mobile end devices (Figure 02)

- Insert the USB plug of the charging cable into the USB port.

The batteries of the connected device are recharged automatically.



Note the manufacturer's specifications for the connected device for the charging time and the charging characteristics of the batteries. If two devices are connected, the charging time may be longer as the charging current is divided between the two ports.

Installation and electrical connection



Danger

Electric shock when live parts are touched!

An electric shock can lead to death!

- Isolate all connection cables before working on the device and cover any live parts in the area!

Connecting and installing the device

- ☑ A miniature circuit breaker max. 16 A has been installed as device protection.
- Connect the device (1) according to the connecting diagram (Figure 03).
- Place the device in the wall box (USB port at top) and secure with the wall box screws or fastening claws.
- Attach frame (2).
- Attach centre plate (3) and secure with the screw.



Depending on the installation location of the socket outlet and the charge status of the connected device, a minimal amount of noise may occur during charging via the USB port. This is especially important to consider when installing in sleeping rooms.

Technical data



Mounting orientation	USB port at top
Connecting terminals	2 x 1.5 ... 2.5 mm ²
Degree of protection	IP20
Operating temperature	0 ... 35 °C
Storage/transport temperature	-20 ... 60 °C
Installation depth	32 mm

SCHUKO socket outlet

Nominal voltage	250 V~, 50 Hz
Miniature circuit breaker	≤ 16 A

USB port

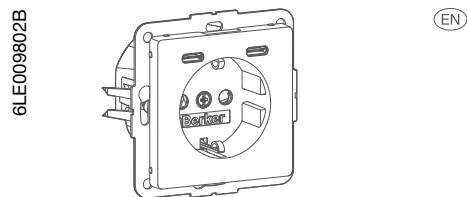

EN



SCHUKO socket outlet + USB ports

4814 xx xx

SCHUKO socket outlet with USB port type A+C PD

4815 xx xx

SCHUKO socket outlet with USB port type C+C PD

01

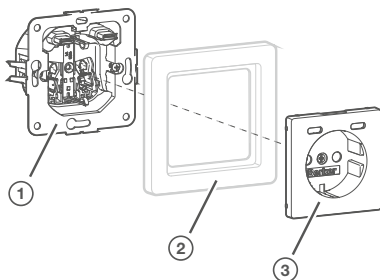

02

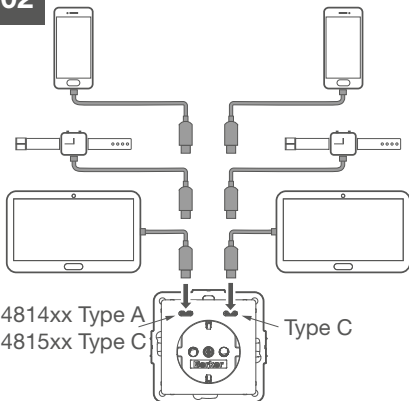

4814xx Type A
4815xx Type C

03

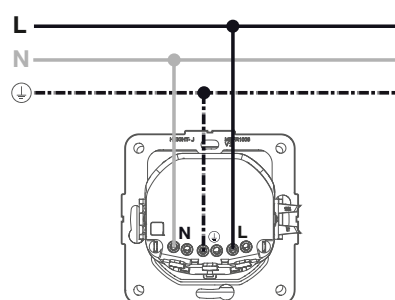

Input voltage 230 V~ +20%/-15%, 50 Hz
Input current ≤ 0.3 A
Type A output 5.0 V $\overline{=}$ ±5% / 1.0 A
Type C output 5.0 V $\overline{=}$ ±5% / 3.0 A
 9.0 V $\overline{=}$ ±5% / 2.22 A
USB type A output power ≤ 5.0 W
USB type C output power ≤ 20.0 W
Total output power ≤ 20.0 W



Overheating protection: In the event of overheating, the charging device switches off for a short time to cool down. The charging operation is resumed automatically.

Power dissipation Type A+C 62 mW
(Standby consumption) Type C+C 70 mW
Energy efficiency Type A+C ≥ 82.3%
 Type C+C ≥ 83.8%
Energy efficiency at Type A+C ≥ 76.9%
low load (10%) Type C+C ≥ 79.4%
Charging protocols USB PD 3.0, BC1.2,
 QC3.0, Apple 2.4A,
 Samsung 2A