

HIM302/304/306/308
HIM402/404/406/408
20A - 80A

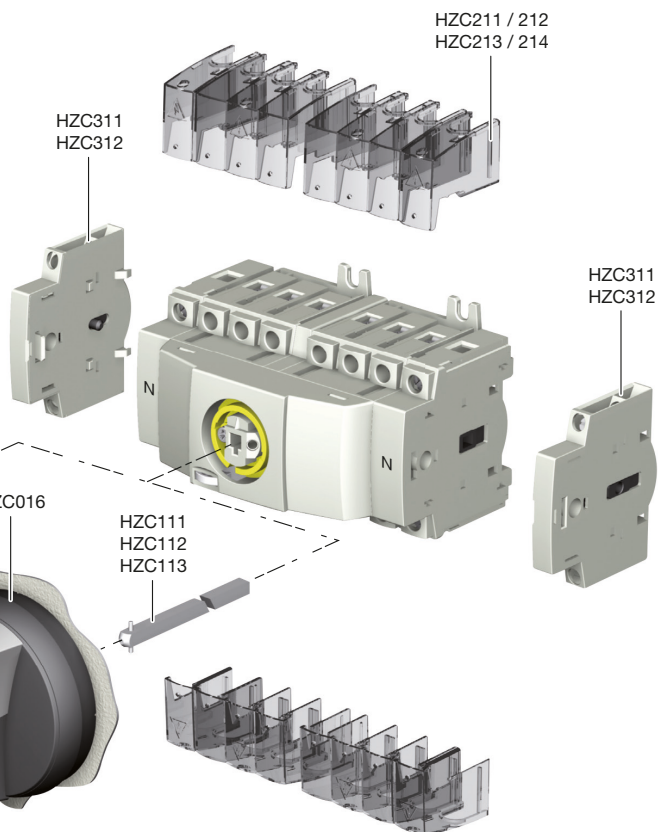

535619E

(EN) Changeover switch
(FR) Commutateur modulaire
(DE) Modularer Lastumschalter



(A) Direct operation
Commande directe
Direkt Drehantrieb

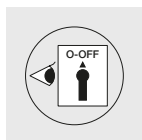

(B) Front operation
Commande frontale
Drehantrieb zum
Türeinbau

	Ref. Changeover Réf. Commutateur Lastumschalter Artikel	Rating Calibre Stromstärke	AC	Ref. Terminal shrouds Réf. Capot cache-bornes Klemmenabdeckungen Artikel	Ref. Bridging bar Réf. Barre de pontage Überbrückungsschiene Artikel
①	HIM302	3 x 20 A	AC- 23 A	HHC211	HHC706
	HIM402	4 x 20 A		HHC212	- NO -
	HIM304	3 x 40 A		HHC211	HHC706
	HIM404	4 x 40 A		HHC212	- NO -
②	HIM306	3 x 63 A	AC- 23 A	HHC213	HHC708
	HIM406	4 x 63 A		HHC214	- NO -
	HIM308	3 x 80 A		HHC213	HHC708
	HIM408	4 x 80 A		HHC214	- NO -

Configuration / Configuration / Konfiguration

01

standart

02

Only for direct operation
Uniquement pour commande directe
Nur für direkt Drehantrieb

max. Ø 5 mm
min. Ø 4 mm

PZ 1
0,5 Nm

A Direct operation
Commande directe
Direkt Drehantrieb

B Front operation
Commande frontale
Drehantrieb zum
Türeinbau

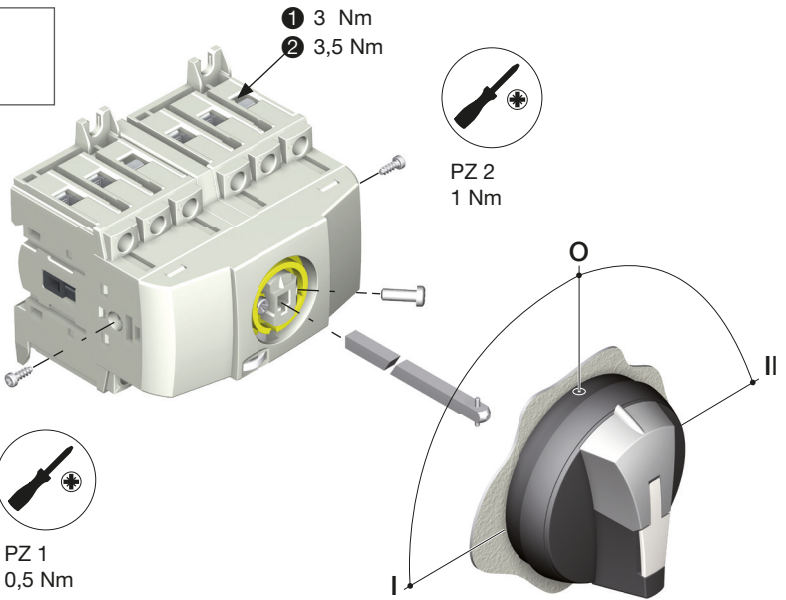
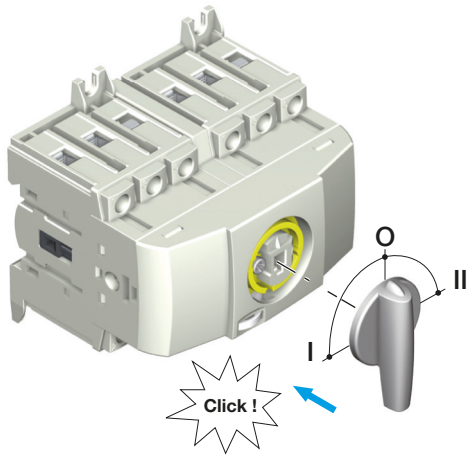

Use 75°C Cu wire only / Utiliser uniquement du fil cuivre 75°C / Nur mit 75°C Kupfer Leitungsdraht



1 **2**
9 mm - 12 mm



1,5 mm² - 16 mm²

1 3 Nm

2,5 mm² - 35 mm²

2 3,5 Nm

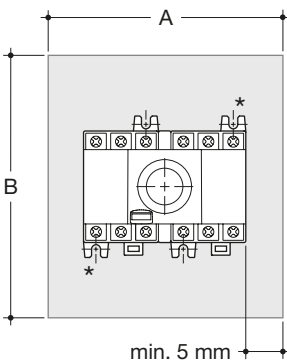

Possible assembly with two screws
Montage avec 2 vis possible
Einbau mit 2 Schrauben möglich

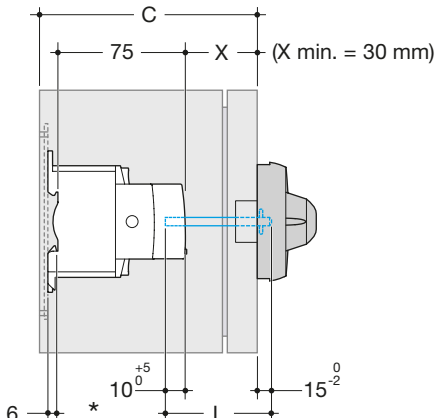

$L = X + 30 \text{ mm}$

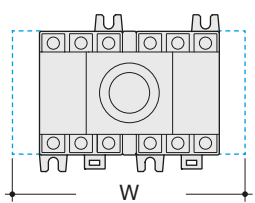
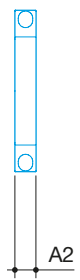
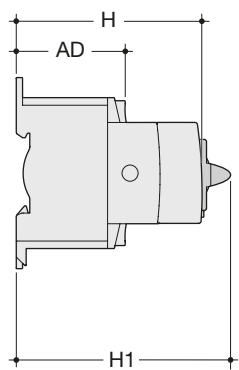
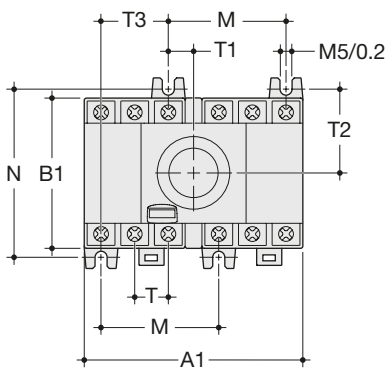

$W = A1 + (x) \times A2$

REF	x) max)
HIM302	4
HIM304	
HIM306	
HIM308	
HIM402	2
HIM404	
HIM406	
HIM408	

	A mm	A1 mm	A2 mm	B mm	AD mm	B1 mm	C mm	H mm	H1 mm	N mm	M mm	T mm	T1 mm	T2 mm	T3 mm	
HIM302/304	140	97,5	8,8	147	48,5	68	110	84	93,5	75	52,5	15	11,25	37,5	30	
HIM402/404	140	127,5		147		68										75
HIM306/308	170	105		199		76										85
HIM406/408	170	140		199		76										85