

Safety instructions

Electrical equipment must only be installed and assembled by a qualified electrician in accordance with the relevant installation standards, regulations, directives and safety and accident prevention directives of the country.

Failure to comply with these installation instructions may result in damage to the device, fire or other hazards.

Function / Correct use

Cooker control unit for electrical installations in buildings. The unit combines a cooker control switch with a BS switched socket outlet.

- For the flush-mounted installation in standard twin wall boxes (recommended wall box depth ≥ 35 mm).
- Only suitable for use in indoor areas with no drip and no spray water.

Cooker control switch features:

- Double pole cooker control switch with red LED indicator
- For the control of suitable fixed loads, e.g. cooker ovens.

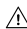
 Do not exceed a maximum horizontal installation distance of 2 meters to the load. And ensure that the control switch is always easily accessible after installation.

Socket outlet features:

- Compatible with BS 1363-1 plugs
- With double pole switch and red control LED

 When choosing a suitable installation location, take care of minimizing the risk of trailing cables of connected devices being located too near or on hot surfaces!

Technical data

Rated voltage:	250 V~
Frequency:	50/60 Hz
Rated current (cooker control switch):	45 A
Rated current (switched socket outlet):	13 A
Conductor cross-section of screw terminals (L, N):	max. 1 x 16 mm ²
Conductor cross-section of earthing terminals:	max. 1 x 10 mm ²
Distance of fixing holes:	120.6 mm
Compliance:	BS 4177 and SASO 2203

Information for electricians

Installation and electrical connection



DANGER!

Touching live parts can result in an electric shock.

An electric shock can lead to death.

Disconnect the connecting cables before working on the device and cover all live parts in the area!

Preparing the device for installation

The device is delivered with a transparent dust protection sticker. This sticker must remain on the device during the time of installation.

1

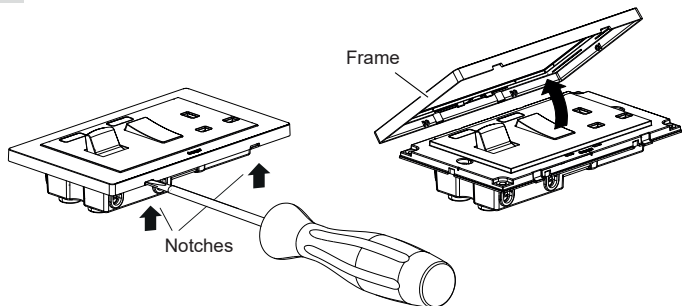

- Carefully loosen the frame on the notches with a flat-blade screwdriver. Lift up and remove the frame (1).

Connecting the device

2

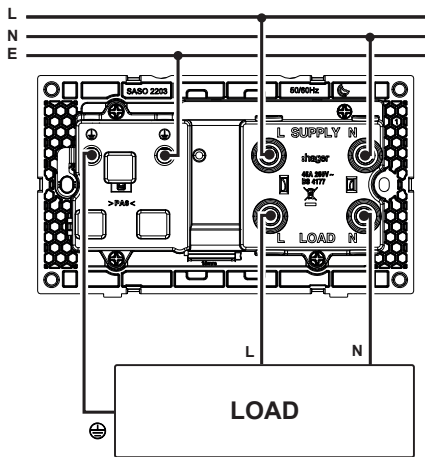

- Strip connection cables approx. 18 mm.
- Wire the device according to the appropriate connection diagram (2).

Installing the device into the wall box

3

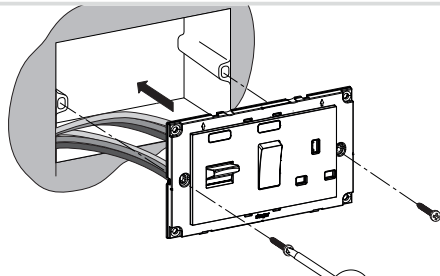

- After wiring, fix the device with the two screws attached into the wall box (3).

Assembling the frame

4

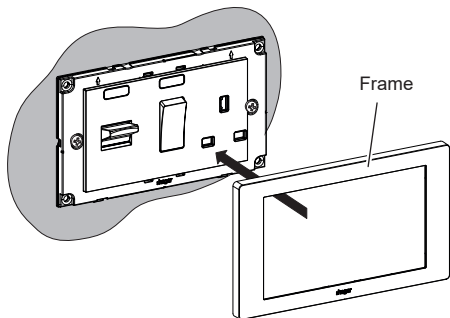

- Snap the frame onto the device (4).
- Remove the dust protection sticker.