

- Ⓜ GB Quadro5 User Instruction
- Ⓜ FR Quadro5 Notice d'instructions
- Ⓜ ES Quadro5 Instrucciones de uso
- Ⓜ IT Quadro5 Istruzioni d'uso
- Ⓜ GR Quadro5 Οδηγίες Χρήσεως
- Ⓜ AR كوادرو 5 تعليمات المستخدم

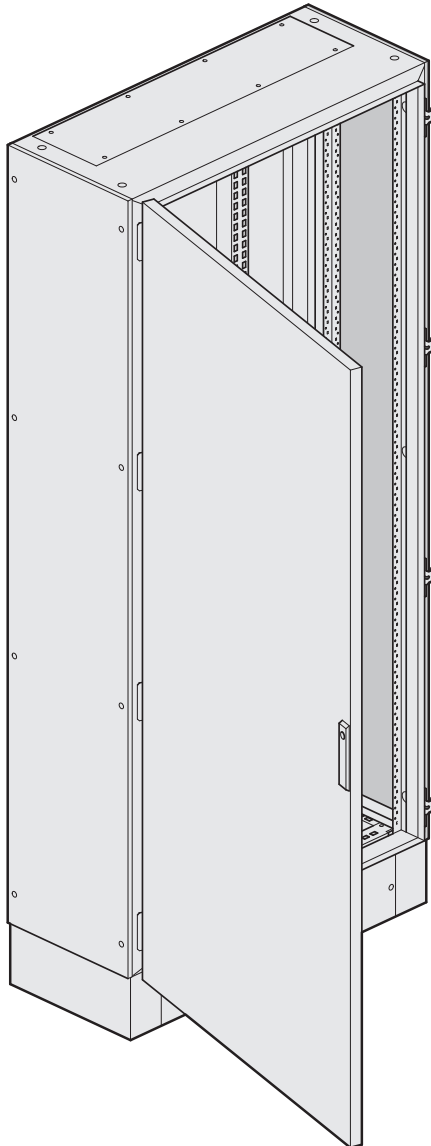
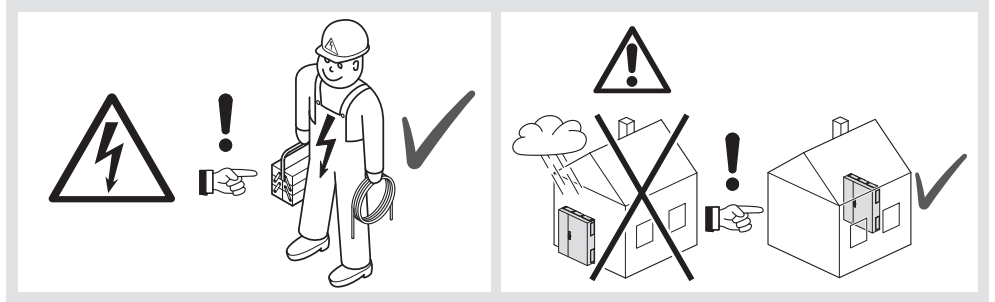

(GB) Wall mounting enclosure User Instruction

(FR) Coffret mural Notice d'instructions

(ES) Armario de pared Instrucciones de uso

(IT) Quadro a parete Istruzioni d'uso

(GR) Επίτοιχο ερμάριο Οδηγίες Χρήσεως

(AR) لوحة تركيب حائطية تعليمات المستخدم

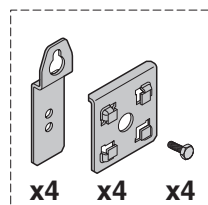
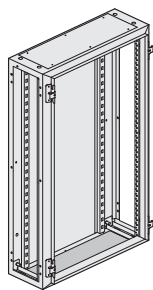

x4

x4

x4



⊕
PZ 2

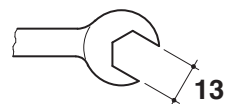

13

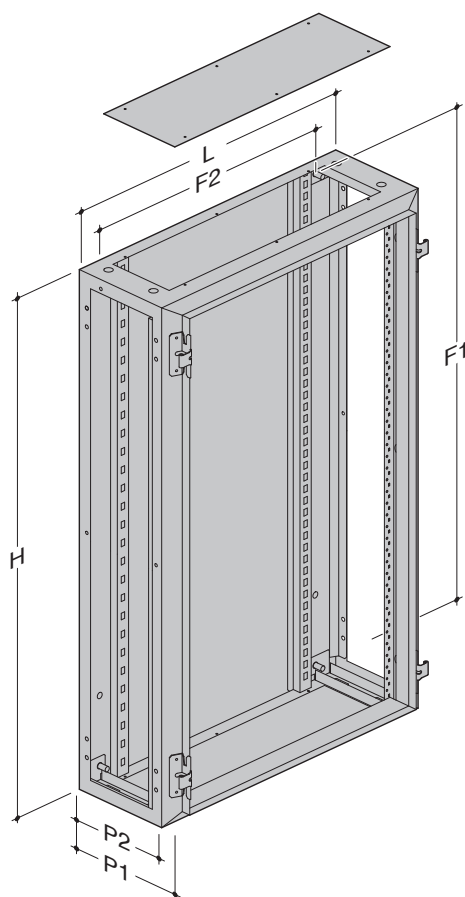

	H	L	P1	P2	F1	F2
FM200	510	700	260	220	430	570
FM201	660	700	260	220	580	570
FM202	810	700	260	220	730	570
FM203	960	700	260	220	880	570
FM204	1110	700	260	220	1030	570
FM205	1260	700	260	220	1180	570
FM206	1410	700	260	220	1330	570
FM304	1110	900	260	220	1030	770
FM305	1260	900	260	220	1180	770
FM306	1410	900	260	220	1330	770

(GB) Floor standing enclosure User Instruction

(FR) Armoire Notice d'instructions

(ES) Armario de suelo Instrucciones de uso

(IT) Quadro a pavimento Istruzioni d'uso

(GR) Επιδαπέδιο ερμάριο Οδηγίες Χρήσεως

(AR) لوحة أرضية قائمة تعليمات المستخدم

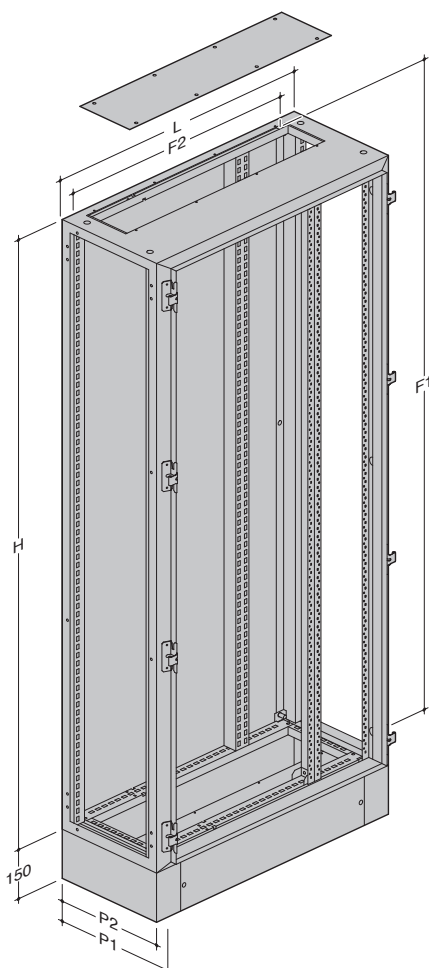
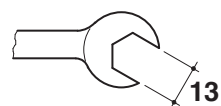
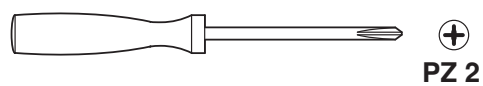
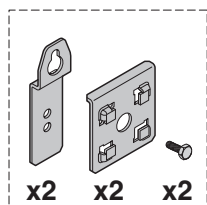

	H	L	P1	P2	F1	F2
FM107	1560	450	260	220	1480	320
FM108	1710	450	260	220	1630	320
FM109	1860	450	260	220	1780	320
FM117	1560	450	400	360	1480	320
FM118	1710	450	400	360	1630	320
FM119	1860	450	400	360	1780	320
FM207	1560	700	260	220	1480	570
FM208	1710	700	260	220	1630	570
FM209	1860	700	260	220	1780	570
FM217	1560	700	400	360	1480	570
FM218	1710	700	400	360	1630	570
FM219	1860	700	400	360	1780	570
FM307	1560	900	260	220	1480	770
FM308	1710	900	260	220	1630	770
FM309	1860	900	260	220	1780	770
FM317	1560	900	400	360	1480	770
FM318	1710	900	400	360	1630	770
FM319	1860	900	400	360	1780	770

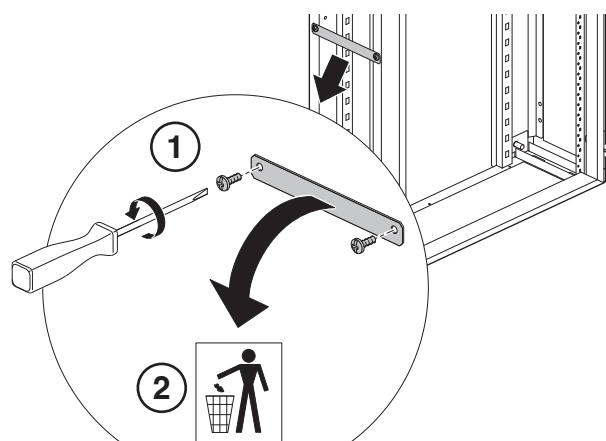

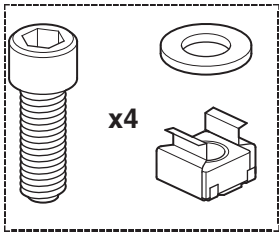
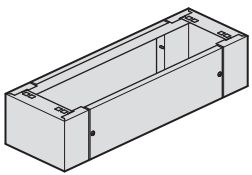
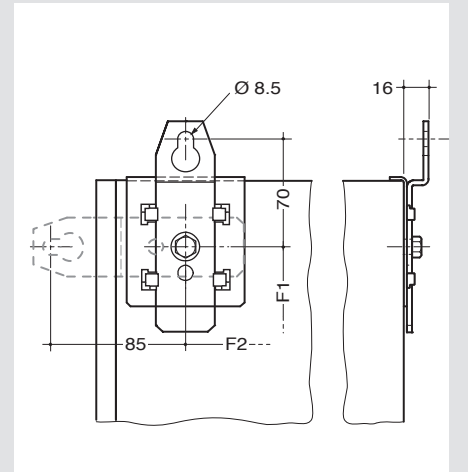
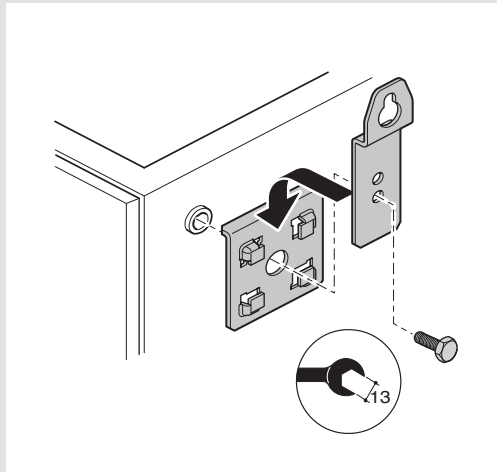
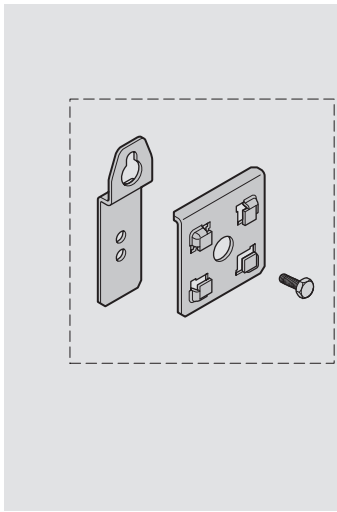

- | | | |
|------|-------------------------|-----------------------|
| (GB) | Enclosure plinth | User Instruction |
| (FR) | Socles d'armoires | Notice d'instructions |
| (ES) | Zócalos de los armarios | Instrucciones de uso |
| (IT) | Zoccolo del quadro | Istruzioni d'uso |
| (GR) | Βάθρο ερμαρίων | Οδηγίες Χρήσεως |
| (AR) | قاعدة اللوحة | تعليمات المستخدم |

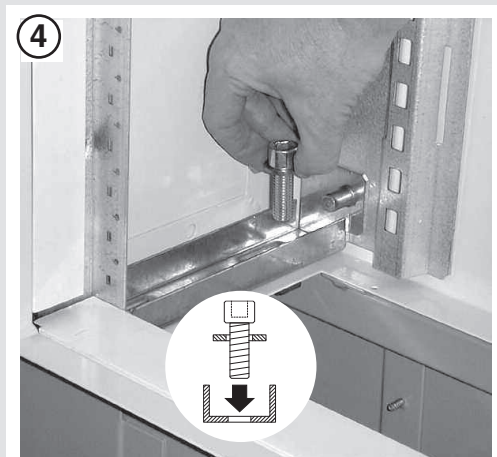
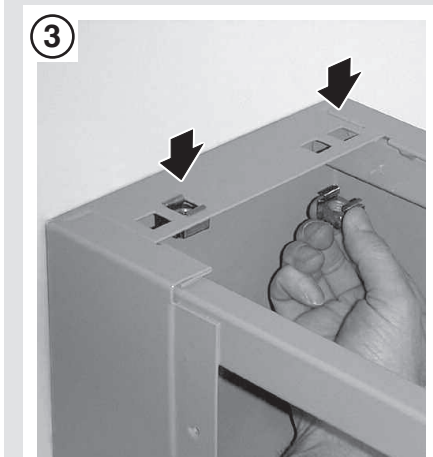
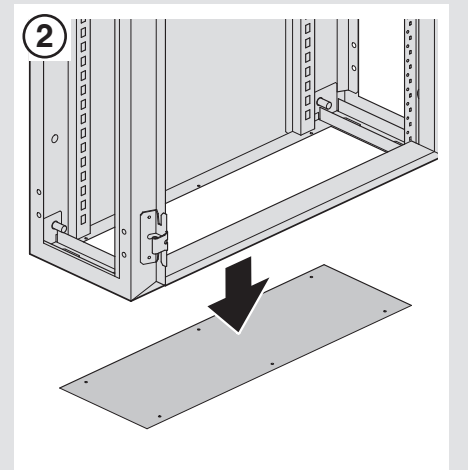
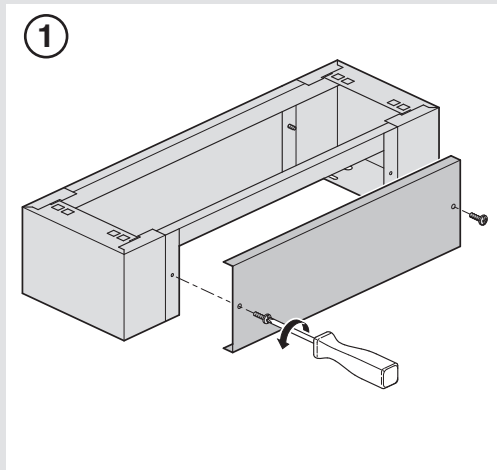
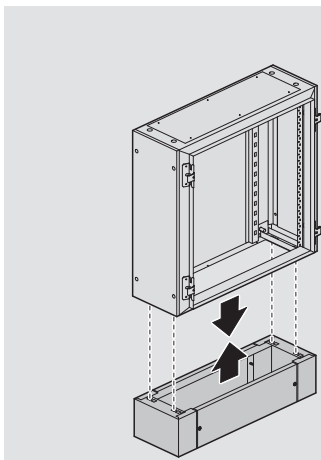

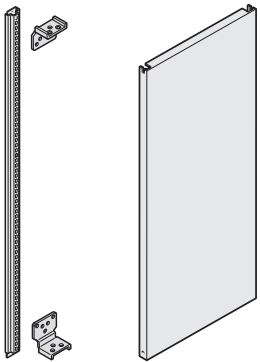
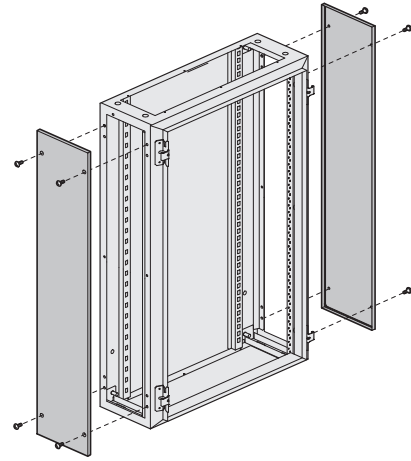
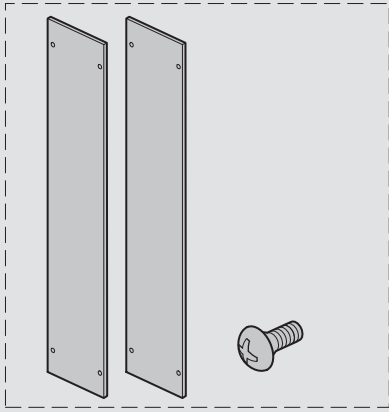

- (GB) Upright and mounting plate
- (FR) Montant et panneau interne
- (ES) Montante y panel interior
- (IT) Montante e piastra di fondo
- (GR) Ορθοστάτης και πλάτη στήριξης
- (AR) العمود ولوحة التثبيت

- User Instruction
- Notice d'instructions
- Instrucciones de uso
- Istruzioni d'uso
- Οδηγίες Χρήσεως
- تعليمات المستخدم

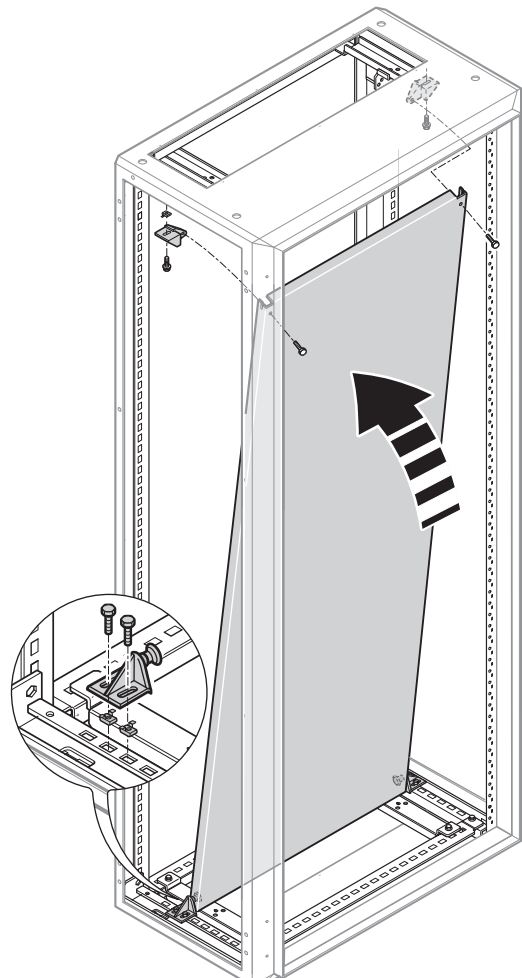
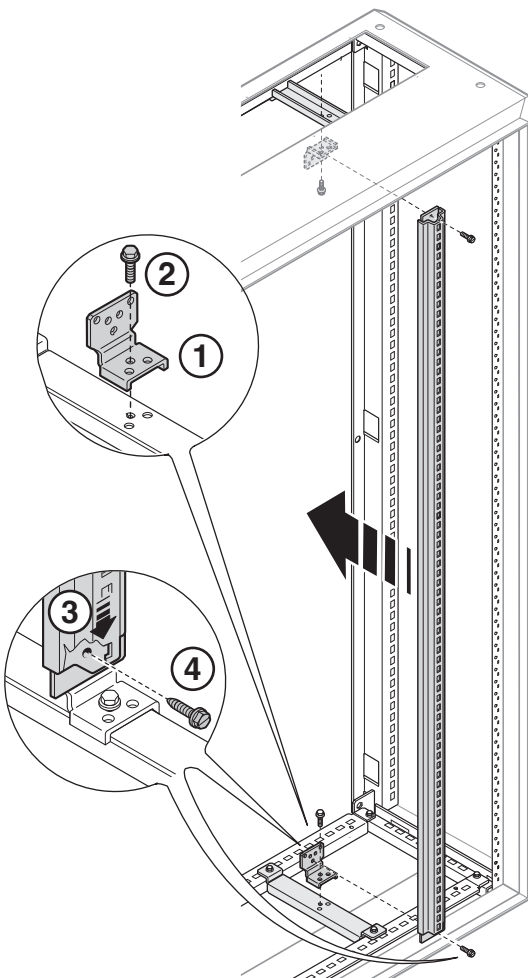

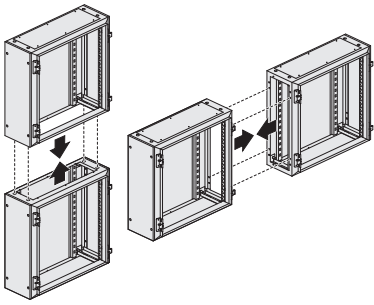

- ⓐ GB Coupling kit
- ⓑ FR Kits d'association
- ⓒ ES Kit de asociación
- ⓓ IT Kit di associazione
- ⓔ GR Εξαρτήματα σύνδεσης
- ⓕ AR طقم الربط

- User Instruction
- Notice d'instructions
- Instrucciones de uso
- Istruzioni d'uso
- Οδηγίες Χρήσεως
- تعليمات المستخدم

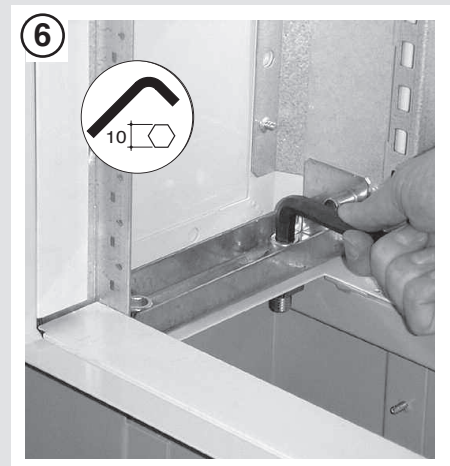
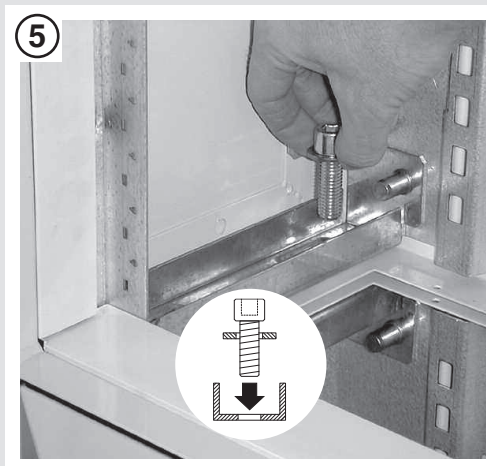
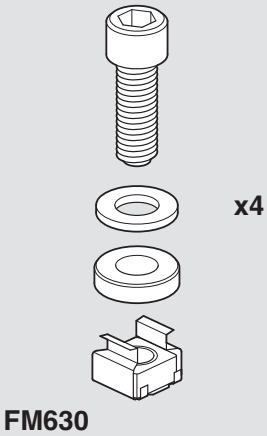
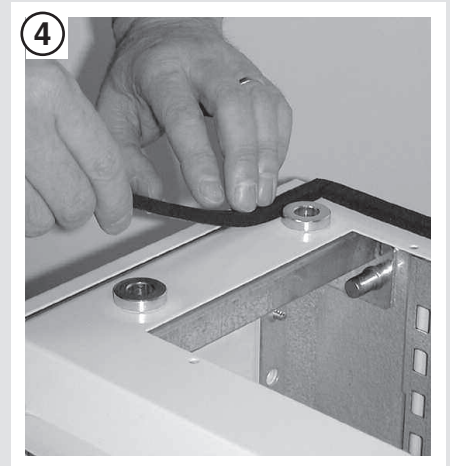
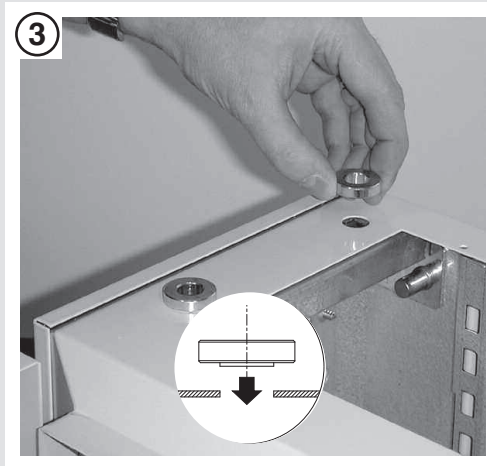
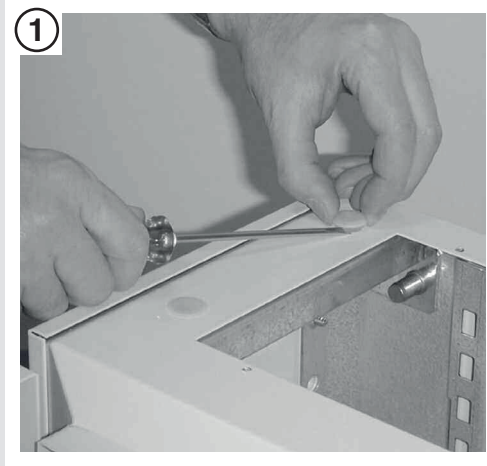
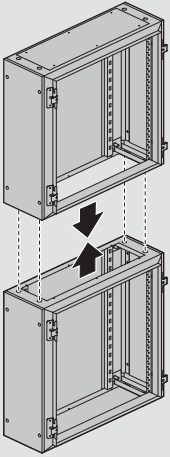

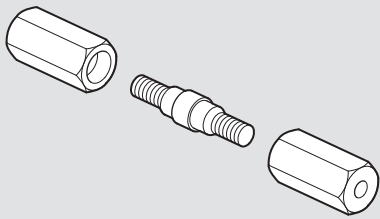
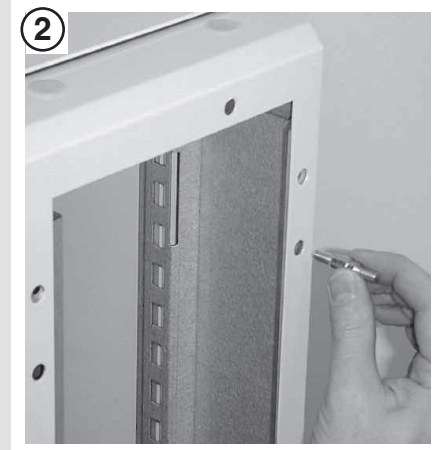
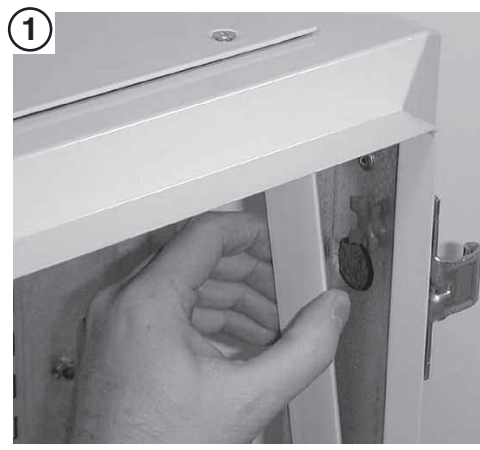
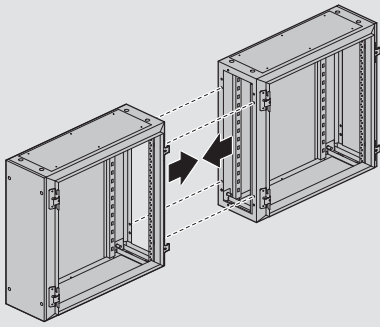

FM635

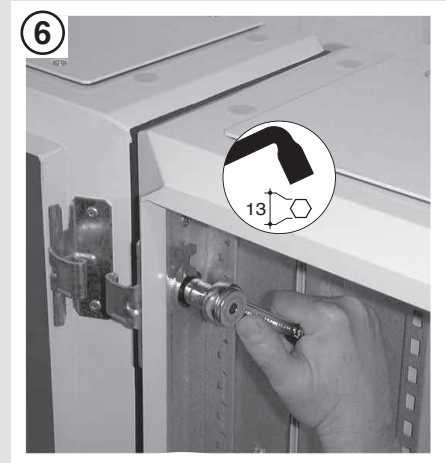
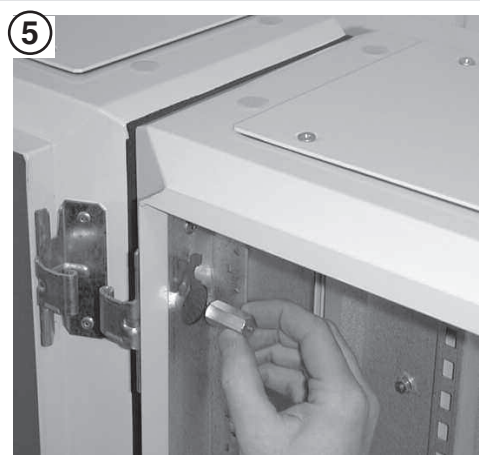
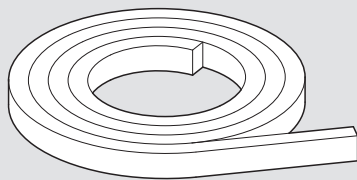
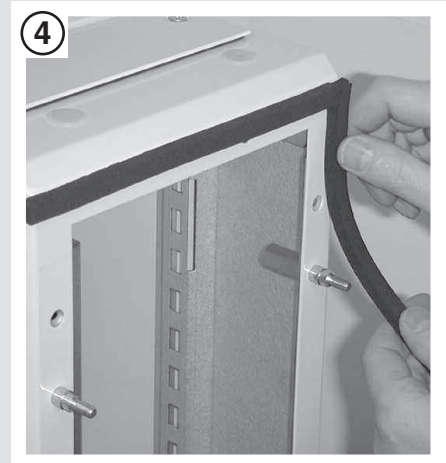
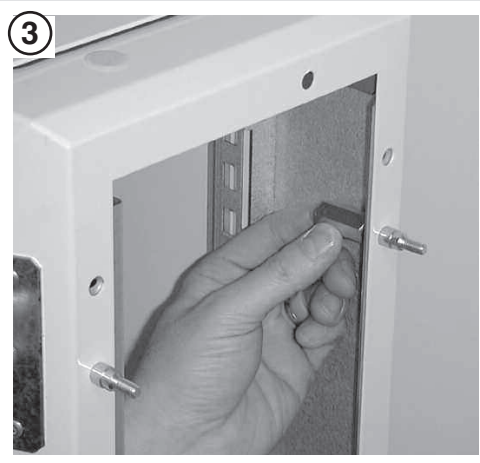

- Ⓒ GB Cabinet door
- Ⓒ FR Porte d'armoire
- Ⓒ ES Puerta del armario
- Ⓒ IT Porta del quadro
- Ⓒ GR Πόρτα ερμαρίου
- Ⓒ AR باب اللوحة

- User Instruction
- Notice d'instructions
- Instrucciones de uso
- Istruzioni d'uso
- Οδηγίες Χρήσεως
- تعليمات المستخدم

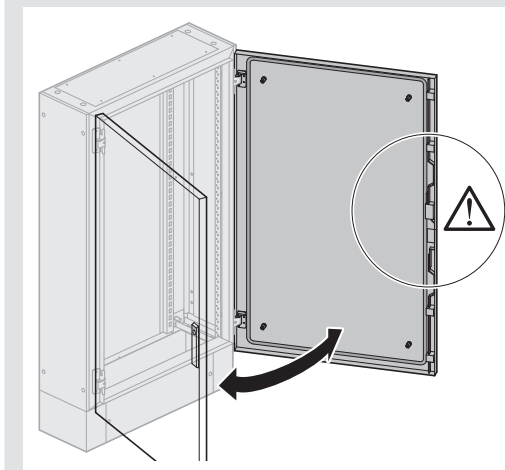
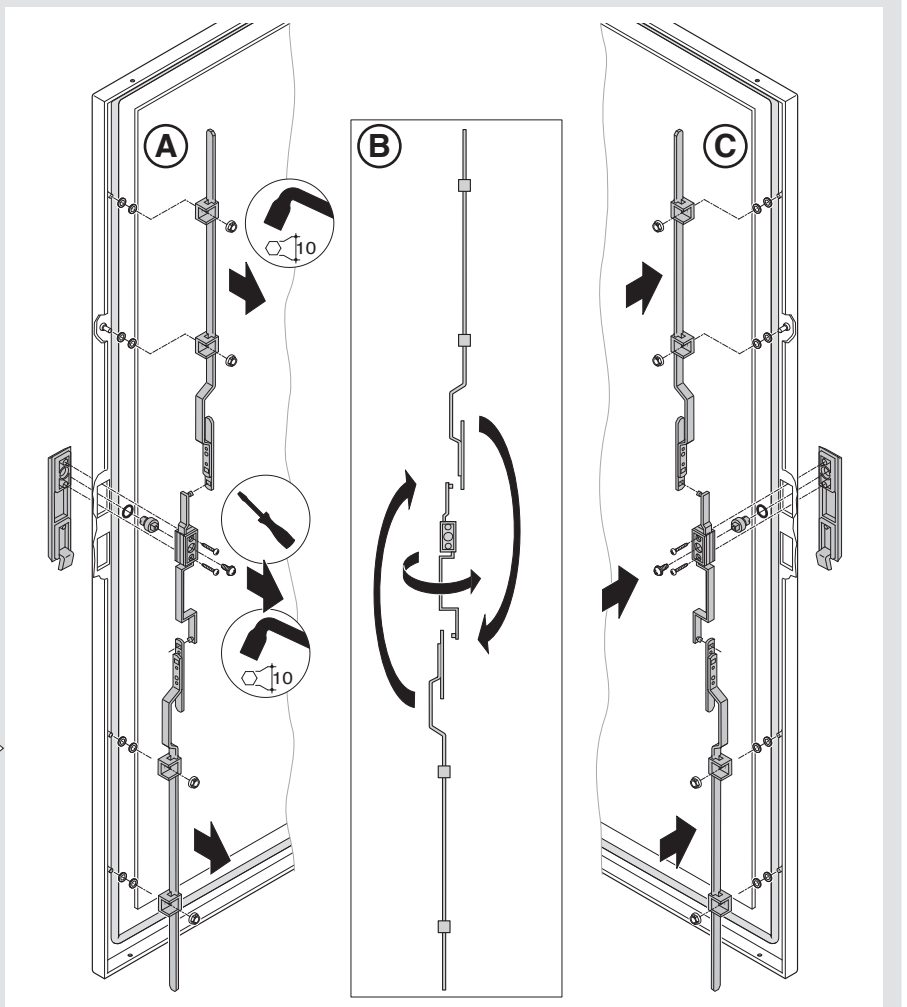
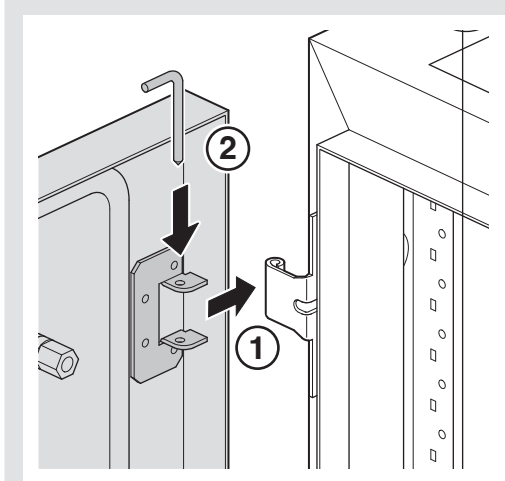
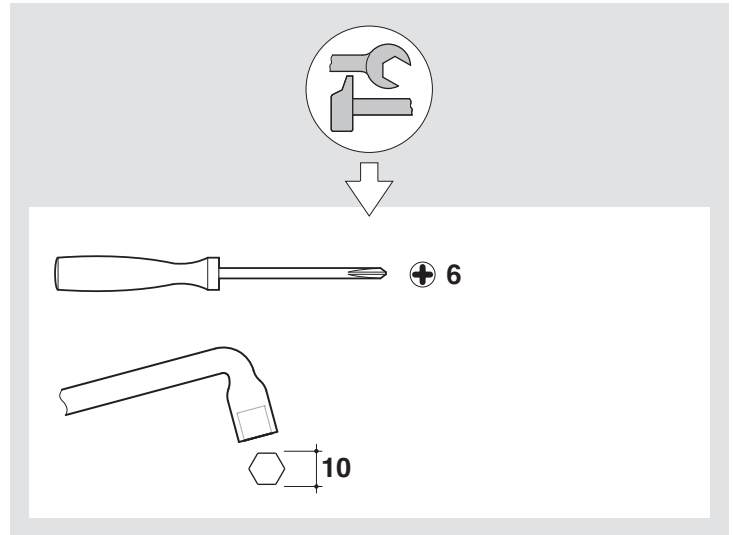
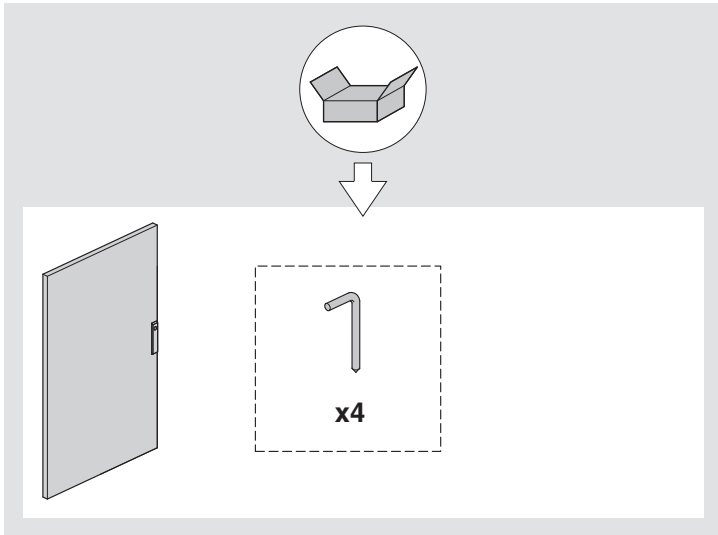

- Ⓒ GB Cable duct
- Ⓒ FR Kit gaine à câbles interne
- Ⓒ ES Kit emplazamiento cables/embarrado
- Ⓒ IT Kit vano cavi
- Ⓒ GR Kit δημιουργίας χώρου καλωδίωσης/μπαρών
- Ⓒ AR قناة الكابلات

- User Instruction
- Notice d'instructions
- Instrucciones de uso
- Istruzioni d'uso
- Οδηγίες Χρήσεως
- تعليمات المستخدم

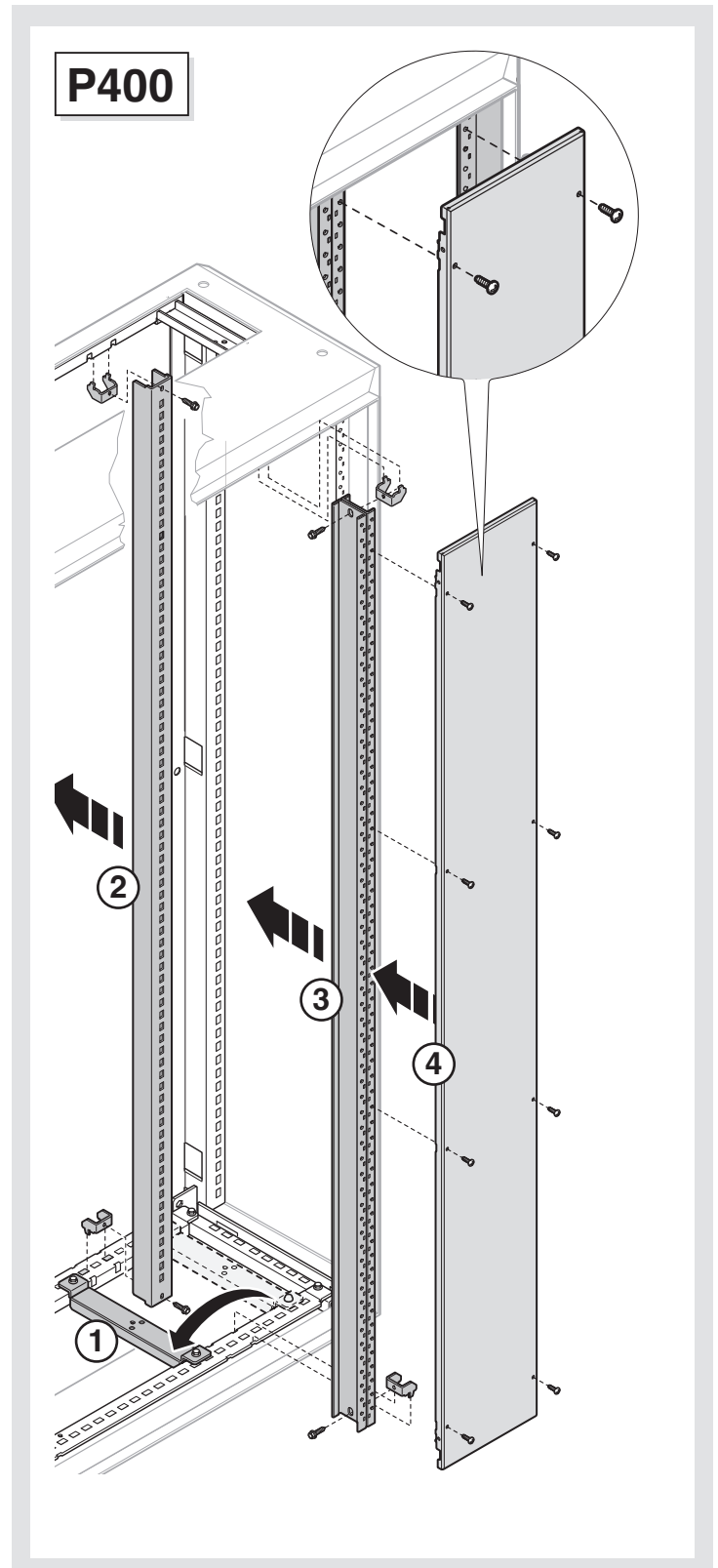
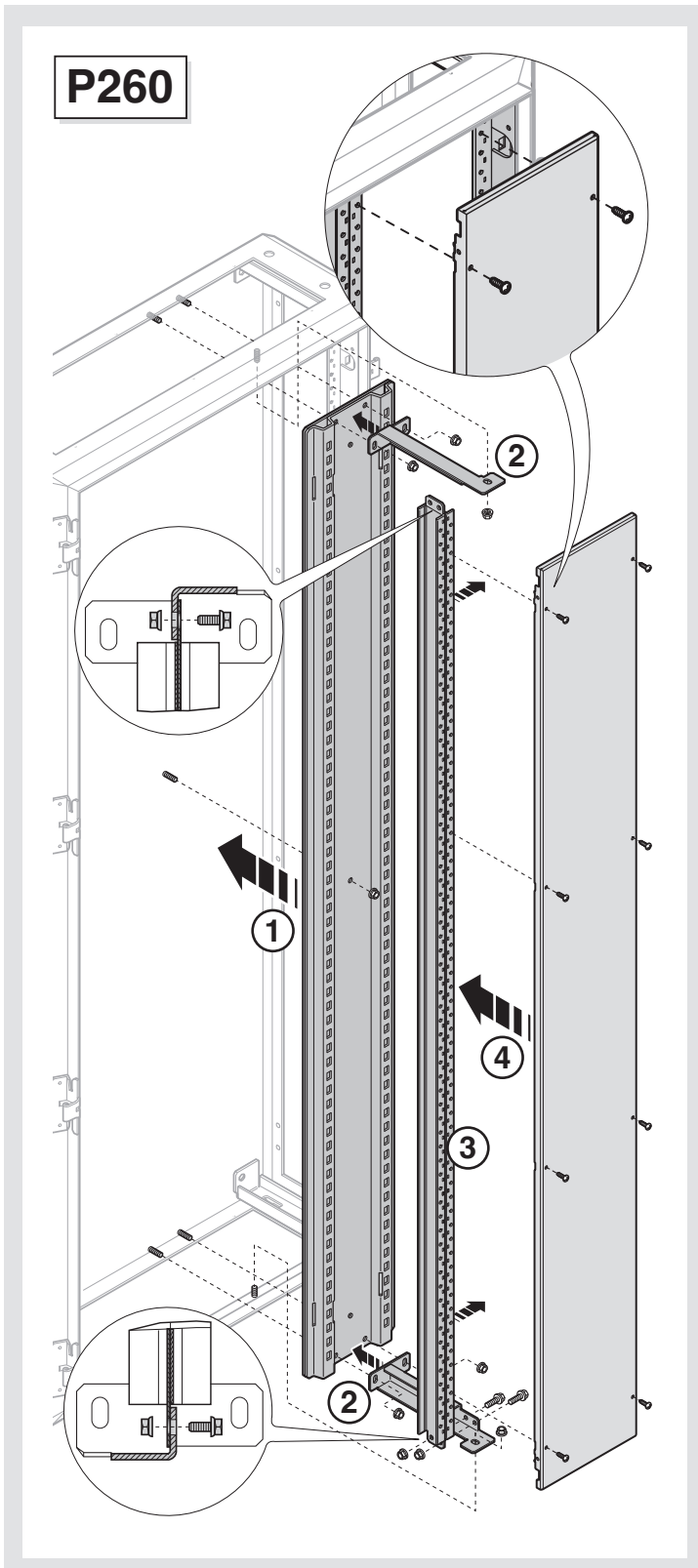

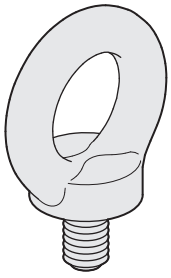

- Ⓜ GB Transport lug
- Ⓜ FR Anneaux de levage
- Ⓜ ES Cáncamos de elevación
- Ⓜ IT Golfari di sollevamento
- Ⓜ GR Κρίκοι μεταφοράς
- Ⓜ AR حلقة الرفع والنقل

User Instruction

Notice d'instructions

Instrucciones de uso

Istruzioni d'uso

Οδηγίες Χρήσεως

تعليمات المستخدم

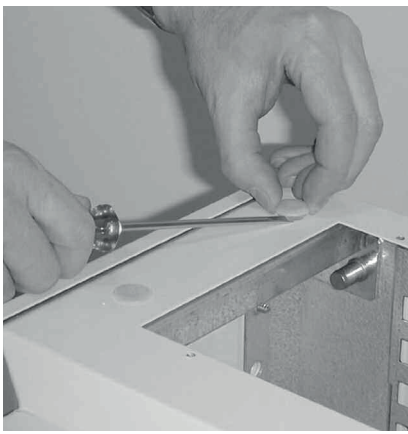
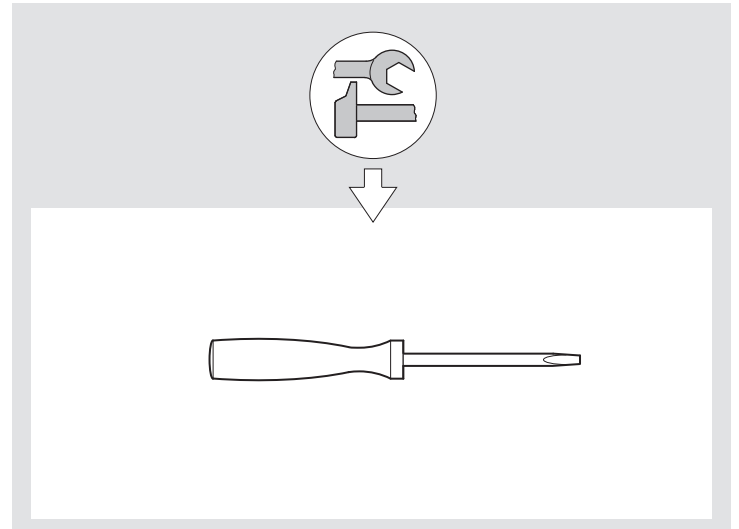
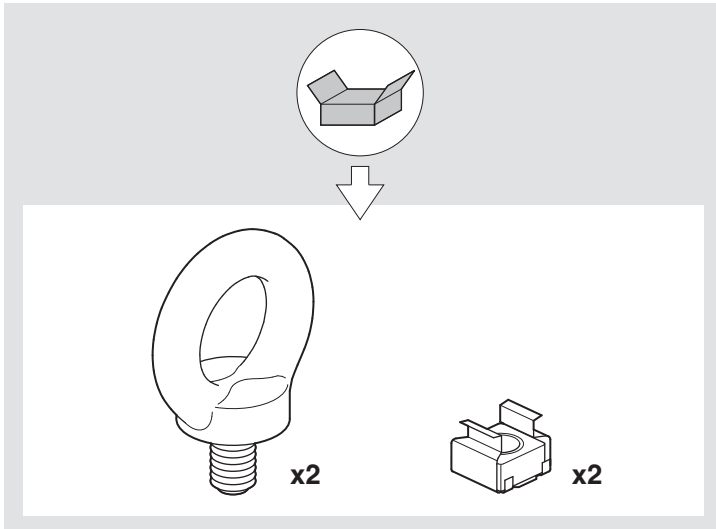

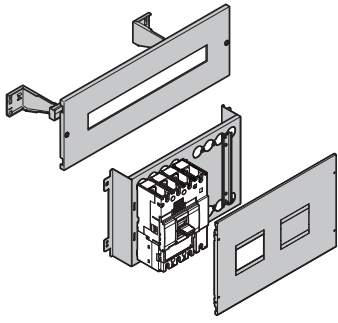

- Ⓜ GB Kit for modular device and moulded circuit breakers Cl. I
- Ⓜ FR kit d'appareillage modulaire et disjoncteurs boîtier moulé Cl. I
- Ⓜ ES Kit para apartamento modular y en caja moldeada Cl. I
- Ⓜ IT Kit per apparecchi modulari e scatolati Cl. I
- Ⓜ GR Κιτ για αρθρωτές και συσκευασμένες συσκευές Τάξη I
- Ⓜ AR طقم أجهزة معيارية وقواطع مصبوبة الفئة الأولى

User Instruction

Notice d'instructions

Instrucciones de uso

Istruzioni d'uso

Οδηγίες Χρήσεως

تعليمات المستخدم

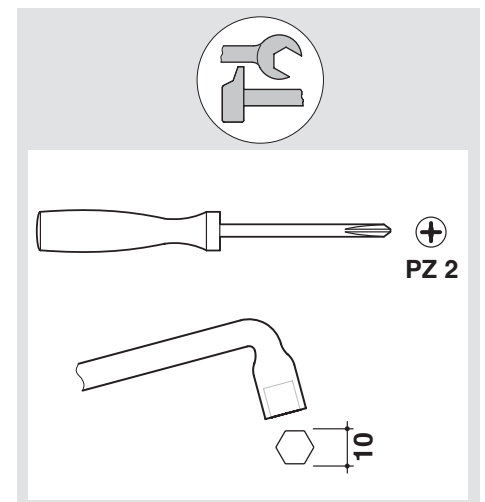
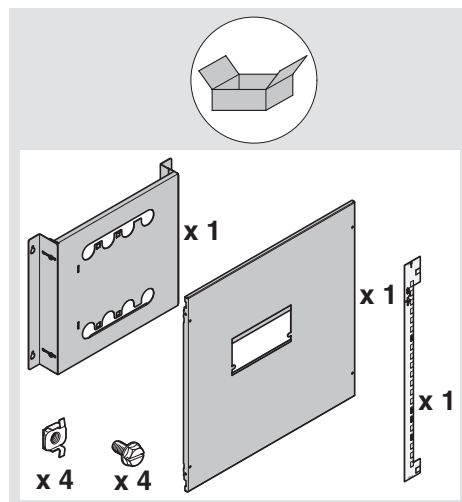
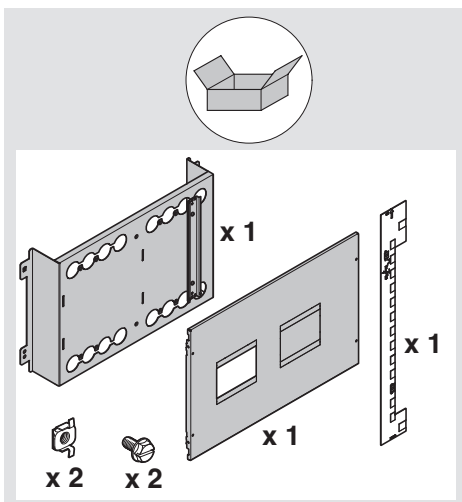
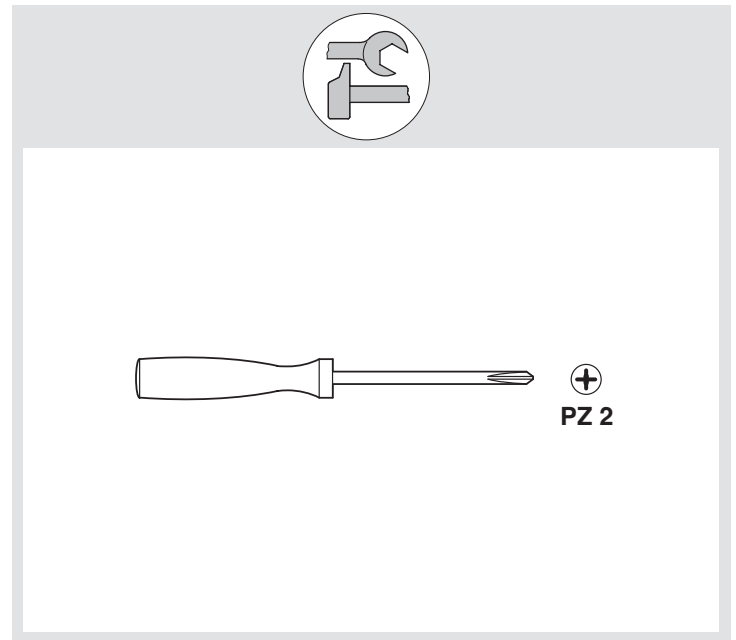
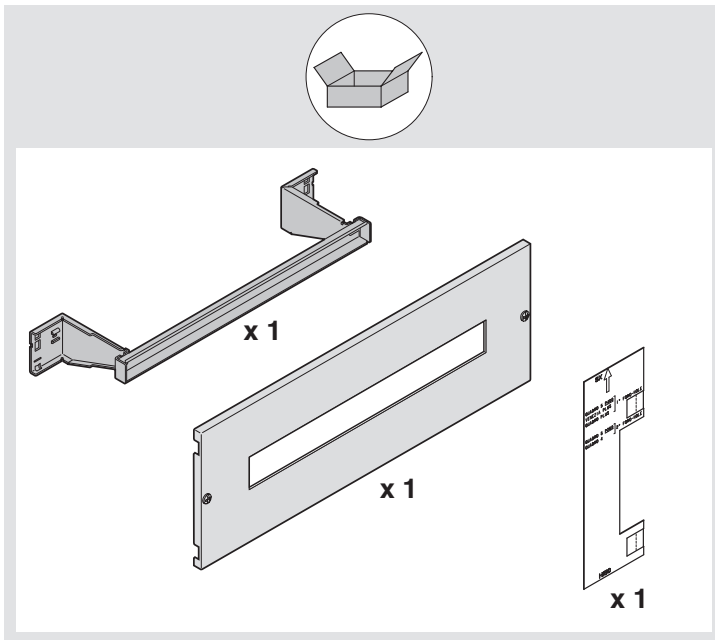

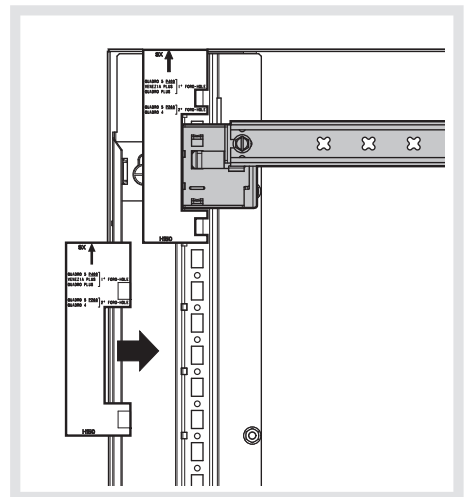
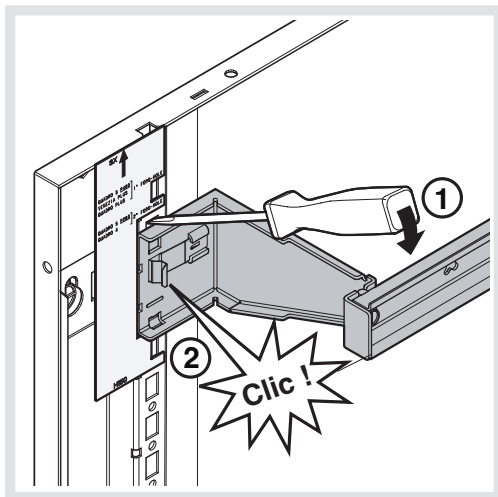
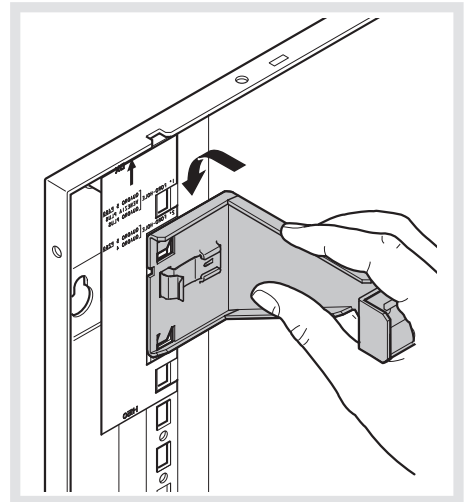
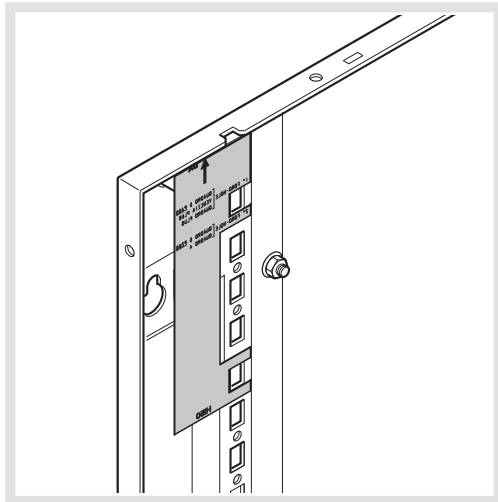
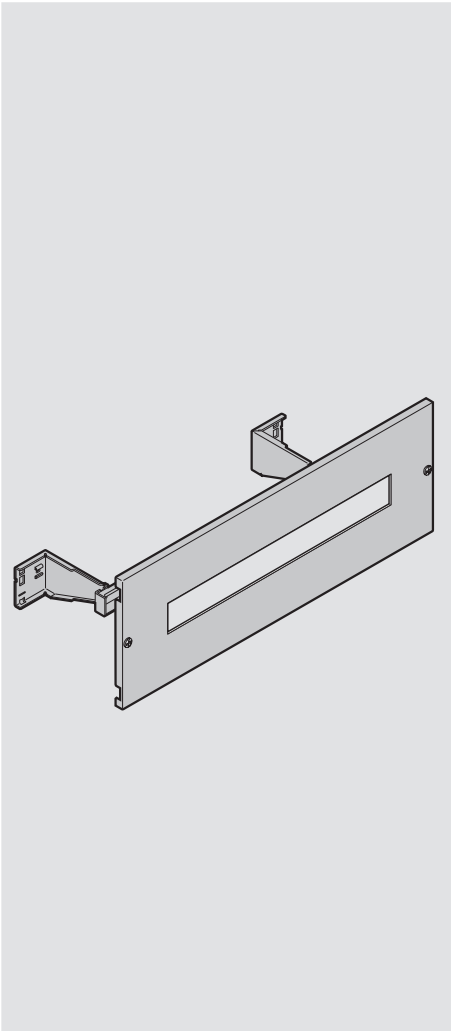
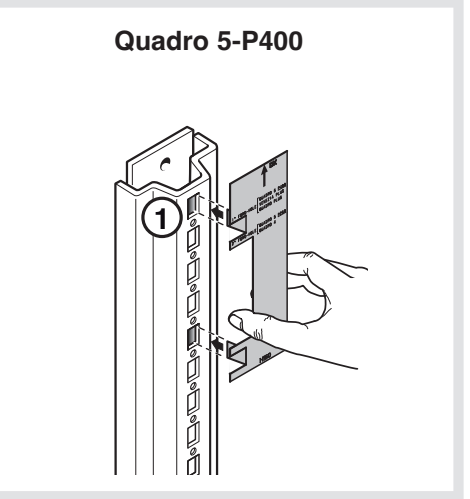
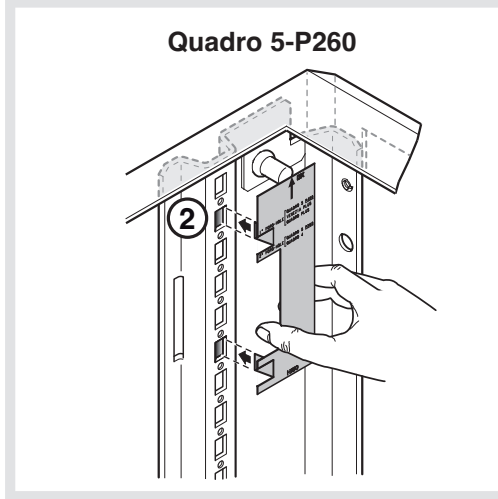
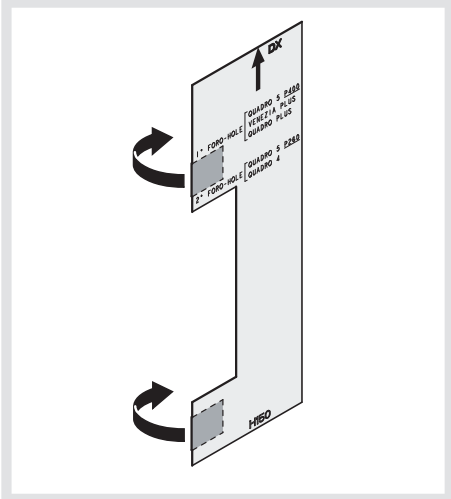
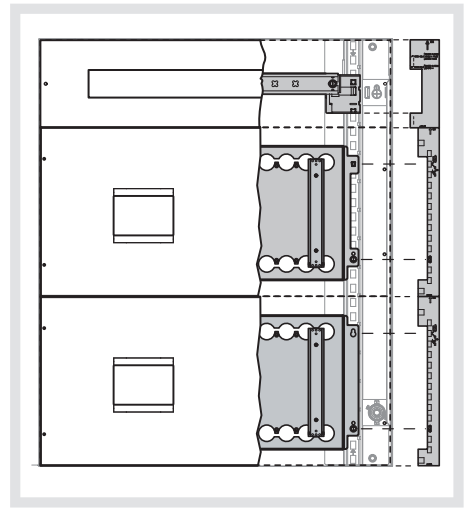
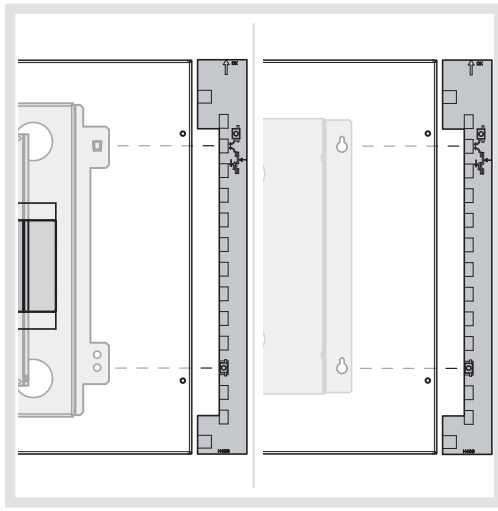
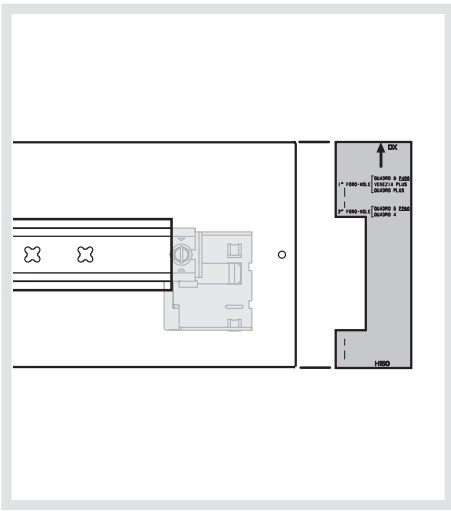

UC ___ H



UC ___

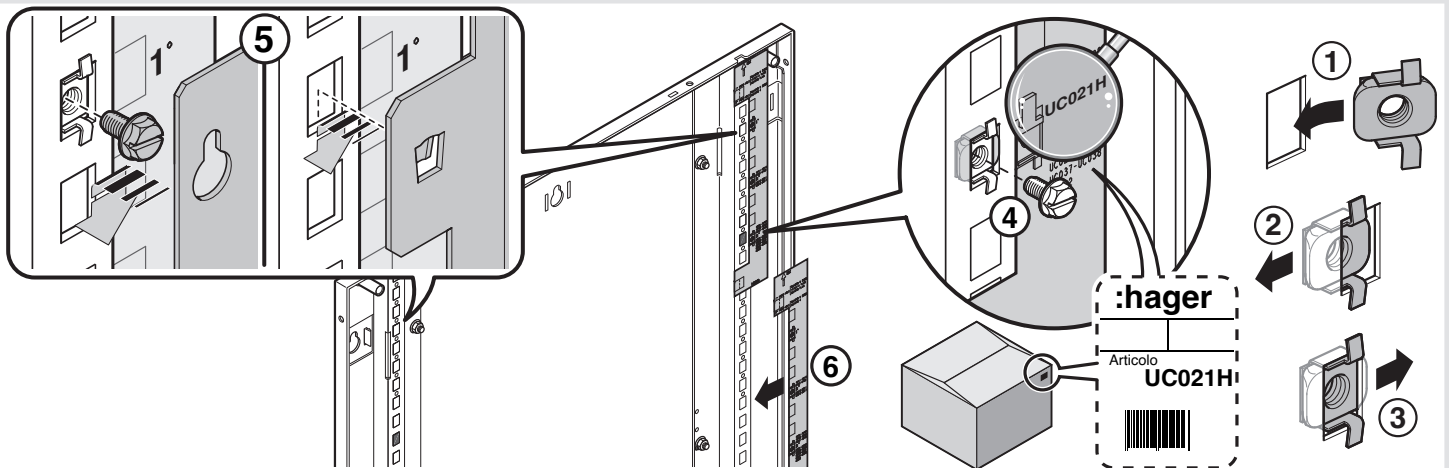
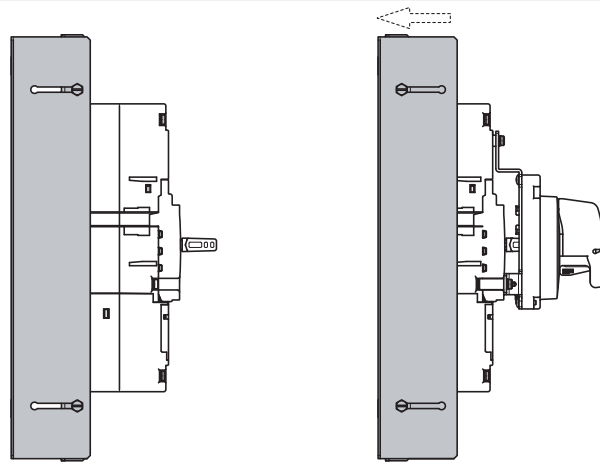
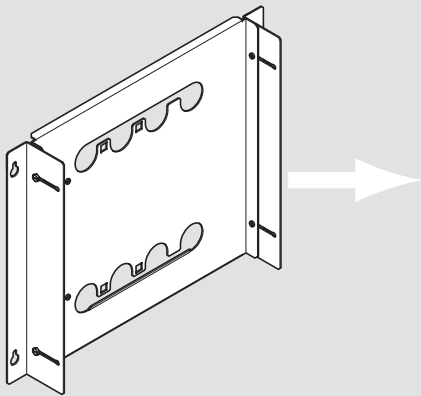
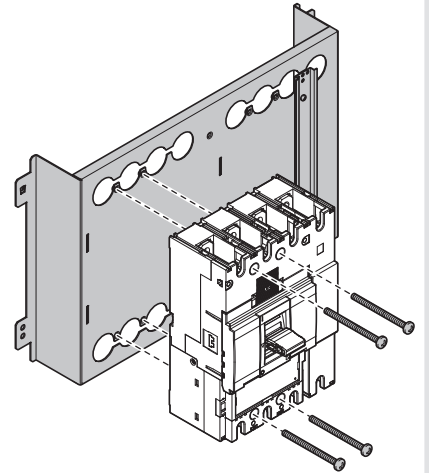
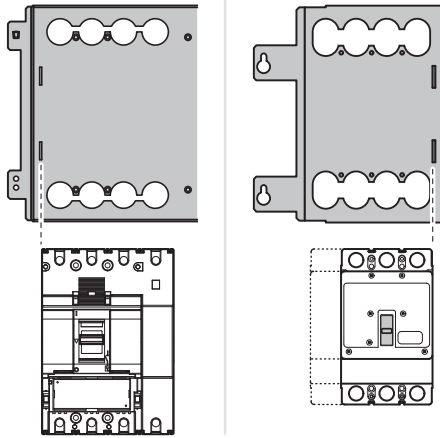
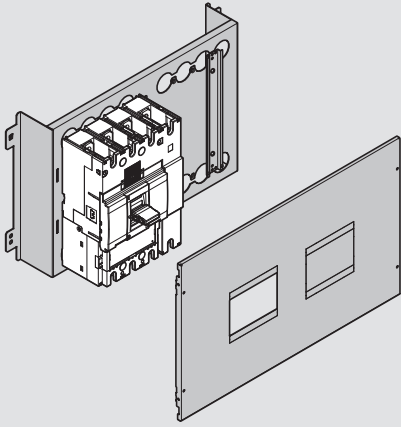

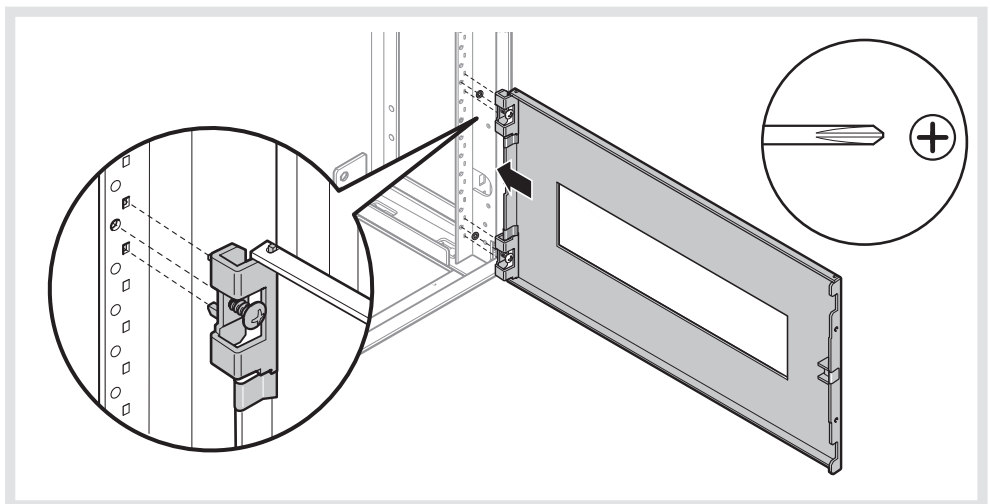
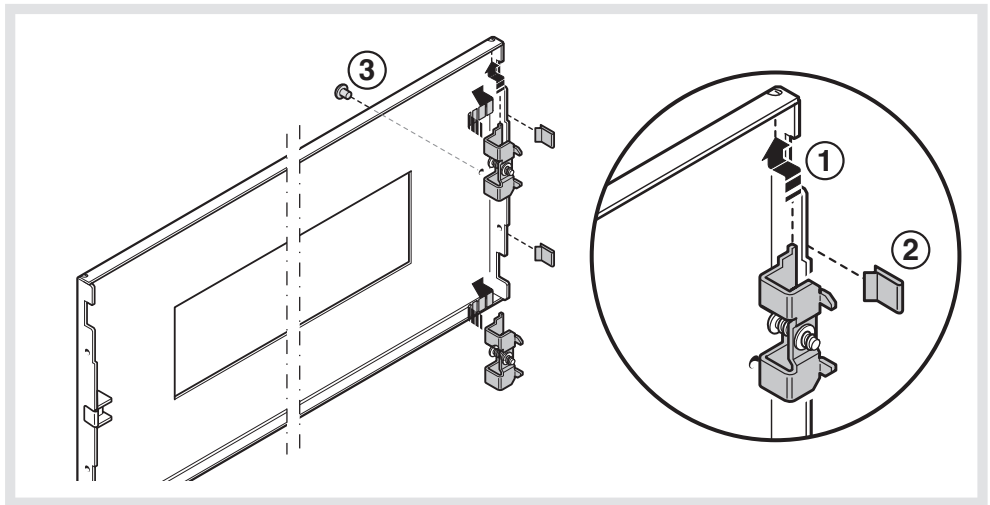
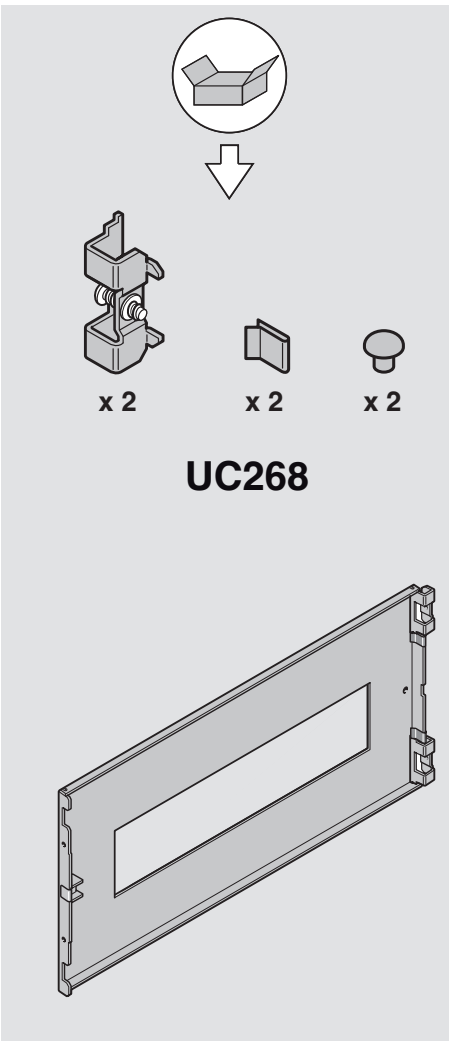
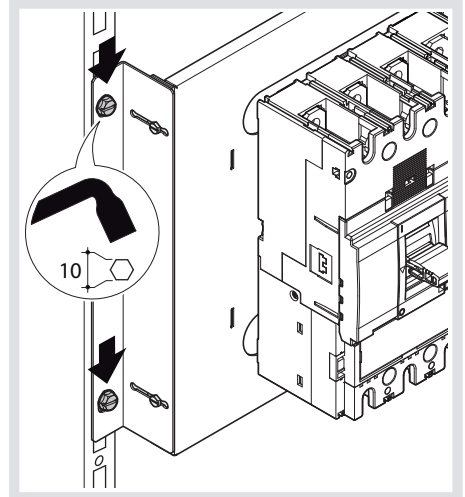
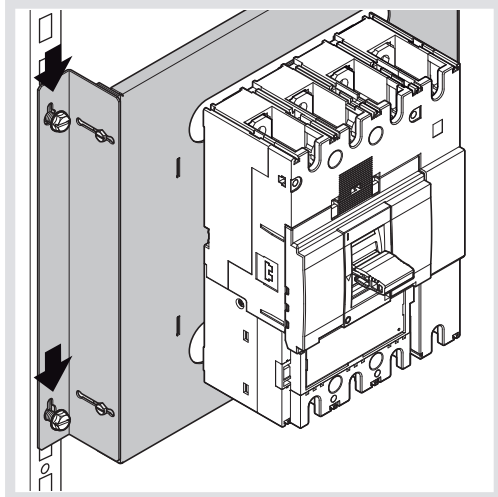
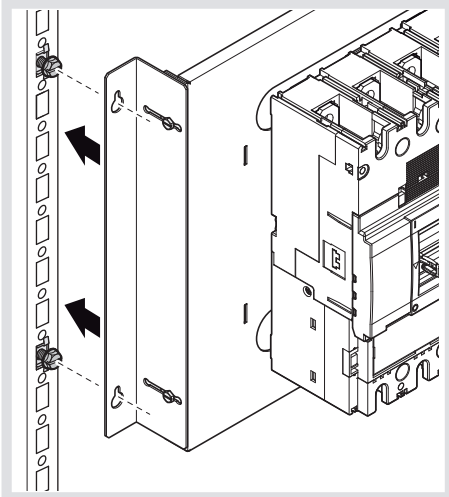
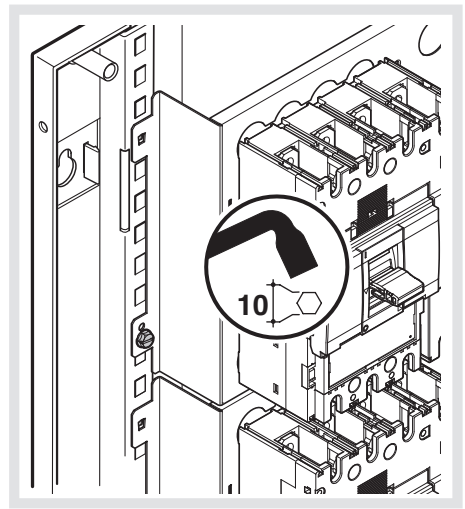
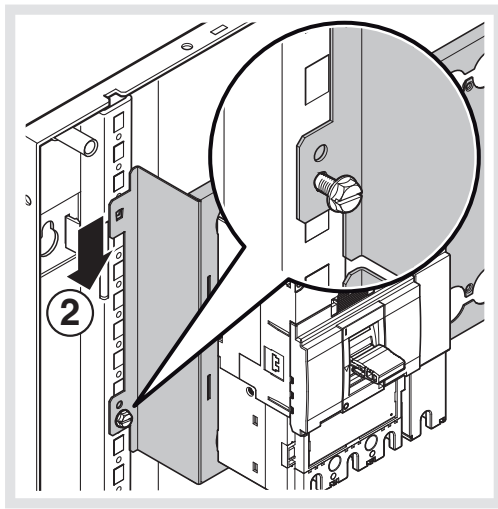
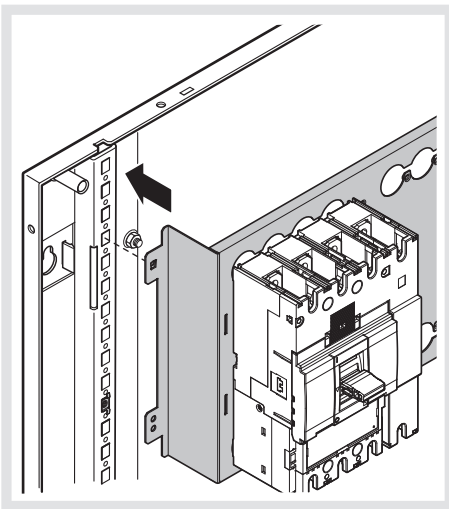

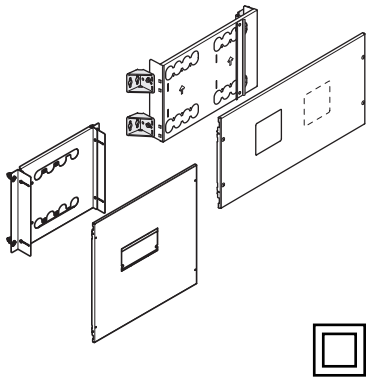

- (GB) Kit for modular device and moulded circuit breakers cl. II
- (FR) kit d'appareillage modulaire et disjoncteurs boîtier moulé cl. II
- (ES) Kit para aparata modular y en caja moldeada cl. II
- (IT) Kit per apparecchi modulari e scatolati cl. II
- (GR) Κιτ για αρθρωτές και συσκευασμένες συσκευές κλάσης II
- (AR) طقم أجهزة معيارية وقواطع مصبوبة الفئة الثانية

User Instruction

Notice d'instructions

Instrucciones de uso

Istruzioni d'uso

Οδηγίες Χρήσεως

تعليمات المستخدم

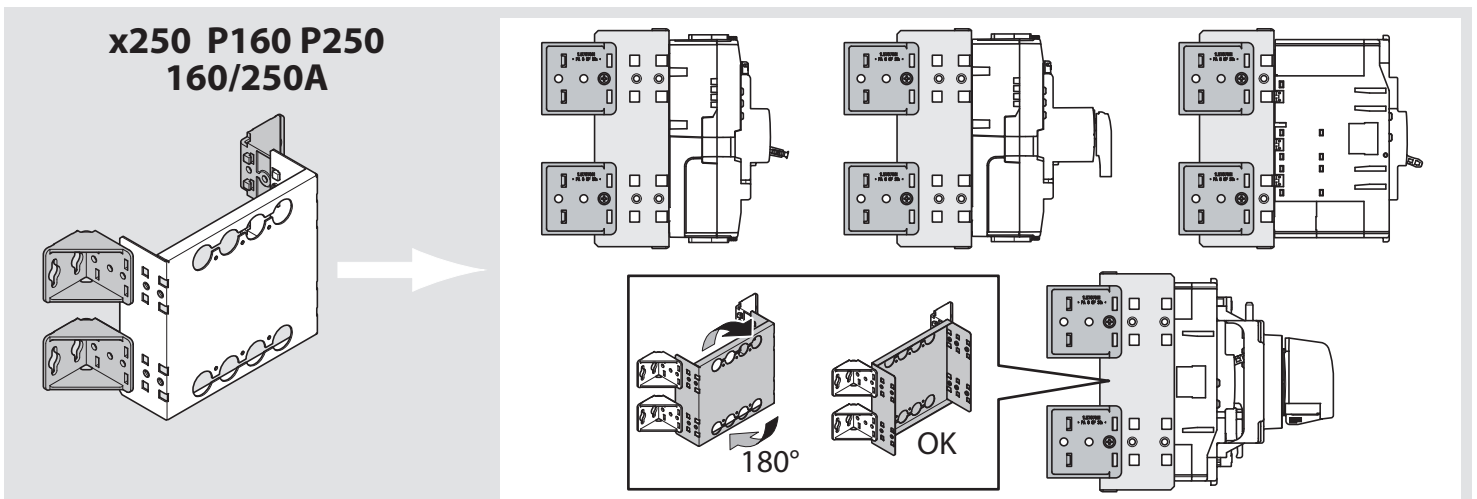
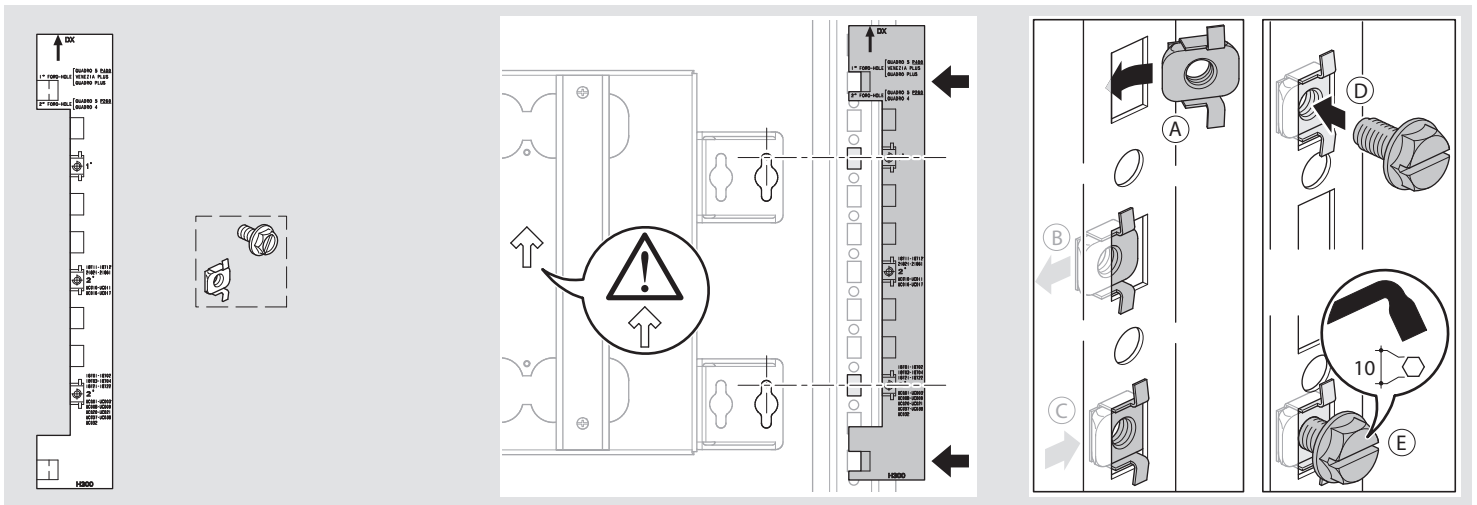
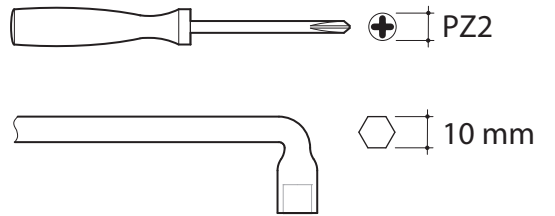
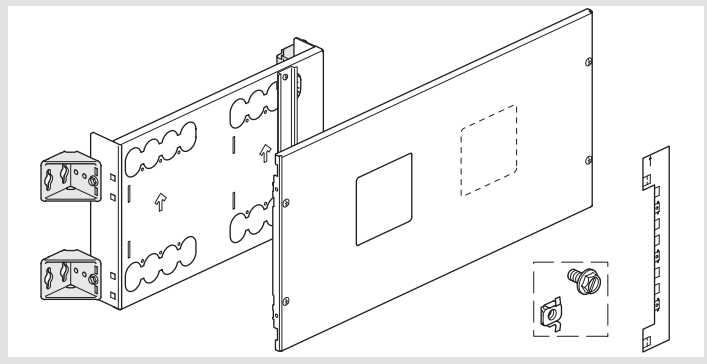
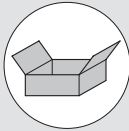

**UC321HM
UC322HM**

250A

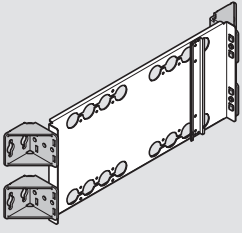

x250

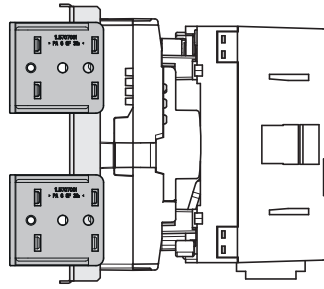

P250

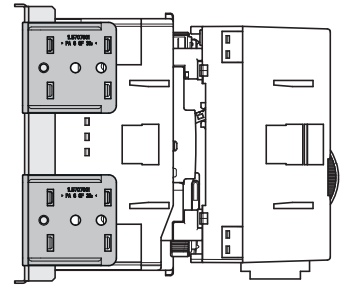

Plug-in

250A

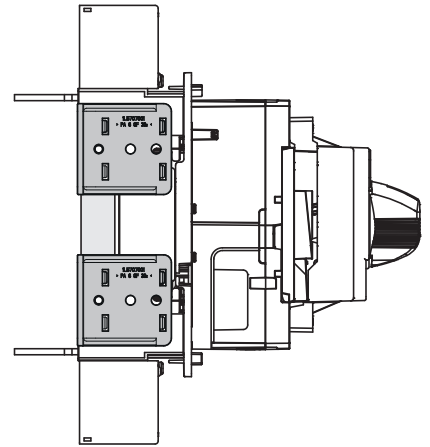
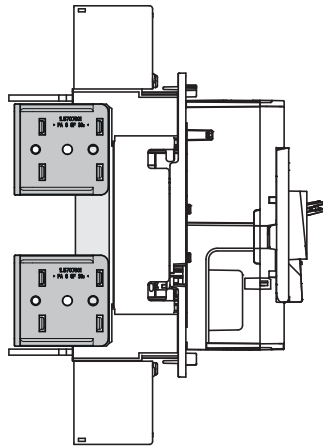
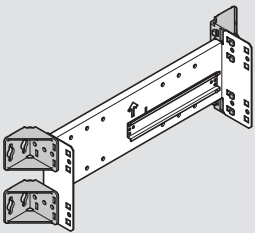

Withdrawable

250A

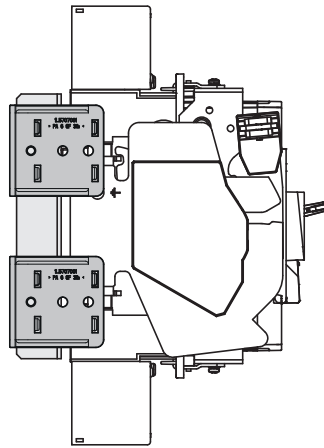
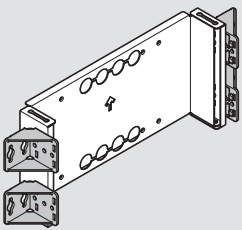

400-630A

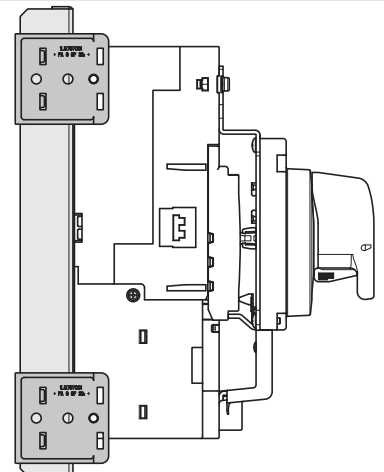
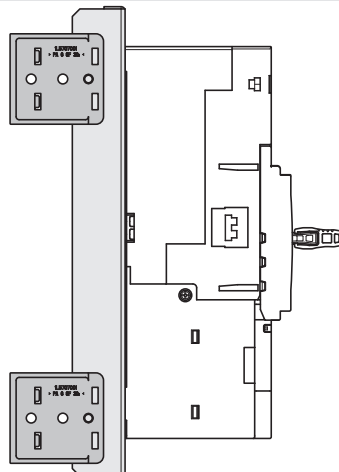
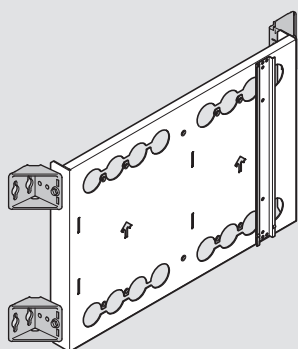

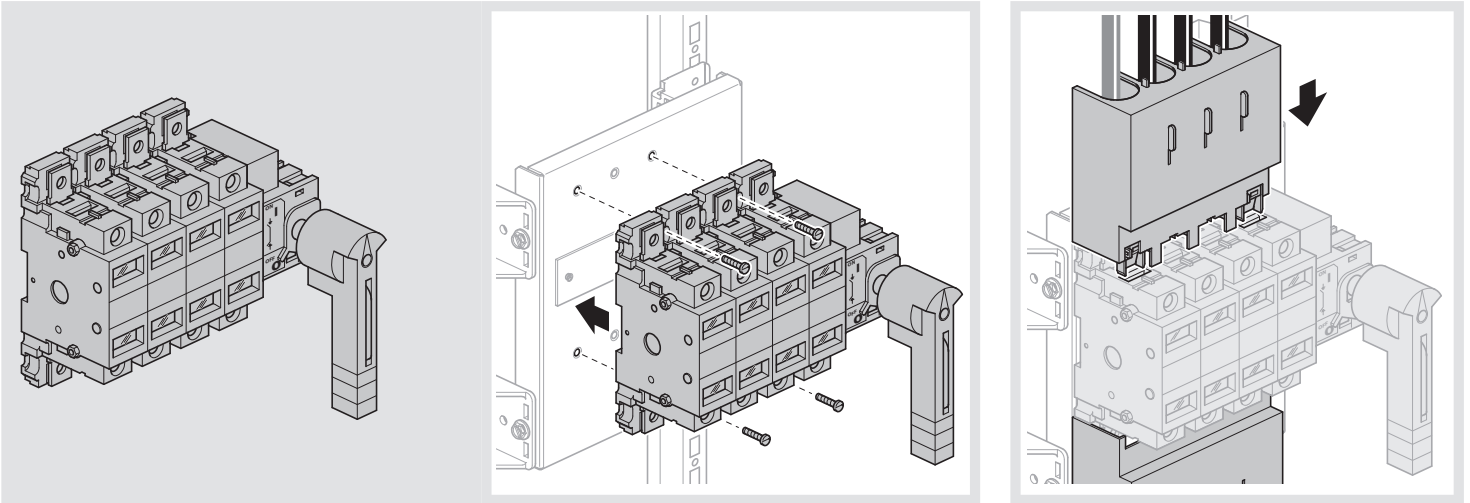
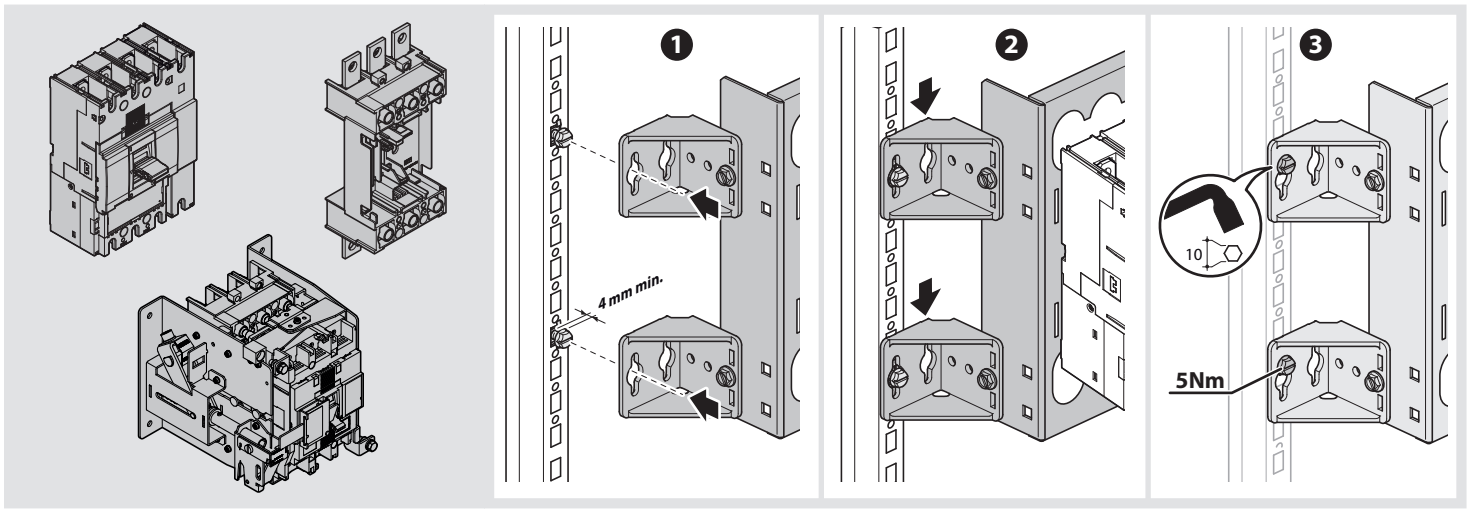

UC300S
+
UC311H/UC312H CL II

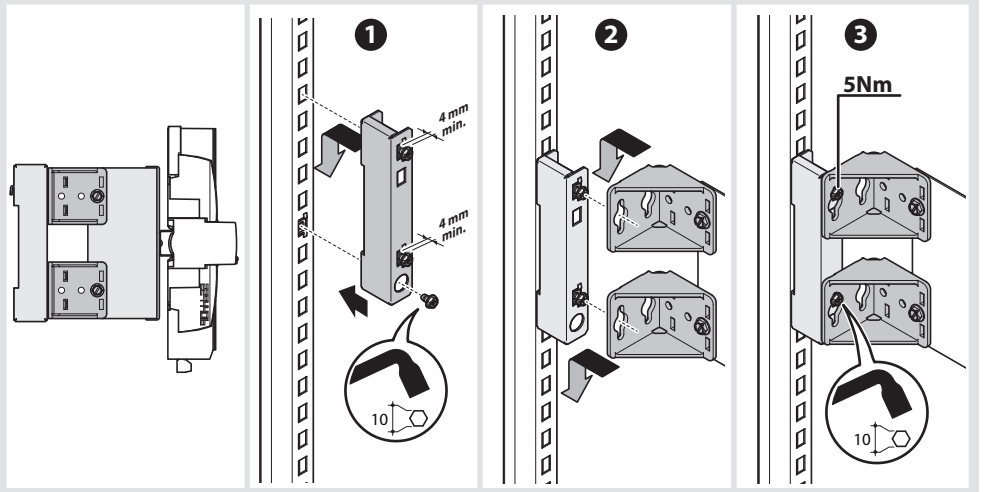
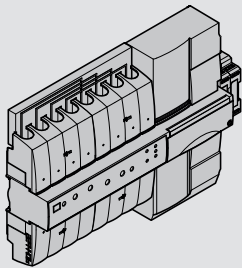

UC300S
+
UC011H/UC012H CL I

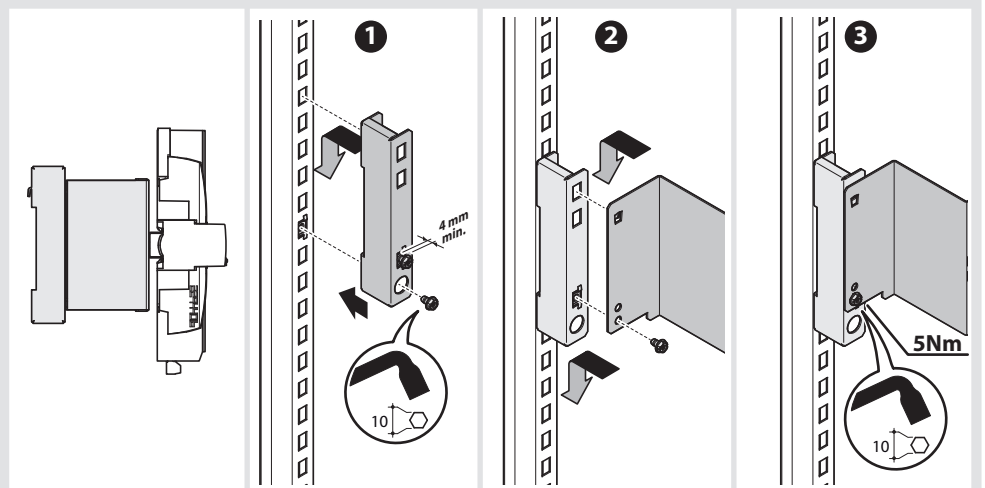
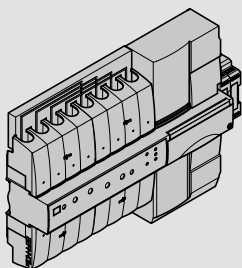

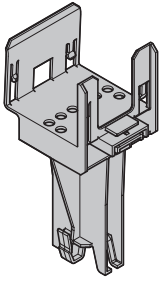

- (GB) Trunking
- (FR) Goulotte de câblage
- (ES) Canal de cableado
- (IT) Canale di cablaggio
- (GR) Διάτρητα κανάλια
- (AR) قناة تمديد الأسلاك

- User Instruction
- Notice d'instructions
- Instrucciones de uso
- Istruzioni d'uso
- Οδηγίες Χρήσεως
- تعليمات المستخدم

UC915N

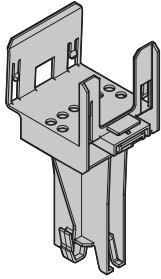
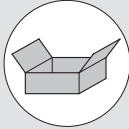

Horizontal أفقي	H	L	W1	Fixation تثبيت
UC911	80	30	350	Clip
UC912	80	30	600	Clip
UC913	80	30	800	Clip
B02567	80	40	~	Clip
Vertical رأسي	H	L	W1	Fixation تثبيت
UC916	80	60	~	Clip
B02570	80	60	~	Clip
B02581	80	40	~	Rivet

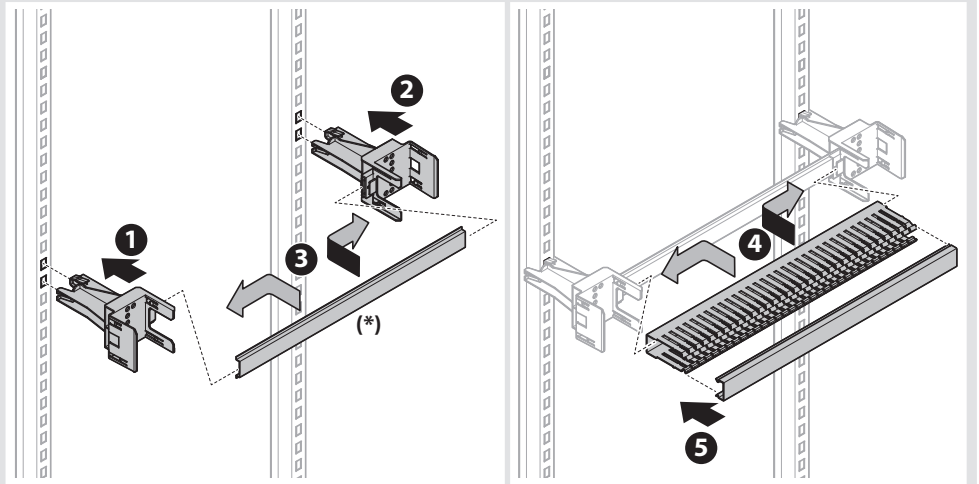

(*) DIN rail not included
لا تشمل السكة DIN

W1	L
350 (10M)	200 mm
600 (24M)	450 mm
800 (36M)	650 mm

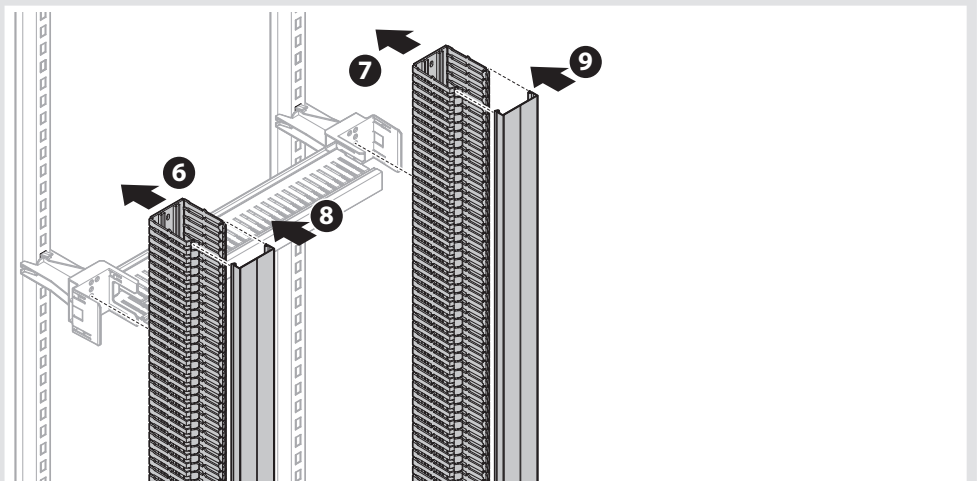
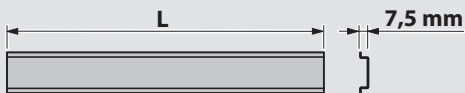

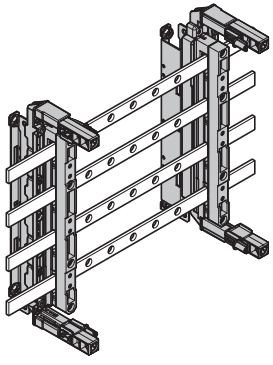

- Ⓒ GB 160 to 630A flat busbars system
- Ⓒ FR Jeu de barres a plat 160 a 630A
- Ⓒ ES Embarrado 160 a 630A
- Ⓒ IT Sistema sbarre di piatto da 160 a 630A
- Ⓒ GR Σύστημα επίπεδης μπάρας από 160 έως 630A
- Ⓒ AR نظام قضبان مسطحة 630-160 أمبير

- User Instruction
- Notice d'instructions
- Instrucciones de uso
- Istruzioni d'uso
- Οδηγίες Χρήσεως
- تعليمات المستخدم

UC820N – UC500 – UC700

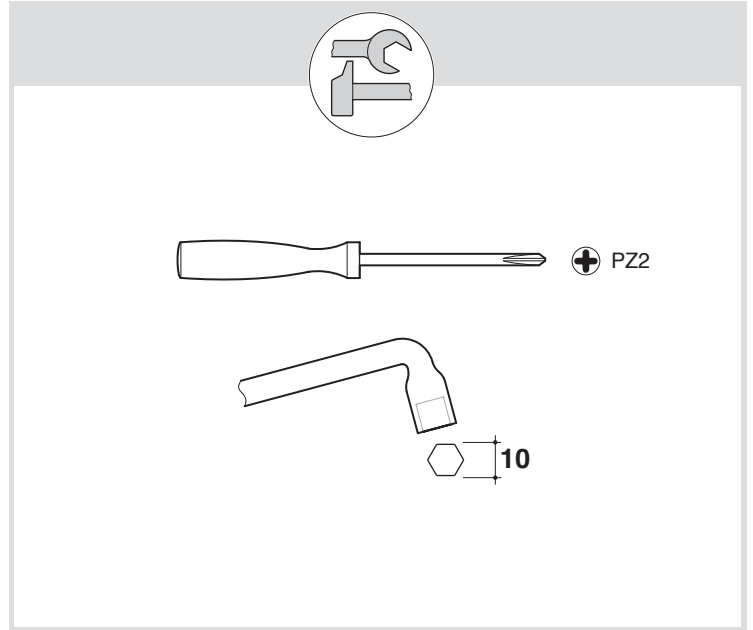
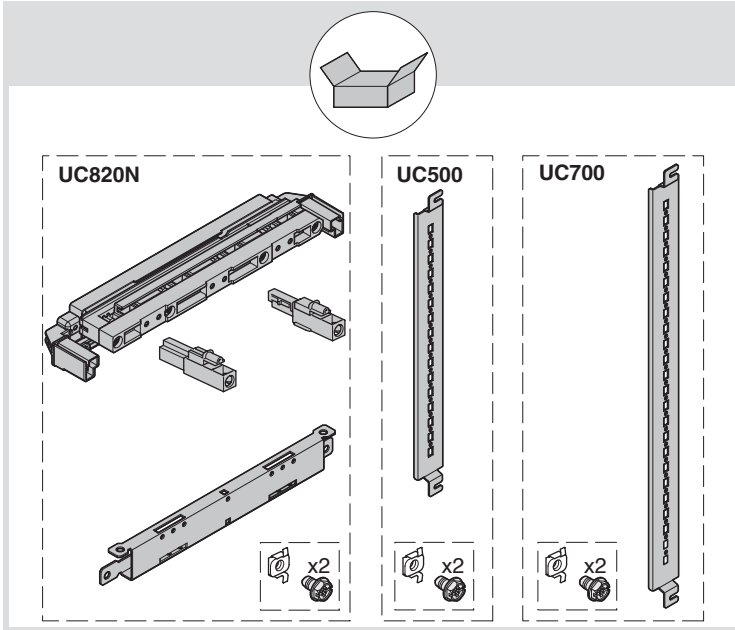

	250	500	250	500	750
 *(HI) *(LO)					
	2x UC820N *(LO)	2x UC820N *(LO)	2x (3x) UC820N *(HI)	2x (3x) UC820N *(LO)	2x (3x) UC820N *(LO)
	/	/	/	2x (3x) UC500	/
	/	/	/	/	2x (3x) UC700

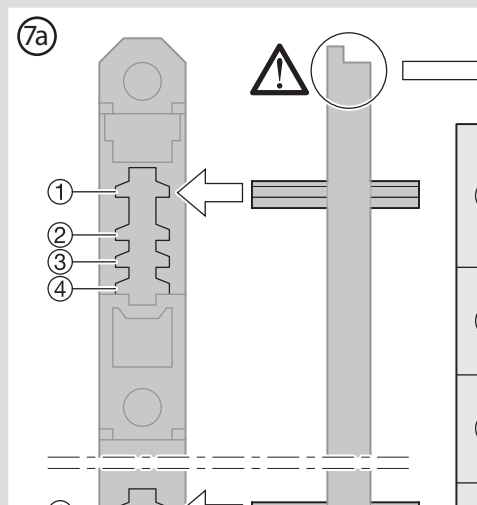
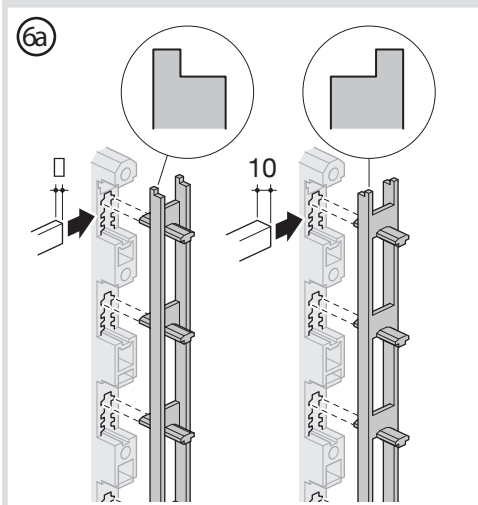
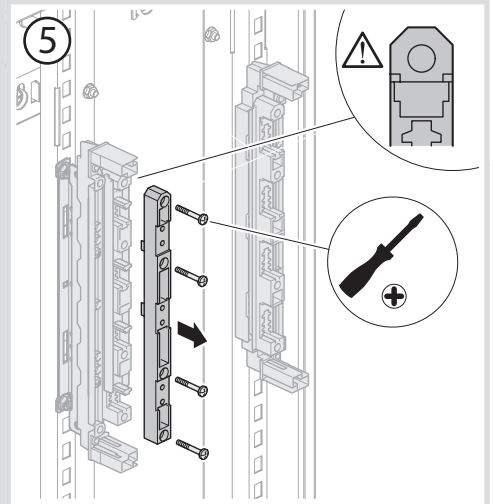
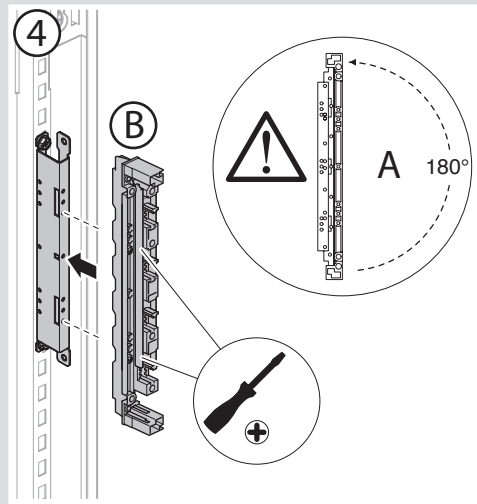
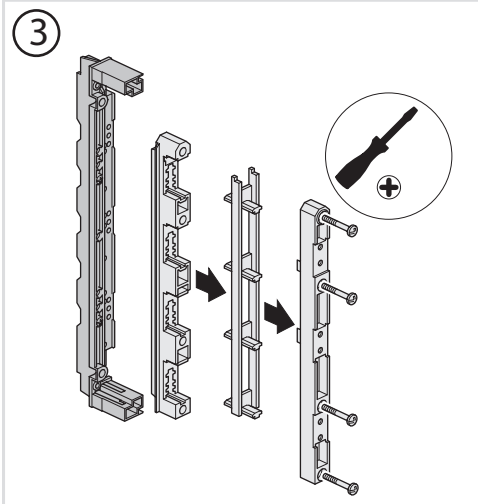
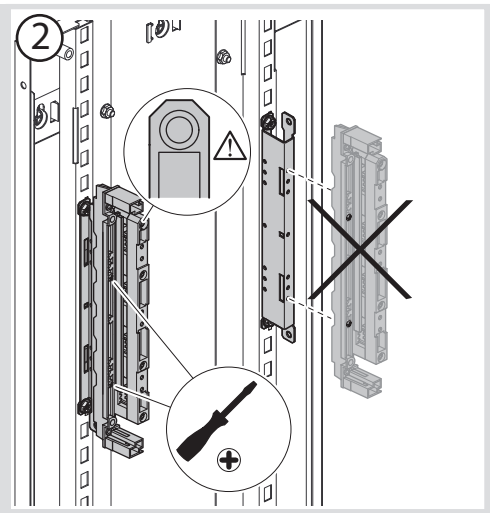
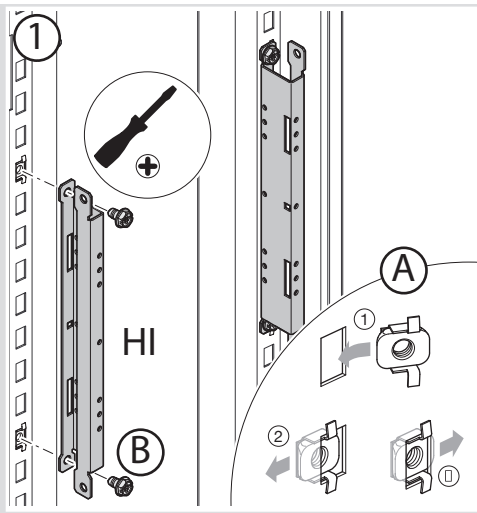
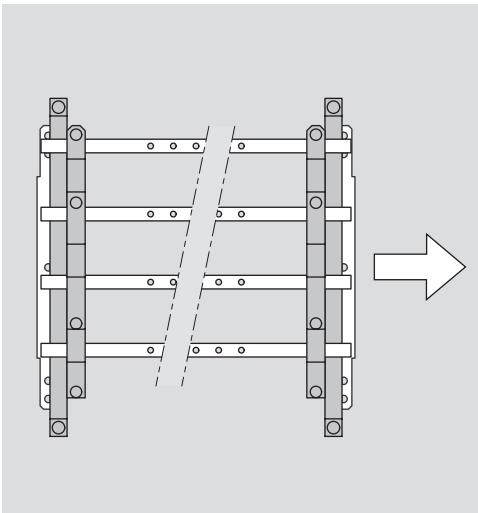

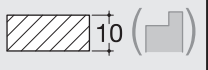
		
①	4x KS72B (12 x 5 x 245 mm) 4x KS72C (12 x 5 x 1000 mm)	
②	4x UC832 (20 x 5 x 1000 mm)	
③		
④	4x UM30A3 (30 x 5 x 280 mm) 4x UM30A1 (30 x 5 x 430 mm) 4x UM30A2 (30 x 5 x 880 mm)	4x UM30A4 (30 x 10 x 430 mm) 4x UM30A5 (30 x 10 x 880 mm)

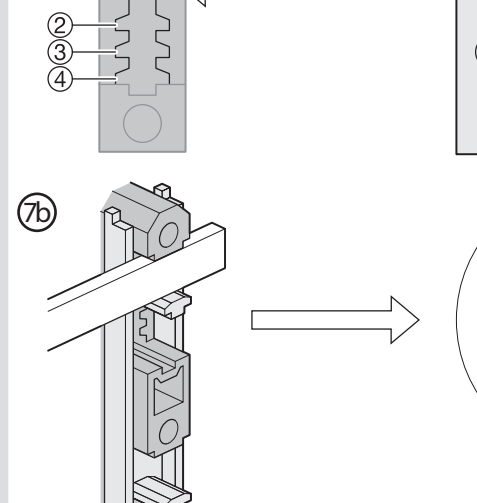
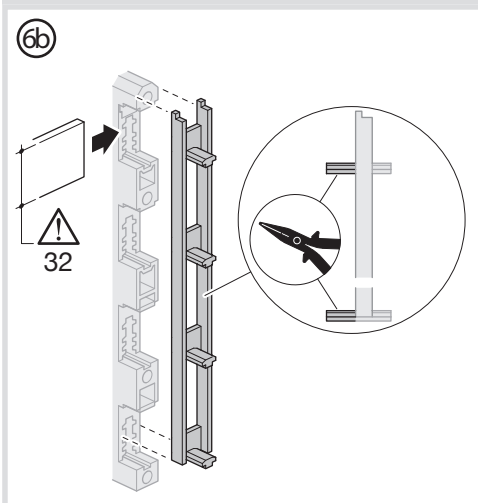

8

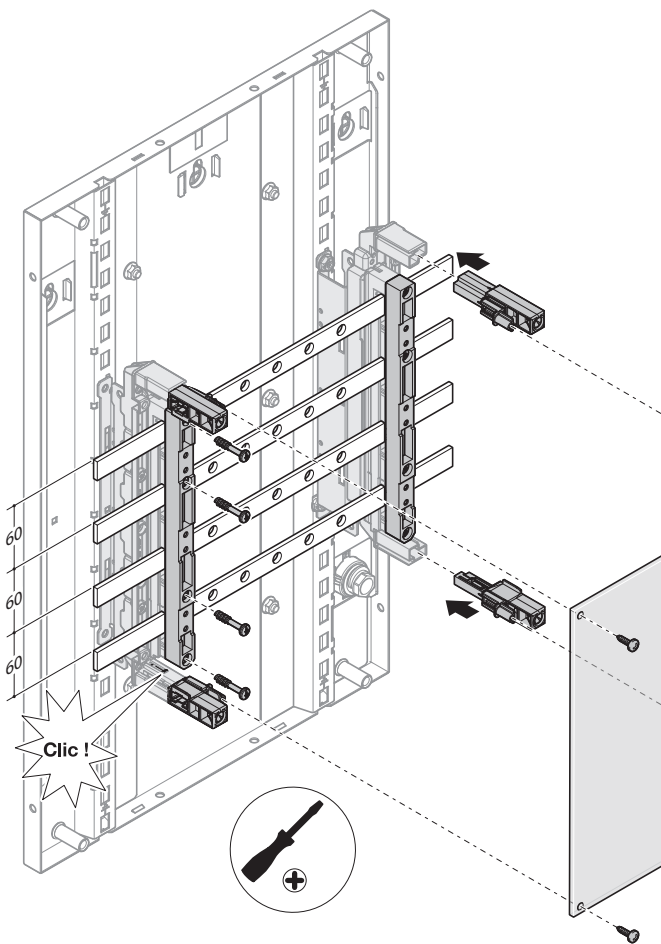

Icc (kA)	IpK (kA)	160 A	250 A	400 A	630 A
		D max 12 x 5	D max 20 x 5	D max 32 x 5	D max 32 x 10
9	15	500 mm	/	/	/
10	20	250 mm	/	/	/
15	30	/	500 mm	/	/
17	34	/	/	500 mm	/
18	35	/	250 mm	/	/
21	45	/	/	250 mm	500 mm
26	55	/	/	/	250 mm

UC827

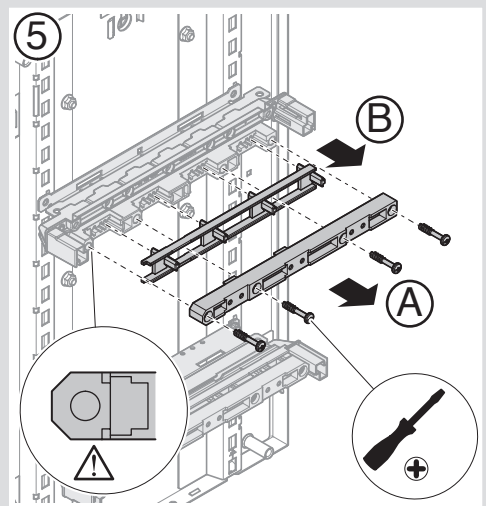
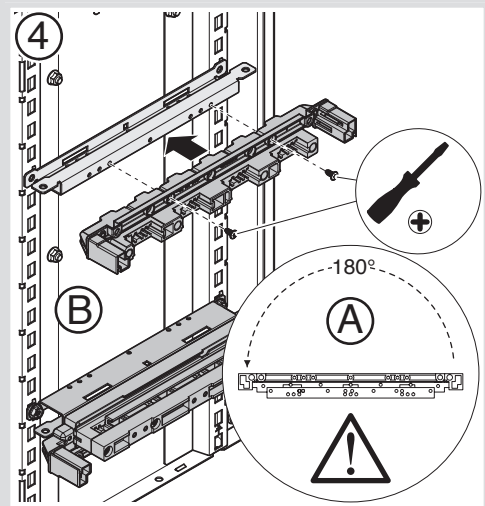
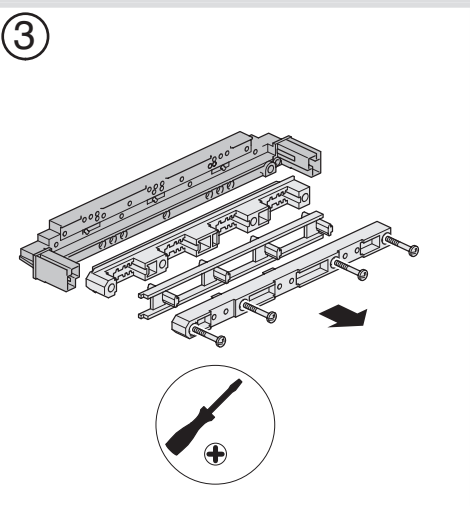
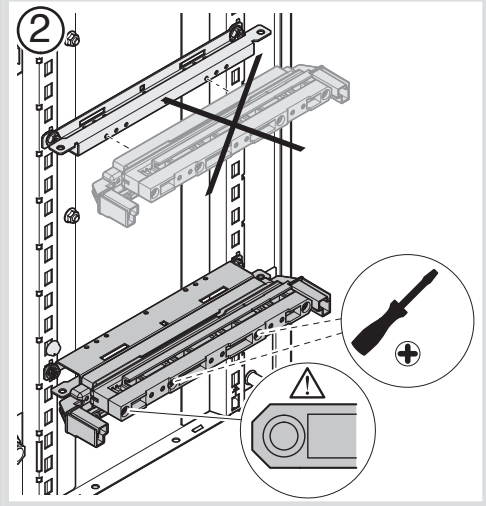
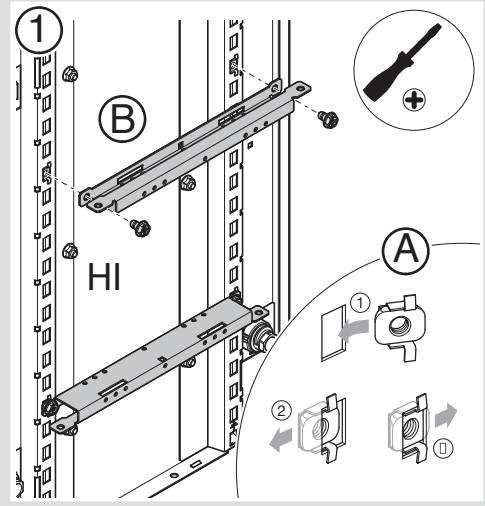
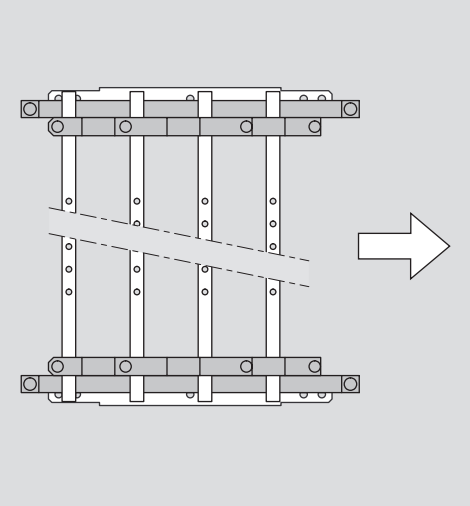

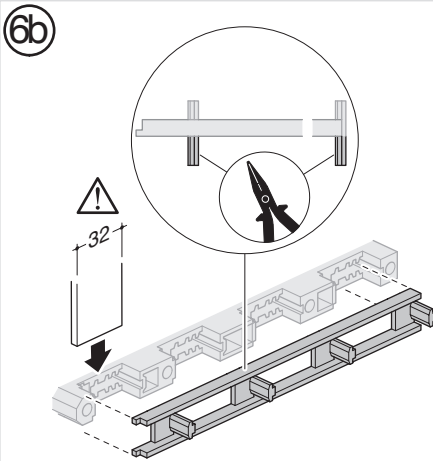
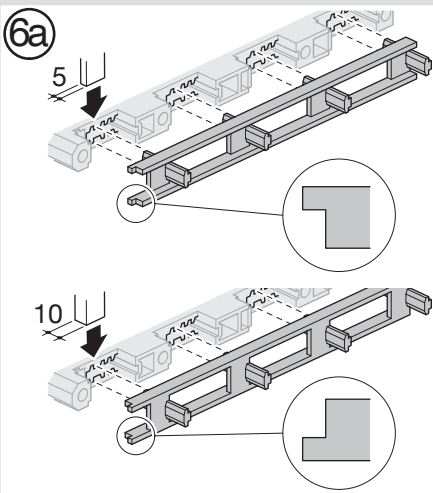

7a

①	4x KS72B (12 x 5 x 245 mm) 4x KS72C (12 x 5 x 1000 mm)	
②	4x UC832 (20 x 5 x 1000 mm)	
③		
④	4x UM30A3 (30 x 5 x 280 mm) 4x UM30A1 (30 x 5 x 430 mm) 4x UM30A2 (30 x 5 x 880 mm)	4x UM30A4 (30 x 10 x 430 mm) 4x UM30A5 (30 x 10 x 880 mm)

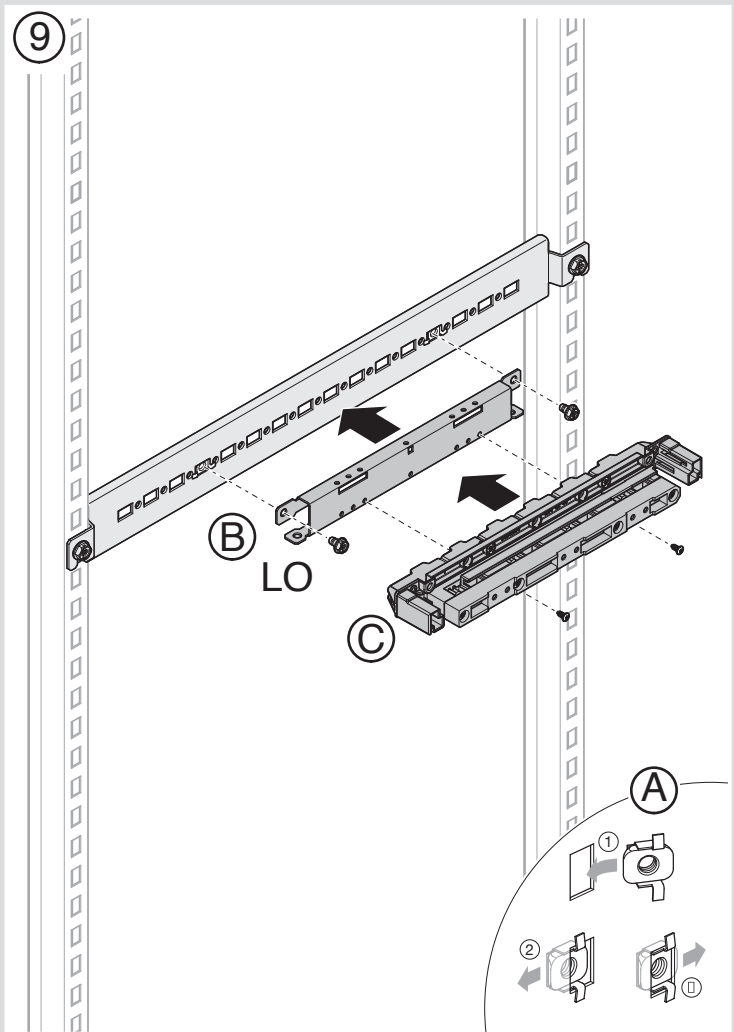
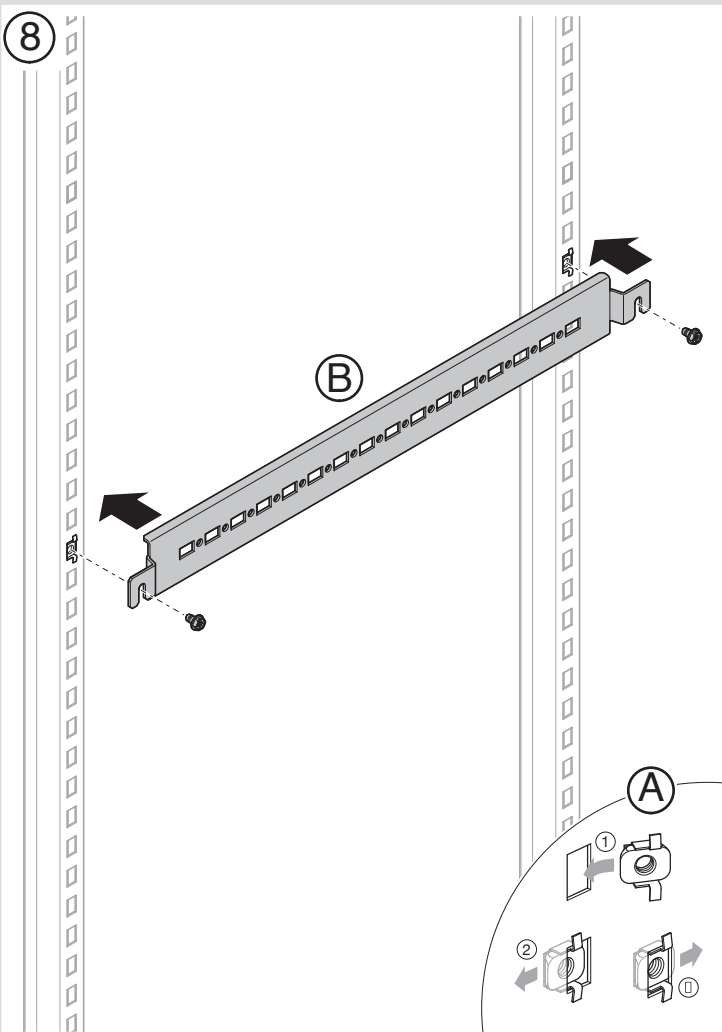
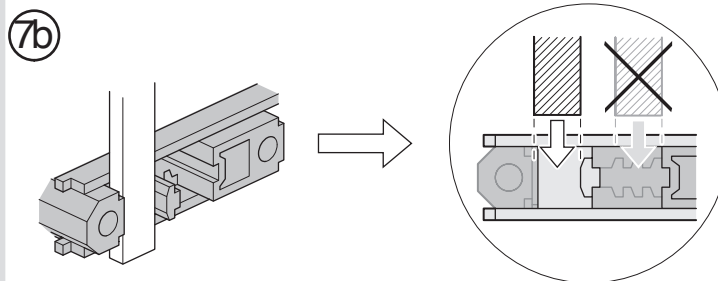

10

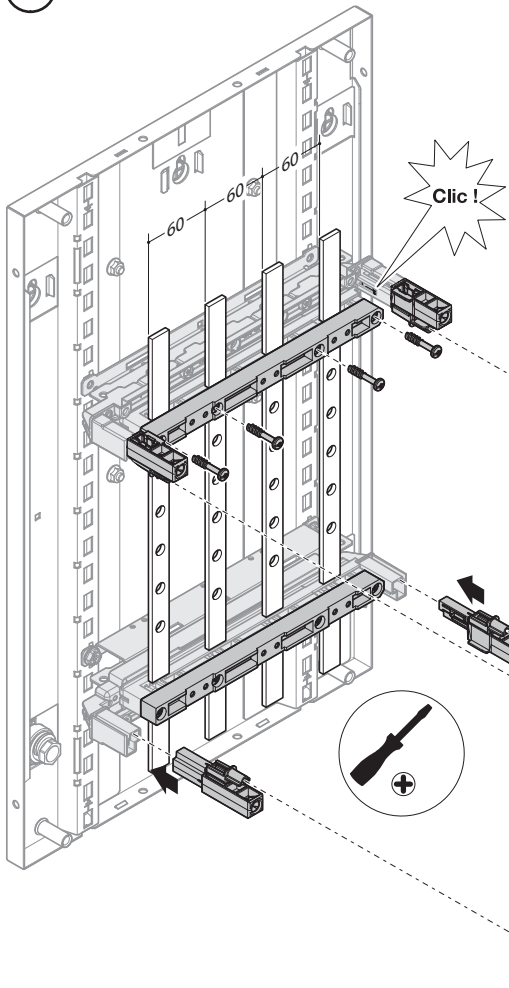

		160 A	250 A	400 A	630 A
Icc (kA)	IpK (kA)	12 x 5	20 x 5	32 x 5	32 x 10
10	17	1000 mm	1000 mm	1000 mm	1000 mm
15	30	475 mm	1000 mm	1000 mm	1000 mm
20	40	/	950 mm	1000 mm	1000 mm
25	53	/	650 mm	850 mm	1000 mm
30	63	/	425 mm	550 mm	900 mm
35	74	/	/	375 mm	625 mm

UC827

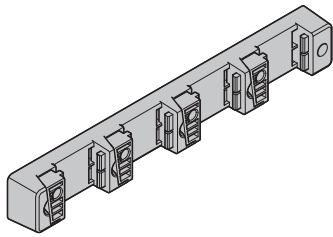

- (GB) Alluminium Busbars
- (FR) Barres d'aluminium
- (ES) Barras de aluminio
- (IT) Barre in alluminio
- (GR) Ράβδοι αλουμινίου
- (AR) قضبان ألومنيوم

User Instruction

Notice d'instructions

Instrucciones de uso

Istruzioni d'uso

Οδηγίες Χρήσεως

تعليمات المستخدم

UCBS80BB - UC500 - UC700 - UC829

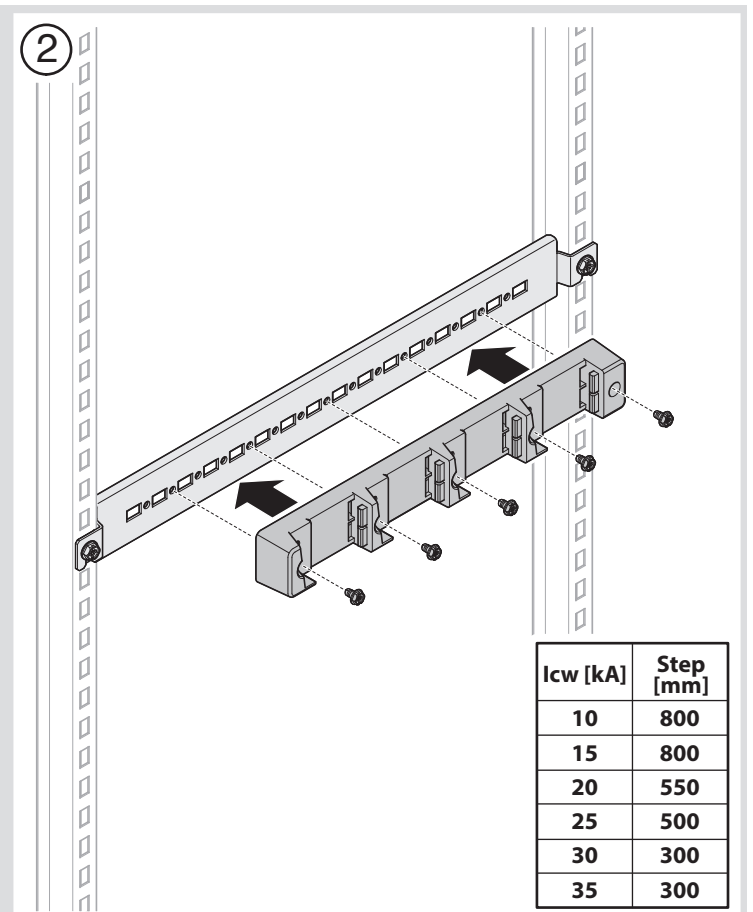
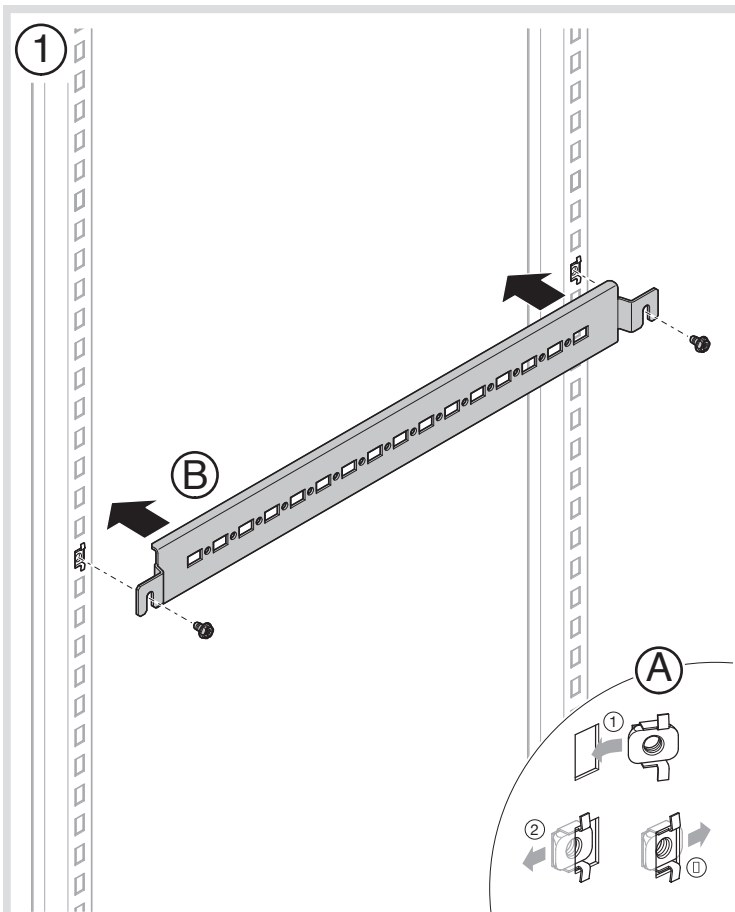
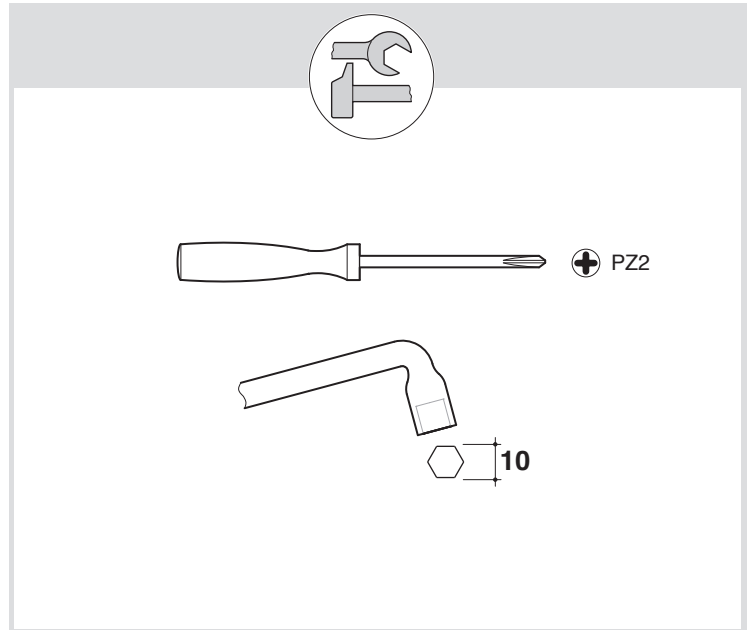
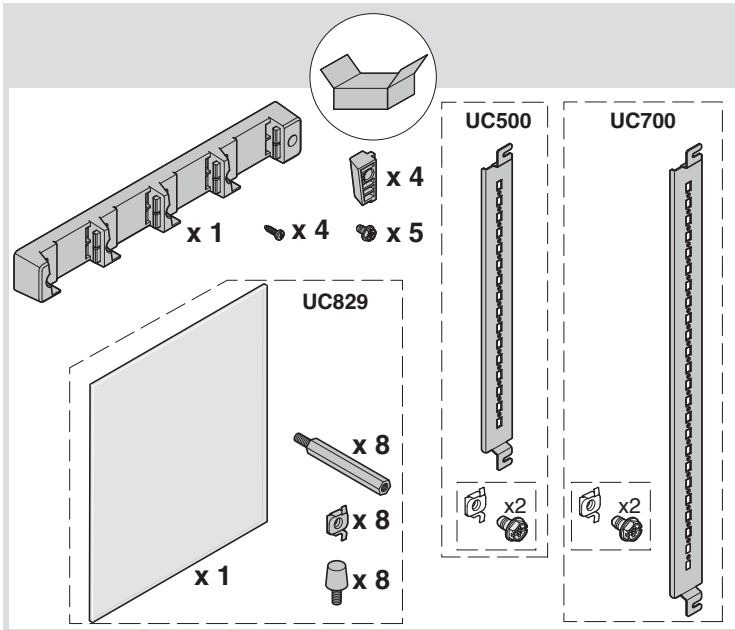

I _{cw} [kA]	Step [mm]
10	800
15	800
20	550
25	500
30	300
35	300

